

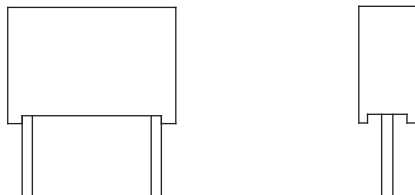

## AC and Pulse Metallized Polypropylene Film Capacitors MKP Radial Potted Type



### FEATURES

- Material categorization:  
for definitions of compliance please see  
[www.vishay.com/doc?99912](http://www.vishay.com/doc?99912)



### APPLICATIONS

- Pulse operations
- SMPS and thyristor circuits
- Storage, filter, timing, sample and hold circuits



| QUICK REFERENCE DATA                          |   |
|---|---|
| Capacitance range                             | 4700 pF to 10 $\mu$ F   |
| Capacitance tolerances                        | $\pm 20\%$ (M), $\pm 10\%$ (K), $\pm 5\%$ (J)   |
| Climatic testing class according to IEC 60068 | 55/100/56   |
| Operating temperature range                   | -55 $^{\circ}$ C to +100 $^{\circ}$ C   |
| Dielectric                                    | Polypropylene film  |
| Electrodes                                    | Metallized  |
| Construction                                  | Extended metallized film<br>(refer to general information following the link in note below table)   |
| Coating                                       | Flame retardant plastic case, epoxy resin sealed<br>UL-class 94 V-0   |
| Leads   | Tinned wire   |
| Rated voltages ( $U_R$ )                      | 100 V <sub>DC</sub> , 160 V <sub>DC</sub> , 250 V <sub>DC</sub> , 400 V <sub>DC</sub> , 630 V <sub>DC</sub>   |
| Insulation resistance                         | Measured at 100 V <sub>DC</sub> after one minute<br><b>For C <math>\leq</math> 0.33 <math>\mu</math>F:</b><br>25 000 M $\Omega$ ( $U_R$ 100 V <sub>DC</sub> ) |
| Permissible AC voltages (RMS) up to 60 Hz     | 63 V <sub>AC</sub> , 100 V <sub>AC</sub> , 160 V <sub>AC</sub> , 220 V <sub>AC</sub> , 250 V <sub>AC</sub>  |
| Test voltage (electrode/electrode)            | 1.6 x $U_R$ for 2 s   |
| Time constant                                 | Measured at 100 V <sub>DC</sub> after one minute<br><b>For C &gt; 0.33 <math>\mu</math>F:</b><br>30 000 s minimum value                                       |
| Temperature coefficient                       | -250 x 10 <sup>-6</sup> / $^{\circ}$ C (typical value)  |
| Capacitance drift                             | Up to +40 $^{\circ}$ C, < 0.5 % for a period of two years   |
| Dielectric absorption                         | 0.05 % (typical value) according to IEC 60068-2-21  |
| Derating for DC and AC category voltage $U_C$ | At +85 $^{\circ}$ C: $U_C = 1.0 U_R$<br>At +100 $^{\circ}$ C: $U_C = 0.7 U_R$   |
| Self inductance                               | ~ 6 nH measured with 2 mm long leads  |
| Pull test on leads                            | $\geq 30$ N in direction of leads according to IEC 60068-2-21   |

### Note

- For further details, please refer to the general information available at [www.vishay.com/doc?26033](http://www.vishay.com/doc?26033)



**DIMENSIONS** in millimeters

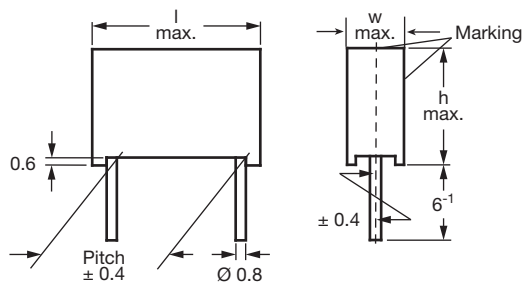

| LEAD DIAMETER<br>$d_t$ | W         | PITCH        |
|------------------------|-----------|--------------|
| $0.5 \pm 0.05$         | -         | 5 to 7.5     |
| $0.6 \pm 0.06$         | -         | 10           |
| $0.6 \pm 0.06$         | $\leq 6$  | 15           |
| $0.8 \pm 0.08$         | $> 6$     | 15           |
| $0.8 \pm 0.08$         | $< 16$    | 22.5 to 37.5 |
| $1.0 \pm 0.1$          | $\geq 16$ | 22.5 to 37.5 |

**MAXIMUM PULSE RISE TIME**

| PCM<br>(mm) | MAXIMUM PULSE RISE TIME $dV/dt$ [V/ $\mu$ s] |                     |                     |                     |                     |
|-------------|--|---------------------|---------------------|---------------------|---------------------|
|             | 100 V <sub>DC</sub>                          | 160 V <sub>DC</sub> | 250 V <sub>DC</sub> | 400 V <sub>DC</sub> | 630 V <sub>DC</sub> |
| 5           | 390  | -                   | -                   | -                   | -                   |
| 7.5         | -  | 240                 | 300                 | -                   | -                   |
| 10          | -  | 175                 | 220                 | 380                 | 510                 |
| 15          | -  | 100                 | 125                 | 200                 | 280                 |
| 22.5        | -  | 60                  | 75                  | 120                 | 160                 |
| 27.5        | -  | 45                  | 60                  | 95                  | 120                 |
| 37.5        | -  | 30                  | 40                  | 65                  | 85                  |

**Note**

- If the maximum pulse voltage is less than the rated voltage higher  $dV/dt$  values can be permitted.

**DISSIPATION FACTOR  $\tan \delta$**

| MEASURED AT    | $C \leq 0.1 \mu F$       | $0.1 \mu F < C \leq 1.0 \mu F$ | $C > 1.0 \mu F$          |
|----------------|--------------------------|--------------------------------|--------------------------|
| 1 kHz          | $\leq 10 \times 10^{-4}$ | $\leq 10 \times 10^{-4}$       | $\leq 40 \times 10^{-4}$ |
| 10 kHz         | $\leq 10 \times 10^{-4}$ | $\leq 10 \times 10^{-4}$       | -                        |
| 100 kHz        | $\leq 10 \times 10^{-4}$ | -                              | -                        |
| Maximum values |                          |                                |                          |



| ELECTRICAL DATA         |              |                     |                 |                 |                                 |             |
|-------------------------|--------------|---------------------|-----------------|-----------------|---------------------------------|-------------|
| U <sub>RDC</sub><br>(V) | CAP.<br>(μF) | CAPACITANCE<br>CODE | VOLTAGE<br>CODE | V <sub>AC</sub> | DIMENSIONS<br>w x h x l<br>(mm) | PCM<br>(mm) |
| 100                     | 0.0047       | -247                | 01              | 63              | 3.5 x 8.0 x 7.2                 | 5.0         |
|                         | 0.0068       | -268                |                 |                 | 3.5 x 8.0 x 7.2                 | 5.0         |
|                         | 0.010        | -310                |                 |                 | 3.5 x 8.0 x 7.2                 | 5.0         |
|                         | 0.015        | -315                |                 |                 | 3.5 x 8.0 x 7.2                 | 5.0         |
|                         | 0.022        | -322                |                 |                 | 3.5 x 8.0 x 7.2                 | 5.0         |
|                         | 0.033        | -333                |                 |                 | 3.5 x 8.0 x 7.2                 | 5.0         |
|                         | 0.047        | -347                |                 |                 | 4.5 x 9.0 x 7.2                 | 5.0         |
|                         | 0.068        | -368                |                 |                 | 4.5 x 9.0 x 7.2                 | 5.0         |
|                         | 0.100        | -410                |                 |                 | 6.0 x 11.0 x 7.2                | 5.0         |
| 160                     | 0.033        | -333                | 16              | 100             | 3.0 x 8.0 x 10.0                | 7.5         |
|                         | 0.047        | -347                |                 |                 | 3.0 x 8.0 x 10.0                | 7.5         |
|                         | 0.068        | -368                |                 |                 | 4.0 x 10.0 x 12.5               | 10.0        |
|                         | 0.10         | -410                |                 |                 | 4.0 x 10.0 x 12.5               | 10.0        |
|                         | 0.15         | -415                |                 |                 | 5.0 x 11.0 x 12.5               | 10.0        |
|                         | 0.22         | -422                |                 |                 | 5.0 x 11.0 x 17.5               | 15.0        |
|                         | 0.33         | -433                |                 |                 | 6.0 x 12.0 x 17.5               | 15.0        |
|                         | 0.47         | -447                |                 |                 | 7.0 x 13.5 x 17.5               | 15.0        |
|                         | 0.68         | -468                |                 |                 | 8.5 x 15.0 x 17.5               | 15.0        |
|                         | 1.0          | -510                |                 |                 | 7.0 x 16.5 x 26.0               | 22.5        |
|                         | 1.5          | -515                |                 |                 | 8.5 x 18.0 x 26.0               | 22.5        |
|                         | 2.2          | -522                |                 |                 | 9.0 x 19.0 x 31.5               | 27.5        |
|                         | 3.3          | -533                |                 |                 | 11.0 x 21.0 x 31.0              | 27.5        |
|                         | 4.7          | -547                |                 |                 | 12.5 x 22.5 x 41.5              | 37.5        |
|                         | 6.8          | -568                |                 |                 | 14.5 x 24.5 x 41.5              | 37.5        |
| 10.0                    | -610         | 16.0 x 28.5 x 41.5  | 37.5            |                 |                                 |             |
| 250                     | 0.010        | -310                | 25              | 160             | 3.0 x 8.0 x 10.0                | 7.5         |
|                         | 0.015        | -315                |                 |                 | 3.0 x 8.0 x 10.0                | 7.5         |
|                         | 0.022        | -322                |                 |                 | 3.0 x 8.0 x 10.0                | 7.5         |
|                         | 0.033        | -333                |                 |                 | 4.0 x 10.0 x 12.5               | 10.0        |
|                         | 0.047        | -347                |                 |                 | 4.0 x 10.0 x 12.5               | 10.0        |
|                         | 0.068        | -368                |                 |                 | 4.0 x 10.0 x 12.5               | 10.0        |
|                         | 0.10         | -410                |                 |                 | 4.0 x 10.0 x 12.5               | 10.0        |
|                         | 0.15         | -415                |                 |                 | 5.0 x 11.0 x 17.5               | 15.0        |
|                         | 0.22         | -422                |                 |                 | 5.0 x 11.0 x 17.5               | 15.0        |
|                         | 0.33         | -433                |                 |                 | 6.0 x 12.0 x 17.5               | 15.0        |
|                         | 0.47         | -447                |                 |                 | 7.0 x 13.5 x 17.5               | 15.0        |
|                         | 0.68         | -468                |                 |                 | 6.0 x 15.5 x 26.0               | 22.5        |
|                         | 1.0          | -510                |                 |                 | 7.0 x 16.5 x 26.0               | 22.5        |
|                         | 1.5          | -515                |                 |                 | 9.0 x 19.0 x 31.5               | 27.5        |
|                         | 2.2          | -522                |                 |                 | 11.0 x 21.0 x 31.0              | 27.5        |
|                         | 3.3          | -533                |                 |                 | 13.0 x 23.0 x 31.0              | 27.5        |
|                         | 4.7          | -547                |                 |                 | 12.5 x 22.5 x 41.5              | 37.5        |
|                         | 6.8          | -568                |                 |                 | 14.5 x 24.5 x 41.5              | 37.5        |
| 10.0                    | -610         | 16.0 x 28.5 x 41.5  | 37.5            |                 |                                 |             |



| ELECTRICAL DATA         |              |                     |                 |                    |                                 |             |
|-------------------------|--------------|---------------------|-----------------|--------------------|---------------------------------|-------------|
| U <sub>RDC</sub><br>(V) | CAP.<br>(µF) | CAPACITANCE<br>CODE | VOLTAGE<br>CODE | V <sub>AC</sub>    | DIMENSIONS<br>w x h x l<br>(mm) | PCM<br>(mm) |
| 400                     | 0.010        | -310                | 40              | 220                | 4.0 x 10.0 x 12.5               | 10.0        |
|                         | 0.015        | -315                |                 |                    | 4.0 x 10.0 x 12.5               | 10.0        |
|                         | 0.022        | -322                |                 |                    | 4.0 x 10.0 x 12.5               | 10.0        |
|                         | 0.033        | -333                |                 |                    | 4.0 x 10.0 x 12.5               | 10.0        |
|                         | 0.047        | -347                |                 |                    | 5.0 x 11.0 x 17.5               | 15.0        |
|                         | 0.068        | -368                |                 |                    | 5.0 x 11.0 x 17.5               | 15.0        |
|                         | 0.10         | -410                |                 |                    | 5.0 x 11.0 x 17.5               | 15.0        |
|                         | 0.15         | -415                |                 |                    | 6.0 x 12.0 x 17.5               | 15.0        |
|                         | 0.22         | -422                |                 |                    | 7.0 x 13.5 x 17.5               | 15.0        |
|                         | 0.33         | -433                |                 |                    | 6.0 x 15.5 x 26.0               | 22.5        |
|                         | 0.47         | -447                |                 |                    | 7.0 x 16.5 x 26.0               | 22.5        |
|                         | 0.68         | -468                |                 |                    | 9.0 x 19.0 x 31.5               | 27.5        |
|                         | 1.0          | -510                |                 |                    | 11.0 x 21.0 x 31.0              | 27.5        |
|                         | 1.5          | -515                |                 |                    | 13.0 x 23.0 x 31.0              | 27.5        |
|                         | 2.2          | -522                |                 |                    | 12.5 x 22.5 x 41.5              | 37.5        |
|                         | 3.3          | -533                |                 |                    | 14.5 x 24.5 x 41.5              | 37.5        |
| 4.7                     | -547         | 18.0 x 32.5 x 41.5  | 37.5            |                    |                                 |             |
| 630                     | 0.010        | -310                | 63              | 250 <sup>(1)</sup> | 4.0 x 10.0 x 12.5               | 10.0        |
|                         | 0.015        | -315                |                 |                    | 4.0 x 10.0 x 12.5               | 10.0        |
|                         | 0.022        | -322                |                 |                    | 4.0 x 10.0 x 12.5               | 10.0        |
|                         | 0.033        | -333                |                 |                    | 5.0 x 11.0 x 17.5               | 15.0        |
|                         | 0.047        | -347                |                 |                    | 5.0 x 11.0 x 17.5               | 15.0        |
|                         | 0.068        | -368                |                 |                    | 5.0 x 11.0 x 17.5               | 15.0        |
|                         | 0.10         | -410                |                 |                    | 6.0 x 12.0 x 17.5               | 15.0        |
|                         | 0.15         | -415                |                 |                    | 6.0 x 15.5 x 26.0               | 22.5        |
|                         | 0.22         | -422                |                 |                    | 7.0 x 16.5 x 26.0               | 22.5        |
|                         | 0.33         | -433                |                 |                    | 8.5 x 18.0 x 26.0               | 22.5        |
|                         | 0.47         | -447                |                 |                    | 9.0 x 19.0 x 31.5               | 27.5        |
|                         | 0.68         | -468                |                 |                    | 11.0 x 21.0 x 31.0              | 27.5        |
|                         | 1.0          | -510                |                 |                    | 13.0 x 23.0 x 31.0              | 27.5        |
|                         | 1.5          | -515                |                 |                    | 14.5 x 24.5 x 41.5              | 37.5        |
|                         | 2.2          | -522                |                 |                    | 16.0 x 28.5 x 43.0              | 37.5        |

**Notes**

- Further C-values upon request.
- <sup>(1)</sup> Not suitable for mains applications.  
Please refer to X-capacitors in our catalog "RFI Suppression Components".

| RECOMMENDED PACKAGING |                      |                    |                          |                           |                  |           |                     |             |
|-----------------------|----------------------|--------------------|--------------------------|---------------------------|------------------|-----------|---------------------|-------------|
| LETTER<br>CODE        | TYPE OF<br>PACKAGING | HEIGHT (H)<br>(mm) | REEL<br>DIAMETER<br>(mm) | ORDERING CODE<br>EXAMPLES | PCM<br>7.5 TO 10 | PCM<br>15 | PCM<br>22.5 TO 27.5 | PCM<br>37.5 |
| D                     | Ammo                 | 16.5               | S <sup>(1)</sup>         | MKP1840310405D            | x                | x         | -                   | -           |
| G                     | Ammo                 | 18.5               | S <sup>(1)</sup>         | MKP1840310405G            | x                | x         | -                   | -           |
| F                     | Reel                 | 16.5               | 350                      | MKP1840310405F            | x                | x         | -                   | -           |
| W                     | Reel                 | 18.5               | 350                      | MKP1840310405W            | x                | x         | -                   | -           |
| V                     | Reel                 | 18.5               | 500                      | MKP1840522255V            | -                | x         | x                   | -           |
| G                     | Ammo                 | 18.5               | L <sup>(2)</sup>         | MKP1840522255G            | -                | -         | x                   | -           |
| -                     | Bulk                 | -                  | -                        | MKP1840547255             | x                | x         | x                   | x           |

**Notes**

- <sup>(1)</sup> S = box size 55 mm x 210 mm x 340 mm (w x h x l)
- <sup>(2)</sup> L = box size 60 mm x 360 mm x 510 mm (w x h x l)



**PERMISSIBLE AC VOLTAGE VS. FREQUENCY**

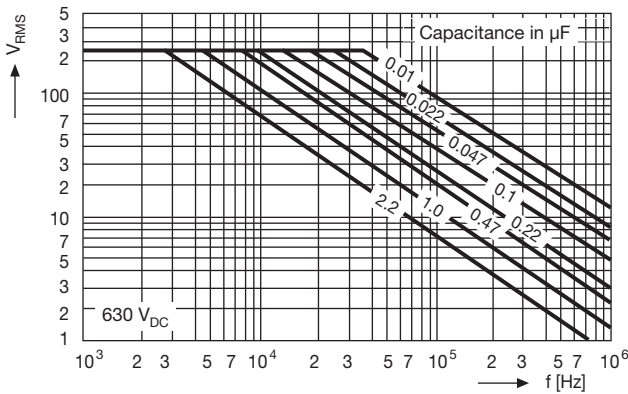
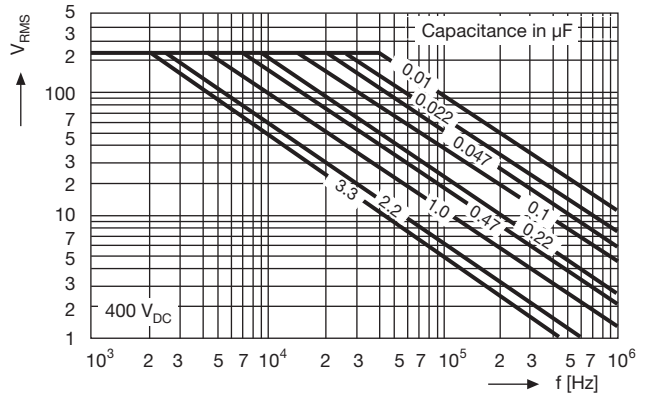
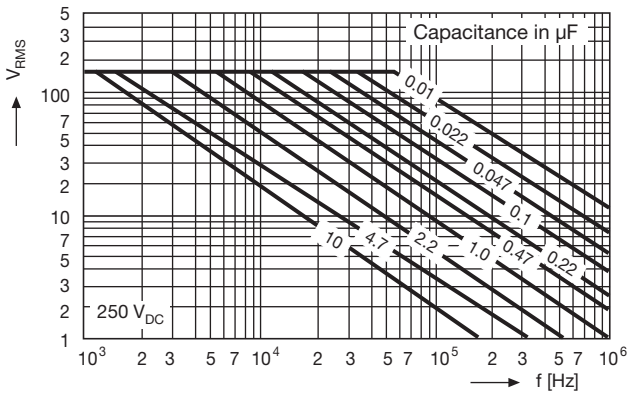
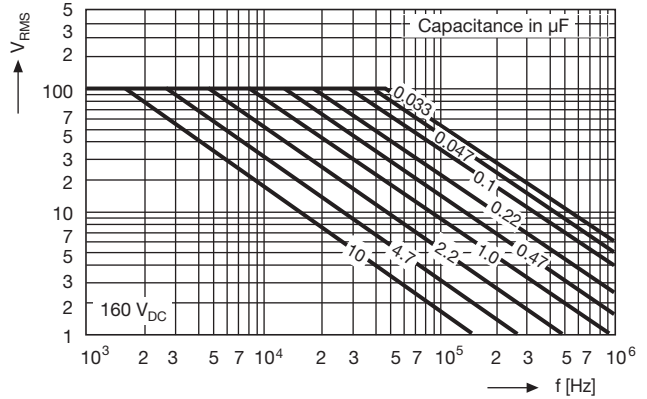
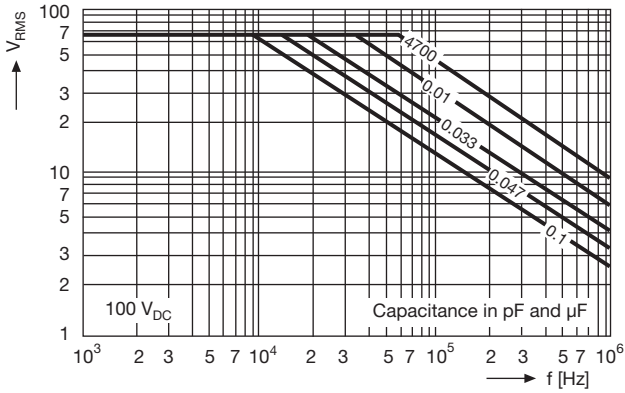

**IMPEDANCE VS. FREQUENCY**

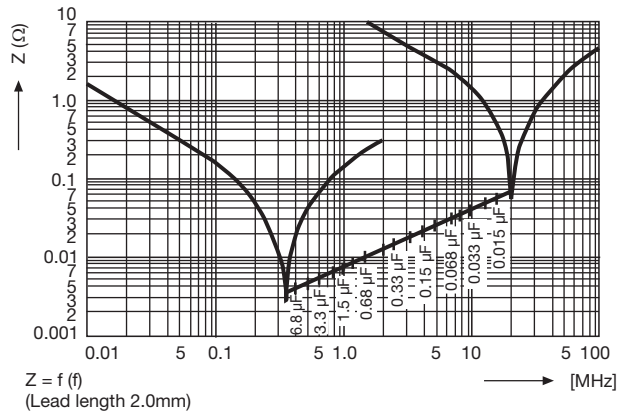



## **Disclaimer**

ALL PRODUCT, PRODUCT SPECIFICATIONS AND DATA ARE SUBJECT TO CHANGE WITHOUT NOTICE TO IMPROVE RELIABILITY, FUNCTION OR DESIGN OR OTHERWISE.

Vishay Intertechnology, Inc., its affiliates, agents, and employees, and all persons acting on its or their behalf (collectively, "Vishay"), disclaim any and all liability for any errors, inaccuracies or incompleteness contained in any datasheet or in any other disclosure relating to any product.

Vishay makes no warranty, representation or guarantee regarding the suitability of the products for any particular purpose or the continuing production of any product. To the maximum extent permitted by applicable law, Vishay disclaims (i) any and all liability arising out of the application or use of any product, (ii) any and all liability, including without limitation special, consequential or incidental damages, and (iii) any and all implied warranties, including warranties of fitness for particular purpose, non-infringement and merchantability.

Statements regarding the suitability of products for certain types of applications are based on Vishay's knowledge of typical requirements that are often placed on Vishay products in generic applications. Such statements are not binding statements about the suitability of products for a particular application. It is the customer's responsibility to validate that a particular product with the properties described in the product specification is suitable for use in a particular application. Parameters provided in datasheets and / or specifications may vary in different applications and performance may vary over time. All operating parameters, including typical parameters, must be validated for each customer application by the customer's technical experts. Product specifications do not expand or otherwise modify Vishay's terms and conditions of purchase, including but not limited to the warranty expressed therein.

Except as expressly indicated in writing, Vishay products are not designed for use in medical, life-saving, or life-sustaining applications or for any other application in which the failure of the Vishay product could result in personal injury or death. Customers using or selling Vishay products not expressly indicated for use in such applications do so at their own risk. Please contact authorized Vishay personnel to obtain written terms and conditions regarding products designed for such applications.

No license, express or implied, by estoppel or otherwise, to any intellectual property rights is granted by this document or by any conduct of Vishay. Product names and markings noted herein may be trademarks of their respective owners.

## X-ON Electronics

Largest Supplier of Electrical and Electronic Components

*Click to view similar products for [Film Capacitors](#) category:*

*Click to view products by [Vishay](#) manufacturer:*

Other Similar products are found below :

[F339X134748MIP2T0](#) [F450KG153J250ALH0J](#) [750-1018](#) [FKP1-1500160010P15](#) [FKP1R031007D00JYSD](#) [FKP1R031507E00JYSD](#)  
[FKP1U024707E00KYSD](#) [82DC4100CK60J](#) [82EC1100DQ50K](#) [PFR5101J100J11L16.5TA18](#) [PME261JB5220KR19T0](#) [A451GK223M040A](#)  
[A561ED221M450A](#) [QXJ2E474KTPT](#) [QXL2B333KTPT](#) [R49AN347000A1K](#) [EEC2G505HQA406](#) [B25668A6676A375](#) [B25673A4282E140](#)  
[BFC233868148](#) [BFC2370GC222](#) [C3B2AD44400B20K](#) [C4ASWBU3220A3EK](#) [CB027C0473J--](#) [CB177I0184J--](#) [CB182K0184J--](#) [23PW210](#)  
[950CQW5H-F](#) [SBDC3470AA10J](#) [SCD105K122A3-22](#) [2N3155](#) [A571EH331M450A](#) [FKP1-2202KV5P15](#) [FKS3-680040010P10](#)  
[QXL2E473KTPT](#) [445450-1](#) [B25669A3996J375](#) [46KI322000M1M](#) [46KR415050M1K](#) [4BSNBX4100ZBFJ](#) [MKP383510063JKP2T0](#)  
[MKPY2-.02230020P15](#) [MKT 1813-368-015](#) [4055292001](#) [46KN410000N1K](#) [EEC2E106HQA405](#) [EEC2G205HQA402](#) [EEC2G805HQA415](#)  
[P409CP224M250AH470](#) [82EC2150DQ50K](#)