

POS	A	B	C	D
02	6.65	NA	11.20	
04	9.65	3.00	14.20	6.74
06	12.65	6.00	17.20	
08	15.65	9.00	20.20	
10	18.65	12.00	23.20	
12	21.65	15.00	26.20	
14	24.65	18.00	29.20	
16	27.65	21.00	32.20	
18	30.65	24.00	35.20	
20	33.65	27.00	38.20	
22	36.65	30.00	41.20	
24	39.65	33.00	44.20	

DIMENSION TABLE

PART NUMBER SCHEME:

10137924-XX X X LF

NO OF POS.

02: 2 POS.

24: 24 POS.

1. HSG MATERIAL
2. LCP, GLOW WIRE COMPATIBLE
3. LCP, NON GLOW WIRE COMPATIBLE

CONTACT PLATING

1. TIN
2. GOLD FLASH
3. 15u" Au, TIN ON SOLDER TAILS
4. 30u" Au, TIN ON SOLDER TAILS

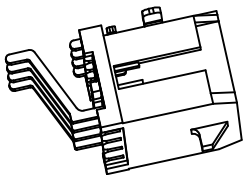
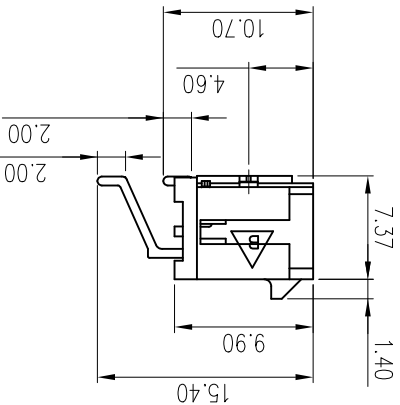
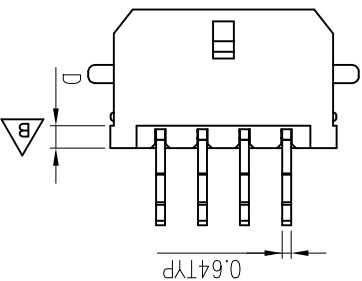
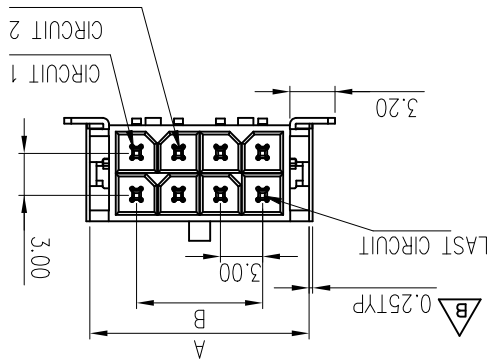

- NOTES:
- MATERIALS: 1. MATERIALS: OPTIONAL, UL94V-0, HALOGEN FREE, COLOR: BLACK
 - FINISH: 2. FINISH: TERMINAL: COPPER ALLOY
HOLD DOWN: COPPER ALLOY
 - TERMINAL: OPTIONAL
 - HOLD DOWN: MATTE TIN
 - UNDER PLATING: NICKEL OVERALL
 - PRODUCT SPECIFICATION: GS-12-1177
 - PACKAGE SPECIFICATION: GS-14-2359
 - THIS PART MATES WITH FCI RECEPTACLE WIRE
 - CONNECTOR 10127716
 - THIS PART IS APPLICABLE FOR REFLOW PROCESS WITH 260°C PEAK TEMPERATURE FOR 10 SECONDS.

RECOMMENDED PCB LAYOUT
GENERAL TOLERANCE: ±0.05
PCB THICKNESS=1.60MM

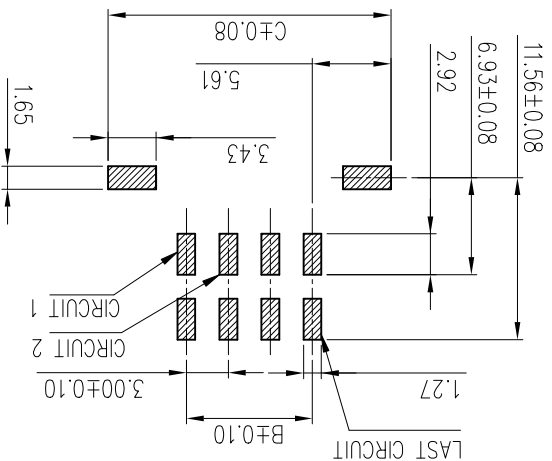

mat'l. code	surface	tolerance	projection	product family	MINITEX PWR3.0
lit	ecn no	dr	date	tolerances unless otherwise specified	
A	TAI	2015-11-30			
B	EX-1-24982	TAI	2016-09-21		
C	EX-N-26477	TONY	2017-03-27		
	inlet	X±.2			
	inlet	X.XX ±0.2			
	dr	KENNY TAI	2015-11-26		
	enrg	KENNY TAI	2015-11-26		
	chr	KENNY TAI	2015-11-26		
	pppd	PM ZHENG	2015-11-30		
sheet	revision	c	c		
index	revision	1	2		
	sheet				
	type	Product Customer Drawing			
	dwg no	10137924			
	sheet 1 of 2 size	A4			
	product family	MINITEX PWR3.0 R/A HEADER, DUAL ROW SMT TAILS AND HOLD DOWN			
	title	MINITEX PWR3.0			

scalen.T.S.

mm

projection

FCI

Product Customer Drawing

type

sheet

index

mat'l. code	surface	tolerance	projection	product family	MINITEK PWR3.0
ltr	ecn no	dr	date	tolerances unless otherwise specified	
angles	X.X ±0.3	linear	X.XX ±0.2	mm	MINITEK PWR3.0 R/A HEADER, DUAL ROW
X±Z'				mm	SMT TAILS AND HOLD DOWN
dr	KENNY TAI	2015-11-26		scale:N.T.S.	dwg no
engr	KENNY TAI	2015-11-26			sheet 2 of 2 size
chr	KENNY TAI	2015-11-26			10137924
apprd	PM ZHENG	2015-11-30			Product Customer Drawing
sheet	revision	c			
index					

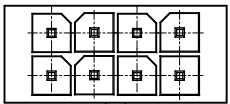

08 P

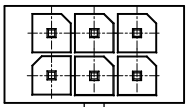

06 P

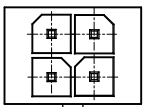

04 P

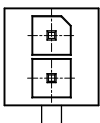

02 P

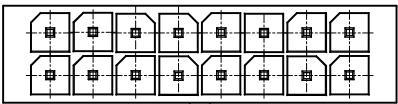

16 P

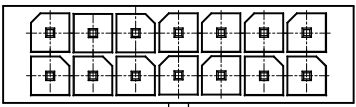

14 P

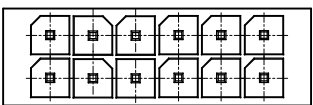

12 P

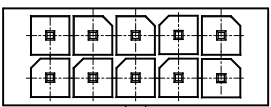

10 P

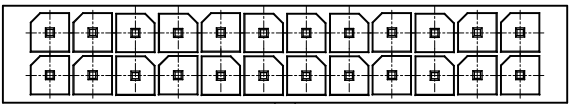

24 P

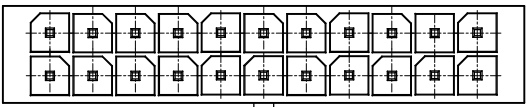

22 P

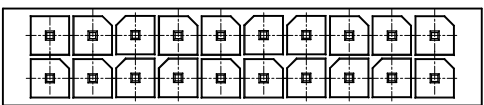

20 P

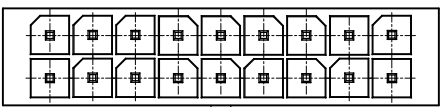

18 P



B

A

B

5

A

X-ON Electronics

Largest Supplier of Electrical and Electronic Components

Click to view similar products for [Power to the Board](#) category:

Click to view products by [Amphenol](#) manufacturer:

Other Similar products are found below :

[10131318-08512GRLF](#) [6450171-4](#) [6450552-7](#) [6600323-8](#) [6643429-1](#) [6646040-2](#) [6651939-1](#) [6766604-1](#) [120959-1](#) [1393557-2](#) [1393532-2](#)
[1393532-3](#) [1393532-4](#) [1393557-1](#) [1600812-5](#) [1-6450861-2](#) [1645595-1](#) [1743490-1](#) [1744132-7](#) [1761122-1](#) [1766169-1](#) [1766250-1](#) [18362](#)
[1892109-1](#) [1-967627-6](#) [2226808-1](#) [2-6450860-5](#) [2-6450860-6](#) [2-6450870-0](#) [93003-0502](#) [953552-1](#) [1-6450161-4](#) [1-6450850-6](#) [1645526-2](#) [1-](#)
[6600130-0](#) [1743419-1](#) [1766150-1](#) [2005243-2](#) [211110-1](#) [2-6600130-2](#) [TE34-12-16P-F0](#) [5-6450830-6](#) [5646956-4](#) [36662-0005](#) [40585-3000](#) [4-](#)
[6450830-9](#) [4-6600333-3](#) [51142-0214](#) [10134048-911LF](#) [10130248-005LF](#)