

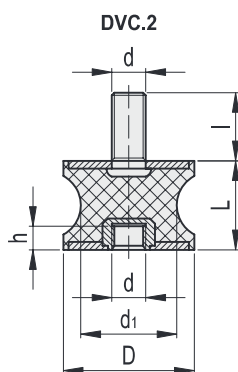

Machine elements

12



Conversion Table 1 mm = 0.039 inch			
L			
mm	inch	mm	inch
8	0.31	40	1.57
10	0.39	45	1.77
15	0.59	50	1.97
19	0.75	53	2.09
20	0.79	60	2.36
25	0.98	75	2.95
22	0.87	34	1.34
30	1.18	48	1.89
33.5	1.32		

DVC.2 - 10 - 8 - 10 - M4 - 10 - 55  
 D d1 L d l Shore A

DVC.2

Code	Description	D	L	d	d1	l	h	Max load [N]	Max. deflection [mm]	Stiffness [N/mm]
433901	DVC.2-10-8-10-M4-10-40	10	10	M4	8	10	4	94	2.5	37
433751	DVC.2-10-8-10-M4-10-55	10	10	M4	8	10	4	43	2.5	17
434051	DVC.2-10-8-10-M4-10-70	10	10	M4	8	10	4	81	2.5	32
433911	DVC.2-15-8,5-15-M4-10-40	15	15	M4	8,5	10	4	81	3.75	22
433761	DVC.2-15-8,5-15-M4-10-55	15	15	M4	8,5	10	4	132	3.75	35
434061	DVC.2-15-8,5-15-M4-10-70	15	15	M4	8,5	10	4	180	3.75	48
433916	DVC.2-15-12-15-M4-10-40	15	15	M4	12	10	4	132	3.75	35
433766	DVC.2-15-12-15-M4-10-55	15	15	M4	12	10	4	142	3.75	38
434066	DVC.2-15-12-15-M4-10-70	15	15	M4	12	10	4	191	3.75	51
433923	DVC.2-20-14-15-M6-18-40	20	15	M6	14	18	6	191	3.75	51
433773	DVC.2-20-14-15-M6-18-55	20	15	M6	14	18	6	247	3.75	66
434073	DVC.2-20-14-15-M6-18-70	20	15	M6	14	18	6	319	3.75	85
433925	DVC.2-20-14-19-M6-18-40	20	19	M6	14	18	6	319	4.75	67
433775	DVC.2-20-14-19-M6-18-55	20	19	M6	14	18	6	226	4.75	48
434075	DVC.2-20-14-19-M6-18-70	20	19	M6	14	18	6	278	4.75	59
433927	DVC.2-20-14-20-M6-18-40	20	20	M6	14	18	6	278	5	56
433777	DVC.2-20-14-20-M6-18-55	20	20	M6	14	18	6	223	5	45
434077	DVC.2-20-14-20-M6-18-70	20	20	M6	14	18	6	270	5	54
433931	DVC.2-21-16-22-M6-18-40	21	22	M6	16	18	6	270	5.5	49
433781	DVC.2-21-16-22-M6-18-55	21	22	M6	16	18	6	240	5.5	44
434081	DVC.2-21-16-22-M6-18-70	21	22	M6	16	18	6	314	5.5	57
433921	DVC.2-20-12-30-M6-18-40	20	30	M6	12	18	6	240	7.5	32
433771	DVC.2-20-12-30-M6-18-55	20	30	M6	12	18	6	147	7.5	20
434071	DVC.2-20-12-30-M6-18-70	20	30	M6	12	18	6	227	7.5	30
433929	DVC.2-20-14-30-M6-18-40	20	30	M6	14	18	6	328	7.5	44
433779	DVC.2-20-14-30-M6-18-55	20	30	M6	14	18	6	556	7.5	74
434079	DVC.2-20-14-30-M6-18-70	20	30	M6	14	18	6	236	7.5	32
433941	DVC.2-25-18-20-M6-18-40	25	20	M6	18	18	6	593	5	119
433791	DVC.2-25-18-20-M6-18-55	25	20	M6	18	18	6	631	5	126
434091	DVC.2-25-18-20-M6-18-70	25	20	M6	18	18	6	1038	5	208
433946	DVC.2-25-20-20-M6-18-40	25	20	M6	20	18	6	1038	5	208
433796	DVC.2-25-20-20-M6-18-55	25	20	M6	20	18	6	655	5	131
434096	DVC.2-25-20-20-M6-18-70	25	20	M6	20	18	6	1055	5	211
433956	DVC.2-30-22-20-M8-20-40	30	20	M8	22	20	8	655	5	131
433806	DVC.2-30-22-20-M8-20-55	30	20	M8	22	20	8	863	5	173
434106	DVC.2-30-22-20-M8-20-70	30	20	M8	22	20	8	1272	5	254
433951	DVC.2-30-18-25-M8-20-40	30	25	M8	18	20	8	1272	6.25	203
433801	DVC.2-30-18-25-M8-20-55	30	25	M8	18	20	8	510	6.25	82
434101	DVC.2-30-18-25-M8-20-70	30	25	M8	18	20	8	785	6.25	126
433966	DVC.2-35-31-15-M8-20-40	35	15	M8	31	20	8	785	3.75	209
433816	DVC.2-35-31-15-M8-20-55	35	15	M8	31	20	8	1310	3.75	349
434116	DVC.2-35-31-15-M8-20-70	35	15	M8	31	20	8	2453	3.75	654

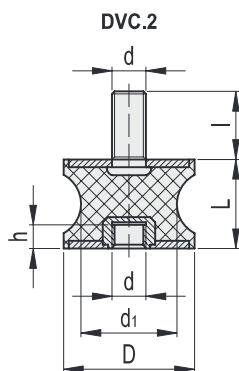

DVC.2 - 10 - 8 - 10 - M4 - 10 - 55  
 D d1 L d l Shore A

Conversion Table 1 mm = 0.039 inch			
L			
mm	inch	mm	inch
8	0.31	40	1.57
10	0.39	45	1.77
15	0.59	50	1.97
19	0.75	53	2.09
20	0.79	60	2.36
25	0.98	75	2.95
22	0.87	34	1.34
30	1.18	48	1.89
33.5	1.32		

DVC.2

Code	Description	D	L	d	d1	l	h	Max load [N]	Max. deflection [mm]	Stiffness [N/mm]
433961	DVC.2-35-25-34-M8-20-40	35	34	M8	25	20	8	2453	8.5	289
433811	DVC.2-35-25-34-M8-20-55	35	34	M8	25	20	8	1255	8.5	148
434111	DVC.2-35-25-34-M8-20-70	35	34	M8	25	20	8	1830	8.5	215
433975	DVC.2-40-30-25-M8-23-40	40	25	M8	30	23	8	1830	6.25	293
433825	DVC.2-40-30-25-M8-23-55	40	25	M8	30	23	8	2133	6.25	341
434125	DVC.2-40-30-25-M8-23-70	40	25	M8	30	23	8	2843	6.25	455
433973	DVC.2-40-25-30-M8-23-40	40	30	M8	25	23	8	2843	7.5	379
433823	DVC.2-40-25-30-M8-23-55	40	30	M8	25	23	8	1096	7.5	146
434123	DVC.2-40-25-30-M8-23-70	40	30	M8	25	23	8	1897	7.5	253
433979	DVC.2-40-33-30-M8-23-40	40	30	M8	33	23	8	1897	7.5	253
433829	DVC.2-40-33-30-M8-23-55	40	30	M8	33	23	8	1178	7.5	157
434129	DVC.2-40-33-30-M8-23-70	40	30	M8	33	23	8	2191	7.5	292
433971	DVC.2-40-20-48-M8-23-40	40	48	M8	20	23	8	2191	12	183
433821	DVC.2-40-20-48-M8-23-55	40	48	M8	20	23	8	583	12	49
434121	DVC.2-40-20-48-M8-23-70	40	48	M8	20	23	8	825	12	69
433977	DVC.2-40-32-50-M8-23-40	40	50	M8	32	23	8	825	12.5	66
433827	DVC.2-40-32-50-M8-23-55	40	50	M8	32	23	8	610	12.5	49
434127	DVC.2-40-32-50-M8-23-70	40	50	M8	32	23	8	930	12.5	74
433981	DVC.2-50-42-30-M10-28-40	50	30	M10	42	28	10	2843	7.5	379
433831	DVC.2-50-42-30-M10-28-55	50	30	M10	42	28	10	1281	7.5	171
434131	DVC.2-50-42-30-M10-28-70	50	30	M10	42	28	10	1782	7.5	238
433986	DVC.2-55-44-45-M10-28-40	55	45	M10	44	28	10	1782	11.25	158
433836	DVC.2-55-44-45-M10-28-55	55	45	M10	44	28	10	1066	11.25	95
434136	DVC.2-55-44-45-M10-28-70	55	45	M10	44	28	10	1554	11.25	138
433991	DVC.2-57-25-45-M10-28-40	57	45	M10	25	28	10	1554	11.25	138
433841	DVC.2-57-25-45-M10-28-55	57	45	M10	25	28	10	1055	11.25	94
434141	DVC.2-57-25-45-M10-28-70	57	45	M10	25	28	10	1430	11.25	127
433996	DVC.2-60-49-60-M10-28-40	60	60	M10	49	28	10	1430	15	95
433846	DVC.2-60-49-60-M10-28-55	60	60	M10	49	28	10	2560	15	171
434146	DVC.2-60-49-60-M10-28-70	60	60	M10	49	28	10	4428	15	295
434001	DVC.2-70-45-53-M12-37-40	70	53	M12	45	37	12	4428	13.25	334
433851	DVC.2-70-45-53-M12-37-55	70	53	M12	45	37	12	2219	13.25	168
434151	DVC.2-70-45-53-M12-37-70	70	53	M12	45	37	12	2473	13.25	187
434006	DVC.2-72-64-33,5-M12-37-40	72	33,5	M12	64	37	12	2473	8.375	295
433856	DVC.2-72-64-33,5-M12-37-55	72	33,5	M12	64	37	12	3364	8.375	402
434156	DVC.2-72-64-33,5-M12-37-70	72	33,5	M12	64	37	12	4879	8.375	583
434011	DVC.2-75-60-40-M12-37-40	75	40	M12	60	37	12	4879	10	488
433861	DVC.2-75-60-40-M12-37-55	75	40	M12	60	37	12	2819	10	282
434161	DVC.2-75-60-40-M12-37-70	75	40	M12	60	37	12	4224	10	422
434016	DVC.2-95-80-75-M16-41-40	95	75	M16	80	41	16	4224	18.75	225
433866	DVC.2-95-80-75-M16-41-55	95	75	M16	80	41	16	8873	18.75	473
434166	DVC.2-95-80-75-M16-41-70	95	75	M16	80	41	16	12712	18.75	678

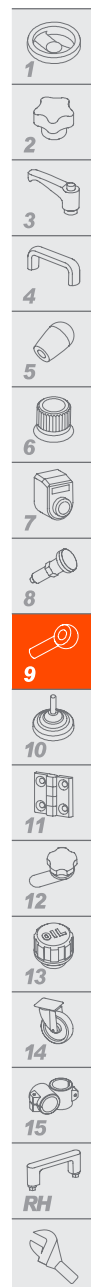

Machine elements

- 1
- 2
- 3
- 4
- 5
- 6
- 7
- 8
- 9
- 10
- 11
- 12
- 13
- 14
- 15
- RH
- 14

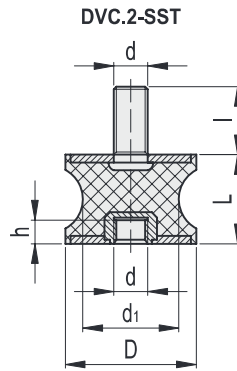

DVC.2 - 10 - 8 - 10 - SST - M4 - 10 - 55  
 D d1 L Stainless steel d l Shore A

Conversion Table 1 mm = 0.039 inch			
L			
mm	inch	mm	inch
8	0.31	40	1.57
10	0.39	45	1.77
15	0.59	50	1.97
19	0.75	53	2.09
20	0.79	60	2.36
25	0.98	75	2.95
22	0.87	34	1.34
30	1.18	48	1.89
33.5	1.32		

DVC.2-SST



Code	Description	D	L	d	d1	l	h	Max load [N]	Max. deflection [mm]	Stiffness [N/mm]
434201	DVC.2-10-8-10-SST-M4-10-55	10	10	M4	8	10	4	115	2.5	46
434211	DVC.2-15-8,5-15-SST-M4-10-55	15	15	M4	8,5	10	4	242	3.75	65
434216	DVC.2-15-12-15-SST-M4-10-55	15	15	M4	12	10	4	259	3.75	69
434223	DVC.2-20-14-15-SST-M6-18-55	20	15	M6	14	18	6	380	3.75	101
434225	DVC.2-20-14-19-SST-M6-18-55	20	19	M6	14	18	6	353	4.75	74
434227	DVC.2-20-14-20-SST-M6-18-55	20	20	M6	14	18	6	351	5	70
434231	DVC.2-21-16-22-SST-M6-18-55	21	22	M6	16	18	6	369	5.5	67
434221	DVC.2-20-12-30-SST-M6-18-55	20	30	M6	12	18	6	254	7.5	34
434229	DVC.2-20-14-30-SST-M6-18-55	20	30	M6	14	18	6	352	7.5	47
434241	DVC.2-25-18-20-SST-M6-18-55	25	20	M6	18	18	6	1558	5	312
434246	DVC.2-25-20-20-SST-M6-18-55	25	20	M6	20	18	6	1615	5	323
434256	DVC.2-30-22-20-SST-M8-20-55	30	20	M8	22	20	8	2346	5	469
434251	DVC.2-30-18-25-SST-M8-20-55	30	25	M8	18	20	8	1570	6.25	251
434266	DVC.2-35-31-15-SST-M8-20-55	35	15	M8	31	20	8	3762	3.75	1003
434261	DVC.2-35-25-34-SST-M8-20-55	35	34	M8	25	20	8	2826	8.5	332
434275	DVC.2-40-30-25-SST-M8-23-55	40	25	M8	30	23	8	3952	6.25	632
434273	DVC.2-40-25-30-SST-M8-23-55	40	30	M8	25	23	8	2628	7.5	350
434279	DVC.2-40-33-30-SST-M8-23-55	40	30	M8	33	23	8	2835	7.5	378
434271	DVC.2-40-20-48-SST-M8-23-55	40	48	M8	20	23	8	1314	12	109
434277	DVC.2-40-32-50-SST-M8-23-55	40	50	M8	32	23	8	1546	12.5	124
434281	DVC.2-50-42-30-SST-M10-28-55	50	30	M10	42	28	10	2657	7.5	354
434286	DVC.2-55-44-45-SST-M10-28-55	55	45	M10	44	28	10	2310	11.25	205
434291	DVC.2-57-25-45-SST-M10-28-55	57	45	M10	25	28	10	2065	11.25	184
434296	DVC.2-60-49-60-SST-M10-28-55	60	60	M10	49	28	10	5060	15	337
434301	DVC.2-70-45-53-SST-M12-37-55	70	53	M12	45	37	12	3777	13.25	285
434306	DVC.2-72-64-33,5-SST-M12-37-55	72	33,5	M12	64	37	12	8559	8.375	1022
434311	DVC.2-75-60-40-SST-M12-37-55	75	40	M12	60	37	12	8176	10	818
434316	DVC.2-95-80-75-SST-M16-41-55	95	75	M16	80	41	16	15518	18.75	828