

DVC.3 - 15 - 8.5 - 15 - M4 - 55  
 D d1 L d Shore A

Conversion Table 1 mm = 0.039 inch			
L			
mm	inch	mm	inch
8	0.31	40	1.57
10	0.39	45	1.77
15	0.59	50	1.97
19	0.75	53	2.09
20	0.79	60	2.36
25	0.98	75	2.95
22	0.87	34	1.34
30	1.18	48	1.89
33.5	1.32		

DVC.3

Code	Description	D	L	d	d1	h	Max load [N]	Max. deflection [mm]	Stiffness [N/mm]
434601	DVC.3-15-8,5-15-M4-40	15	15	M4	8,5	4	94	3.75	25
434501	DVC.3-15-8,5-15-M4-55	15	15	M4	8,5	4	155	3.75	41
434701	DVC.3-15-8,5-15-M4-70	15	15	M4	8,5	4	211	3.75	56
434606	DVC.3-15-12-15-M4-40	15	15	M4	12	4	155	3.75	41
434506	DVC.3-15-12-15-M4-55	15	15	M4	12	4	166	3.75	44
434706	DVC.3-15-12-15-M4-70	15	15	M4	12	4	223	3.75	60
434613	DVC.3-20-14-15-M6-40	20	15	M6	14	6	223	3.75	60
434513	DVC.3-20-14-15-M6-55	20	15	M6	14	6	289	3.75	77
434713	DVC.3-20-14-15-M6-70	20	15	M6	14	6	374	3.75	100
434615	DVC.3-20-14-19-M6-40	20	19	M6	14	6	374	4.75	79
434515	DVC.3-20-14-19-M6-55	20	19	M6	14	6	264	4.75	56
434715	DVC.3-20-14-19-M6-70	20	19	M6	14	6	326	4.75	69
434617	DVC.3-20-14-20-M6-40	20	20	M6	14	6	326	5	65
434517	DVC.3-20-14-20-M6-55	20	20	M6	14	6	261	5	52
434717	DVC.3-20-14-20-M6-70	20	20	M6	14	6	316	5	63
434621	DVC.3-21-16-22-M6-40	21	22	M6	16	6	316	5.5	57
434521	DVC.3-21-16-22-M6-55	21	22	M6	16	6	281	5.5	51
434721	DVC.3-21-16-22-M6-70	21	22	M6	16	6	367	5.5	67
434611	DVC.3-20-12-30-M6-40	20	30	M6	12	6	281	7.5	37
434511	DVC.3-20-12-30-M6-55	20	30	M6	12	6	172	7.5	23
434711	DVC.3-20-12-30-M6-70	20	30	M6	12	6	266	7.5	35
434619	DVC.3-20-14-30-M6-40	20	30	M6	14	6	383	7.5	51
434519	DVC.3-20-14-30-M6-55	20	30	M6	14	6	650	7.5	87
434719	DVC.3-20-14-30-M6-70	20	30	M6	14	6	277	7.5	37
434631	DVC.3-25-18-20-M6-40	25	20	M6	18	6	694	5	139
434531	DVC.3-25-18-20-M6-55	25	20	M6	18	6	738	5	148
434731	DVC.3-25-18-20-M6-70	25	20	M6	18	6	1214	5	243
434636	DVC.3-25-20-20-M6-40	25	20	M6	20	6	1214	5	243
434536	DVC.3-25-20-20-M6-55	25	20	M6	20	6	767	5	153
434736	DVC.3-25-20-20-M6-70	25	20	M6	20	6	1235	5	247
434643	DVC.3-30-22-20-M8-40	30	20	M8	22	8	767	5	153
434543	DVC.3-30-22-20-M8-55	30	20	M8	22	8	1010	5	202
434743	DVC.3-30-22-20-M8-70	30	20	M8	22	8	1488	5	298
434641	DVC.3-30-18-25-M8-40	30	25	M8	18	8	1488	6.25	238
434541	DVC.3-30-18-25-M8-55	30	25	M8	18	8	597	6.25	95
434741	DVC.3-30-18-25-M8-70	30	25	M8	18	8	919	6.25	147
434645	DVC.3-35-25-34-M8-40	35	34	M8	25	8	2871	8.5	338
434545	DVC.3-35-25-34-M8-55	35	34	M8	25	8	1469	8.5	173
434745	DVC.3-35-25-34-M8-70	35	34	M8	25	8	2141	8.5	252

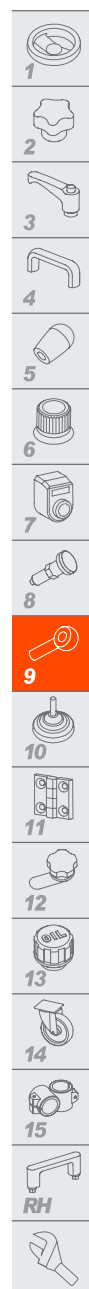

Machine elements

15



Conversion Table			
1 mm = 0.039 inch			
L			
mm	inch	mm	inch
8	0.31	40	1.57
10	0.39	45	1.77
15	0.59	50	1.97
19	0.75	53	2.09
20	0.79	60	2.36
25	0.98	75	2.95
22	0.87	34	1.34
30	1.18	48	1.89
33.5	1.32		

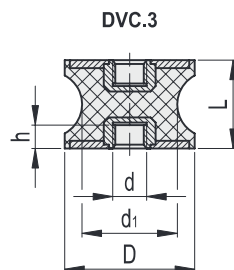

DVC.3 - 15 - 8.5 - 15 - M4 - 55  
 D d1 L d Shore A

DVC.3

Code	Description	D	L	d	d1	h	Max load [N]	Max. deflection [mm]	Stiffness [N/mm]
434655	DVC.3-40-30-25-M8-40	40	25	M8	30	8	2141	6.25	343
434555	DVC.3-40-30-25-M8-55	40	25	M8	30	8	2496	6.25	399
434755	DVC.3-40-30-25-M8-70	40	25	M8	30	8	3326	6.25	532
434653	DVC.3-40-25-30-M8-40	40	30	M8	25	8	3326	7.5	444
434553	DVC.3-40-25-30-M8-55	40	30	M8	25	8	1283	7.5	171
434753	DVC.3-40-25-30-M8-70	40	30	M8	25	8	2219	7.5	296
434659	DVC.3-40-33-30-M8-40	40	30	M8	33	8	2219	7.5	296
434559	DVC.3-40-33-30-M8-55	40	30	M8	33	8	1378	7.5	184
434759	DVC.3-40-33-30-M8-70	40	30	M8	33	8	2564	7.5	342
434657	DVC.3-40-32-50-M8-40	40	50	M8	32	8	2564	12.5	205
434557	DVC.3-40-32-50-M8-55	40	50	M8	32	8	682	12.5	55
434757	DVC.3-40-32-50-M8-70	40	50	M8	32	8	965	12.5	77
434651	DVC.3-40-20-48-M8-40	40	48	M8	20	8	965	12	80
434551	DVC.3-40-20-48-M8-55	40	48	M8	20	8	713	12	59
434751	DVC.3-40-20-48-M8-70	40	48	M8	20	8	1088	12	91
434656	DVC.3-50-42-30-M10-40	50	30	M10	42	10	3326	7.5	444
434556	DVC.3-50-42-30-M10-55	50	30	M10	42	10	1499	7.5	200
434756	DVC.3-50-42-30-M10-70	50	30	M10	42	10	2085	7.5	278
434661	DVC.3-55-44-45-M10-40	55	45	M10	44	10	2085	11.25	185
434561	DVC.3-55-44-45-M10-55	55	45	M10	44	10	1247	11.25	111
434761	DVC.3-55-44-45-M10-70	55	45	M10	44	10	1818	11.25	162
434666	DVC.3-57-25-45-M10-40	57	45	M10	25	10	1818	11.25	162
434566	DVC.3-57-25-45-M10-55	57	45	M10	25	10	1235	11.25	110
434766	DVC.3-57-25-45-M10-70	57	45	M10	25	10	1673	11.25	149
434671	DVC.3-60-49-60-M10-40	60	60	M10	49	10	1673	15	112
434571	DVC.3-60-49-60-M10-55	60	60	M10	49	10	2995	15	200
434771	DVC.3-60-49-60-M10-70	60	60	M10	49	10	5181	15	345
434676	DVC.3-70-45-53-M12-40	70	53	M12	45	12	5181	13.25	391
434576	DVC.3-70-45-53-M12-55	70	53	M12	45	12	2597	13.25	196
434776	DVC.3-70-45-53-M12-70	70	53	M12	45	12	2894	13.25	218
434681	DVC.3-72-64-33,5-M12-40	72	33,5	M12	64	12	2894	8.375	346
434581	DVC.3-72-64-33,5-M12-55	72	33,5	M12	64	12	3936	8.375	470
434781	DVC.3-72-64-33,5-M12-70	72	33,5	M12	64	12	5708	8.375	682
434686	DVC.3-75-60-40-M12-40	75	40	M12	60	12	5708	10	571
434586	DVC.3-75-60-40-M12-55	75	40	M12	60	12	3298	10	330
434786	DVC.3-75-60-40-M12-70	75	40	M12	60	12	4942	10	494
434691	DVC.3-95-80-75-M16-40	95	75	M16	80	16	4942	18.75	264
434591	DVC.3-95-80-75-M16-55	95	75	M16	80	16	10382	18.75	554
434791	DVC.3-95-80-75-M16-70	95	75	M16	80	16	14873	18.75	793

Machine elements

16

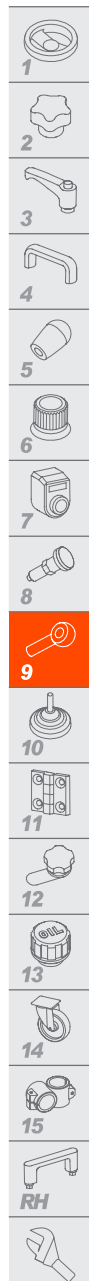

DVC.3 - 15 - 8,5 - 15 - SST - M4 - 55  
 D d1 L Stainless steel d Shore A

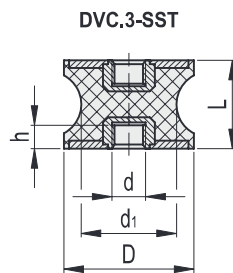

Conversion Table 1 mm = 0.039 inch			
L			
mm	inch	mm	inch
8	0.31	40	1.57
10	0.39	45	1.77
15	0.59	50	1.97
19	0.75	53	2.09
20	0.79	60	2.36
25	0.98	75	2.95
22	0.87	34	1.34
30	1.18	48	1.89
33.5	1.32		

DVC.3-SST



Code	Description	D	L	d	d1	h	Max load [N]	Max. deflection [mm]	Stiffness [N/mm]
434801	DVC.3-15-8,5-15-SST-M4-55	15	15	M4	8,5	4	283	3.75	76
434806	DVC.3-15-12-15-SST-M4-55	15	15	M4	12	4	303	3.75	81
434813	DVC.3-20-14-15-SST-M6-55	20	15	M6	14	6	445	3.75	119
434815	DVC.3-20-14-19-SST-M6-55	20	19	M6	14	6	413	4.75	87
434817	DVC.3-20-14-20-SST-M6-55	20	20	M6	14	6	411	5	82
434821	DVC.3-21-16-22-SST-M6-55	21	22	M6	16	6	431	5.5	78
434811	DVC.3-20-12-30-SST-M6-55	20	30	M6	12	6	297	7.5	40
434819	DVC.3-20-14-30-SST-M6-55	20	30	M6	14	6	412	7.5	55
434831	DVC.3-25-18-20-SST-M6-55	25	20	M6	18	6	1823	5	365
434836	DVC.3-25-20-20-SST-M6-55	25	20	M6	20	6	1889	5	378
434843	DVC.3-30-22-20-SST-M8-55	30	20	M8	22	8	2745	5	549
434841	DVC.3-30-18-25-SST-M8-55	30	25	M8	18	8	1837	6.25	294
434845	DVC.3-35-25-34-SST-M8-55	35	34	M8	25	8	3306	8.5	389
434855	DVC.3-40-30-25-SST-M8-55	40	25	M8	30	8	4624	6.25	740
434853	DVC.3-40-25-30-SST-M8-55	40	30	M8	25	8	3075	7.5	410
434859	DVC.3-40-33-30-SST-M8-55	40	30	M8	33	8	3317	7.5	442
434857	DVC.3-40-32-50-SST-M8-55	40	50	M8	32	8	1537	12.5	123
434851	DVC.3-40-20-48-SST-M8-55	40	48	M8	20	8	1808	12	151
434856	DVC.3-50-42-30-SST-M10-55	50	30	M10	42	10	3109	7.5	415
434861	DVC.3-55-44-45-SST-M10-55	55	45	M10	44	10	2702	11.25	240
434866	DVC.3-57-25-45-SST-M10-55	57	45	M10	25	10	2416	11.25	215
434871	DVC.3-60-49-60-SST-M10-55	60	60	M10	49	10	5920	15	395
434876	DVC.3-70-45-53-SST-M12-55	70	53	M12	45	12	4419	13.25	333
434881	DVC.3-72-64-33,5-SST-M12-55	72	33,5	M12	64	12	10014	8.375	1196
434886	DVC.3-75-60-40-SST-M12-55	75	40	M12	60	12	9566	10	957
434891	DVC.3-95-80-75-SST-M16-55	95	75	M16	80	16	18156	18.75	968