

SKINDICHT® RWV-M

SKINDICHT® RWV-M, corrosion-resistant, metric angled gland plastic/metal, sealed by incised sealing ring

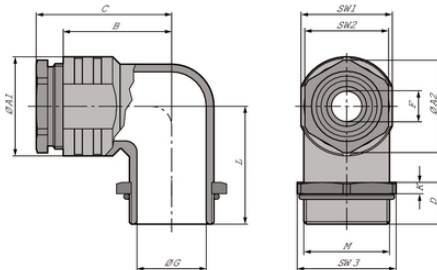

Temperature-resistant



Connector with standard housing unit



Space requirement



Corrosion-resistant

Benefits

Strain relief

Sealed by incised sealing ring

Corrosion-resistant

Decrease in installation height

Seawater-resistant

Application range

Angled glands are used in areas where cables have to run in parallel to the housing wall.

Electric motor manufacturing

Machine and equipment manufacturing

Plant engineering

Light and sound applications

Product Make-up

Metric connection thread acc. to DIN EN 60423

Basis for technical information DIN IEC 62444

SKINDICHT® RWV-M

Note

Counter nut to be used: SKINDICHT® SM-M

Technical Data

Classification ETIM 5:	ETIM 5.0 Class-ID: EC000441 ETIM 5.0 Class-Description: Cable screw gland
Classification ETIM 6:	ETIM 6.0 Class-ID: EC000441 ETIM 6.0 Class-Description: Cable screw gland
Material:	Body: zinc die-casting, nickel-plated Compression screw and hexagon nut: nickel-plated brass Incised sealing ring: CR/NBR O-ring: NBR
Protection rating:	IP 55
Temperature range:	-20°C to +100°C

Note

Photographs and graphics are not to scale and do not represent detailed images of the respective products.
Prices are net prices without VAT and surcharges. Sale to business customers only.

**SKINDICHT® RWV-M**

Article number	Article designation / size	Clamping range ØF (mm)	L	SW1	Ø A1	SW2	Ø A2	Ø G	Height (mm)	Overall length, C (mm)	Thread length, D (mm)	SW3
SKINDICHT® RWV-M												
52107800	M 12 x 1,5	5.0	20.5	14.0	16	12.0	13.2	8.0	5.0	26.1	11.5	17
52107810	M 16 x 1,5	9.0 - 3.0	23.5	18.0	20	16.0	17.6	12.0	5.0	28.6	11.5	22
52107820	M 20 x 1,5	13.0 - 4.0	28.5	22.0	24	20.0	22.2	15.0	5.0	35.1	12.5	27
52107830	M 25 x 1,5	17.5 - 8.5	31	27.0	29	25.0	27.5	20.0	5.0	38.1	13.5	32
52107840	M 32 x 1,5	25.0 - 16.0	33	34.0	36	32.0	35.2	27.0	5.0	44.6	13.5	41
52107850	M 40 x 1,5	32.0 - 23.0	43	42.0	45	40.0	43.5	35.0	5.0	53.1	15.5	46

Last Update (09.04.2018)

©2018 Lapp Group - Technical changes reserved

Product Management www.lappkabel.deYou can find the current technical data in the corresponding data sheet.
PN 0456 / 02_03.16