

# PT Connectors with Printed Circuit Board Contacts

## Box Mounting Receptacle (PT02) with PCB Contacts

Order by applicable part number in chart below; add insert arrangement number. Refer to insert availability on pages 4-10.

■ (MMC) located within .0025 of (TP)

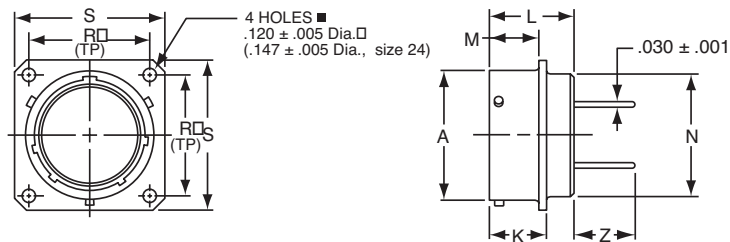

| Shell Size | Part Number*<br>PT02 with PCB<br>Contacts | Receptacle Front View |                     | Receptacle Side View |                     |           |                     |                   |                     |
|------------|---|-----------------------|---------------------|----------------------|---------------------|-----------|---------------------|-------------------|---------------------|
|            |   | R<br>(TP)             | S<br>+.011<br>-.010 | A<br>+.001<br>-.005  | K<br>+.021<br>-.010 | L<br>Max. | M<br>+.010<br>-.000 | N<br>Dia.<br>Max. | Z<br>+.040<br>-.050 |
| 6          | 71-570120-XXX                             | .469                  | .688                | .348                 | .493                | .825      | .431                | .323              | .380                |
| 8          | 71-570121-XXX                             | .594                  | .812                | .473                 | .493                | .825      | .431                | .449              | .380                |
| 10         | 71-570122-XXX                             | .719                  | .938                | .590                 | .493                | .825      | .431                | .573              | .380                |
| 12         | 71-570123-XXX                             | .812                  | 1.031               | .750                 | .493                | .825      | .431                | .699              | .380                |
| 14         | 71-570124-XXX                             | .906                  | 1.125               | .875                 | .493                | .825      | .431                | .823              | .380                |
| 16         | 71-570125-XXX                             | .969                  | 1.219               | 1.000                | .493                | .825      | .431                | .949              | .380                |
| 18         | 71-570126-XXX                             | 1.062                 | 1.312               | 1.125                | .493                | .825      | .431                | 1.073             | .380                |
| 20         | 71-570127-XXX                             | 1.156                 | 1.438               | 1.250                | .650                | 1.076     | .556                | 1.199             | .286                |
| 22         | 71-570128-XXX                             | 1.250                 | 1.562               | 1.375                | .650                | 1.076     | .556                | 1.323             | .286                |
| 24         | 71-570129-XXX                             | 1.375                 | 1.688               | 1.500                | .683                | 1.109     | .589                | 1.449             | .253                |

All dimensions for reference only.

## Jam Nut Receptacle (PT07) with PCB Contacts

All lockwire holes are .044 Dia. Min.

Order by applicable part number in chart below; add insert arrangement number. Refer to insert availability on pages 4-10.

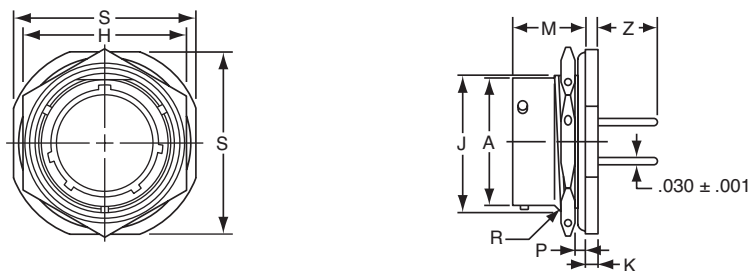

| Shell Size | Part Number*<br>PT07 with PCB<br>Contacts | Receptacle Front View |            | Receptacle Side View     |                          |                     |            |                      |      |                         |                     |
|------------|---|-----------------------|------------|--------------------------|--------------------------|---------------------|------------|----------------------|------|-------------------------|---------------------|
|            |   | H<br>+.017<br>-.016   | S<br>±.010 | A Dia.<br>+.001<br>-.005 | J Flat<br>+.000<br>-.010 | K<br>+.011<br>-.010 | M<br>±.010 | P Panel<br>Thickness |      | R<br>Thread<br>Class 2A | Z<br>+.025<br>-.035 |
|            |   |                       |            |                          |                          |                     |            | Min.                 | Max. |                         |                     |
| 6          | 71-533720-XXX                             | .625                  | .812       | .348                     | .405                     | .125                | .696       | .062                 | .125 | .4375-28 UNEF           | .376                |
| 8          | 71-533721-XXX                             | .750                  | .938       | .473                     | .530                     | .125                | .696       | .062                 | .125 | .5625-24 UNEF           | .376                |
| 10         | 71-533722-XXX                             | .875                  | 1.062      | .590                     | .655                     | .125                | .696       | .062                 | .125 | .6875-24 UNEF           | .376                |
| 12         | 71-533723-XXX                             | 1.062                 | 1.250      | .750                     | .818                     | .125                | .696       | .062                 | .125 | .8750-20 UNEF           | .376                |
| 14         | 71-533724-XXX                             | 1.188                 | 1.375      | .875                     | .942                     | .125                | .696       | .062                 | .125 | 1.0000-20 UNEF          | .376                |
| 16         | 71-533725-XXX                             | 1.312                 | 1.500      | 1.000                    | 1.066                    | .125                | .696       | .062                 | .125 | 1.1250-18 UNEF          | .376                |
| 18         | 71-533726-XXX                             | 1.438                 | 1.625      | 1.125                    | 1.191                    | .125                | .696       | .062                 | .125 | 1.2500-18 UNEF          | .376                |
| 20         | 71-533727-XXX                             | 1.562                 | 1.812      | 1.250                    | 1.316                    | .156                | .884       | .062                 | .250 | 1.3750-18 UNEF          | .367                |
| 22         | 71-533728-XXX                             | 1.688                 | 1.938      | 1.375                    | 1.441                    | .156                | .884       | .062                 | .250 | 1.5000-18 UNEF          | .367                |
| 24         | 71-533729-XXX                             | 1.816                 | 2.062      | 1.500                    | 1.566                    | .156                | .917       | .062                 | .250 | 1.6250-18 UNEF          | .334                |

All dimensions for reference only.

\* For RoHS compliance connectors with PCB contacts change "71"- to:  
"FL" designates conductive gray zinc nickel plating  
"93" designates black zinc cobalt plating

## X-ON Electronics

Largest Supplier of Electrical and Electronic Components

*Click to view similar products for [amphenol manufacturer](#):*

Other Similar products are found below :

[MS27473P14B18S](#) [GTS02R20-15P-025-116](#) [GTC030-40-68SZ-025-RDS-LC](#) [ACC02E28-51S-003-B30-LC](#) [TV06RL-13-35AD](#) [TV06RL-13-98BD](#) [TV06RL-13-35SD-LC](#) [TV06RL-13-35SD](#) [TV06RL-13-98SD-LC](#) [TV06RL-13-98SD](#) [TVP00RW-23-53AD](#) [100-007-213-002-001](#) [TV06RW-25-90AE](#) [97-3108B16S-5PW-417](#) [PT06J20-24SW](#) [97-3108B16S-4PY-417](#) [97-3108B16S-4PX-417](#) [97-3108B16S-5PY-417](#) [97-3108B16S-4PW-417](#) [CS-DSDMDB37MF-025](#) [97-3108B16S-5PZ-417](#) [TV06RW-25-46AE](#) [TVS07RF-21-16AA](#) [TVS07RF-21-39BA](#) [CF-5A9013-04N](#) [CF-6A4615-06N](#) [GTC02R32-17S-025-RDS](#) [GTC02R32-17S-025-RDS-LC](#) [GTC02R32-17S-025-LC](#) [PT06SE-24-61P\(LC\)](#) [GTC06-22-13SW](#) [GTC06-22-13SY](#) [GTS06G-36-10S](#) [GTC06-22-13S-025-B30-LC](#) [GTC06-22-13SW-025-LC](#) [GTC06-22-13SX-025-B30](#) [GTC06-22-13SZ-025](#) [GTC06-22-13SZ-025-LC](#) [GTC06-22-13S-025-LC](#) [GTC06-22-13SW-025-B30](#) [GTC06-22-13SW-025-B30-LC](#) [GTC06-22-13SX-025-B30-LC](#) [GTC06-22-13SX-025-LC](#) [GTC06-22-13SY-025-B30](#) [GTC06-22-13SY-025-B30-LC](#) [GTC06-22-13SY-025-LC](#) [GTC06-22-13SZ-025-B30](#) [GTC06-22-13SZ-025-B30-LC](#) [GTC06-22-13SW-025](#) [GTC06-22-13SX-025](#)