

- 1 STRAIN RELIEF TO BE ULTRASONICALLY WELDED TO HOUSING.
- 2 ASSEMBLES 8 POSN AND SMALLER WILL NOT BE MARKED.
- 3 NOTE DELETED.
- 4 "AMP", PART NO., AND DATE CODE MARKED (WHITE) 1.58±0.38[.062±.015] HIGH CHARACTERS IN AREA SHOWN.

CUSTOMER DRAWING		SCALE 1:1		SHEET 1 OF 2		REV J	
MATERIAL FLAME RETARDENT GLASS FILLED NYLON COLOR: BLACK		FINISH		WEIGHT		DRAWING NO	
DIMENSIONS: mm [INCHES]		TOLERANCES UNLESS OTHERWISE SPECIFIED:		APPLICATOR SPEC		RESTRICTED TO	
0 PLC ±		1 PLC ±		D. DUPLER		A2 00779	
1 PLC ±		2 PLC ±		PRODUCT SPEC		DRAWING NO	
2 PLC ±		3 PLC ±		NAME		102184	
3 PLC ±		4 PLC ±		P. SREMICICH		CAGE CODE	
4 PLC ±		ANGLES		F. BRANDBERG		DRAWING NO	
				CHK. SREMICICH		102184	
				DWN. SREMICICH		102184	
				APVD. SREMICICH		102184	
				TE Connectivity		102184	

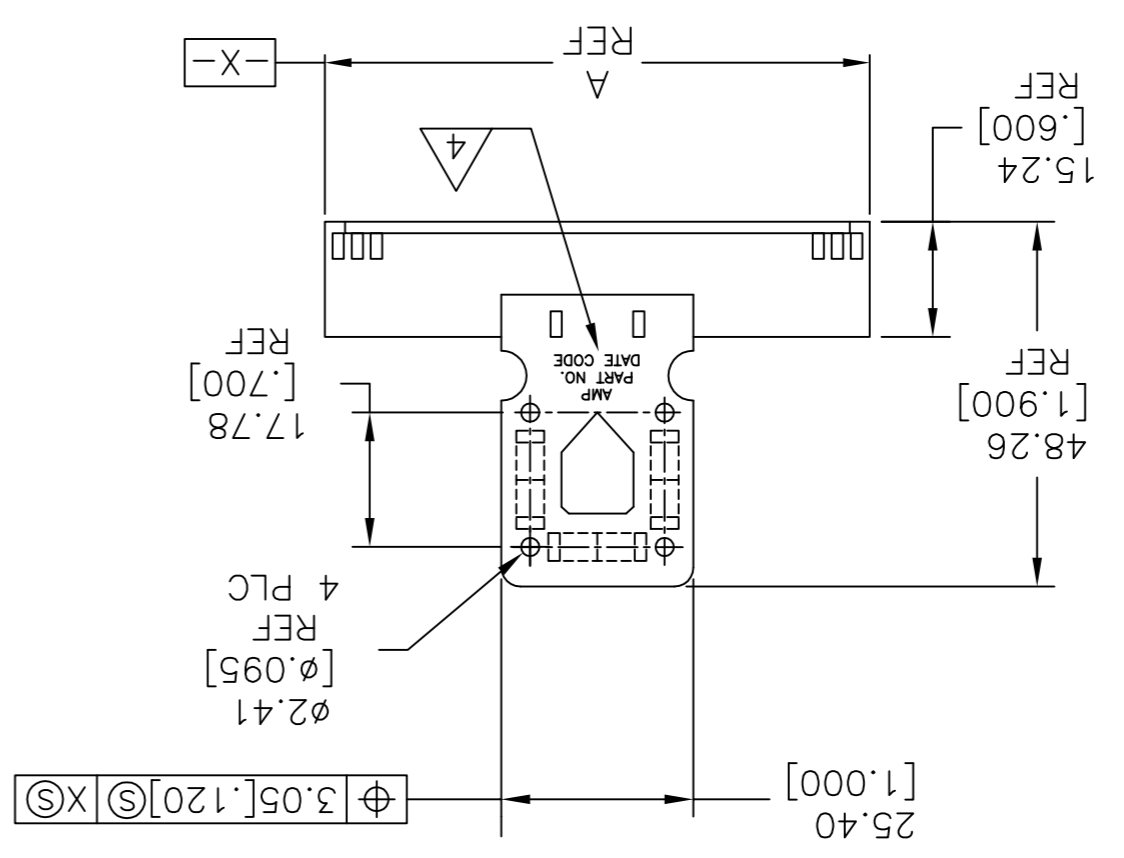
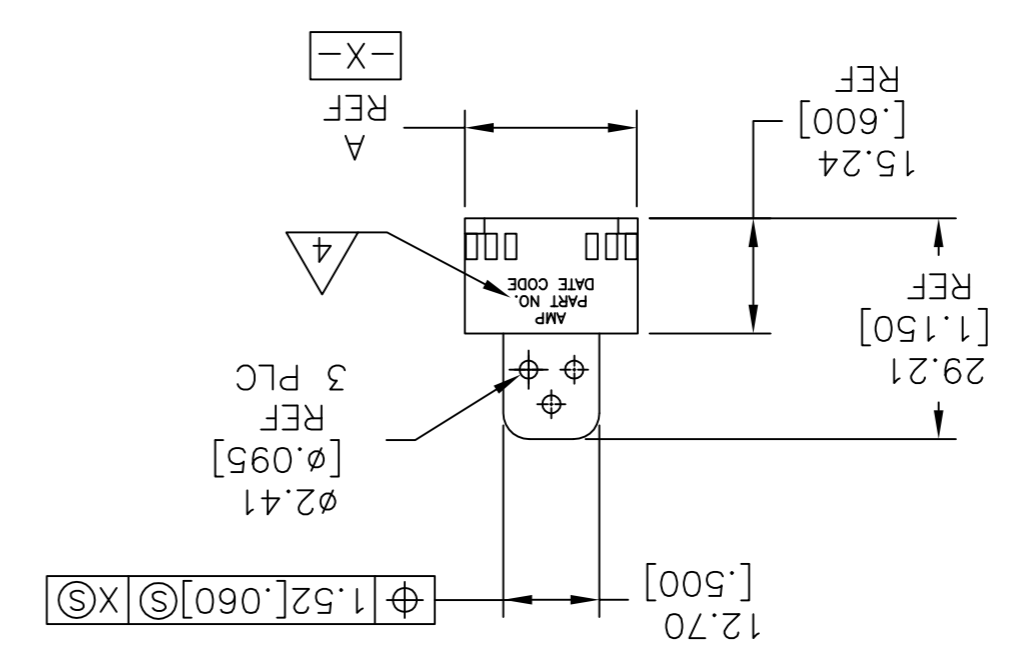
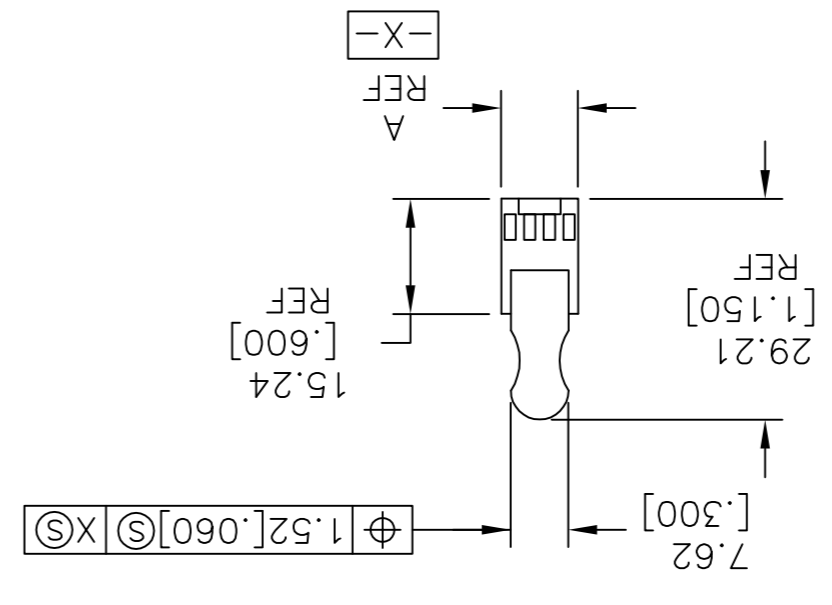
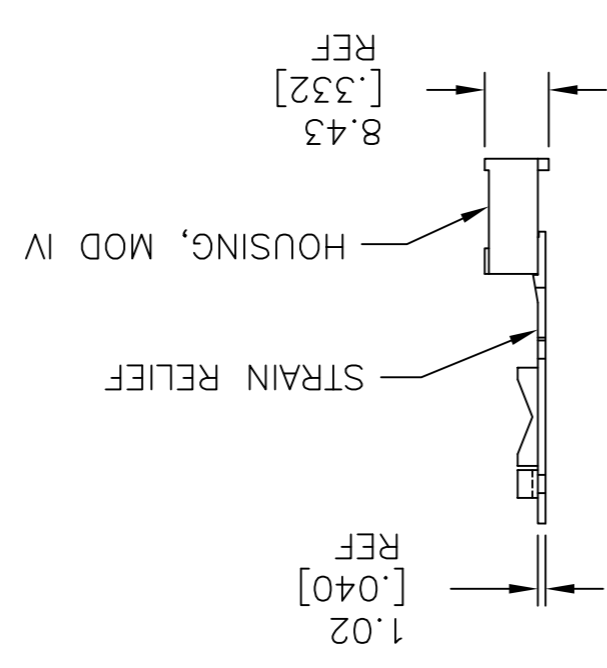
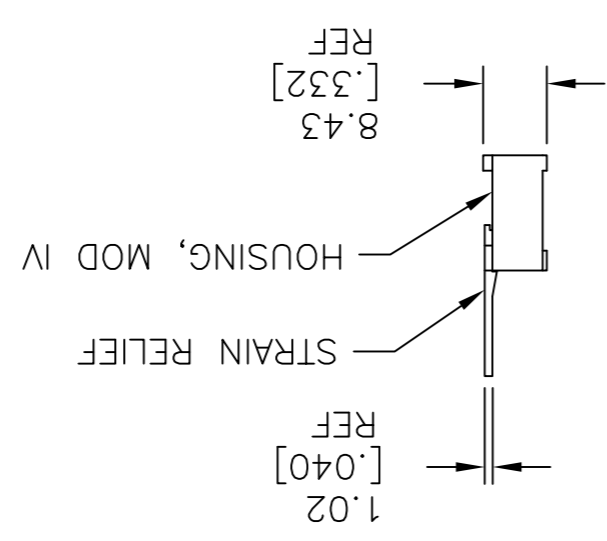
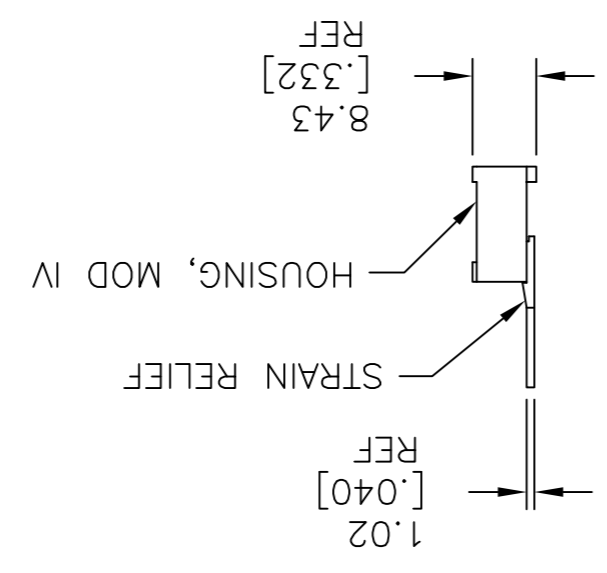

TYPE III

TYPE II

TYPE I

REV	DATE	DESCRIPTION	APVD
J	31OCT2017	REVISED PER ECO-17-015762	RS
H	30DEC96	OBS-8 PER 0010-0665-96	JH
P			DWN

1

2

3

4

MARKING	TYPE	∇	HOUSING PART NO.	NO. OF POSN.	PART NUMBER
NONE	I	81.28[3.200]	6-87977-2	64	6-102184-2
NONE	I	81.28[3.200]	6-87977-2	64	6-102184-1
NONE	I	73.66[2.900]	6-87977-0	58	6-102184-0
ALL	I	73.66[2.900]	6-87977-0	58	6-102184-9
NONE	I	73.66[2.900]	6-87977-0	58	6-102184-8
NONE	I	71.12[2.800]	5-87977-8	56	5-102184-7
ALL	I	71.12[2.800]	5-87977-8	56	5-102184-7
NONE	I	60.96[2.400]	5-87977-6	48	5-102184-6
ALL	I	60.96[2.400]	5-87977-6	48	5-102184-5
NONE	I	91.44[3.600]	5-87977-4	72	5-102184-4
NONE	I	88.90[3.500]	5-87977-3	70	5-102184-3
NONE	I	83.82[3.300]	5-87977-2	66	5-102184-2
NONE	I	76.20[3.000]	5-87977-1	60	5-102184-1
NONE	I	68.58[2.700]	5-87977-0	54	5-102184-0
NONE	I	66.04[2.600]	4-87977-9	52	4-102184-9
NONE	I	63.50[2.500]	4-87977-8	50	4-102184-8
NONE	I	55.88[2.200]	4-87977-7	44	4-102184-7
NONE	I	45.72[1.800]	4-87977-3	36	4-102184-6
NONE	I	53.34[2.100]	4-87977-6	42	4-102184-5
NONE	I	50.80[2.000]	4-87977-5	40	4-102184-4
NONE	I	48.26[1.900]	4-87977-4	38	4-102184-3
NONE	I	45.72[1.800]	4-87977-3	36	4-102184-2
NONE	I	43.18[1.700]	4-87977-2	34	4-102184-1
NONE	I	40.64[1.600]	4-87977-1	32	4-102184-0
NONE	I	38.10[1.500]	4-87977-0	30	4-102184-9
NONE	I	35.56[1.400]	3-87977-9	28	3-102184-8
NONE	I	33.02[1.300]	3-87977-8	26	3-102184-7
NONE	I	30.48[1.200]	3-87977-7	24	3-102184-6
NONE	I	27.94[1.100]	3-87977-6	22	3-102184-5
NONE	I	25.40[1.000]	3-87977-5	20	3-102184-4
NONE	I	22.86[.900]	3-87977-4	18	3-102184-3
NONE	II	20.32[.800]	3-87977-3	16	3-102184-2
NONE	II	17.78[.700]	3-87977-2	14	3-102184-1
NONE	II	15.24[.600]	3-87977-1	12	3-102184-0
NONE	II	12.70[.500]	3-87977-0	10	3-102184-9
NONE	II	10.16[.400]	2-87977-9	8	2-102184-8
NONE	III	7.62[.300]	2-87977-8	6	2-102184-7
NONE	III	7.62[.300]	2-87977-8	6	2-102184-6
NONE	I	83.82[3.300]	5-87977-2	66	2-102184-5
ALL	I	76.20[3.000]	5-87977-1	60	2-102184-4
ALL	I	68.58[2.700]	5-87977-0	54	2-102184-3
ALL	I	66.04[2.600]	4-87977-9	52	2-102184-2
ALL	I	63.50[2.500]	4-87977-8	50	2-102184-1
ALL	I	55.88[2.200]	4-87977-7	44	2-102184-0
ALL	I	53.34[2.100]	4-87977-6	42	1-102184-9
ALL	I	50.80[2.000]	4-87977-5	40	1-102184-8
ALL	I	48.26[1.900]	4-87977-4	38	1-102184-7
ALL	I	45.72[1.800]	4-87977-3	36	1-102184-6
ALL	I	43.18[1.700]	4-87977-2	34	1-102184-5
ALL	I	40.64[1.600]	4-87977-1	32	1-102184-4
ALL	I	38.10[1.500]	4-87977-0	30	1-102184-3
ALL	I	35.56[1.400]	3-87977-9	28	1-102184-2
ALL	I	33.02[1.300]	3-87977-8	26	1-102184-1
ALL	I	30.48[1.200]	3-87977-7	24	1-102184-0
ALL	I	27.94[1.100]	3-87977-6	22	102184-9
ALL	I	25.40[1.000]	3-87977-5	20	102184-8
ALL	II	22.86[.900]	3-87977-4	18	102184-7
ALL	II	20.32[.800]	3-87977-3	16	102184-6
ALL	II	17.78[.700]	3-87977-2	14	102184-5
ALL	II	15.24[.600]	3-87977-1	12	102184-4
ALL	II	12.70[.500]	3-87977-0	10	102184-3
ALL	III	10.16[.400]	2-87977-9	8	102184-2
ALL	III	7.62[.300]	2-87977-8	6	102184-1

MARKING	TYPE	∇	HOUSING PART NO.	NO. OF POSN.	PART NUMBER
NONE	II	15.24[.600]	3-87977-1	12	3-102184-1
NONE	II	12.76[.500]	3-87977-0	10	3-102184-0
NONE	III	10.16[.400]	2-87977-9	8	2-102184-9
NONE	III	7.62[.300]	2-87977-8	6	2-102184-8
ALL	I	91.44[3.600]	5-87977-4	72	2-102184-7
ALL	I	88.90[3.500]	5-87977-3	70	2-102184-6
ALL	I	83.82[3.300]	5-87977-2	66	2-102184-5
ALL	I	76.20[3.000]	5-87977-1	60	2-102184-4
ALL	I	68.58[2.700]	5-87977-0	54	2-102184-3
ALL	I	66.04[2.600]	4-87977-9	52	2-102184-2
ALL	I	63.50[2.500]	4-87977-8	50	2-102184-1
ALL	I	55.88[2.200]	4-87977-7	44	2-102184-0
ALL	I	53.34[2.100]	4-87977-6	42	1-102184-9
ALL	I	50.80[2.000]	4-87977-5	40	1-102184-8
ALL	I	48.26[1.900]	4-87977-4	38	1-102184-7
ALL	I	45.72[1.800]	4-87977-3	36	1-102184-6
ALL	I	43.18[1.700]	4-87977-2	34	1-102184-5
ALL	I	40.64[1.600]	4-87977-1	32	1-102184-4
ALL	I	38.10[1.500]	4-87977-0	30	1-102184-3
ALL	I	35.56[1.400]	3-87977-9	28	1-102184-2
ALL	I	33.02[1.300]	3-87977-8	26	1-102184-1
ALL	I	30.48[1.200]	3-87977-7	24	1-102184-0
ALL	I	27.94[1.100]	3-87977-6	22	102184-9
ALL	I	25.40[1.000]	3-87977-5	20	102184-8
ALL	II	22.86[.900]	3-87977-4	18	102184-7
ALL	II	20.32[.800]	3-87977-3	16	102184-6
ALL	II	17.78[.700]	3-87977-2	14	102184-5
ALL	II	15.24[.600]	3-87977-1	12	102184-4
ALL	II	12.70[.500]	3-87977-0	10	102184-3
ALL	III	10.16[.400]	2-87977-9	8	102184-2
ALL	III	7.62[.300]	2-87977-8	6	102184-1

THIS DRAWING IS A CONTROLLED DOCUMENT.

APPROVED: E. BRANDBERG 6-20-94
 CHECKED: P. SREMOICICH 6-20-94
 NAME: D. DUPLER 6-20-94

TE Connectivity

HOUSING ASSEMBLY, MOD IV,
 2.54[.100] X 2.54[.100] ⌀
 W/POLARIZATION AND STRAIN RELIEF

RESTRICTED TO: []

SCALE: 1:1 SHEET 2 OF 2 REV J

CUSTOMER DRAWING

REV	DATE	DESCRIPTION	APVD
-	-	SEE SHEET 1	-

THIS DRAWING IS UNPUBLISHED. RELEASED FOR PUBLICATION. ALL RIGHTS RESERVED. © COPYRIGHT - TE Connectivity

X-ON Electronics

Largest Supplier of Electrical and Electronic Components

Click to view similar products for [Headers & Wire Housings](#) category:

Click to view products by [TE Connectivity](#) manufacturer:

Other Similar products are found below :

[95000-104TRLF](#) [10135584-644402LF](#) [DF62W-EP2022PCA](#) [95000-106TRLF](#) [DF62W-2022SCA](#) [DF62W-EP2022PC](#) [2203348](#) [DF62W-2022SC](#) [1084018](#) [1029039](#) [1084017](#) [802-10-012-10-002000](#) [1112640](#) [1112639](#) [000-34000](#) [0009482033](#) [0009507031](#) [57102-S06-03LF](#) [57202-S52-04LF](#) [PCN6-15S-2.5E](#) [0039019024](#) [58102-G61-06LF](#) [582553-1](#) [0009485154](#) [0009508121](#) [0022285053](#) [0050291907](#) [018731A](#) [LY20-4P-DT1-P1E-BR](#) [02.125.8002.8](#) [60101931](#) [60598-1 \(Cut Strip\)](#) [M1625-3R/100](#) [61062-3](#) [61082-181009](#) [636-1427](#) [638009-1](#) [641938-9](#) [641991-4](#) [644168-1](#) [647662-1](#) [65039-019ELF](#) [65817-002LF](#) [65817-015LF](#) [65863-015LF](#) [66207-023LF](#) [67016-026LF](#) [67046-001LF](#) [67095-007LF](#) [67230-005LF](#)