

THIS COPY IS PROVIDED ON A RESTRICTED BASIS AND IS NOT TO BE USED IN ANY WAY DETRIMENTAL TO THE INTERESTS OF PANDUIT CORP.

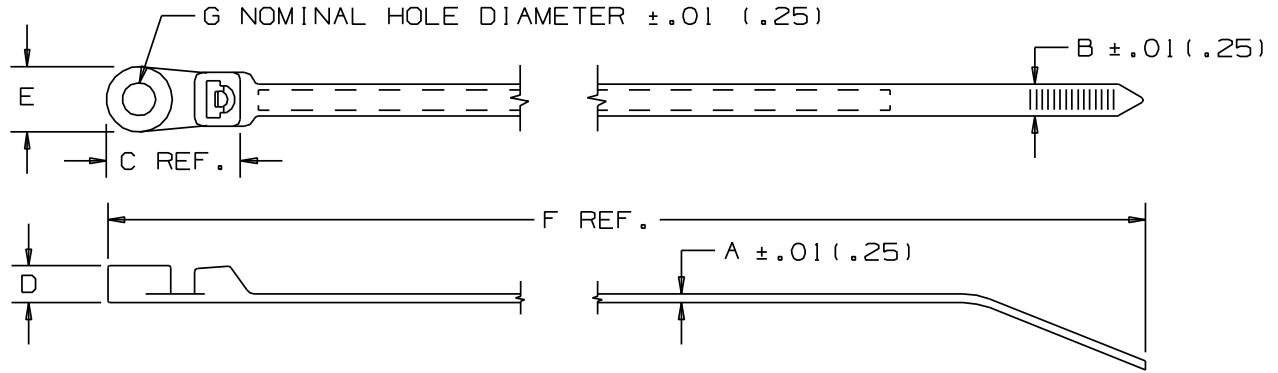
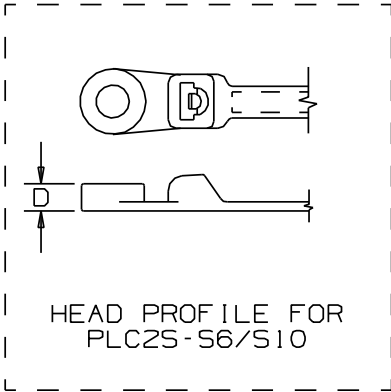

| PANDUIT PART NO. | BUNDLE DIA. | | A In (mm) | B In (mm) | C In (mm) | D In (mm) | E In (mm) | F In (mm) | G In (mm) | MIN. LOOP TENSILE lbs (N) | CROSS- SECTION | RECM. FASTENER | WEIGHT lbs/100pcs (g) |
|---------------------|-----------------|-----------------|-----------------|-----------------|-----------------|-----------------|-----------------|-----------------|-----------------|---------------------------------|-------------------|--------------------|-----------------------------|
| | MIN. In (mm) | MAX. In (mm) | | | | | | | | | | | |
| PLC1M-S4 | .06 (1.5) | .75 (19) | .045 (1.1) | .100 (2.5) | .542 (13.8) | .153 (3.9) | .239 (6.1) | 4.3 (109.2) | .122 (3.1) | 18 (80) | MINIATURE | #4 (M2.5) SCREW | .08 (36) |
| PLC1.5I-S8 | .06 (1.5) | 1.25 (32) | .045 (1.1) | .135 (3.4) | .694 (17.6) | .166 (4.2) | .335 (8.5) | 6.1 (154.9) | .174 (4.4) | 40 (178) | INTERMEDIATE | #8 (M4) SCREW | .18 (82) |
| PLC25-S6 | .06 (1.5) | 1.84 (47) | .047 (1.2) | .190 (4.8) | .765 (19.4) | .160 (4.1) | .373 (9.5) | 7.9 (200.7) | .148 (3.8) | 50 (222) | STANDARD | #6 (M3) SCREW | .32 (145) |
| PLC25-S10 | .06 (1.5) | 1.84 (47) | .047 (1.2) | .190 (4.8) | .765 (19.4) | .160 (4.1) | .373 (9.5) | 7.9 (200.7) | .200 (5.1) | 50 (222) | STANDARD | #10 (M5) SCREW | .32 (145) |
| PLC35-S10 | .06 (1.5) | 3.00 (76) | .052 (1.3) | .190 (4.8) | .765 (19.4) | .220 (5.6) | .373 (9.5) | 12 (304.8) | .200 (5.1) | 50 (222) | STANDARD | #10 (M5) SCREW | .50 (227) |
| PLC45-S10 | .06 (1.5) | 4.00 (102) | .052 (1.3) | .190 (4.8) | .765 (19.4) | .220 (5.6) | .373 (9.5) | 15 (381.0) | .200 (5.1) | 50 (222) | STANDARD | #10 (M5) SCREW | .59 (268) |

NOTES:

*1) SEE www.panduit.com FOR CURRENT PART NUMBER SUFFIX DESIGNATION AND FOR PACKAGE SIZE AND PART COLOR.

DIMENSIONS IN PARENTHESES ARE IN METRIC UNITS

PAN-TY LOCKING CLAMP TIE - PLC SERIES

CUSTOMER DRAWING

ITEM REVISION NAME

W10001EH/00

DATASET FILE NAME

W10001EH/00-SS-2724_REV19

UNLESS OTHERWISE SPECIFIED,
DIMENSIONAL TOLERANCES ARE: IN | mm |

.X.X | ... | .XXX | .020 | .5 | |
.XX | .02 | .5 | | ANGLES | ... |



THIRD ANGLE
PROJECTION

MATERIAL:

NYLON 6.6

DRAWING NUMBER:

SS-2724

D101000A/16

| REV | DATE | BY | CHK | APR | DESCRIPTION | ECN | DRAWN BY | DATE | CHK | SCALE | SHT 1 OF 1 | SIZE |
|-----|---------|-----|-----|------|---|------------|----------|---------|-----|-------|------------|------|
| 19 | 8/13/13 | BWG | KJM | RTFI | UPDATED TITLE BORDER, REVISED NOTES. SEE ECN FOR DETAILS. | SS-2724/19 | L.V./AJC | 2-11-71 | HVP | NONE | | A |

X-ON Electronics

Largest Supplier of Electrical and Electronic Components

Click to view similar products for [Cable Ties](#) category:

Click to view products by [Panduit](#) manufacturer:

Other Similar products are found below :

[20093-0](#) [SJ-3463](#) [SJ3518FR-1x50](#) [SJ3526N-Beige-2"x50yd](#) [SJ3526N BLACK 58" X 50YD](#) [SJ3571](#) [SJ-3571-1"x50yd-Black](#) [20113-0](#)
[T56137](#) [3-350087-0](#) [CTB75X75BKA-C](#) [3722](#) [561-B110120](#) [561-EZAB580T](#) [561-EZS375B40](#) [561-N3510](#) [561-TA250125](#) [08350-0](#) [08443-0](#)
[08600-0](#) [10035-0](#) [10036-0](#) [10037-0](#) [10325-0](#) [10362-0](#) [10606-0](#) [561-EZ250](#) [561-EZ500](#) [561-EZ625](#) [561-EZ750](#) [561-TA00600](#) [SJ3519FR](#)
[BLACK 1X50](#) [SJ3527N-Beige-2"x50yd](#) [SJ3527N-LOOP-BLACK-1](#) [SJ3572-2"x50yd-Black](#) [157-00039](#) [3719](#) [SJ-3401 BLACK 1"](#) [08445-0](#)
[08582-0](#) [08386-0](#) [10431-0](#) [08359-0](#) [10056-0](#) [10620-0](#) [10345-0](#) [10344-0](#) [08416-0](#) [08384-0](#) [08401-0](#)