

NOTES:

1. ALL DIMENSIONS ARE IN INCHES [MILLIMETERS] [GRAMS] LBS

2. DIMENSIONS APPEARING IN TABLE ARE AS FOLLOWS:

a AS SUPPLIED
b AFTER UNRESTRICTED RECOVERY

3. COATING (ADHESIVE) IS OPTIONAL AS SUPPLIED DIMENSIONS APPEARING IN TABLE ARE FOR UNCOATED PARTS.

DIAMETERS WILL BE REDUCED BY .06 MAX. WHEN COATING IS ADDED, ENTRY MOLDING PORTS ARE OPTIONAL.

4. WHEN -00 MODIFICATION NUMBER IS SPECIFIED MOLDING PORTS WILL BE LOCATED AS SHOWN.

ON SIZES 222A111 AND 222A121 THE 0.18 INCH DIAMETER MOLDING PORT AT "T" WILL BE ELIMINATED. THE 0.12" DIA MOLDING PORT WILL BE ENLARGED TO 0.18 INCHES

5. WEIGHT SHOWN IN TABLE OF DIMENSIONS IS BASED ON POLYOLEFIN PART

6. ORDERING INFORMATION

222A1XX -XX -XX /XXX /0

BASE PART NUMBER

MATERIAL DASH NUMBER

-3 POLYOLEFIN, SEMI RIGID (RT-301)

-4 POLYOLEFIN, FLEXIBLE (RT-1304)

-5 ELASTOMER, FLEXIBLE (RT-501)

-6 SILICONE (RT-602)

-12 FLUORO ELASTOMER, FLEXIBLE (RT-1312)

-25 ELASTOMER, FLUID RESISTANT (RW-2070)

-100 POLYOLEFIN, SEMI-FLEXIBLE ZEROHAL (RT-1323)

MODIFICATION NUMBER

ADHESIVE SLASH NUMBER

SEE COMPATIBILITY CHART BELOW

COLOR DESIGNATOR

IF THIS DOCUMENT IS PRINTED IT BECOMES UNCONTROLLED. CHECK FOR THE LATEST REVISION.

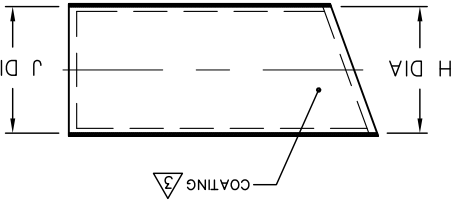

AS SUPPLIED

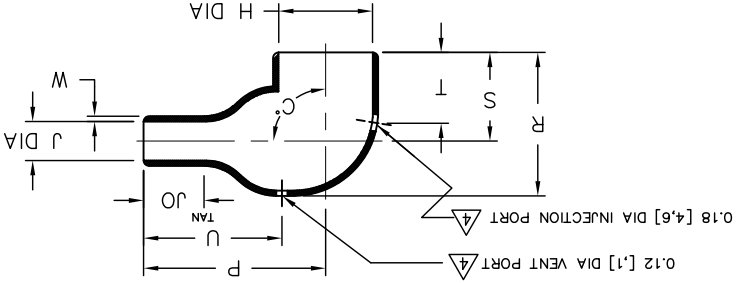

AFTER UNRESTRICTED RECOVERY

TABLE OF DIMENSIONS

PART DESCRIPTION	H		J		P	R	S	T	U	JO	W	C.	
	MIN	MAX	MIN	MAX	MIN	MAX	MIN	MAX	MIN	MAX	MIN	MAX	REF
222A111	.70	.31	.70	.39	.15	.68	.79	.61	N/A	.45	.17	.04	.002
222A121	.98	.40	.98	.21	.84	.89	.65	.58	N/A	.23	.53	.05	.003
222A132	1.18	.56	1.18	.81	1.25	1.06	1.05	.73	.75	.70	.28	.06	.006
222A142	1.28	.68	1.28	.27	1.44	1.20	1.20	.81	.75	.98	.40	.07	.014
222A152	1.42	.86	1.42	.33	1.72	1.38	.90	.75	1.18	.50	.07	.019	.019
222A163	1.73	1.08	1.73	.37	2.11	1.73	1.15	.75	1.34	.68	.08	.029	.029
222A174	2.09	1.33	2.09	.59	2.98	2.08	1.34	1.00	2.10	1.26	.13	.077	.077
222A185	2.66	1.74	2.66	.80	3.84	2.60	1.66	1.00	2.80	1.60	.15	.143	.143
222A196	3.45	2.18	3.45	1.28	5.04	3.12	1.93	1.00	3.45	2.22	.18	.310	.310

CUSTOMER DRAWING

UNLESS OTHERWISE SPECIFIED DIMENSIONS ARE IN INCHES. METRIC DIMENSIONS ARE IN BRACKETS.

APPROVED: YUNGUEN

TE CONNECTIVITY RESERVES THE RIGHT TO PRODUCT FOR THEIR APPLICATION. THIS DRAWING AT THE USERS RISK SHOULD EVALUATE THE SIMILARITY OF THE PART TO THE ORIGINAL.

TE CONNECTIVITY RESERVES THE RIGHT TO PRODUCT FOR THEIR APPLICATION. THIS DRAWING AT THE USERS RISK SHOULD EVALUATE THE SIMILARITY OF THE PART TO THE ORIGINAL.

© 2015 Tyco Electronics Corporation. TE Connectivity LLC Company. All rights reserved.

DO NOT SCALE THIS DRAWING

SHEET 1 OF 1

222A111 thru 196

06090

TE CONNECTIVITY

305 Constitution Dr
Menlo Park, CA 94025

THIRD ANGLE PROJECTION

DRAWN

APPROVED

TITLE: BOOT, 90 DEGREE, THIN WALL

SIZE: B

CODE IDENT. NO. DWG. NO.

COMPATIBILITY CHART

MATERIAL DASH NO.	ADHESIVE (COATING) SLASH NO.	S
-3; -4	/42; /86	S-1017; S-1048;
-5	/42	S-1017
-6; -12	NOT APPLICABLE	N/A
-25	/42; /86; /225	S-1017; S-1048; S-1206
-100	/86; /180; /184	S-1017; S-1030

X-ON Electronics

Largest Supplier of Electrical and Electronic Components

Click to view similar products for [Cable Boots](#) category:

Click to view products by [TE Connectivity](#) manufacturer:

Other Similar products are found below :

[618235-000](#) [622A014-3-0](#) [CX4132-000](#) [879103-4](#) [879515-000](#) [889092](#) [982033-2](#) [R280576000](#) [1300830729](#) [MTPSRBCL-C](#) [1811481-1](#)
[200W531-3-0](#) [202A121-386-0](#) [202A142-4-00/42-0](#) [202A163-4-0-CS5067](#) [202B221-13-0](#) [202B231-13-0](#) [202B563-25-07-0](#)
[202C621710CS5361](#) [202D132-4-07/42-0](#) [202D221-4-0-CS5349](#) [202D221-4-26-0](#) [202D263-25-08-0](#) [202D263-4-22/42-0](#) [202D263-4-88-0](#)
[202D921-2542-0](#) [202E336-71-0](#) [202F211-50-22-0-CS8474](#) [202F242-50-05-0](#) [202F242-51-04/164-0](#) [202K121-25-CS-1858-0](#) [202K121-25-](#)
[CS-2062-0](#) [202K132-25-01/225-0CS8387](#) [202K153-3-0186-0](#) [202S132-25-UP-0](#) [203W301-3/42-0](#) [207W613-100/184-0-CS5657](#) [207W623-](#)
[100-01/184-0](#) [207W634-100/184-0-CS5657](#) [207W656-100-01/184-0](#) [207W667-100-01/184-0](#) [207W667-100/184-0](#) [208A011-3-0](#) [208A021-3-](#)
[0](#) [221A011-51164-0-CS7133](#) [222A121-2586](#) [222A152-342-0](#) [222A213-25-0-CS5613](#) [222D221-25-13/86-0](#) [222D232-4-61-0-CS5078](#)