

PC card drilling dimensions(after plating)
(thickness 1.60±0.20mm)

Part Number & Date Code Printing

| SHELL | A±0.38 | B±0.12 | C±0.10 | D±0.25 | Plating: 0.76» AU | Plating: Flash AU |
|-------|--------|--------|--------|--------|-------------------|-------------------|
| 09 | 30.81 | 24.99 | 16.96 | 16.21 | D09S13B6G*00** | D09S13B4G*00** |
| 15 | 39.14 | 33.32 | 25.18 | 24.54 | D15S13B6G*00** | D15S13B4G*00** |
| 25 | 53.03 | 47.04 | 39.12 | 38.25 | D25S13B6G*00** | D25S13B4G*00** |
| 37 | 69.32 | 63.50 | 55.68 | 54.71 | D37S13B6G*00** | D37S13B4G*00** |

Threaded ØT M3 = L
Threaded ØT 4.40 = X
LF FOR LEAD FREE

REQUIREMENTS

Technical characteristics:
 Shell: steel tin plated
 Insulators: self-extinguishing black polyster, ULclass94V0
 Contacts size 20: brass, gold 0.76» on mating end, bright tin on termination end over nickel on entire contact
 Cycles : 200 for plating 4
 500 for plating 6
 Harpoons: phosphor bronze, tin plated
 Metal plate for electrical continuity: brass, tin plated
 Nuts: brass, tin plated
Electrical characteristics:
 max. current rating: 5A
 Test voltage: 1000V
 Rated voltage: 300V
 Contact resistance: ?15m?
 Shell resistance: ?5m?
 Insulation resistance: *5000M?
Climatic characteristics:
 Operating temperature range: -55°c +125°c
Dimensions:
 in accordance with MIL-C-24308

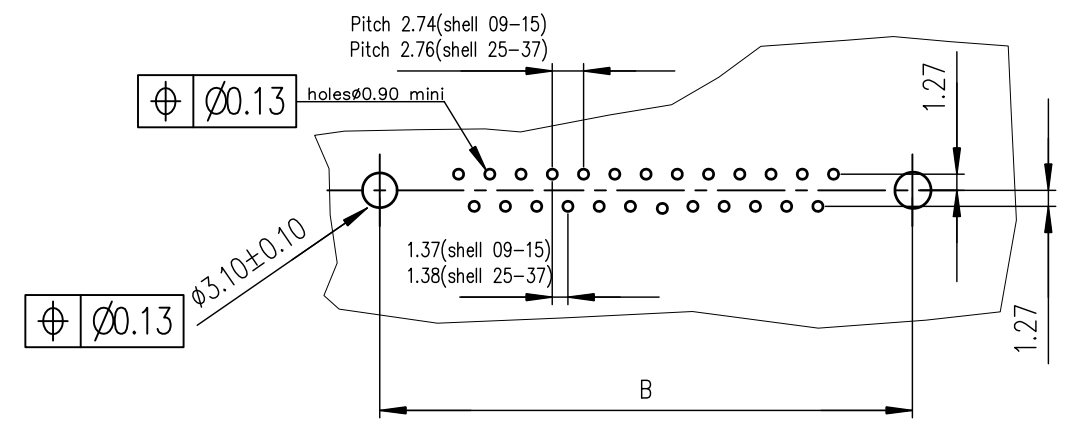

FOR ROHS DETAILS REFER DWG.NO: C01-8646-0000

| | | | | | | | | | |
|-------------|--------------|----------|-------------|---------------------------------------|--------|------------|--|-------------------------------------|--|
| mat'l. code | | surface | | tolerance | | projection | | product family | |
| SEE.NOTES | | ISO 1302 | | ISO 406 ISO 1101 | | MM | | D-SUB | |
| ltr | ecn no | dr | date | tolerances unless otherwise specified | | MM | | title | |
| D | I05-0124 | JS | 2005/07/27 | angles | linear | MM | | SOCKET CONNECT.DELTA-D RIGHT ANGLED | |
| E | I05-0074 | SK | 2006/05/08 | | | MM | | WITH NUT, HARPOON & METAL PLATE | |
| F | ELXI-I-15060 | AB | 2013/06/25 | X±1° | | scale 1:1 | | | |
| | | dr | JOHN.SLEEBA | 1994/08/01 | | FCJ | | dwg no | |
| | | enr | ALIAS.BABU | 2013/06/25 | | | | sheet 1 of 1 | |
| | | chr | MITHUN.PAUL | 2013/06/25 | | | | size | |
| | | appd | BIJU.K.PAUL | 2013/06/25 | | | | A3 | |
| sheet index | | revision | F | | | | | type | |
| sheet | | 1 | | | | | | CUSTOMER Drawing | |

X-ON Electronics

Largest Supplier of Electrical and Electronic Components

Click to view similar products for [D-Sub Standard Connectors](#) category:

Click to view products by [Amphenol](#) manufacturer:

Other Similar products are found below :

[DCM37S732N](#) [DAM15P500](#) [DEV09S364GTLF](#) [DEM09P032N](#) [DDM50P732N](#) [DAM15S332N](#) [173109-2218](#) [173109-2466](#) [173109-2436](#)
[173109-2435](#) [56F706-005-LI](#) [56F711-015](#) [015-0341-000](#) [015-0372-008](#) [015-8544-011](#) [017041-0005](#) [020419-0104](#) [012-0515-000](#) [012-9507-](#)
[034](#) [012-9507-114](#) [012-9534-001](#) [020745-0008](#) [609-25P](#) [M24308/2-23Z](#) [M243082310F](#) [M243082410F](#) [M243082411F](#) [M24308/4-21](#)
[CT1A18-11PSA206](#) [CT1N36-5SC](#) [CT2-16S-17PS](#) [CT2-20-15PCAU](#) [CT2-24-12PS](#) [CT2-24-28PSF127A206](#) [CT2-32-9PC](#) [CT6F9767-14-4-](#)
[14S-5PC](#) [CT6FA10SL-4PS](#) [CT7-18-10SC](#) [CT7-18-10SCAU](#) [CT7-18-12SCAU](#) [CT7-18-1PC](#) [CT7-18-1PCAU](#) [CT7-18-21SCAU](#) [M83513/01-](#)
[FC](#) [M83723/76W24619 L/C](#) [M85049/48-3-2F](#) [69001-865](#) [6STD09PCM99B70X](#) [6STD09SCM99B30X](#) [6STD09SCT99S40X](#)