

PRODUCT NUMBER
65039-YXX(E)LF

DESIGN CODE
0 = STANDARD
2 = OPTIONAL RIB
SEE SHEET 2

PIN STYLE
SEE SHEET 2

INDICATES THE PRODUCT IS ROHS COMPLIANT, SEE NOTE 6

65039-YXXLF OR 65039-YXXELF ARE EXACTLY THE SAME PRODUCTS.

EXTENSION "E" JUST FOR OLD EUROPEAN DESIGN AND MANUFACTURING SITE

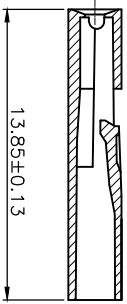
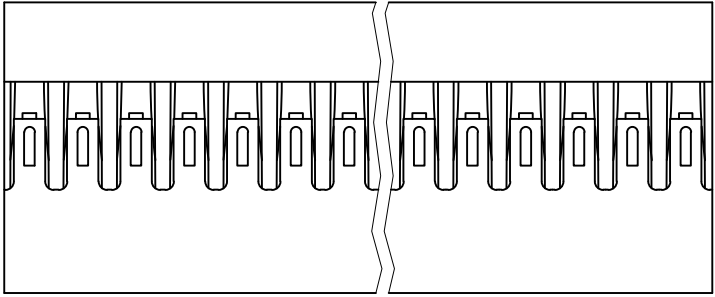

NOTES:

1. MOLDING MATERIAL : MODIFIED POLYPHELYMENE
COLOR BLACK, UL 94 V0

2. LATCH MUST WITHSTAND 18N MIN PULL OUT FORCE

3. STANDARD PACKAGING IN POLYBAGS

4. TERMINALS MUST BE CRIMPED PROPERLY FOR SATISFACTORY LATCHING :

- FOR CRIMPING INSTRUCTIONS, SEE TA-75 AND TA-295
- FOR TERMINAL APPLICATION SEE TA-531.

PRODUCT SPECIFICATION: BUS-12-067.

5. THIS HOUSING IS INTENDED FOR USE WITH MINI PV TERMINAL WITH 22-36 GAUGE WIRE

6. ROHS COMPLIANT PRODUCT SPECIFICATIONS :

- MEETS PACKAGING SPECS AS PER GS-14-920

- PRODUCT MEETS EUROPEAN UNION DIRECTIVES

AND OTHER COUNTRY REGULATIONS AS DESCRIBED IN GS-22-008.

- THE PRODUCT IS NOT INTENDED TO BE EXPOSED TO A MANUFACTURING SOLDER PROCESS.

mat'l. code		surface	tolerance	projection	product family	BERCONN
SEE NOTES		ISO 1302	ISO 406 ISO 101		title	MINI LATCH SR
ltr	ecn no	dr	date	tolerances unless otherwise specified	x ±0.3	angles
BE	V07-0483	HTB	07.07.24		linear	xx ±0.13
BF	F12-0064	LMU	12.06.08		xxx ±0.05	scale 5:1
BG	B-14321	LMU	13.03.21			
BH	B-18693	LMU	14.08.29			
BH	B-18693	AMA	15.02.27	engr	L.MULIN	12.06.08
BH	B-20324	AMA	15.02.27	engr	L.MULIN	12.06.08
sheet	revision	BJ	BH	appt	JCO	12.06.08
index	sheet	1	2			

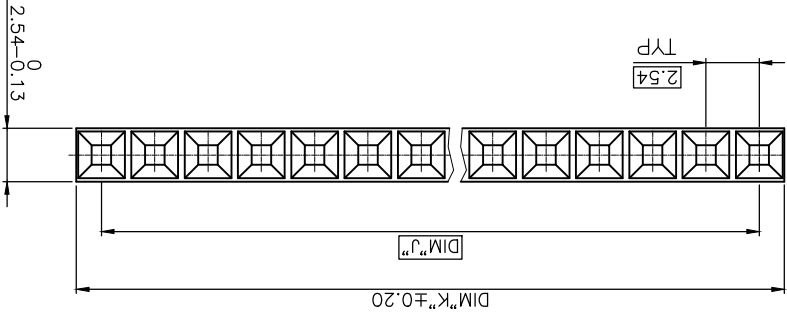

PIN STYLE	No. OF POS.	DIM J	DIM K
01	1x36	88.90	91.29
02	1x35	86.36	88.75
03	1x34	83.82	86.21
04	1x33	81.28	83.67
05	1x32	78.74	81.13
06	1x31	76.20	78.59
07	1x30	73.66	76.05
08	1x29	71.12	73.51
09	1x28	68.58	70.97
10	1x27	66.04	68.43
11	1x26	63.50	65.89
12	1x25	60.96	63.35
13	1x24	58.42	60.81
14	1x23	55.88	58.27
15	1x22	53.34	55.73
16	1x21	50.80	53.19
17	1x20	48.26	50.65
18	1x19	45.72	48.11
19	1x18	43.18	45.57
20	1x17	40.64	43.03
21	1x16	38.10	40.49
22	1x15	35.56	37.95
23	1x14	33.02	35.41
24	1x13	30.48	32.87
25	1x12	27.94	30.33
26	1x11	25.40	27.79
27	1x10	22.86	25.25
28	1x09	20.32	22.71
29	1x08	17.78	20.17
30	1x07	15.24	17.63
31	1x06	12.70	15.09
32	1x05	10.16	12.55
33	1x04	7.62	10.01
34	1x03	5.08	7.47
35	1x02	2.54	4.93
36	1x01	N/A	2.39

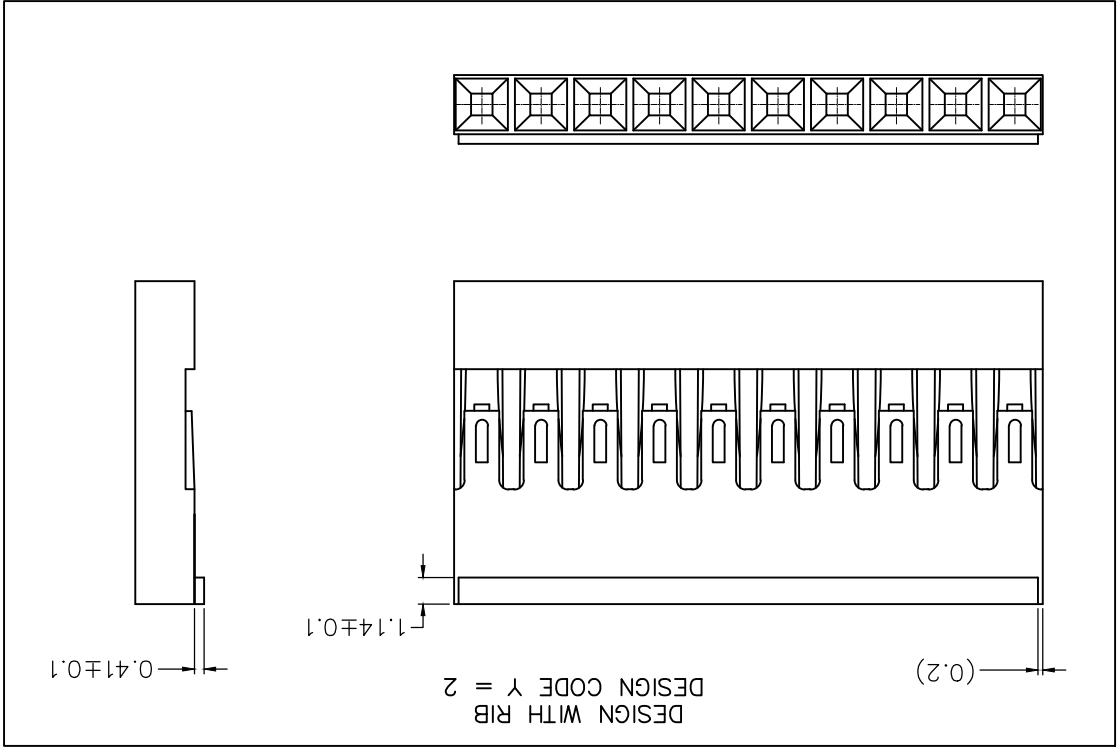

mat'l. code	surface	ISO 1302	tolerance	ISO 406 ISO 1001	projection	product family	BERCONN
ltr ecn no	dr	date	tolerances unless otherwise specified	x ±0.3	mm	title	MINI LATCH SR
BF	F12-0064	LMU	12.06.08	angles	linear	scale	5:1
BG	B-18693	LMU	14.08.29	xxx ±0.05		POLARIZED HSG 2.54mm	
BH	B-20324	AMA	15.02.27	dr	L.MULIN	12.06.08	
				engr	L.MULIN	12.06.08	
				chr			
				appt	JCO	12.06.08	
sheet	revision						
index	sheet						

X-ON Electronics

Largest Supplier of Electrical and Electronic Components

Click to view similar products for [Headers & Wire Housings](#) category:

Click to view products by [Amphenol](#) manufacturer:

Other Similar products are found below :

[95000-104TRLF](#) [10135584-644402LF](#) [DF62W-EP2022PCA](#) [95000-106TRLF](#) [DF62W-2022SCA](#) [DF62W-EP2022PC](#) [2203348](#) [DF62W-2022SC](#) [1084018](#) [1029039](#) [1084017](#) [802-10-012-10-002000](#) [1112640](#) [1112639](#) [000-34000](#) [0009482033](#) [0009507031](#) [57102-S06-03LF](#) [57202-S52-04LF](#) [PCN6-15S-2.5E](#) [0039019024](#) [58102-G61-06LF](#) [582553-1](#) [0009485154](#) [0009508121](#) [0022285053](#) [0050291907](#) [018731A](#) [LY20-4P-DT1-P1E-BR](#) [02.125.8002.8](#) [60101931](#) [60598-1 \(Cut Strip\)](#) [M1625-3R/100](#) [61062-3](#) [61082-181009](#) [636-1427](#) [638009-1](#) [641938-9](#) [641991-4](#) [644168-1](#) [647662-1](#) [65039-019ELF](#) [65817-002LF](#) [65817-015LF](#) [65863-015LF](#) [66207-023LF](#) [67016-026LF](#) [67046-001LF](#) [67095-007LF](#) [67230-005LF](#)