

REVISIONS					
P	LTR	DESCRIPTION	DATE	DWN	APVD
	A	REVISED PER PCN E-17-005334	18MAR2017	CM	DM

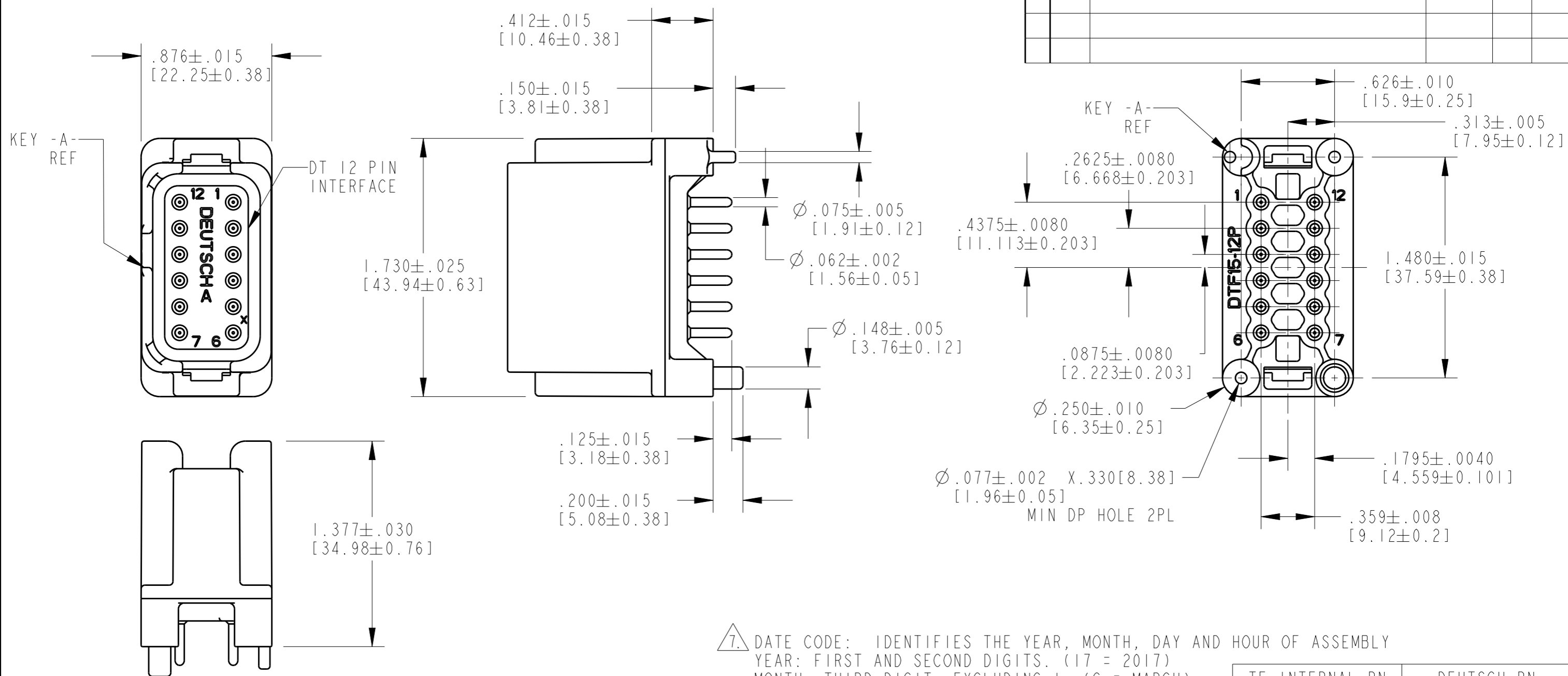

5. RECOMMENDED SCREW: 2-28 [M2.26 X 0.91] PLASTITE 48, SINGLE HELIX TORQUE: 0.75-1.5 IN-LB [0.08-0.16 N-m].

4. THE RECEPTACLE MATES WITH DT06-12SX-XXXX PLUG (X=A,B,C,D KEYS; XXXX=ALL MODIFICATIONS)

3. PIN PLATING:
 MATING SIDE: GOLD (-G003 MOD)
 PCB SIDE: TIN (ROHS)

2. MATERIAL:
 RECEPTACLE: PA46 GF30
 PIN: COPPER ALLOY

1. DIMENSIONAL TOLERANCES: ±.025 [.64]

NOTES:

7. DATE CODE: IDENTIFIES THE YEAR, MONTH, DAY AND HOUR OF ASSEMBLY
 YEAR: FIRST AND SECOND DIGITS. (17 = 2017)
 MONTH: THIRD DIGIT, EXCLUDING 1. (C = MARCH)
 DAY: FOURTH AND FIFTH DIGITS (21 = 21ST DAY)
 HOUR: SIXTH AND SEVENTH DIGITS. (16 = 4-5PM)

6. RECEPTACLE TO BE POTTED IN PLACE.
 POTTING DEPTH TO BE .600 [15.24] MAX FOR PCB.

TE INTERNAL PN	DEUTSCH PN
DTF15-12PA-G003	DTF15-12PA-G003
DTF15-12PB-G003	DTF15-12PB-G003
DTF15-12PC-G003	DTF15-12PC-G003
DTF15-12PD-G003	DTF15-12PD-G003

THIS DRAWING IS A CONTROLLED DOCUMENT.		DWN M. GONZALEZ	L1MAR2004	
DIMENSIONS: INCHES [mm]		CHK -	APVD 22MAR2004	
TOLERANCES UNLESS OTHERWISE SPECIFIED:		NAME 12 WAY RECEPTACLE 16 SIZE PINS -G003 MOD DTF SERIES		
0 PLC ±		PRODUCT SPEC -		
1 PLC ±		APPLICATION SPEC -		
2 PLC ±		SIZE A3		
3 PLC ±		CAGE CODE 4AFU8		
4 PLC ±		DRAWING NO DTF15-12PX-G003		
ANGLES ±		RESTRICTED TO -		
FINISH ±		WEIGHT -		
MATERIAL		CUSTOMER DRAWING		
SCALE 1.5:1		SHEET 1 OF 2		
REV A				

REVISIONS

P	LTR	DESCRIPTION	DATE	DWN	APVD
-	-	SEE SHEET 1	-	-	-

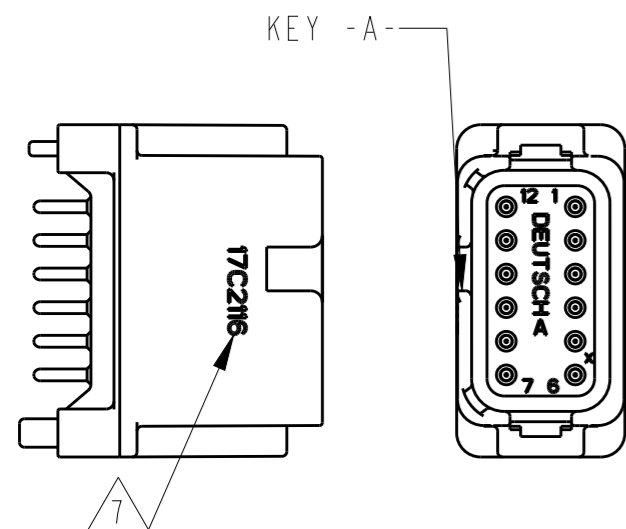

DTF15-12PA-G003
KEY -A-
 COLOR: GRAY

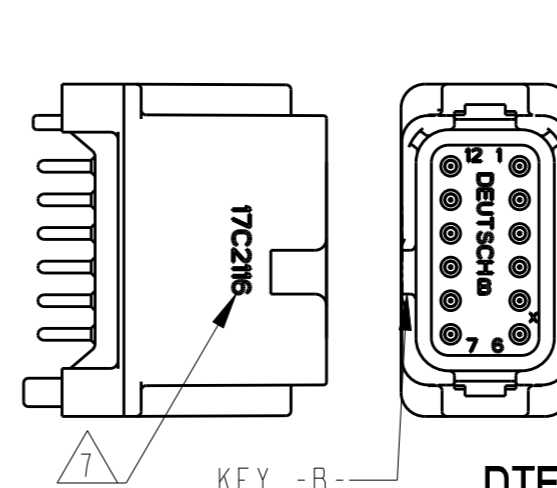
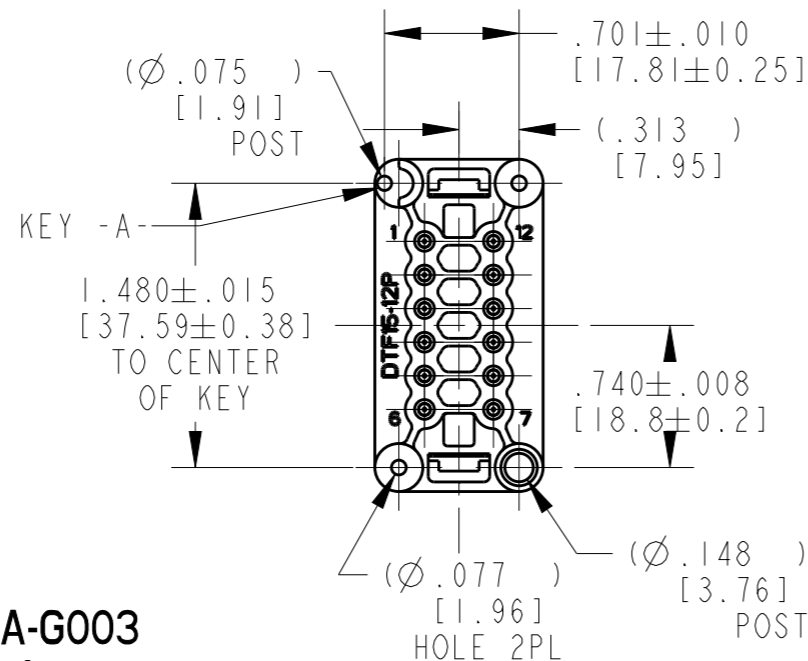

DTF15-12PB-G003
KEY -B-
 COLOR: BLACK

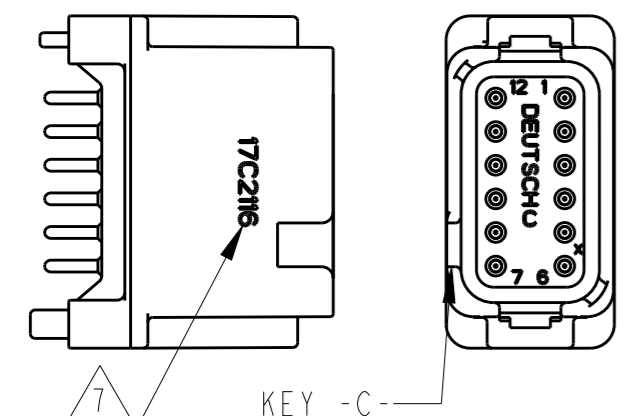
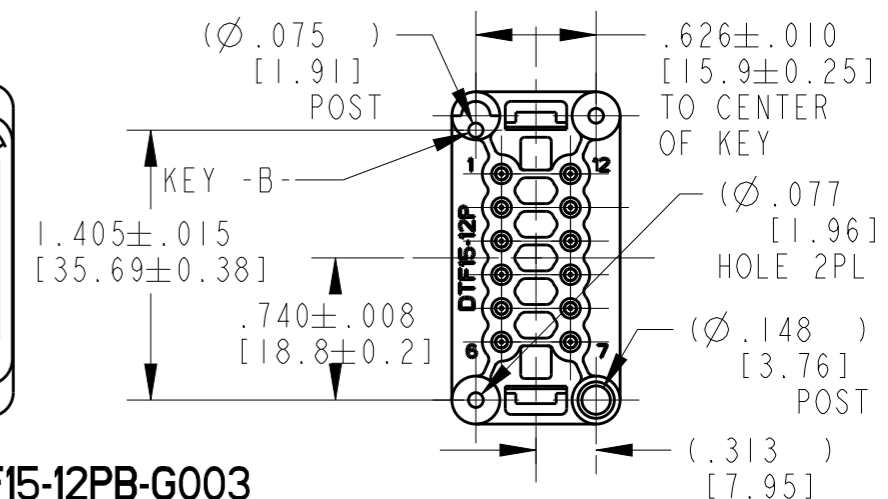

DTF15-12PC-G003
KEY -C-
 COLOR: GREEN

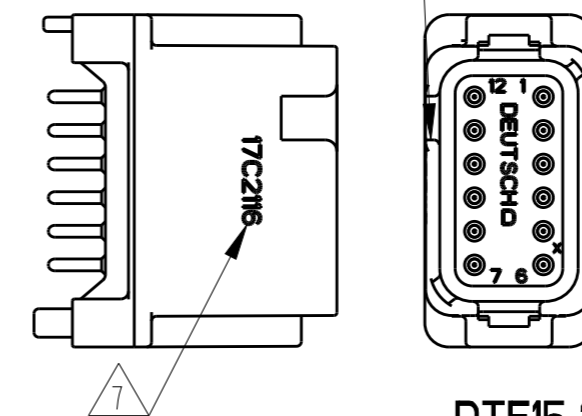
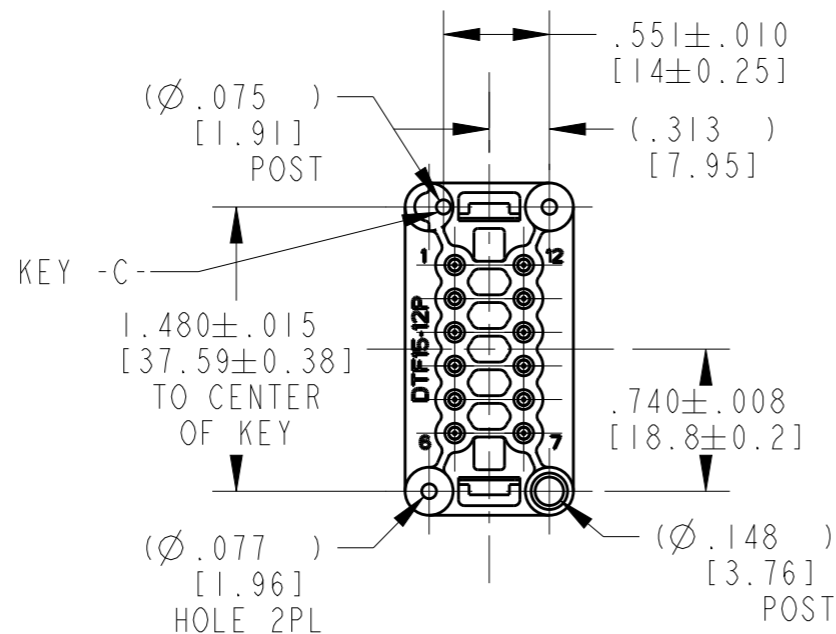

DTF15-12PD-G003
KEY -D-
 COLOR: BROWN

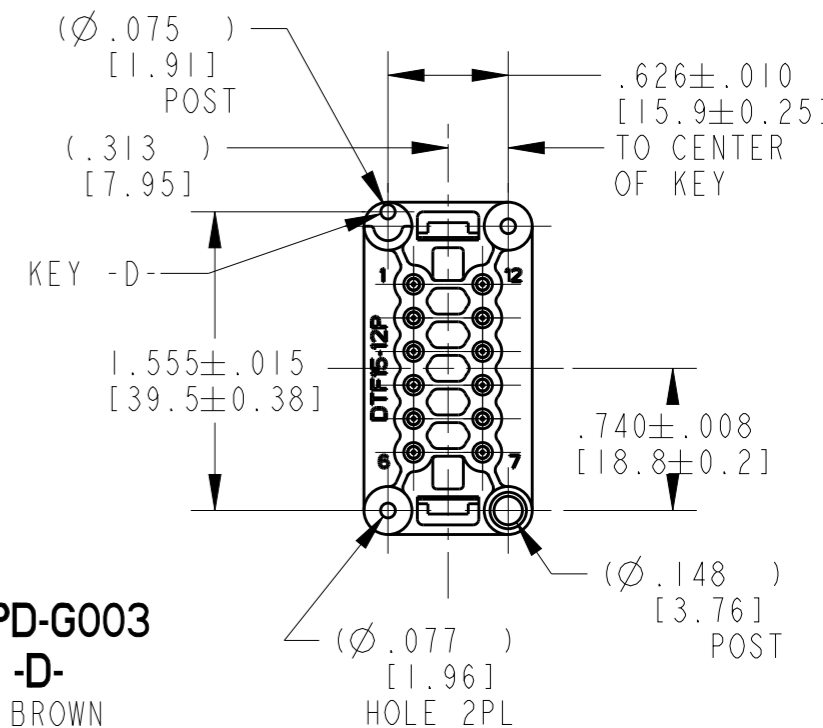

THIS DRAWING IS A CONTROLLED DOCUMENT.

DWN M. GONZALEZ LIMAR2004

CHK -

APVD 22MAR2004

PRODUCT SPEC -

APPLICATION SPEC -

WEIGHT -

CUSTOMER DRAWING

DIMENSIONS: INCHES [mm]

TOLERANCES UNLESS OTHERWISE SPECIFIED:

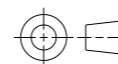

- 0 PLC ±
- 1 PLC ±
- 2 PLC ±
- 3 PLC ±.025 [0.64]
- 4 PLC ±
- ANGLES ±0° 30' 0"

MATERIAL -

FINISH -

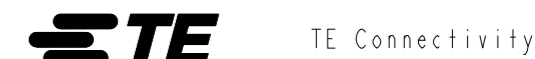

NAME
 12 WAY RECEPTACLE 16 SIZE PINS
 -G003 MOD DTF SERIES

SIZE A3 CAGE CODE 4AFU8 DRAWING NO. DTF15-12PX-G003 RESTRICTED TO -

SCALE 1:1 SHEET 2 OF 2 REV A

X-ON Electronics

Largest Supplier of Electrical and Electronic Components

Click to view similar products for [Automotive Connectors](#) category:

Click to view products by [TE Connectivity](#) manufacturer:

Other Similar products are found below :

[003-018-000](#) [600858](#) [60403001](#) [60993906-B](#) [60993913-B](#) [629515004020001](#) [M902-2131](#) [M902-2161](#) [M902-2344](#) [72.330.1035.1](#)
[73.353.4028.0](#) [F118010](#) [F119300-B](#) [F132210](#) [F132210-B](#) [F166900](#) [F180100](#) [F258300](#) [F258300-B](#) [F294300-B](#) [F339100](#) [F339700](#) [F358300-](#)
[B](#) [F374110](#) [F407400](#) [F412210](#) [F427600](#) [F444110](#) [F487000](#) [F495100-B](#) [F500900-B](#) [F509500B-B](#) [770444-1](#) [776880-1](#) [827153-1](#) [881735-1](#)
[8N1515-32-24P](#) [9-1326727-8](#) [9-1326729-8](#) [925467-1](#) [925474-1](#) [928905-1](#) [936398-2](#) [964562-1](#) [964562-4](#) [964731-2](#) [965051-1](#) [968782-1](#)
[GT17SA-8DS-HU](#) [GT17VS-10DP-5.2CF](#)