

This document is the property of Amphenol Corporation and is delivered on the express condition that it not be disseminated, reproduced or used, in whole or in part, for manufacture or sale by anyone other than Amphenol Corporation without the prior consent, in which no right is granted to disclose or to use any information in this document.

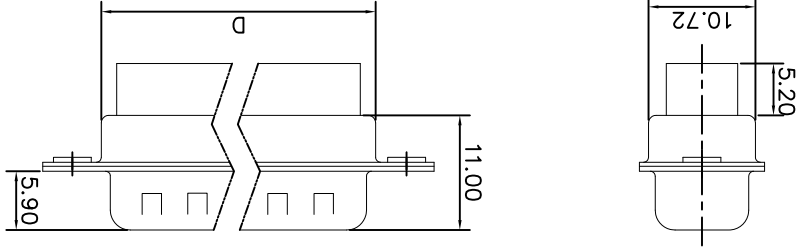
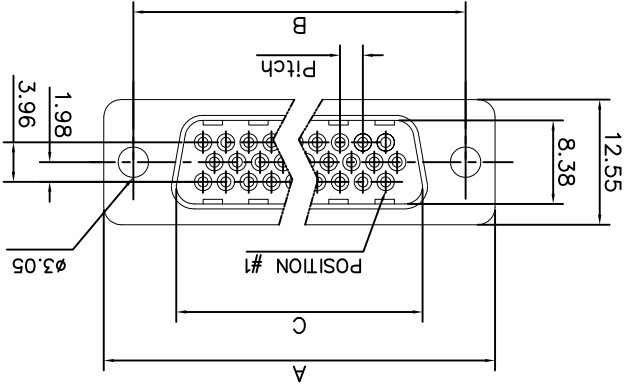

DIM. S	SHELL	A	B	C	D	Pitch
15	30.84	24.99	16.92	19.28	2.29	
26	39.24	33.32	24.70	27.51	2.29	
44	53.04	47.04	38.96	41.30	2.29	
62	69.32	63.50	55.42	57.71	2.41	

Customer drawing

PRODUCT CODE

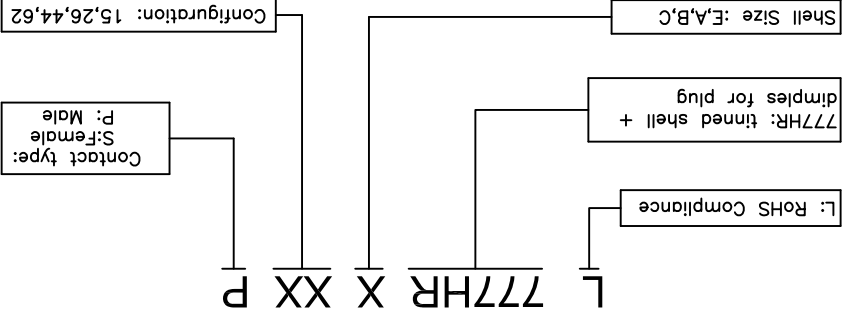

D-SUB TECHNICAL DATA

- SHELL :** Steel, 2.5um (100u") min tin over 1.25um (50u") min nickel
- BODY :** Glass filled thermoplastic.
- ELECTRICAL :** Voltage rating : 500 V RMS at 50 Hz
Flame retardant to UL94 V-0 Color Black
Insulation resistance >5000 M Ohms
- CLIMATIC :** Temperature range -55 °C up to 125°C
- MARKING :** Amphenol...(Series No.)
Commercial reference
Manufacturing date

REVISIONS			
S/N	ECN	DESCRIPTION	DATE
1			08/29/08

UNLESS OTHERWISE SPECIFIED	
TOLERANCES	U.S. MTRNC
X	+/-
.XX	+/-
.XXX	+/-
FRACTIONS	+/-
2	
FOR MATERIALS AND FINISHES	
REMOVE SHARP EDGES	
DIMENSIONS	
U.S.	INCHES
MM	METRIC

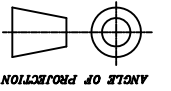

ANGLE OF PROJECTION

DRAWING FILE :

TITLE

APPROVAL DATE

DRAWN DATE

CHECKED DATE

U.S. MTRNC

DATE

APPROVAL DATE

U.S. MTRNC

DATE

APPROVAL DATE

U.S. MTRNC

DATE

APPROVAL DATE

U.S. MTRNC

DATE

APPROVAL DATE

U.S. MTRNC

DATE

APPROVAL DATE

U.S. MTRNC

DATE

APPROVAL DATE

U.S. MTRNC

DATE

APPROVAL DATE

U.S. MTRNC

DATE

APPROVAL DATE

U.S. MTRNC

DATE

APPROVAL DATE

U.S. MTRNC

DATE

APPROVAL DATE

U.S. MTRNC

DATE

APPROVAL DATE

U.S. MTRNC

DATE

APPROVAL DATE

U.S. MTRNC

DATE

SCALE	NONE
SIZE	A4
DRAWING NO.	C L777HRXXXP
REV.	1
stamped and formed connector, HR series	

Amphenol®

1

2

3

4

1

2

3

4

X-ON Electronics

Largest Supplier of Electrical and Electronic Components

Click to view similar products for [D-Sub High Density Connectors](#) category:

Click to view products by [Amphenol](#) manufacturer:

Other Similar products are found below :

[1484349-1](#) [163A16769X](#) [163A16809X](#) [163A17089X](#) [164A17199X](#) [164A17209X](#) [164A17479X](#) [164A18209X](#) [17BH-044S-AA110](#) [K86X-AD-26S](#) [KF66X-A26P-NJ](#) [KF66X-E15P-N](#) [241A17320X](#) [242A18390X](#) [242A25740X](#) [L717HDB44POL2R210](#) [L717HDCH62POL2RM5](#) [L717HDEH15POL2](#) [L777HDE15P](#) [L77HDC62S](#) [L77HDE15SC309](#) [163A16779X](#) [163A16839X](#) [163A17049X](#) [163A17079X](#) [164A17309X](#) [164A17329X](#) [164A18219X](#) [241A16440X](#) [241A16550X](#) [241A16680X](#) [241A17390X](#) [241A20810X](#) [241A25740X](#) [CT25-44P](#) [K66X-E15S-N30](#) [K86X-BA-44S](#) [K86X-ED-15S-BR15](#) [K86X-ED-15SK](#) [L177HDE15SOL2RM23](#) [L177HRC62S](#) [L177HRC62SVFM](#) [L177HRCG62S](#) [L717HDBH44POL2RM5](#) [L717HDEG15POL2RM5](#) [L77HDA26SVF](#) [L77HDE15SD1CO](#) [L77HDEH15SOL2RM832](#) [DAMA-15S-WS](#)
[443895-3](#)