

## 3A to 60A, 250VAC EMI Filters

### Features

- ◆ High Voltage Pulse Attenuation
- ◆ DIN Rail Mount Option (Up 30A)
- ◆ Low Earth Leakage Current Option (Up to 30A)
- ◆ Conforms to UL, CSA and EN Safety Agency Certifications



Specifications		RSAN-2003 RSAN-2003D RSAN-2003L	RSAN-2006 RSAN-2006D RSAN-2006L	RSAN-2010 RSAN-2010D RSAN-2010L	RSAN-2016 RSAN-2016D RSAN-2016L	RSAN-2020 RSAN-2020D RSAN-2020L
Rated Voltage (AC, DC)	V	250V				
Rated Current	A	3A	6A	10A	16A	20A
Withstand Voltage	V	Terminals to Case: 2500VAC (1 Minute)				
Isolation Resistance	MΩ	100MΩ minimum (500VDC, 1 Minute)				
Leakage Current (max)	A	RSAN-20xx 1mA; RSAN20xxL 10uA (250VAC, 60Hz)				
DC Resistance (total)	mΩ	250	110	40	20	10

Specifications		RSAN-2030 RSAN-2030D RSAN-2030L	RSAN-2040	RSAN-2050	RSAN-2060
Rated Voltage (AC, DC)	V	250V			
Rated Current	A	30A	40A	50A	60A
Withstand Voltage	V	Terminals to Case: 2500VAC (1 Minute)			
Isolation Resistance	MΩ	100MΩ minimum (500VDC, 1 Minute)			
Leakage Current (max)	A	RSAN-20xx 1mA; RSAN20xxL 10uA (250VAC, 60Hz)			
DC Resistance (total)	mΩ	6	6	4	3
Operating Temperature	°C	-25 to +85°C (Derate above 55°C, see derating curve)			
Storage Temperature	°C	-25 to +85°C			
Safety Agency Certifications	-	UL1283, CSA C22.2 No.8, EN60939			
Weight	g	170g to 870g model dependant (See weights chart on website)			
Warranty	yr	5 Year			

Options	
Chassis Mount & Standard Leakage Current	RSAN-20xx
DIN Rail Mount & Standard Leakage Current	RSAN-20xxD
Chassis Mount & Low Leakage Current	RSAN-20xxL

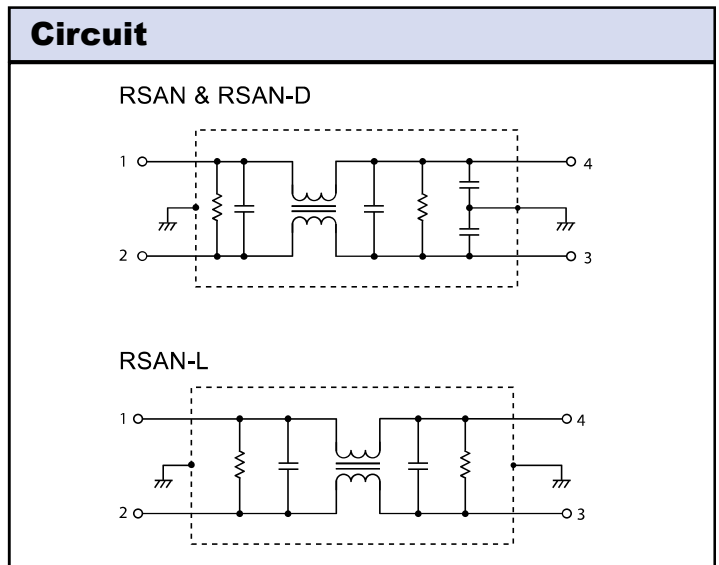
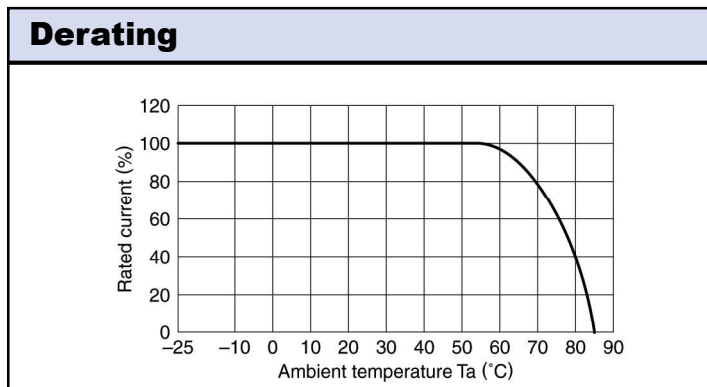

**Outline Drawing**

RSAN-2003/2006/2010/2016/2020/2030

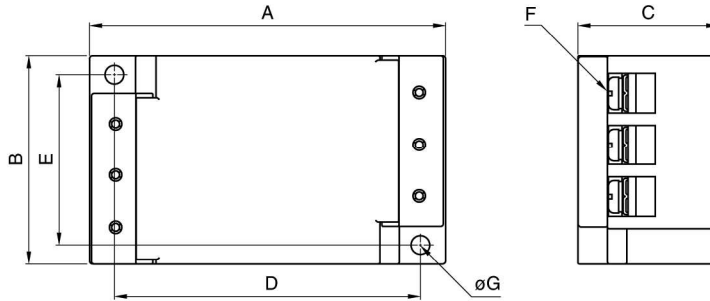

RSAN-2040/2050/2060

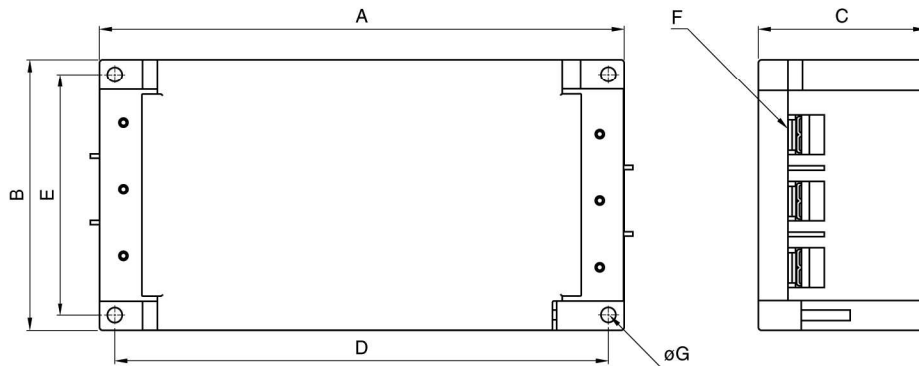

Dimensions in mm

Part No.	A	B	C	D	E	F	$\phi G$	Recommended clamping torque
RSAN-2003	87	52	35	75	43	M4	4.5	1.27N · m
RSAN-2006								
RSAN-2010								
RSAN-2016								
RSAN-2020								
RSAN-2030								
RSAN-2040	170	90	54	160	80	M5	4.5	2.5N · m
RSAN-2050								
RSAN-2060								

For Additional Information, please visit [us.tdk-lambda.com/lp/products/r-series.htm](http://us.tdk-lambda.com/lp/products/r-series.htm)



## X-ON Electronics

Largest Supplier of Electrical and Electronic Components

*Click to view similar products for [Power Line Filters](#) category:*

*Click to view products by [TDK-Lambda](#) manufacturer:*

Other Similar products are found below :

[5B1](#) [6609019-3](#) [6609026-5](#) [6609030-6](#) [6609063-2](#) [6609973-2](#) [7-1609090-5](#) [F1500CA06](#) [F7382Z](#) [F7863Z](#) [FAHAV3100ZC000](#) [806276](#)  
[FN2020B-1-06](#) [FN2080B-10-06](#) [FN2090A-1-06](#) [FN2410H-32-33](#) [FN2410H-80-34](#) [FN2412H-16-44](#) [FN406B-0.5-02](#) [FN420-1-13](#) [FP144](#) [8-](#)  
[6609089-0](#) [12-MMB-030-11-D](#) [B84144A90R120](#) [20B1](#) [RSEL-2001A](#) [2B1](#) [1-6609070-1](#) [F1500CA10](#) [1B1](#) [FN2020A-10-06](#) [FN2020B-3-06](#)  
[FN2060A-3-06](#) [FN2070A-16-06](#) [FN2070B-16-08](#) [FN2090B-12-06](#) [FN2090Z-1-06](#) [FN2410H-25-33](#) [FN2410H-60-34](#) [FN2410H-8-44](#)  
[FN2412H-25-33](#) [FN2412H-8-44](#) [FN610R-3-06](#) [20EHZ7](#) [20K1](#) [30B6](#) [30BCF10R](#) [3K1](#) [4-6609089-0](#) [B84142A0016R122](#)