

CSICD05-1200

**SURFACE MOUNT
SILICON CARBIDE
SCHOTTKY RECTIFIER
5.0 AMP, 1200 VOLT**



www.centrasemi.com

DESCRIPTION:

The CENTRAL SEMICONDUCTOR CSICD05-1200 is a silicon carbide Schottky rectifier designed for high frequency systems where energy efficiency and thermal performance are critical design elements.

MARKING CODE: SICD0512



DPAK-2L Case

APPLICATIONS:

- Power inverters
- Motor drives
- Switch-mode power supplies
- Power factor correction

FEATURES:

- Low profile package
- Low switching loss
- Stable switching over temperature extremes

MAXIMUM RATINGS: ($T_C=25^\circ\text{C}$ unless otherwise noted)

	SYMBOL		UNITS
Peak Repetitive Reverse Voltage	V_{RRM}	1200	V
Peak Reverse Surge Voltage	V_{RSM}	1200	V
DC Blocking Voltage	V_R	1200	V
Average Rectified Forward Current ($T_C=151^\circ\text{C}$)	I_O	5.0	A
Continuous Forward Current ($T_C=151^\circ\text{C}$)	I_F	5.0	A
Peak Forward Surge Current, $t_p=10\text{ms}$	I_{FSM}	37.5	A
Single Pulse Avalanche Energy (Note 1)	E_{AS}	44	mJ
Power Dissipation	P_D	150	W
Power Dissipation ($T_C=151^\circ\text{C}$)	P_D	42	W
Operating and Storage Junction Temperature	T_J, T_{stg}	-55 to +175	$^\circ\text{C}$
Thermal Resistance	θ_{JC}	1.6	$^\circ\text{C/W}$

Note 1: $L=10\text{mH}$, $I_{PK}=2.9\text{A}$, $V_{DD}=100\text{V}$, Initial $T_J=25^\circ\text{C}$

ELECTRICAL CHARACTERISTICS: ($T_J=25^\circ\text{C}$ unless otherwise noted)

SYMBOL	TEST CONDITIONS	TYP	MAX	UNIT
I_R	$V_R=1200\text{V}$	30	190	μA
V_F	$I_F=5.0\text{A}$	1.5	1.7	V
V_F	$I_F=5.0\text{A}$, $T_J=175^\circ\text{C}$	2.5	3.0	V
Q_C	$V_R=800\text{V}$	26		nC
C_J	$V_R=1.0\text{V}$, $f=1.0\text{MHz}$	260		pF
C_J	$V_R=400\text{V}$, $f=1.0\text{MHz}$	24		pF
C_J	$V_R=800\text{V}$, $f=1.0\text{MHz}$	19		pF

R2 (12-October 2017)

CSICD05-1200
 SURFACE MOUNT
 SILICON CARBIDE
 SCHOTTKY RECTIFIER
 5.0 AMP, 1200 VOLT



DPAK-2L CASE - MECHANICAL OUTLINE

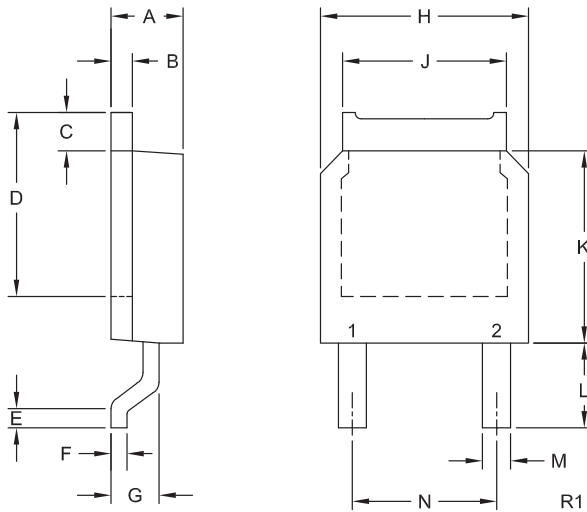

SYMBOL	INCHES		MILLIMETERS	
	MIN	MAX	MIN	MAX
A	0.080	0.100	2.03	2.54
B	0.018	0.035	0.46	0.89
C	0.035	0.050	0.89	1.27
D	0.230		5.84	
E	0.021	0.027	0.53	0.69
F	0.015	0.025	0.38	0.64
G	0.051	0.071	1.30	1.80
H	0.250	0.270	6.35	6.86
J	0.195	0.215	4.95	5.46
K	0.230	0.250	5.84	6.35
L	0.087	0.118	2.21	3.00
M	0.025	0.045	0.64	1.14
N	0.180		4.57	

DPAK-2L (REV: R1)

PIN CONFIGURATION

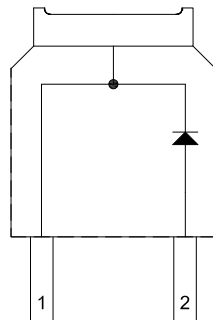

LEAD CODE:

- 1) Cathode
- 2) Anode
- Tab) Cathode

MARKING CODE: SICD0512

R2 (12-October 2017)

CSICD05-1200

SURFACE MOUNT
SILICON CARBIDE
SCHOTTKY RECTIFIER
5.0 AMP, 1200 VOLT



TYPICAL ELECTRICAL CHARACTERISTICS

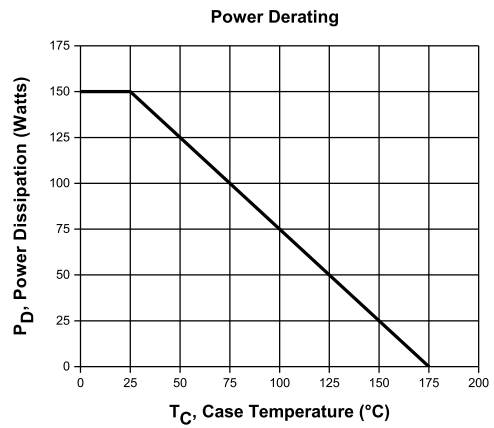
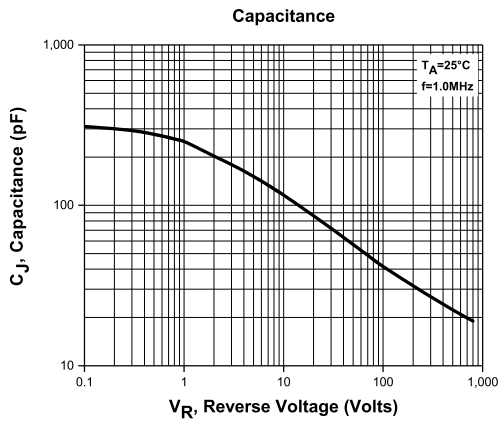
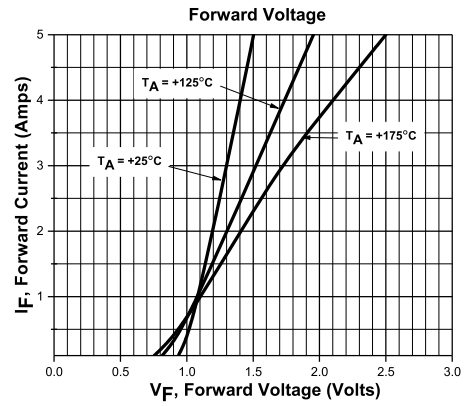
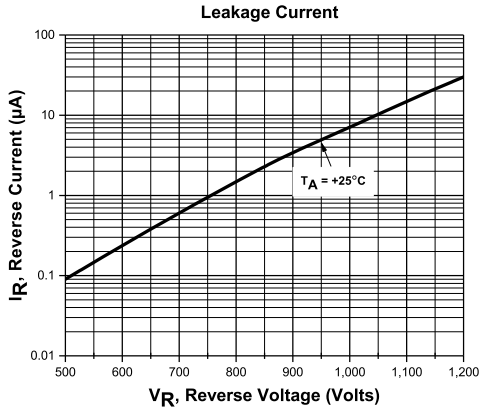

R2 (12-October 2017)

X-ON Electronics

Largest Supplier of Electrical and Electronic Components

Click to view similar products for [Schottky Diodes & Rectifiers](#) category:

Click to view products by [Central Semiconductor](#) manufacturer:

Other Similar products are found below :

[CUS06\(TE85L,Q,M\)](#) [MA4E2039](#) [D1FH3-5063](#) [MBR0530L-TP](#) [MBR10100CT-BP](#) [MBR30H100MFST1G](#) [MMBD301M3T5G](#) [PMAD1103-LF](#) [PMAD1108-LF](#) [RB160M-50TR](#) [RB520S-30](#) [RB551V-30](#) [DD350N18K](#) [DZ435N40K](#) [DZ600N16K](#) [BAS16E6433HTMA1](#) [BAS 3010S-02LRH E6327](#) [BAT 54-02LRH E6327](#) [IDL02G65C5XUMA1](#) [NSR05F40QNXT5G](#) [JANS1N6640](#) [SB07-03C-TB-H](#) [SB1003M3-TL-W](#) [SBAT54CWT1G](#) [SK32A-LTP](#) [SK33A-TP](#) [SK34A-TP](#) [SK34B-TP](#) [SMD1200PL-TP](#) [ACDBN160-HF](#) [SS3003CH-TL-E](#) [STPS30S45CW](#) [PDS3100Q-7](#) [GA01SHT18](#) [CRS10I30A\(TE85L,QM\)](#) [MA4E2501L-1290](#) [MBR1240MFST1G](#) [MBRB30H30CT-1G](#) [BAS28E6433HTMA1](#) [BAS 70-02L E6327](#) [HSB123JTR-E](#) [JANTX1N5712-1](#) [VS-STPS40L45CW-N3](#) [DD350N12K](#) [SB007-03C-TB-E](#) [SK110-LTP](#) [SK154-TP](#) [SK32A-TP](#) [SK33B-TP](#) [SK35A-TP](#)