

RoHS compliant

Scale	1:1
TOLERANCE	
X	±0.38
X.X	±0.25
X.XX	±0.13
DIM	TOL
X.°	±3.°
X.X°	±1.0°
Angle	TOL
Id.	

Update	30.05.2014	Joanna	Drawn	17.05.2000	Helwig	Name
Update	17.07.2012	Lucas	Approved	30.05.2014	Joanna	Date
Update	06.07.2012	Lucas	detail information add			
Update	08.04.2009	Dean	Modification			
Drawn	17.05.2000	Helwig	Date			

ASSMANN WSW-No.		ASSMANN WSW-No.		ASSMANN WSW-No.		ASSMANN WSW-No.	
Customer-No.		Customer-No.		Customer-No.		Customer-No.	
Name		Name		Name		Name	
Date		Date		Date		Date	

Replace	ASS 0146 CO 11.11.1997
Replace	ASS 0143B CO
Sheet	rev05

1	2	3	4	5	6	7
---	---	---	---	---	---	---

9.4mm Footprint

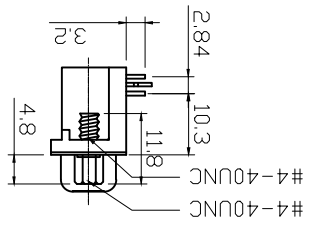
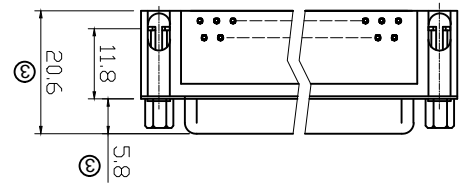

9	30.81	24.99	16.33	11.08
15	39.20	33.30	24.70	19.39
25	53.05	47.04	38.40	33.24
37	69.40	63.50	54.80	49.86

③ Dimensions Positions

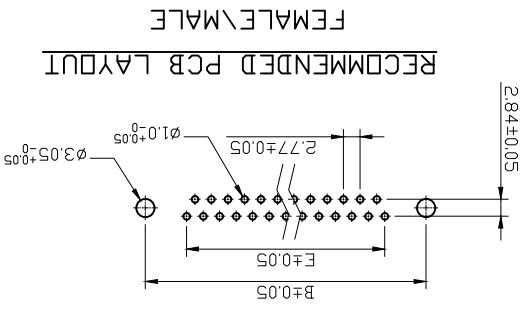
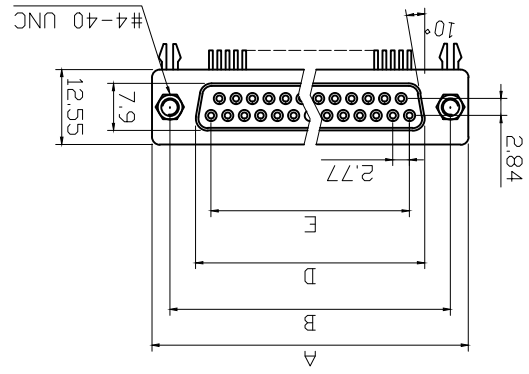

RECOMMENDED PCB LAYOUT FEMALE\MALE

- ③ Product Specification
- Material : Glass-filled thermoplastic PBT
- Insulator : UL94V-0 rated
- Contact : Phosphor bronze
- Shell : Steel : 7439-89-6
- ③ 100u" Tin over 80u" Min Copper
- ③ Clinch Nut : Copper alloy, Nickel Plated.
- ③ Boardlock : Brass, Tin Plated.
- ③ Screwlock : Brass, Nickel Plated.
- Electrical
- Contact Resistance : 20 milliohms
- Max at 1 AMP DC.
- Insulation Resistance : 1000 megohms at 500 VDC
- Dielectric Withstanding Voltage : 1000 VAC/rms 60Hz for 1 minute
- ③ Current Rating : 3AMP
- Voltage Rating : 250 VAC/rms 60HZ
- ③ Temperature Range: -55°C ~ +105 °C

A	B	C	D	E	F	G	H
---	---	---	---	---	---	---	---

X-ON Electronics

Largest Supplier of Electrical and Electronic Components

Click to view similar products for [D-Sub Standard Connectors](#) category:

Click to view products by [Assmann](#) manufacturer:

Other Similar products are found below :

[DCM37S732N](#) [DAM15P500](#) [DEV09S364GTLF](#) [DEM09P032N](#) [DDM50P732N](#) [DAM15S332N](#) [173109-2218](#) [173109-2466](#) [173109-2436](#)
[173109-2435](#) [56F706-005-LI](#) [56F711-015](#) [015-0341-000](#) [015-0372-008](#) [015-8544-011](#) [017041-0005](#) [020419-0104](#) [012-0515-000](#) [012-9507-](#)
[034](#) [012-9507-114](#) [012-9534-001](#) [020745-0008](#) [609-25P](#) [M24308/2-23Z](#) [M243082310F](#) [M243082410F](#) [M243082411F](#) [M24308/4-21](#)
[CT1A18-11PSA206](#) [CT1N36-5SC](#) [CT2-16S-17PS](#) [CT2-20-15PCAU](#) [CT2-24-12PS](#) [CT2-24-28PSF127A206](#) [CT2-32-9PC](#) [CT6F9767-14-4-](#)
[14S-5PC](#) [CT6FA10SL-4PS](#) [CT7-18-10SC](#) [CT7-18-10SCAU](#) [CT7-18-12SCAU](#) [CT7-18-1PC](#) [CT7-18-1PCAU](#) [CT7-18-21SCAU](#) [M83513/01-](#)
[FC](#) [M83723/76W24619 L/C](#) [M85049/48-3-2F](#) [69001-865](#) [6STD09PCM99B70X](#) [6STD09SCM99B30X](#) [6STD09SCT99S40X](#)