

**PACKARD ELECTRIC DIVISION**  
**GENERAL MOTORS CORPORATION**  
**WARREN, OHIO**

**DO NOT SCALE**

THIS DRAWING AND DESIGN HEREON CONSTITUTES A PROPRIETARY DESIGN OF PACKARD ELECTRIC DIVISION AND IS NOT TO BE DUPLICATED OR REPRODUCED WITHOUT AUTHORITY OF PACKARD ELECTRIC DIVISION.

PART NO. **1201 5878**

DATE	SYM.	REVISION RECORD	C/NNO.	DR.	CK.
09JN80	A	RELEASED	80005	H.H.	NP
01SE82	-	PICTURE REVISED	82155	T.W.	Jm
01AU83	B	REV. SYM. ADVANCED	86126	MS	Jm
28AP97	-	REVISED	177598	GA	GA
05DE05	B7	ADDED DIM .1840 +.0060 / -.0030, DIM .512 & REMOVED DIM (1 PLC)	274727	GPS	JVM

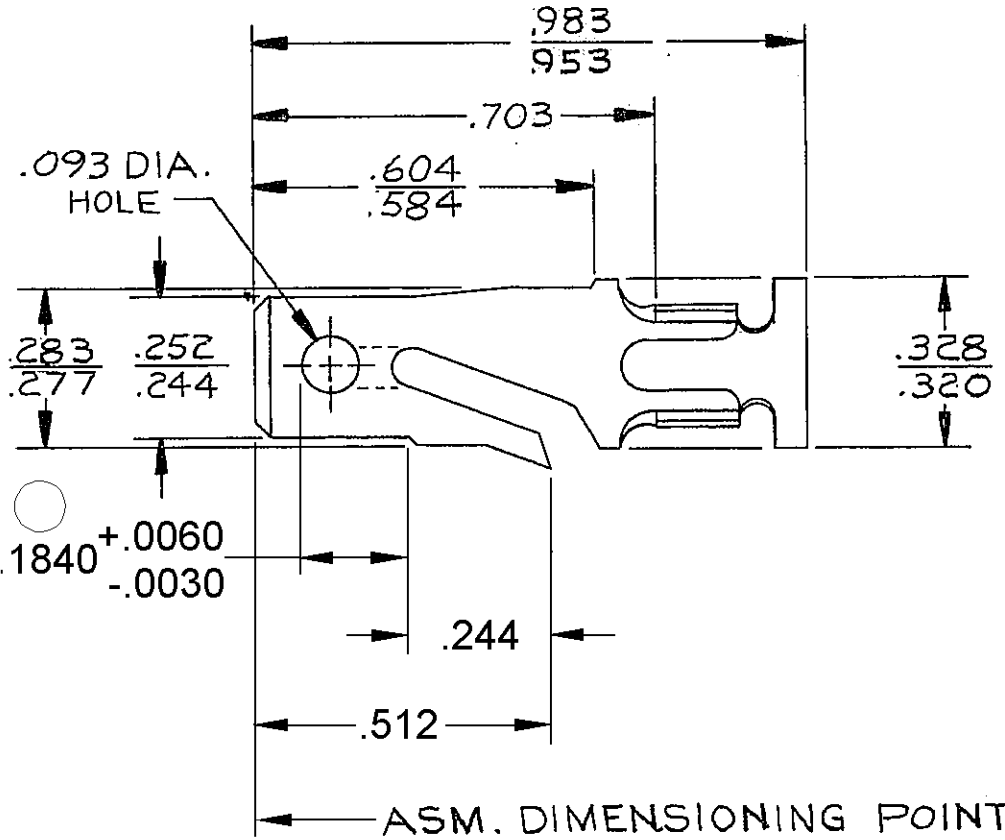

CONDUCTOR WINGS  
 FOR 5.0 - 3.0MM<sup>2</sup> CABLE.

C02D2169

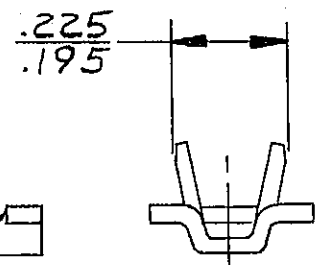

19-A  
 4/100-9  
 173-F5V(3)  
 194 P1  
 14A

**NOTE - MAX. CONTINUOUS CURRENT CARRYING CAPACITY 10GA. 43 AMPS. - 12 GA. 33 AMPS. (CRIMP & SWEAT APPLICATION).**

CODE NO. **6900**

TOLERANCE UNLESS OTHERWISE SPECIFIED  
 DECIMAL:  
 TWO PLACE ± .01  
 THREE PLACE ± .005

QC

DWG. DATE **09JN 80** SCALE **NONE** DR. **H. Hoke 09JN. 80**

EST. NO. CK. **W. Pearce** DATE **14JN 80**

REFERENCE NO. **2962864 "D" SIZE 3** SHT. **3** APPR. **K. M. Kollin** DATE **19JN 80**

MATERIAL SPEC. **.0320 THK. SAE CA 260 BRASS 1/2 HARD-TIN PLATED**

NAME **TERMINAL-MALE-56 SERIES**

PART NO. **1201 5878** SIZE **A**

**OUTLINE DRAWING**

## X-ON Electronics

Largest Supplier of Electrical and Electronic Components

*Click to view similar products for [Automotive Connectors](#) category:*

*Click to view products by [Delphi](#) manufacturer:*

Other Similar products are found below :

[003-018-000](#) [600858](#) [60403001](#) [60993906-B](#) [60993913-B](#) [629515004020001](#) [M902-2131](#) [M902-2161](#) [M902-2344](#) [72.330.1035.1](#)  
[73.353.4028.0](#) [F118010](#) [F119300-B](#) [F132210](#) [F132210-B](#) [F166900](#) [F180100](#) [F258300](#) [F258300-B](#) [F294300-B](#) [F339100](#) [F339700](#) [F358300-](#)  
[B](#) [F374110](#) [F407400](#) [F412210](#) [F427600](#) [F444110](#) [F487000](#) [F495100-B](#) [F500900-B](#) [F509500B-B](#) [770444-1](#) [776880-1](#) [827153-1](#) [881735-1](#)  
[8N1515-32-24P](#) [9-1326727-8](#) [9-1326729-8](#) [925467-1](#) [925474-1](#) [928905-1](#) [936398-2](#) [964562-1](#) [964562-4](#) [964731-2](#) [965051-1](#) [968782-1](#)  
[GT17SA-8DS-HU](#) [GT17VS-10DP-5.2CF](#)