

Order data on pages 120-121

OKW
 GEHÄUSE
 SYSTEME

PRACTICAL MOBILE CASE DESIGN



THE PRODUCT

The new MINITEC cases convince their users thanks to their mini-dimensions and maxi-benefits.

Whether round your neck or round your wrist, MINITEC cases are your loyal companions and are always within easy reach. They are so small and light that they also fit into any trouser pocket.

Whether with orange, green, blue or volcano-coloured intermediate rings or one coloured, these MINITEC cases are the right enclosures for today's personal electronics.

ENCLOSURE DESIGN

You have a choice between an organic "MINITEC DROP" shape or a more technical "MINITEC EDGE" design.

Different intermediate rings and accessories offer the necessary flexibility for individual use.

Protection class IP 41

MINITEC DROP (sizes S and M) with intermediate ring in TPE.

Max. size of PCB (L x W in mm)

	MINITEC DROP bottom part
S	35 x 27
M	51 x 38
XL	57 x 45

(cutouts of pillars not taken into consideration)

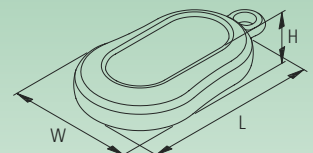

detailed drawings see our website
www.okw.com



THE PERFECT COMPANION

Protection class IP 41
MINITEC EDGE (size M)
with intermediate ring in TPE.

Max. size of PCB (L x W in mm)

	MINITEC EDGE bottom part
S	35 x 24
M	51 x 34
XL	53 x 40

(cutouts of pillars not taken into consideration)

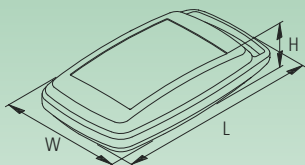

detailed drawings see our website
www.okw.com

YOUR ADVANTAGE

Modern, flat styling.

Easy to wear, e.g. round your neck, or as a bracelet with wrist strap, on a key ring or on a belt (EL).

TPE ring for a pleasant touch sensation and as impact protection.

Also available in infra-red light-permeable material.

Recessed operating area for the protection of the membrane keyboard or decorative foil. MINITEC Edge also without recessed operating area.

APPLICATIONS

Many different types of remote control systems.

Mobile USB solutions.

Specially made for clinic and social fields as well as in the household and in industry, e.g. emergency systems, monitoring and alarm equipment, radio remote control etc.





MINITEC DROP

Bottom and top part	Size	Outside dim. in mm			Equipment (dim. in mm) max. dim. keypad	Part-No. ABS (UL 94 HB)		PMMA* ² black RAL 9005
		L	W	H		off-white RAL 9002	lava	
	S	51	32	13	38.60 x 18.15	B 90 02 907	B 90 02 908	B 90 02 906
	M	70	44	16	52.55 x 23.70	B 90 04 907	B 90 04 908	B 90 04 906
	L	84	53	19	63.95 x 30.10	B 90 06 907	B 90 06 908	B 90 06 906

Intermediate ring	Material	Colour	Part-No.			
			S	M	L	S
	TPE	lava	B 90 02 302	B 90 04 302	B 90 06 302	B 90 02 352
	TPE	orange	B 90 02 303	B 90 04 303	B 90 06 303	B 90 02 353
	TPE	green	B 90 02 304	B 90 04 304	B 90 06 304	B 90 02 354
	TPE	blue	B 90 02 305	B 90 04 305	B 90 06 305	B 90 02 355
	PMMA* ²	black, RAL 9005	B 90 02 306	B 90 04 306	B 90 06 306	B 90 02 356
	TPE	off-white, RAL 9002	B 90 02 307	B 90 04 307	B 90 06 307	B 90 02 357
	TPE	volcano	B 90 02 308	B 90 04 308	B 90 06 308	B 90 02 358
	ABS	black, RAL 9005	B 90 02 309	B 90 04 309	B 90 06 309	B 90 02 359

MINITEC EGDE

Bottom and top part	Size	Outside dim. in mm			Equipment (dim. in mm) max. dim. keypad	Part-No. ABS (UL 94 HB)		PMMA* ² black RAL 9005
		L	W	H		off-white RAL 9002	lava	
	S	52	32	15	34.90 x 19.85	B 90 02 807	B 90 02 808	B 90 02 806
		52	32	15	without recess	B 90 02 857	B 90 02 858	B 90 02 856
	M	68	42	18/24	45.00 x 27.85	B 90 04 807	B 90 04 808	B 90 04 806
		68	42	18/24	without recess	B 90 04 857	B 90 04 858	B 90 04 856
	L	78	48	20	51.60 x 31.95	B 90 06 807	B 90 06 808	B 90 06 806
		78	48	20	without recess	B 90 06 857	B 90 06 858	B 90 06 856
		78	48	24	51.50 x 29.70	B 90 06 817	B 90 06 818	B 90 06 816
		78	48	26	51.50 x 29.70	B 90 06 827	B 90 06 828	B 90 06 826

Intermediate ring	Material	Colour	Part-No.			Part-No.			NEW
			S	M	L	S	M	L	
	TPE	lava	B 90 02 702	B 90 04 702	B 90 06 702	B 90 02 752	B 90 04 752	B 90 06 752	B 90 06 782
	TPE	orange	B 90 02 703	B 90 04 703	B 90 06 703	B 90 02 753	B 90 04 753	B 90 06 753	B 90 06 783
	TPE	green	B 90 02 704	B 90 04 704	B 90 06 704	B 90 02 754	B 90 04 754	B 90 06 754	B 90 06 784
	TPE	blue	B 90 02 705	B 90 04 705	B 90 06 705	B 90 02 755	B 90 04 755	B 90 06 755	B 90 06 785
	PMMA* ²	black	B 90 02 706	B 90 04 706	B 90 06 706	B 90 02 756	B 90 04 756	B 90 06 756	B 90 06 786
	TPE	off-white	B 90 02 707	B 90 04 707	B 90 06 707	B 90 02 757	B 90 04 757	B 90 06 757	B 90 06 787
	TPE	volcano	B 90 02 708	B 90 04 708	B 90 06 708	B 90 02 758	B 90 04 758	B 90 06 758	B 90 06 788
	ABS	black	B 90 02 709	B 90 04 709	B 90 06 709	B 90 02 759	B 90 04 759	B 90 06 759	B 90 06 789

Intermediate ring high	Material	Colour	Part-No.		NEW
			M	USB Type A	
	TPE	lava	B 90 04 782	—	—
	TPE	orange	B 90 04 783	—	—
	TPE	green	B 90 04 784	—	—
	TPE	blue	B 90 04 785	—	—
	TPE	off-white, RAL 9002	B 90 04 787	—	—
	TPE	volcano	B 90 04 788	B 90 04 798	—

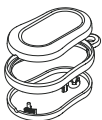

*1 To achieve one MINITEC, please order:
 1 bottom and top part
 1 intermediate ring
 (screw supplied with case)

*² cases made of PMMA (plexiglass[®]) not comparable to cases made of ABS when comparing mechanical load-bearing capacity



MINITEC ACCESSORIES

Article	For MINITEC	Version / Application	Part-No.
① Key ring	E (Edge) / D (Drop)	nickel-plated, ø 20.5 mm	A 91 64 001
② Lanyard "Reflex"	E (Edge) / D (Drop)	silver/black, with quick-action lock, approx. 860 mm long	B 91 00 022
③ Lanyard "Woven" NEW	E (Edge) / D (Drop)	black, with safety closure, approx. 900 mm long	B 91 00 053
④ Hand strap "Woven"	E (Edge) / D (Drop)	grey, with quick-action lock, approx. 200 mm long	B 91 00 044
⑤ Wrist strap	E (Edge, 2 strap loops)	black, elastic belt with velcro, approx. 280 mm long	B 91 00 033
⑥ Strap eyelet NEW	E (Edge size L)	ABS lava, for belts or belt webbing up to 34 x 4 mm, horizontally/vertically use, incl. screws for mounting	B 91 06 108
⑦ USB end cover NEW	E (Edge size M)	TPE, volcano, for USB connectors type A according DIN IEC 61076-3-107, clamps on the connector	A 93 20 008

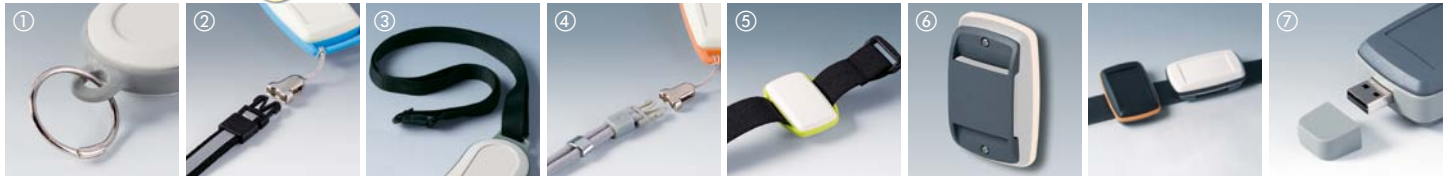

universal accessories on pages 178-187

X-ON Electronics

Largest Supplier of Electrical and Electronic Components

Click to view similar products for [okw manufacturer](#):

Other Similar products are found below :

[A1020648](#) [A9413351](#) [B3218101](#) [B4208208](#) [B9004028](#) [A9082065](#) [A0224070](#) [M-6PCBK](#) [A5116000](#) [D1040465](#) [D2012121](#) [D2512017](#)
[D2512018](#) [D3015317](#) [D4054117](#) [D5111807](#) [D9052288](#) [D9072149](#) [D9408441](#) [D9413648](#) [D9413747](#) [A1020049](#) [A2650060](#) [B3214101](#)
[A9180001](#) [A9066119F](#) [A1320260](#) [A1324860](#) [A4123105](#) [A4140100](#) [A4223000](#) [D9051459](#) [A1020048](#) [A2440068](#) [A9084165](#) [A1321860](#)
[A1422469](#) [A4213008](#) [A6023019](#) [A7510000](#) [D5111057](#) [D5116057](#) [A2531068](#) [A1020068](#) [A2513048](#) [A3016638](#) [A3116068](#) [A9406351](#)
[A1031639](#) [A1102007](#)