

7.0×5.0mm

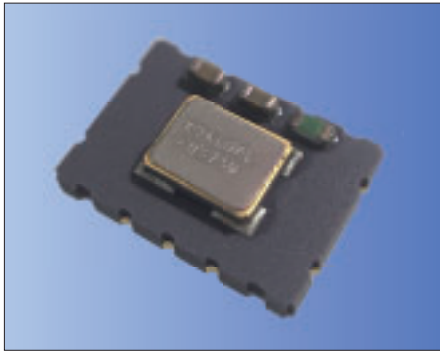

RoHS Compliant

Features

- High stability and high reliability
- 2.7 to 5.5V drive available
- Clipped sine wave or CMOS level output
- Low phase noise
- Disable Function (KT7050A)

Applications

- 5G, Smallcell, Stratum3
- SONET/ SDH/ Ethernet

How to Order

KT7050 □ 20000 □ A □ 33 T xx
 ① ② ③ ④ ⑤ ⑥ ⑦ ⑧ ⑨

① Series	② Land Type
③ Output Frequency	A 10Pads
④ Freq. Temp. Chrst.	B 4Pads
⑤ Lower Operating Temp.	⑥ Upper Operating Temp.
KAW	±0.28×10 ⁻⁶ -40°C +85°C
KAY	±0.28×10 ⁻⁶ -40°C +105°C
AAV	±0.10×10 ⁻⁶ -40°C +105°C

⑦ Supply Voltage	⑧ Voltage Control Function
33 3.3V	T TCXO
	Spec. Code* VCTCXO

*Please contact us for Spec. Code.

⑨ Individual Specification

Packaging (Tape & Reel 1000 pcs./ reel)

- Compliant to the GR1244-Core & GR253-Core
- Recommended in Microsemi's ZLAN-68 app. note for Stratum3 applications based on tests performed by Kyocera.

Specifications

Item	Symbol	Conditions	Min.	Max.	Units	
Output Frequency Range	f _o	Standard Frequency: 10, 19.2, 20, 24.576, 26, 30.72, 38.88, 40 vs Temperature (-10 to +105°C) [±(f _{max} -f _{min})/ 2f _o]	10	40	MHz	
Frequency Tolerance	f _{tol}	vs Temperature (-40 to +85°C/ +105°C) [±(f _{max} -f _{min})/ 2f _o] vs Voltage	-0.1	+0.1	×10 ⁻⁶	
Supply Voltage	V _{CC}		-0.1	+0.1		
Current Consumption	I _{CC}	CMOS Output	+2.7	+5.5	V	
Frequency Aging	f _{age}	20years aging @40°C Including temp characteristics, initial tolerance, rated power supply voltage change and load change.	-	6	mA	
Voltage Control Range	f _{cont}	Positive *100k ohm min	-4.6	+4.6	×10 ⁻⁶	
Output Level	V _{pp}	Clipped Sine, Load: 10k ohm // 10pF	±5	±20	×10 ⁻⁶	
Low Level Output Voltage	V _{OL}	CMOS, Load: 15pF I _{OL} = 4mA	0.8	-	Vp-p	
High Level Output Voltage	V _{OH}	CMOS, Load: 15pF I _{OH} = -4mA	-	10% V _{CC}	V	
Rise / Fall Time (10%V _{CC} to 90%V _{CC})	tr/ tf	CMOS, Load: 15pF	90% V _{CC}	-	V	
Symmetry	SYM	50% V _{CC}	-	8	ns	
Phase Noise	-	@20MHz	@10Hz offset	-	-90	dBc/ Hz
			@100Hz offset	-	-120	
			@1kHz offset	-	-140	
			@10kHz offset	-	-150	
			@100kHz offset	-	-150	

* Please contact us for other specifications.

Dimensions

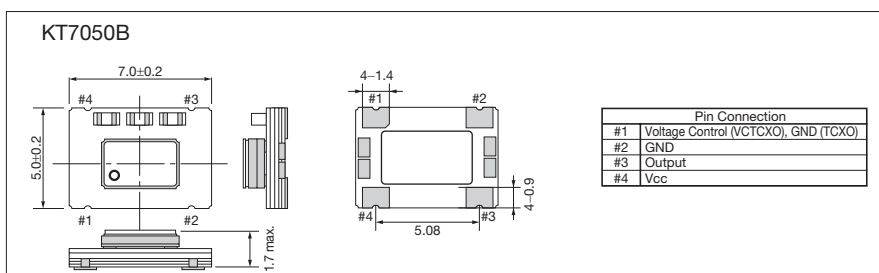
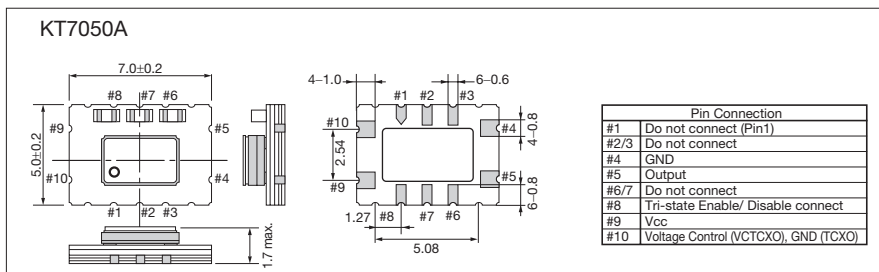

Recommended Land Pattern (Unit: mm)

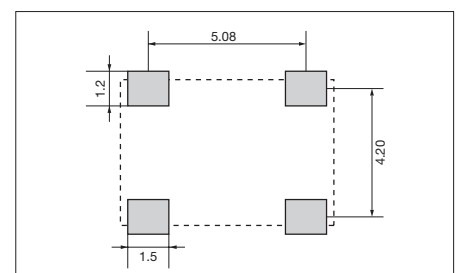
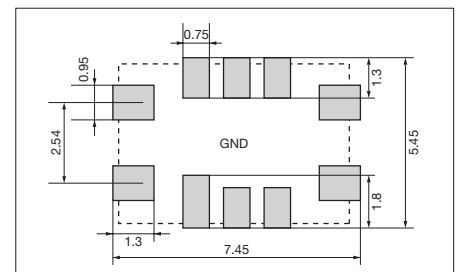

X-ON Electronics

Largest Supplier of Electrical and Electronic Components

Click to view similar products for [TCVCXO Oscillators](#) category:

Click to view products by [Kyocera](#) manufacturer:

Other Similar products are found below :

[FOX923CH-19.20M](#) [TG-5006CG-12H 26.0000M3](#) [TG-5035CG-13N 19.2000M3](#) [SIT5000ACC8E-33VQ-19.200000X](#) [TG5032SGN](#)
[40.0000M-CBGHNAB](#) [LFTVXO022175Bulk](#) [KT7050A10000KAW33TAD](#) [MAOC-009266-PKG003](#) [ASVTX-09-19.200MHZ-T](#)
[SiT5000AICGE-33E0-25.000000X](#) [LFTVXO075674CUTT](#) [ASVTX-12-C-19.200MHz-I15-T](#) [LFTVXO076345CUTT](#) [LFTVXO075803Cutt](#)
[LFTVXO076348CUTT](#) [LFTVXO075802Cutt](#) [LFTVXO076344CUTT](#) [KT2016K27600ZAW18TCS](#) [LFTVXO076343CUTT](#)
[LFTVXO073010Cutt](#) [LFTVXO072344CUTT](#) [LFTVXO073008Cutt](#) [LFTVXO076347CUTT](#) [LFTVXO076349CUTT](#) [LFTVXO076194CUTT](#)
[ASVTX-09-20.000MHz-T](#) [KT1612A26000ACW28TAN](#) [LFTVXO009901BULK](#) [ASGTX-C-100.000MHz-1](#) [ASGTX-C-120.000MHz-1](#)
[ASGTX-D-100.000MHz-1](#) [ASGTX-D-1.000GHz-1](#) [ASGTX-D-125.000MHz-1](#) [ASGTX-D-500.000MHz-1](#) [ASGTX-P-1.000GHz-1](#) [ASGTX-](#)
[P-1.500GHz-1](#) [ASGTX-P-500.000MHz-2](#) [ASGTX-D-1.000GHZ-2](#) [ASVTX-09-14.400MHZ-T](#) [ASVTX-09-16.000MHZ-T](#) [ASVTX-09-](#)
[16.800MHZ-T](#) [ASVTX-11-A-38.400MHz-T](#) [ASVTX-12-A-19.200MHZ-H10-T](#) [ASVTX-12-D-16.369MHz-I05-T](#) [ASVTX-12-D-19.200MHz-](#)
[I05-T](#) [ASVTX-13-C-16.369MHz-I05-T](#) [ASVTX-13-C-19.200MHz-I05-T](#) [ASVTX-13-C-26.000MHz-I05-T](#) [ASVTX-13-C-26.000MHz-I15-T](#)
[ASVTX-13-C-32.000MHz-I15-T](#)