

3D VIEW

REV NC DT06-12S*-CE04

REVISIONS			
SYM	DESCRIPTION	DATE	APPROVED
NC	REDRAWN/REPLACES PREVIOUS		
	RELEASE PER E.O. P18157	5-16-03	RDR

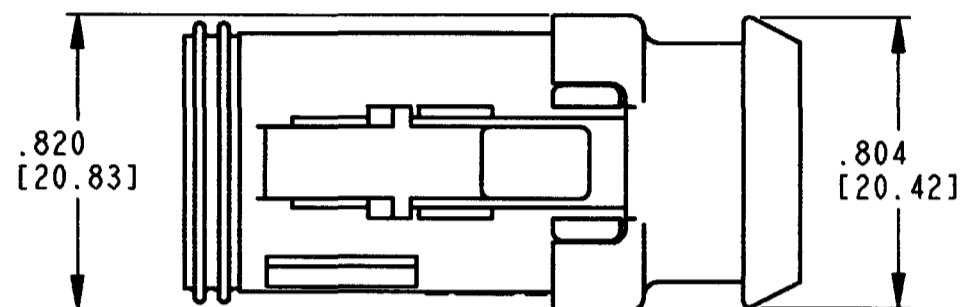

CONTACT SIZE	MIN. INSUL O.D.	MAX. INSUL O.D.	WIRE RANGE [mm ²] REF ONLY
16	.053 [1.35]	.120 [3.05]	14-20 AWG [2.0-0.5]

DATE CODE: MONTH IS REPRESENTED BY SEQUENTIAL ALPHA CHARACTERS. EX: A=JANUARY

DATE CODE: YEAR IS REPRESENTED BY THE LAST NUMERICAL DIGIT. EX: 0=2000.

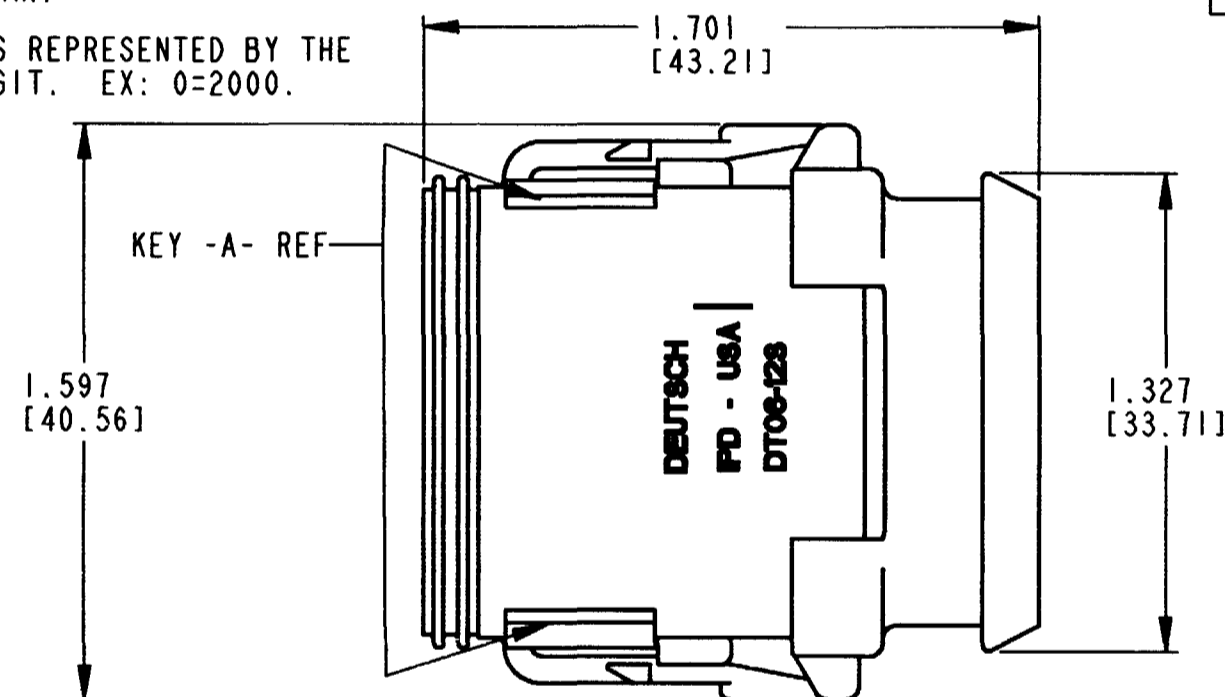
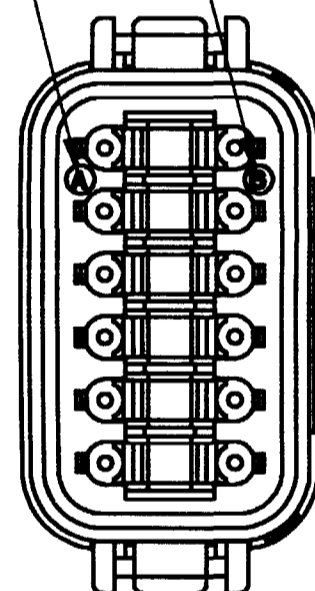

-E- DESIGNATES REDUCED DIAMETER WIRE SEAL

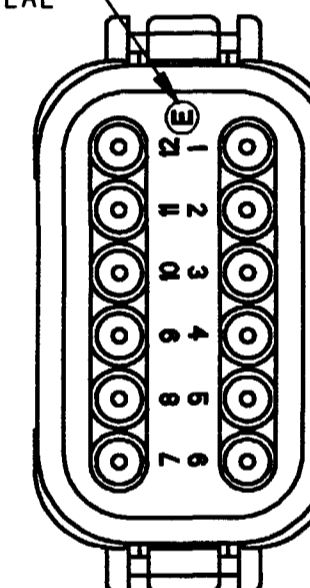

5. MATERIAL: SHELL: PLASTIC
SEAL: RUBBER

4. THIS PLUG MATES WITH DT04-12PA-**** (**** = ALL MODIFICATIONS). CONSULT FACTORY FOR MODIFICATIONS.

3. FOR CONTACTS AND WIRE PERFORMANCE AND APPLICATION CHARACTERISTICS SEE ENVELOPE DRAWING 0425-015-0000 AND 0425-017-0000.

2. DIMENSIONS ARE ±.025[0.63] UNLESS OTHERWISE SPECIFIED.

1. DIMENSIONS ARE IN INCHES [MILLIMETERS].

NOTES:

SIGNATURE & DATE	
DR	T. YOHANNES 5/2/03
CHK	D. M... 5/15/03
PE	T. Johannes 5/16/03
APPD	S. Band 5-7-03
SCALE	NONE WT

12 WAY PLUG
W/ EXTENDED WELD CAP
AND REDUCED WIRE SEALS
DT SERIES

ENVELOPE

CP	MATL. CODE
The Deutsch Company DEUTSCH I. P. D. 3850 INDUSTRIAL AVE. HEMET, CALIF. 92545	
B	DT06-12S*-CE04
DWG SIZE	CODE 11139 SHEET 1 OF 2

REV	DT06-12S*-CE04	REVISIONS		
SYM	DESCRIPTION	DATE	APPROVED	
NC	REDRAWN/REPLACES PREVIOUS			
	RELEASE PER E.O. P18157	5-16-03	ADR	

PART NO: DT06-12SA-CE04
KEY ARR. -A-
COLOR: GRAY

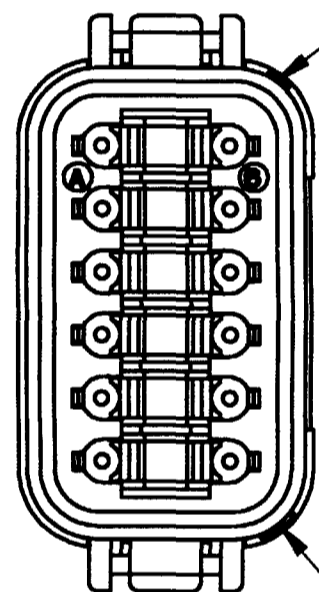

PART NO: DT06-12SB-CE04
KEY ARR. -B-
COLOR: BLACK

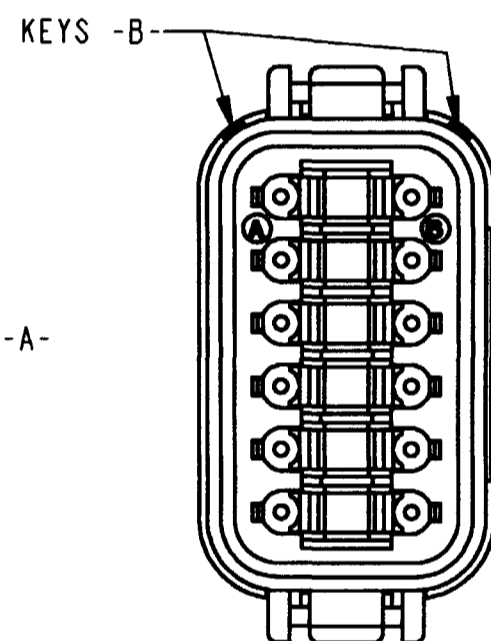

PART NO: DT06-12SC-CE04
KEY ARR. -C-
COLOR: GREEN

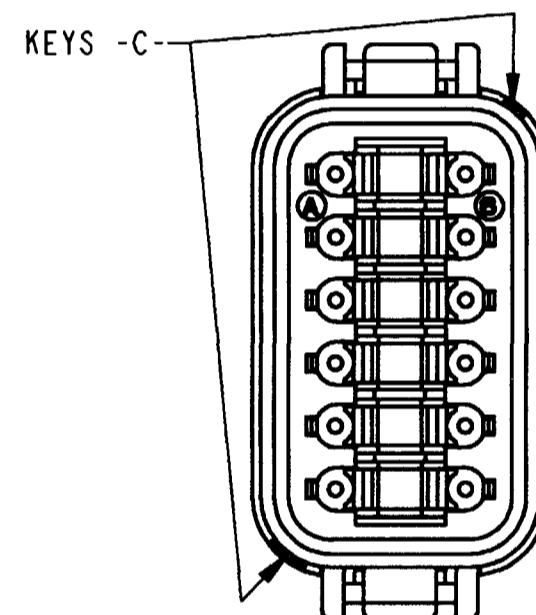

PART NO: DT06-12SD-CE04
KEY ARR. -D-
COLOR: BROWN

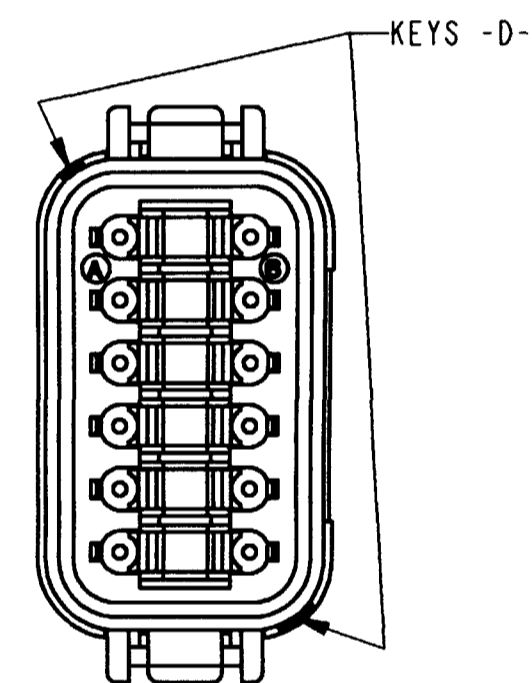

NOTES:

SIGNATURE & DATE		12 WAY PLUG W/ EXTENDED WELD CAP AND REDUCED WIRE SEALS DT SERIES	CP	MATL. CODE
DR	T. YOHANNES 5/2/03		The Deutch Company	
CHK	<i>D. Meyer</i> 5/15/03		DEUTSCH I. P. D. 3850 INDUSTRIAL AVE. HEMET, CALIF. 92545	
PE	<i>Tom Jones</i> 5/15/03		B	DT06-12S*-CE04
APPD	<i>S. Brand</i> 5-7-03	ENVELOPE	DWG SIZE	CODE 11139
SCALE	NONE WT			SHEET 2 OF 2

X-ON Electronics

Largest Supplier of Electrical and Electronic Components

Click to view similar products for [Automotive Connectors](#) category:

Click to view products by [TE Connectivity](#) manufacturer:

Other Similar products are found below :

[003-018-000](#) [600858](#) [60403001](#) [60993906-B](#) [60993913-B](#) [629515004020001](#) [M902-2131](#) [M902-2161](#) [M902-2344](#) [72.330.1035.1](#)
[73.353.4028.0](#) [F118010](#) [F119300-B](#) [F132210](#) [F132210-B](#) [F166900](#) [F180100](#) [F258300](#) [F258300-B](#) [F294300-B](#) [F339100](#) [F339700](#) [F358300-](#)
[B](#) [F374110](#) [F407400](#) [F412210](#) [F427600](#) [F444110](#) [F487000](#) [F495100-B](#) [F500900-B](#) [F509500B-B](#) [770444-1](#) [776880-1](#) [827153-1](#) [881735-1](#)
[8N1515-32-24P](#) [9-1326727-8](#) [9-1326729-8](#) [925467-1](#) [925474-1](#) [928905-1](#) [936398-2](#) [964562-1](#) [964562-4](#) [964731-2](#) [965051-1](#) [968782-1](#)
[GT17SA-8DS-HU](#) [GT17VS-10DP-5.2CF](#)