

APPROVED: _____
 DATE: _____ TITLE: _____

Rev	AWO #	Description	Date	Appr
-		RELEASED	4/13/05	
-		CHART UPDATE	4/27/06	
A		REDRAWN	12/8/11	

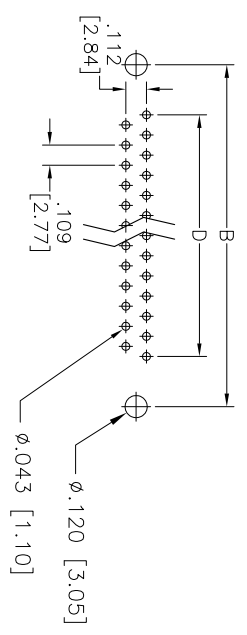
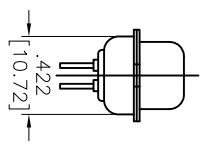
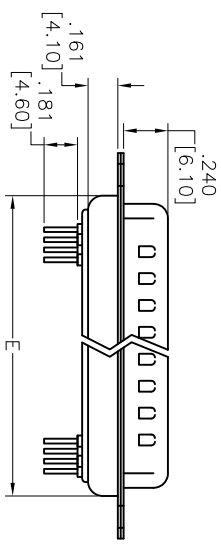
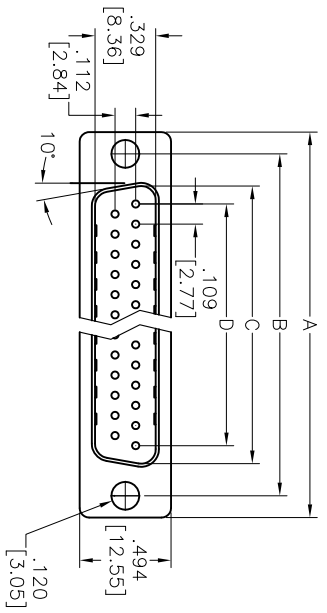

RECOMMENDED PCB LAYOUT

SPECIFICATIONS:

Material: Insulator: PBT, Thermoplastic, glass filled, rated UL 94V-0
 Insulator color: Black
 Contacts: Copper alloy
 Shell: Steel, Tin plated
Plating: Gold flash over Nickel underplate overall
Electrical: Operating voltage: 250 VAC max.
 Current rating: 1 Amp max.
 Contact resistance: 20 mohms max.
 Insulation resistance: 1,000 Mohms min. @DC 500V
 Dielectric withstanding voltage: 1,000 VAC for 1 minute
Temperature Rating: Operating temperature: -55°C to +85°C
Environmental: Lead free, RoHS compliant.

DXXX	NO. OF CONTACTS	DIMENSIONS				
		A	B	C	D	E
DE09	9	1.213 [30.81]	.984 [24.99]	.666 [16.92]	.436 [11.08]	.756 [19.20]
DA15	15	1.543 [39.20]	1.311 [33.30]	.994 [25.25]	.763 [19.39]	1.091 [27.70]
DB25	25	2.088 [53.04]	1.852 [47.04]	1.534 [38.96]	1.309 [33.24]	1.618 [41.10]
DC37	37	2.732 [69.40]	2.500 [63.50]	2.182 [55.42]	1.963 [49.86]	2.256 [57.30]

ADAM TECH

909 Railway Avenue, Union, NJ 07083
 Phone: 908-687-5000 Fax: 908-687-5710

**D-SUB PLUG, STRAIGHT PCB TAIL
 STANDARD PROFILE**

UNLESS OTHERWISE SPECIFIED ALL DIMENSIONS ARE INCHES [MM]		TITLE	
TOLERANCES: EXCEPT AS NOTED	INCHES	±.10	±.015
ØXX	±.10	ØXXX	±.015
.XX	±.020	ØXXX	±.010
.XXX	±.015	ØXXX	±.010
APPROVALS	DATE	SIZE	PART NO.
DRAWN	SS	4/13/05	DXXX-PT-1
CHECKED		X	
APPROVED		REF: S00087	SCALE: NTS



X-ON Electronics

Largest Supplier of Electrical and Electronic Components

Click to view similar products for [D-Sub Standard Connectors](#) category:

Click to view products by [Adam](#) manufacturer:

Other Similar products are found below :

[DCM37S732N](#) [DAM15P500](#) [DEV09S364GTLF](#) [DEM09P032N](#) [DDM50P732N](#) [DAM15S332N](#) [173109-2218](#) [173109-2466](#) [173109-2436](#)
[173109-2435](#) [56F706-005-LI](#) [56F711-015](#) [015-0341-000](#) [015-0372-008](#) [015-8544-011](#) [017041-0005](#) [020419-0104](#) [012-0515-000](#) [012-9507-](#)
[034](#) [012-9507-114](#) [012-9534-001](#) [020745-0008](#) [609-25P](#) [M24308/2-23Z](#) [M243082310F](#) [M243082410F](#) [M243082411F](#) [M24308/4-21](#)
[CT1A18-11PSA206](#) [CT1N36-5SC](#) [CT2-16S-17PS](#) [CT2-20-15PCAU](#) [CT2-24-12PS](#) [CT2-24-28PSF127A206](#) [CT2-32-9PC](#) [CT6F9767-14-4-](#)
[14S-5PC](#) [CT6FA10SL-4PS](#) [CT7-18-10SC](#) [CT7-18-10SCAU](#) [CT7-18-12SCAU](#) [CT7-18-1PC](#) [CT7-18-1PCAU](#) [CT7-18-21SCAU](#) [M83513/01-](#)
[FC](#) [M83723/76W24619 L/C](#) [M85049/48-3-2F](#) [69001-865](#) [6STD09PCM99B70X](#) [6STD09SCM99B30X](#) [6STD09SCT99S40X](#)