

Dimensions: mm (In.)

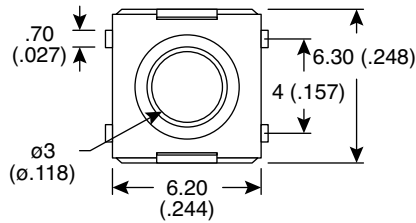

101-0267-EV

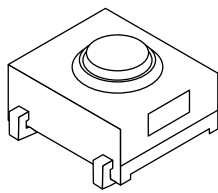
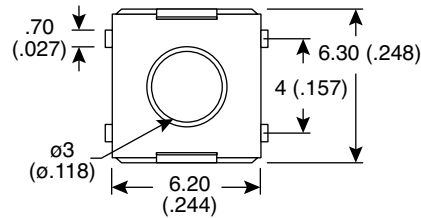
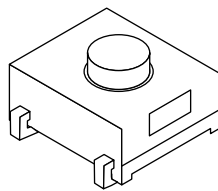
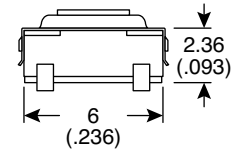
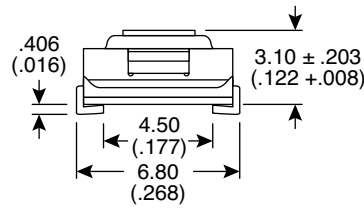

101-0367-EV

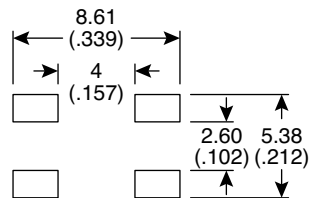
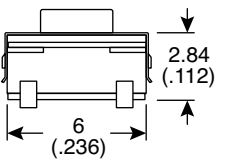
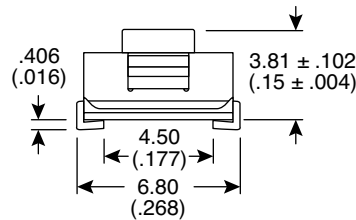

PCB Layout

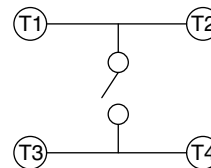

Circuit Diagram

Mechanical Specifications:

- Stop Strength: 3Kg for 15 seconds
- Operating Force: 160±50g (101-0267-EV), 180±50g (101-0367-EV)
- Operating Temperature: -25°~+70°C
- Storage Temperature: -30°~+80°C
- Travel: .25 +.02 -.1mm

Electrical Specifications:

- Life: 100,000 cycles (101-0267), 500,000 cycles (101-0367)
- Contact Resistance: 100mΩ max.
- Insulation Resistance: 100MΩ min. @ 500VDC
- Dielectric Strength: 250VAC for 1 minute
- Rating: 50mA / 12VDC

Notes:

- RoHS Compliant and process compatible with 260° solder
- General Tolerances: Max. ±.20mm

Materials:

- Cover: Stainless steel
- Contacts: Silver clad phosphor bronze
- Terminals: Silver clad brass
- Base: PPA, black

Tactile Switches
101-0267-EV, 101-0367-EV



X-ON Electronics

Authorized Distributor

Click to view similar products for [Tactile Switches](#) category:

[B3F-1060](#) [TLE1105BF250Q](#) [101-TS4322T3201-EV](#) [5GTH9658222](#) [SKQYPCE010](#)
[320.01E11WHT](#) [5ETH965](#) [SF320SH5X5H](#) [M22-KC01SMC10](#) [TL6215VF200GGT](#)