

AC Power Inlet

161-0714-7-E

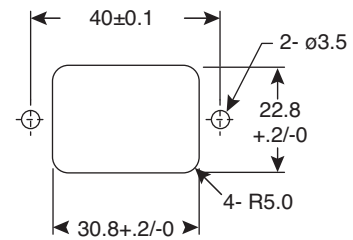

AC Power Inlet

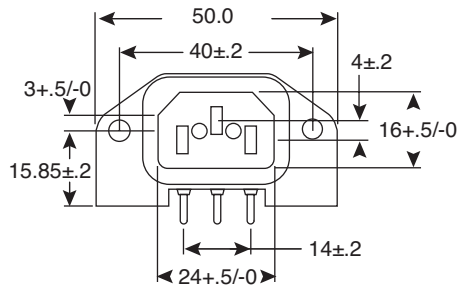
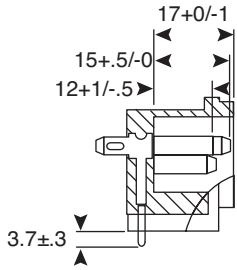

Rear Mounting

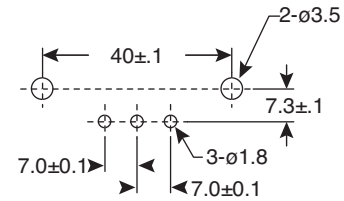
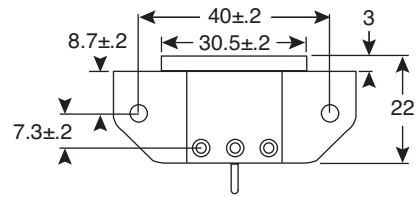
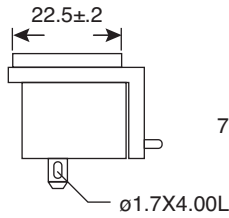

PCB Layout

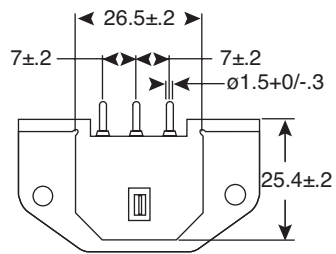

Dimensions: mm

SPECIFICATIONS	
Type:	PC mount
Rating:	15A 125V
Housing:	PBT with glass fiber filler
Terminals:	Copper alloy, tin plated
RoHS Compliant	

Date Last Revised: 12-6-06

Available from Mouser Electronics
 1-800-346-6873
 www.mouser.com

KC- 301082

161-0714-7-E

X-ON Electronics

Authorized Distributor

Click to view similar products for [AC Power Entry Modules](#) category:

[6200.4310](#) [BZV01/A0620/01](#) [2108-CQ](#) [1-6609152-9](#) [PS000DS6A](#) [5150.0021.1](#) [FN1394-10-05-11-QN-0](#) [FN9290B-6-100](#) [4EDL4M](#) [PS0SXSS60](#)