

PRODUCT NUMBER
10135175-XXXXOLF

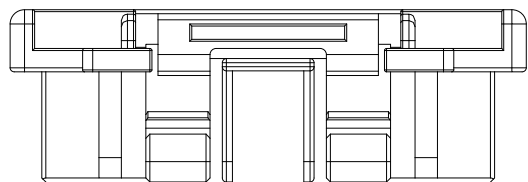

12~15 POS.
2 LOCKS

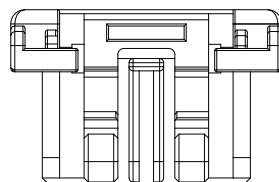

6~11 POS.
2 LOCKS

NOTE:

- 1. MATERIAL: NYLON 66, UL94 V-0.
- 2. RoHS & HF COMPLIANCE
- 3. PART NUMBER SCHEME:
10135175- XX X X 0 LF

No. OF POS.: 02~15

COLOR:
1: NATURAL

PACKAGE:
1: PE BAG

- 4. THE HSG USES FCI TERMINAL 10135176.
MATE WITH FCI CONNECTOR 10135177.
- 5. PRODUCT SPECIFICATION: GS-12-1321
- 6. PACKAGE SPECIFICATION: GS-14-2471
- 7. DIMENSIONAL TABLE:

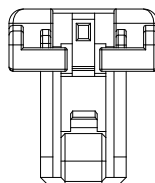
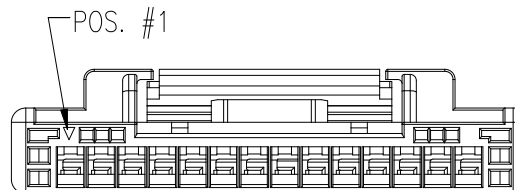
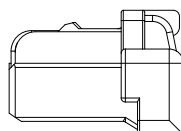
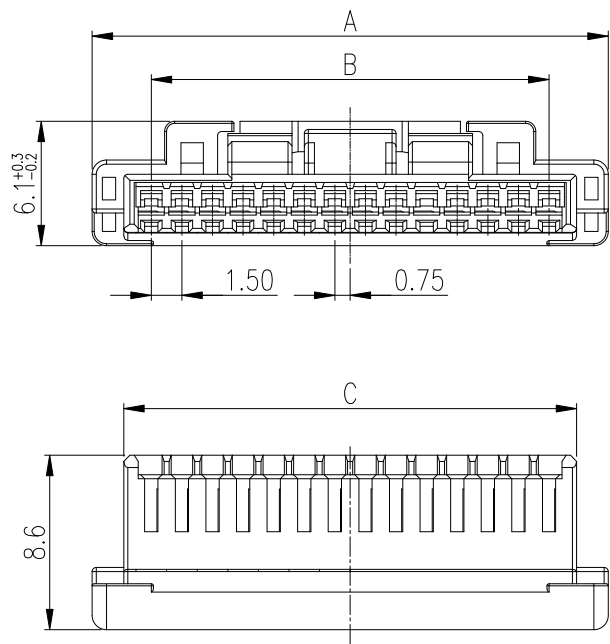

2 & 3 POS.
1 LOCK

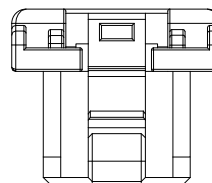

4 & 5 POS.
1 LOCK

Pos.	A	B	C
02	7.30	—	4.20
03	8.80	3.00	5.70
04	10.30	4.50	7.20
05	11.80	6.00	8.70
06	13.30	7.50	10.20
07	14.80	9.00	11.70
08	16.30	10.50	13.20
09	17.80	12.00	14.70
10	19.30	13.50	16.20
11	20.80	15.00	17.70
12	22.30	16.50	19.20
13	23.80	18.00	20.70
14	25.30	19.50	22.20
15	26.80	21.00	23.70

mat'l. code		surface <input checked="" type="checkbox"/> tolerance		projection		product family	
ltr		ecn no		dr		date	
A		TAI		2015-06-16		MINITEK 1.5mm WTB	
angles		linear		mm		title	
±2°		X.X±0.3		← mm →		MINITEK 1.5mm WIRE CONNECTOR, PLUG HOUSING	
dr		KENNY TAI		2015-05-08		scale	
enr		KENNY TAI		2015-05-08		dwg no	
chr		KENNY TAI		2015-06-10		sheet 1 of 1	
appd		PM ZHENG		2015-06-16		size	
sheet index		revision sheet		A 1		10135175	
						CUSTOMER Drawing	
						type	



X-ON Electronics

Largest Supplier of Electrical and Electronic Components

Click to view similar products for [Headers & Wire Housings](#) category:

Click to view products by [Amphenol](#) manufacturer:

Other Similar products are found below :

[95000-104TRLF](#) [10135584-644402LF](#) [DF62W-EP2022PCA](#) [95000-106TRLF](#) [DF62W-2022SCA](#) [DF62W-EP2022PC](#) [2203348](#) [DF62W-2022SC](#) [1084018](#) [1029039](#) [1084017](#) [802-10-012-10-002000](#) [1112640](#) [1112639](#) [000-34000](#) [0009482033](#) [0009507031](#) [57102-S06-03LF](#) [57202-S52-04LF](#) [PCN6-15S-2.5E](#) [0039019024](#) [58102-G61-06LF](#) [582553-1](#) [0009485154](#) [0009508121](#) [0022285053](#) [0050291907](#) [018731A](#) [LY20-4P-DT1-P1E-BR](#) [02.125.8002.8](#) [60101931](#) [60598-1 \(Cut Strip\)](#) [M1625-3R/100](#) [61062-3](#) [61082-181009](#) [636-1427](#) [638009-1](#) [641938-9](#) [641991-4](#) [644168-1](#) [647662-1](#) [65039-019ELF](#) [65817-002LF](#) [65817-015LF](#) [65863-015LF](#) [66207-023LF](#) [67016-026LF](#) [67046-001LF](#) [67095-007LF](#) [67230-005LF](#)