

CMMSH2-40**SURFACE MOUNT SILICON
SCHOTTKY RECTIFIER
2.0 AMP, 40 VOLT****SOD-123F CASE**www.centrasemi.com**DESCRIPTION:**

The CENTRAL SEMICONDUCTOR CMMSH2-40 is a 2.0A, silicon Schottky rectifier. This high efficiency, Schottky features high current capacity packaged in a small, thermally efficient, SOD-123F surface mount package. When compared to similar devices in the larger SMA package, this device is 58% smaller, with a 67% lower profile, making it ideally suited for applications where performance and size are critical.

MARKING CODE: CS240F**APPLICATIONS:**

- DC-DC Converters
- Voltage Clamping
- Protection Circuits
- Battery powered applications including Cell Phones, Digital Cameras, Pagers, PDA's, Laptop Computers, etc.

FEATURES:

- High Current (2.0A Max), 40V Device
- V_F 0.5V Max
- High Surge Current 50A
- Thermally efficient SOD-123F Flat Lead package design

MAXIMUM RATINGS: ($T_J=25^\circ\text{C}$)

| |
|---------------------------------|
| Peak Repetitive Reverse Voltage |
| DC Blocking Voltage |
| Average Forward Current |
| Peak Forward Surge Current |
| Power Dissipation (Note 1) |
| Operating Junction Temperature |
| Storage Temperature |
| Thermal Resistance |

SYMBOL

| SYMBOL | | UNITS |
|---------------|--------------|---------------------------|
| V_{RRM} | 40 | V |
| V_R | 40 | V |
| I_O | 2.0 | A |
| I_{FSM} | 50 | A |
| P_D | 550 | mW |
| T_J | -55 to + 125 | $^\circ\text{C}$ |
| T_{stg} | -55 to + 150 | $^\circ\text{C}$ |
| θ_{JA} | 181 | $^\circ\text{C}/\text{W}$ |

ELECTRICAL CHARACTERISTICS: ($T_J=25^\circ\text{C}$ unless otherwise noted)

| SYMBOL | TEST CONDITIONS | MIN | TYP | MAX | UNITS |
|--------|--|-----|------|------|---------------|
| I_R | $V_R=20\text{V}$ | | 3.0 | 150 | μA |
| I_R | $V_R=40\text{V}$ | | 23 | 500 | μA |
| I_R | $V_R=40\text{V}, T_J=85^\circ\text{C}$ | | | 25 | mA |
| BV_R | $I_R=0.5\text{mA}$ | 40 | | | V |
| V_F | $I_F=2.0\text{A}$ | | 0.45 | 0.50 | V |
| C_J | $V_R=10\text{V}, f=1.0\text{MHz}$ | | | 150 | pF |
| C_J | $V_R=0, f=1.0\text{MHz}$ | | 292 | | pF |

Note 1: FR-5 board (1.0 x 0.75 x 0.062in) with copper mounting pad area of 2.9mm²

R2 (23-November 2015)

CMMSH2-40

SURFACE MOUNT SILICON
SCHOTTKY RECTIFIER
2.0 AMP, 40 VOLT



SOD-123F CASE - MECHANICAL OUTLINE

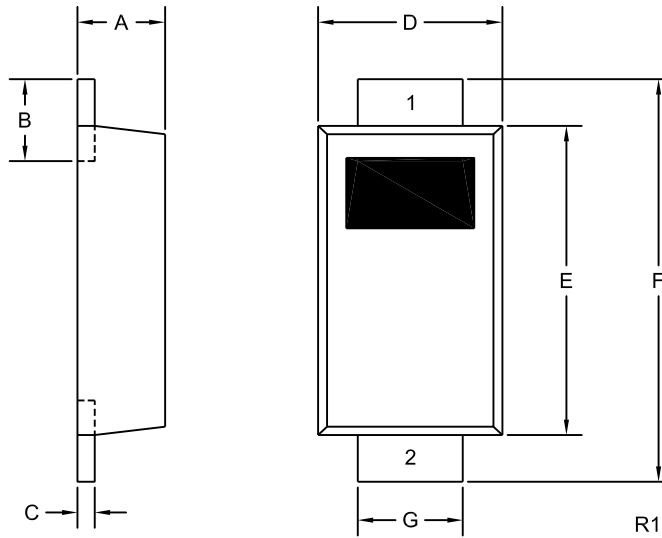

LEAD CODE:

- 1) Cathode
- 2) Anode

MARKING CODE: CS240F

| SYMBOL | INCHES | | MILLIMETERS | |
|--------|--------|-------|-------------|------|
| | MIN | MAX | MIN | MAX |
| A | 0.035 | 0.043 | 0.88 | 1.08 |
| B | 0.020 | 0.031 | 0.50 | 0.80 |
| C | 0.004 | 0.008 | 0.10 | 0.20 |
| D | 0.065 | 0.077 | 1.65 | 1.95 |
| E | 0.104 | 0.116 | 2.65 | 2.95 |
| F | 0.140 | 0.156 | 3.55 | 3.95 |
| G | 0.030 | 0.041 | 0.75 | 1.05 |

SOD-123F (REV:R1)

R2 (23-November 2015)

CMMSH2-40

SURFACE MOUNT SILICON
SCHOTTKY RECTIFIER
2.0 AMP, 40 VOLT



TYPICAL ELECTRICAL CHARACTERISTICS

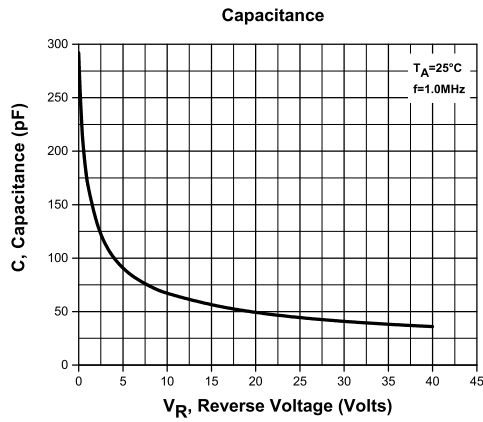
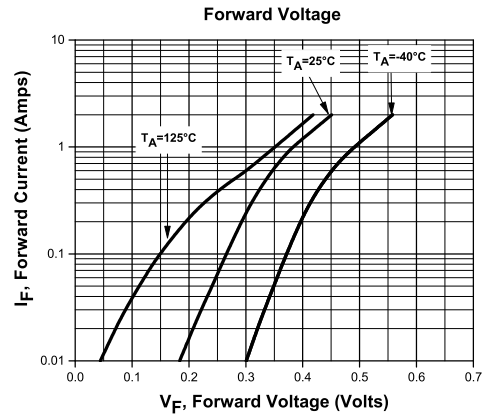
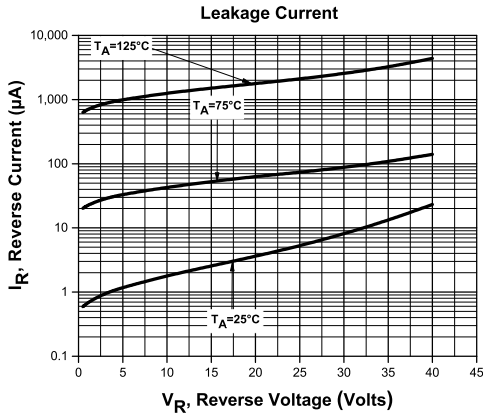

R2 (23-November 2015)

CMMSH2-40
SURFACE MOUNT SILICON
SCHOTTKY RECTIFIER
2.0 AMP, 40 VOLT



TYPICAL ELECTRICAL CHARACTERISTICS

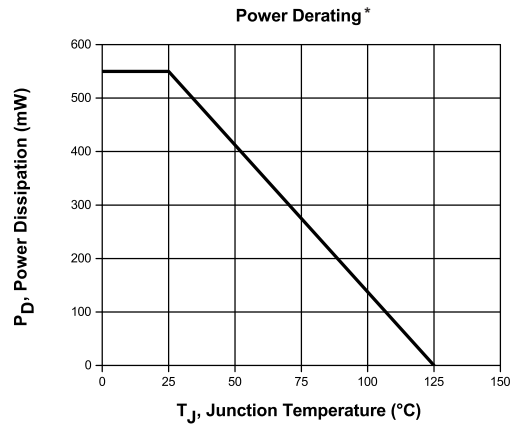
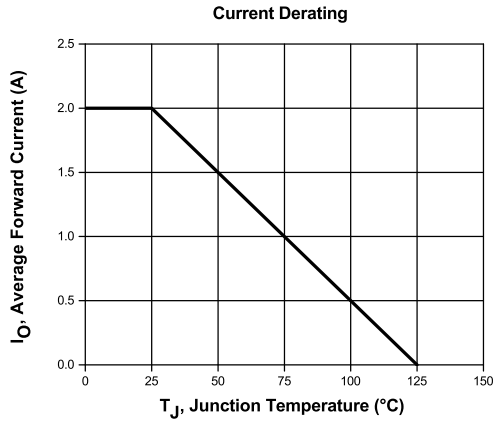

*FR-5 board (1.0 x 0.75 x 0.062in) with copper mounting pad area of 2.9mm²

R2 (23-November 2015)



OUTSTANDING SUPPORT AND SUPERIOR SERVICES

PRODUCT SUPPORT

Central's operations team provides the highest level of support to insure product is delivered on-time.

- Supply management (Customer portals)
- Inventory bonding
- Consolidated shipping options
- Custom bar coding for shipments
- Custom product packing

DESIGNER SUPPORT/SERVICES

Central's applications engineering team is ready to discuss your design challenges. Just ask.

- Free quick ship samples (2nd day air)
- Online technical data and parametric search
- SPICE models
- Custom electrical curves
- Environmental regulation compliance
- Customer specific screening
- Up-screening capabilities
- Special wafer diffusions
- PbSn plating options
- Package details
- Application notes
- Application and design sample kits
- Custom product and package development

REQUESTING PRODUCT PLATING

1. If requesting Tin/Lead plated devices, add the suffix " TIN/LEAD" to the part number when ordering (example: 2N2222A TIN/LEAD).
2. If requesting Lead (Pb) Free plated devices, add the suffix " PBFREE" to the part number when ordering (example: 2N2222A PBFREE).

CONTACT US

Corporate Headquarters & Customer Support Team

Central Semiconductor Corp.
145 Adams Avenue
Hauppauge, NY 11788 USA
Main Tel: (631) 435-1110
Main Fax: (631) 435-1824
Support Team Fax: (631) 435-3388
www.centalsemi.com

Worldwide Field Representatives:
www.centalsemi.com/wwreps

Worldwide Distributors:
www.centalsemi.com/wwdistributors

For the latest version of Central Semiconductor's **LIMITATIONS AND DAMAGES DISCLAIMER**, which is part of Central's Standard Terms and Conditions of sale, visit: www.centalsemi.com/terms

X-ON Electronics

Largest Supplier of Electrical and Electronic Components

Click to view similar products for [Schottky Diodes & Rectifiers](#) category:

Click to view products by [Central Semiconductor](#) manufacturer:

Other Similar products are found below :

[CUS06\(Te85L,Q,M\)](#) [MA4E2039](#) [D1FH3-5063](#) [MBR0530L-TP](#) [MBR10100CT-BP](#) [MBR30H100MFST1G](#) [MMBD301M3T5G](#) [PMAD1103-LF](#) [PMAD1108-LF](#) [RB160M-50TR](#) [RB520S-30](#) [RB551V-30](#) [DD350N18K](#) [DZ435N40K](#) [DZ600N16K](#) [BAS16E6433HTMA1](#) [BAS 3010S-02LRH E6327](#) [BAT 54-02LRH E6327](#) [IDL02G65C5XUMA1](#) [NSR05F40QNXT5G](#) [JANS1N6640](#) [SB07-03C-TB-H](#) [SB1003M3-TL-W](#) [SBAT54CWT1G](#) [SK32A-LTP](#) [SK33A-TP](#) [SK34A-TP](#) [SK34B-TP](#) [SMD1200PL-TP](#) [ACDBN160-HF](#) [SS3003CH-TL-E](#) [STPS30S45CW](#) [PDS3100Q-7](#) [GA01SHT18](#) [CRS10I30A\(Te85L,QM\)](#) [MA4E2501L-1290](#) [MBR1240MFST1G](#) [MBRB30H30CT-1G](#) [BAS28E6433HTMA1](#) [BAS 70-02L E6327](#) [HSB123JTR-E](#) [JANTX1N5712-1](#) [VS-STPS40L45CW-N3](#) [DD350N12K](#) [SB007-03C-TB-E](#) [SK110-LTP](#) [SK154-TP](#) [SK32A-TP](#) [SK33B-TP](#) [SK35A-TP](#)