

Dimensions: mm (in.)

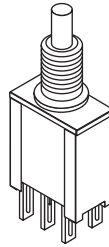

POS. 1	POS. 2
ON	MOM
1-3, 4-6	1-2, 4-5

SWITCH FUNCTION

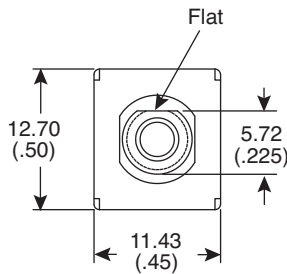

Without locking ring.

PANEL MOUNTING

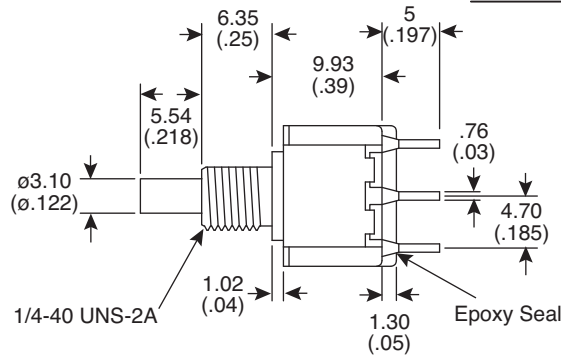

With standard locking ring.

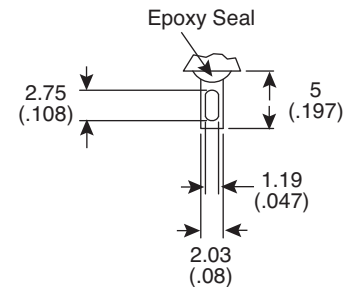
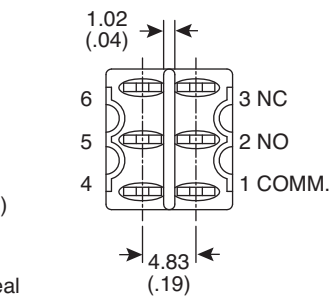
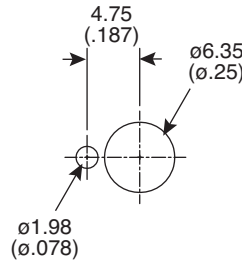

SOLDER LUG

Electrical Specifications:

- Rating: 1A/250VAC, 3A/120VAC or 28VDC
- Contact Resistance: 20mΩmax. initial @ 2-4VDC 100mA
- Insulation Resistance: 1,000MΩmin.
- Dielectric Strength: 1,000 V RMS@ sea level

Mechanical Specifications:

- Mechanical Life: 50,000 make-and-break cycles.
- Operating Temperature: -30°C to 85°C

Materials:

- Case: Dially phthalate (DAP) (UL94V-0)
- Plunger: Glass filled Nylon or Glass filled polyester
- Bushing: Brass, nickel plated
- Housing: Stainless steel.
- Contact: Silver plated.

Note:

- RoHS Compliant by Exemption

Snap-Acting Pushbutton Switch
107-3009-EVX



X-ON Electronics

Authorized Distributor

Click to view similar products for [Pushbutton Switches](#) category:

[65101K206X](#) [M7E-HRN2](#) [701PB580](#) [MB2011SB1W03-DF](#) [MB2061SS1W01-CF](#)

[MB2411JG01-H](#) [MB2411S1W01-HB](#) [9001KR1BH5](#) [9001KR9R05](#) [9001KXRK](#)