

REV  
NC DT04-12P\*-C015

REVISIONS			
SYM	DESCRIPTION	DATE	APPROVED
NC	NEW RELEASE/REPLACES PREVIOUS RELEASE PER E.O. P18766	2-21-05	RD

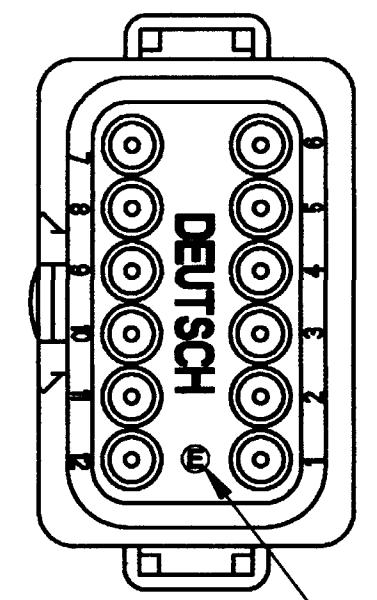

DATE CODE: MONTH IS REPRESENTED BY SEQUENTIAL ALPHA CHARACTERS.  
EX. A = JANUARY

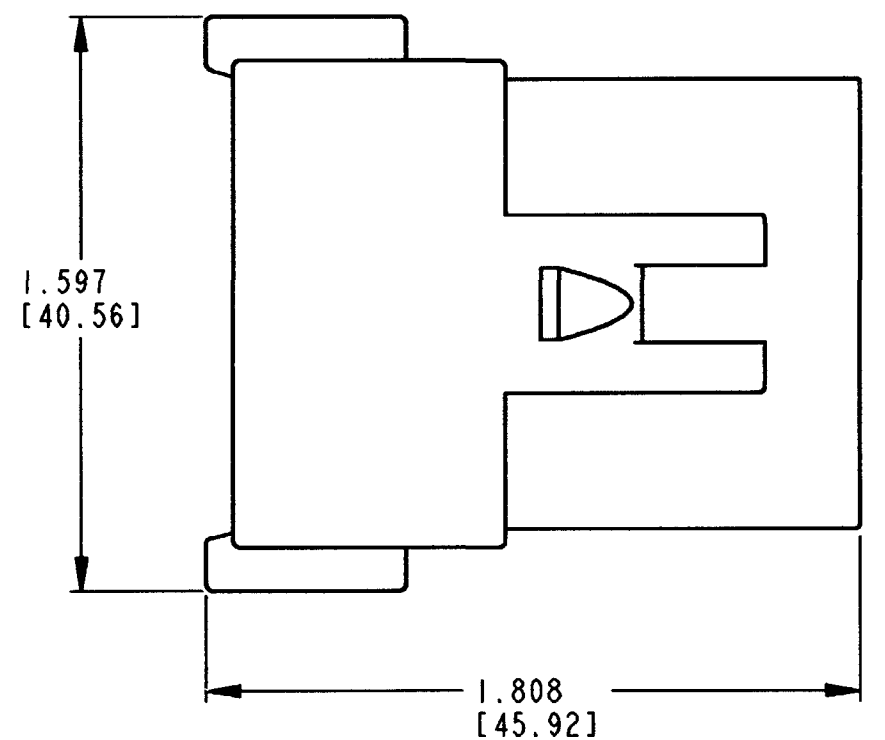
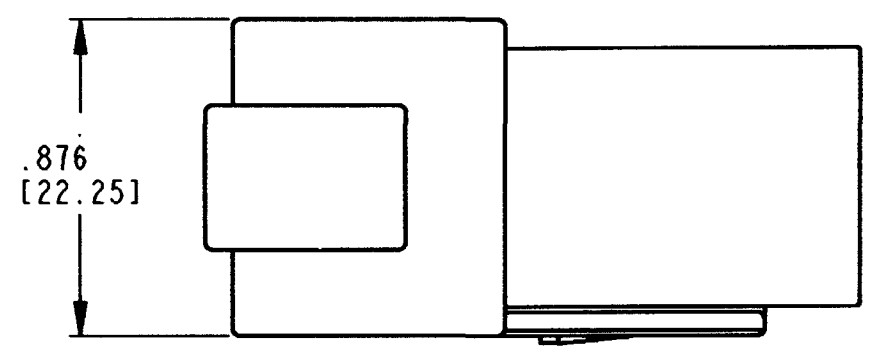
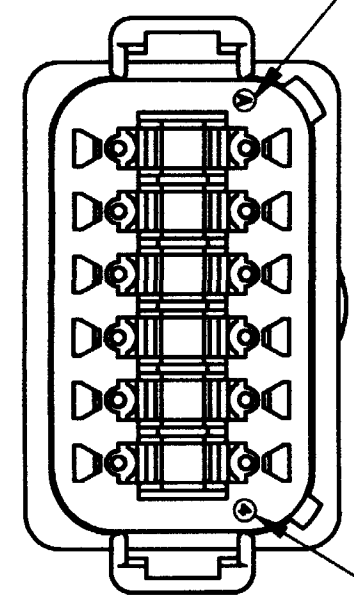

DATE CODE: YEAR IS REPRESENTED BY LAST NUMERICAL DIGIT.  
EX: 4 = 2004

-E- SYMBOL DESIGNATES REDUCED WIRE SEAL

CONTACT SIZE	MIN. INSUL O.D.	MAX. INSUL O.D.	WIRE RANGE [mm <sup>2</sup> ]
16	.053 [1.35]	.120 [3.05]	14-20 AWG [2.0-0.5]

4. THIS RECEPTACLE MATES WITH THE DT06-12S\*-\*\*\*\* PLUG (\*\*\*\* = ALL MODIFICATIONS). CONSULT FACTORY FOR MODIFICATIONS.
3. FOR CONTACTS AND WIRE PERFORMANCE AND APPLICATION CHARACTERISTICS SEE ENVELOPE DRAWING 0425-015-0000 AND 0425-017-0000.
2. DIMENSIONS ARE ±.025 [ .64] UNLESS OTHERWISE SPECIFIED.
1. DIMENSIONS ARE IN INCHES [MILLIMETERS].
- NOTES:

SIGNATURE & DATE	
DR	X. SANCHEZ 04FEB05
CHK	R. M... 2/18/05
PE	[Signature]
APPD	S. Bend 2-15-05
SCALE	NONE
WT	

12 WAY RECEPTACLE  
-C015 MOD.  
D.T. SERIES

ENVELOPE

CP	MATL. CODE
<b>The Deutsch Company</b> DEUTSCH I.P.D. 3850 INDUSTRIAL AVE. HEMET, CALIF. 92545	
<b>B</b>	<b>DT04-12P*-C015</b>
DWG SIZE	CODE 11139 SHEET 1 OF 2

REV	DT04-12P*-C015	REVISIONS			
NC		SYM	DESCRIPTION	DATE	APPROVED
		NC	NEW RELEASE/REPLACES PREVIOUS RELEASE PER E.O. P18766	2-21-05	RDR

PART NO.  
DT04-12PA-C015  
KEY ARR. -A-  
COLOR: GRAY

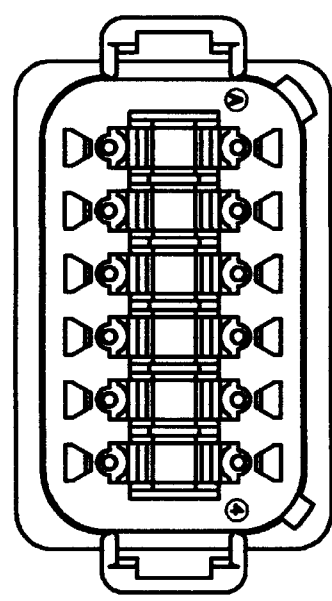

PART NO.  
DT04-12PB-C015  
KEY ARR. -B-  
COLOR: BLACK

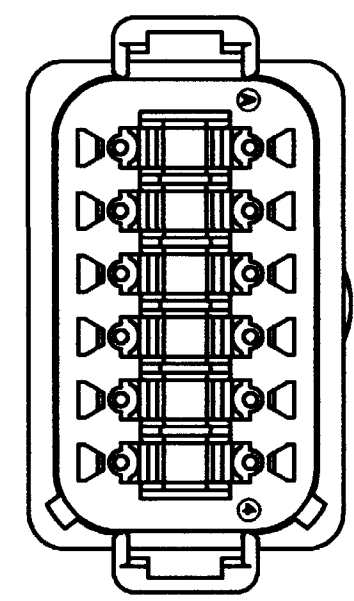

PART NO.  
DT04-12PC-C015  
KEY ARR. -C-  
COLOR: GREEN

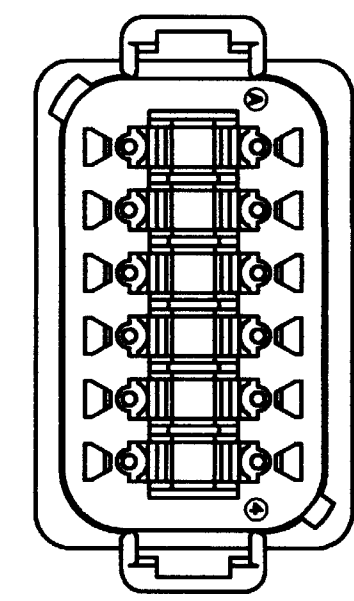

PART NO.  
DT04-12PD-C015  
KEY ARR. -D-  
COLOR: BROWN

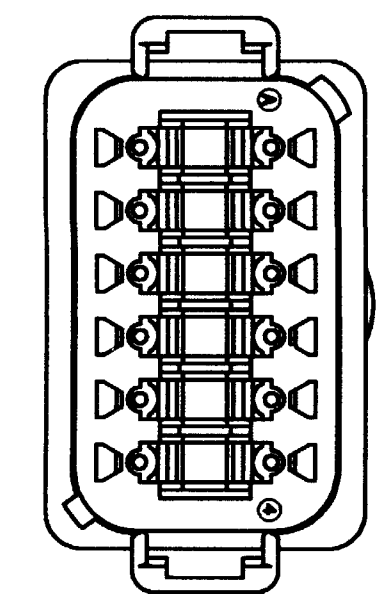

NOTES:

SIGNATURE & DATE		12 WAY RECEPTACLE -C015 MOD. D.T. SERIES	CP	MATL. CODE	
DR	X. SANCHEZ 04FEB05		The Deutch Company DEUTSCH I.P.D. 3850 INDUSTRIAL AVE. HEMET, CALIF. 92545		
CHK	R. MORGAN 2/16/05		B	DT04-12P*-C015	
PE	Steph Yelaman 2/1/05			DWG SIZE	CODE 11139
APPD	S. Bland 2-15-05	ENVELOPE			
SCALE	NONE	WT			

## X-ON Electronics

Largest Supplier of Electrical and Electronic Components

*Click to view similar products for [Automotive Connectors](#) category:*

*Click to view products by [TE Connectivity](#) manufacturer:*

Other Similar products are found below :

[003-018-000](#) [600858](#) [60403001](#) [60993906-B](#) [60993913-B](#) [629515004020001](#) [M902-2131](#) [M902-2161](#) [M902-2344](#) [72.330.1035.1](#)  
[73.353.4028.0](#) [F118010](#) [F119300-B](#) [F132210](#) [F132210-B](#) [F166900](#) [F180100](#) [F258300](#) [F258300-B](#) [F294300-B](#) [F339100](#) [F339700](#) [F358300-](#)  
[B](#) [F374110](#) [F407400](#) [F412210](#) [F427600](#) [F444110](#) [F487000](#) [F495100-B](#) [F500900-B](#) [F509500B-B](#) [770444-1](#) [776880-1](#) [827153-1](#) [881735-1](#)  
[8N1515-32-24P](#) [9-1326727-8](#) [9-1326729-8](#) [925467-1](#) [925474-1](#) [928905-1](#) [936398-2](#) [964562-1](#) [964562-4](#) [964731-2](#) [965051-1](#) [968782-1](#)  
[GT17SA-8DS-HU](#) [GT17VS-10DP-5.2CF](#)