

Test Points

151- Series

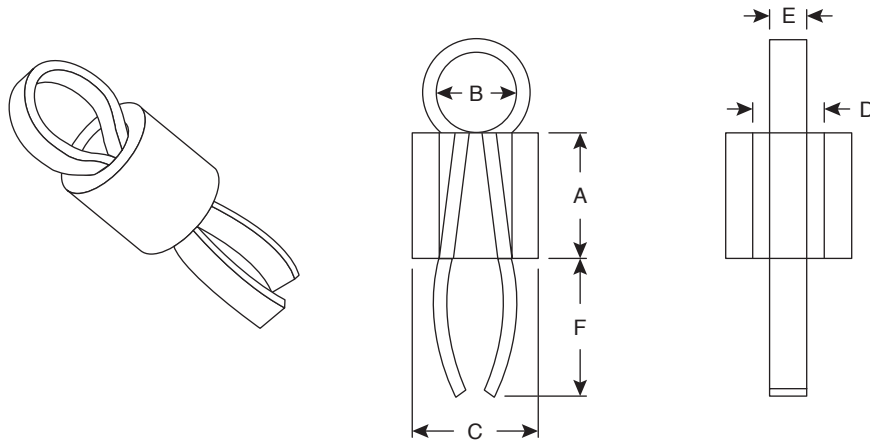

Test Points



SPECIFICATIONS	
Material Bead:	Boro Silicate Sintered Glass
Tag:	Phosphor Bronze BS 384 Solder Tinned
-RC:	RoHS Compliant Part

Glass Bead									
Coeff	Density	Viscosity Poise °C			Log (Ω CM)		Dielectric Properties		
Term. Expn.	g/cc	14.6	13	7.6	TR	DC Resistivity		Const	Loss Ang
X 10 ⁶ / °C		10	10	10	100	250°C	350°C		
4.94	2.27	475	515	719	365	10.1	8.2	5.7	0.003

Coefficient of expansion is quoted for the range of -50°C ~ +300°C.

Mouser Stock No.	Dimensions: In.						Board Thickness	Mounting Hole ø	Center to Center	Colors
	A	B	C	D	E	F				
151-101-RC	.112~.122	.080~.085	.113~.123	.059~.069	.032	.109	.063"	.052"	.125"	White
151-102-RC	.112~.122	.080~.085	.113~.123	.059~.069	.032	.109	.063"	.052"	.125"	Yellow
151-103-RC	.112~.122	.080~.085	.113~.123	.059~.069	.032	.109	.063"	.052"	.125"	Black
151-104-RC	.112~.122	.080~.085	.113~.123	.059~.069	.032	.109	.063"	.052"	.125"	Brown
151-105-RC	.112~.122	.080~.085	.113~.123	.059~.069	.032	.109	.063"	.052"	.125"	Blue
151-106-RC	.112~.122	.080~.085	.113~.123	.059~.069	.032	.109	.063"	.052"	.125"	Pink
151-107-RC	.112~.122	.080~.085	.113~.123	.059~.069	.032	.109	.063"	.052"	.125"	Red
151-107A-RC	.112~.122	.080~.085	.113~.123	.059~.069	.032	.109	.063"	.052"	.125"	Red
151-108-RC	.112~.122	.080~.085	.113~.123	.059~.069	.032	.109	.063"	.052"	.125"	Green
151-201-RC	.120~.130	.051~.059	.087~.097	.042~.052	.020	.109	.063"	.040"	.100"	White
151-202-RC	.120~.130	.051~.059	.087~.097	.042~.052	.020	.109	.063"	.040"	.100"	Yellow
151-203-RC	.120~.130	.051~.059	.087~.097	.042~.052	.020	.109	.063"	.040"	.100"	Black
151-204-RC	.120~.130	.051~.059	.087~.097	.042~.052	.020	.109	.063"	.040"	.100"	Brown
151-205-RC	.120~.130	.051~.059	.087~.097	.042~.052	.020	.109	.063"	.040"	.100"	Blue
151-206-RC	.120~.130	.051~.059	.087~.097	.042~.052	.020	.109	.063"	.040"	.100"	Pink
151-207-RC	.120~.130	.051~.059	.087~.097	.042~.052	.020	.109	.063"	.040"	.100"	Red
151-207A-RC	.120~.130	.051~.059	.087~.097	.042~.052	.020	.109	.063"	.040"	.100"	Red
151-208-RC	.120~.130	.051~.059	.087~.097	.042~.052	.020	.109	.063"	.040"	.100"	Green
151-301-RC	.112~.122	.080~.085	.113~.123	.059~.069	.032	.141	.094"	.052"	.125"	White
151-302-RC	.112~.122	.080~.085	.113~.123	.059~.069	.032	.141	.094"	.052"	.125"	Yellow
151-303-RC	.112~.122	.080~.085	.113~.123	.059~.069	.032	.141	.094"	.052"	.125"	Black
151-304-RC	.112~.122	.080~.085	.113~.123	.059~.069	.032	.141	.094"	.052"	.125"	Brown
151-305-RC	.112~.122	.080~.085	.113~.123	.059~.069	.032	.141	.094"	.052"	.125"	Blue
151-306-RC	.112~.122	.080~.085	.113~.123	.059~.069	.032	.141	.094"	.052"	.125"	Pink
151-307-RC	.112~.122	.080~.085	.113~.123	.059~.069	.032	.141	.094"	.052"	.125"	Red
151-307A-RC	.112~.122	.080~.085	.113~.123	.059~.069	.032	.141	.094"	.052"	.125"	Red
151-308-RC	.112~.122	.080~.085	.113~.123	.059~.069	.032	.141	.094"	.052"	.125"	Green

Date Last Revised: 9/16/16

Available from Mouser Electronics
1-800-346-6873
www.mouser.com

KC-300780

151 - Series

X-ON Electronics

Authorized Distributor

Click to view similar products for [Circuit Board Hardware - PCB category:](#)

[T42-1/M](#) [IT38040](#) [11016-B](#) [K32/C](#) [K30C/M](#) [MS272491B4](#) [4116](#) [4162](#) [BBN-BRG](#) [CLM-](#)

[7.5](#)