

This document is the property of Amphenol Corporation and is delivered on the express condition that it is not to be disclosed, reproduced or used, in whole or in part, for manufacture or sale by anyone other than Amphenol Corporation without its prior consent, & that no right is granted to disclose or to use any information in this document.

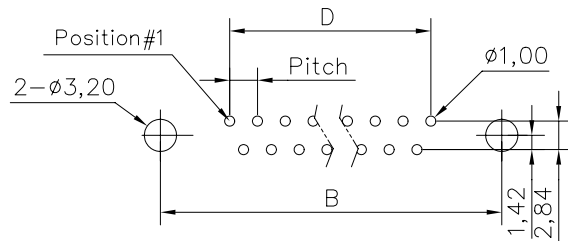
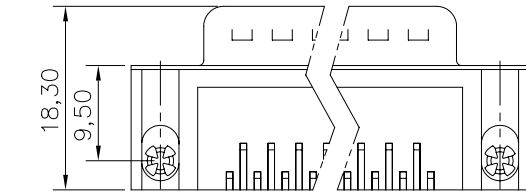
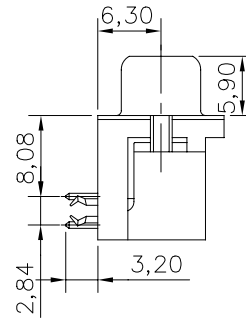
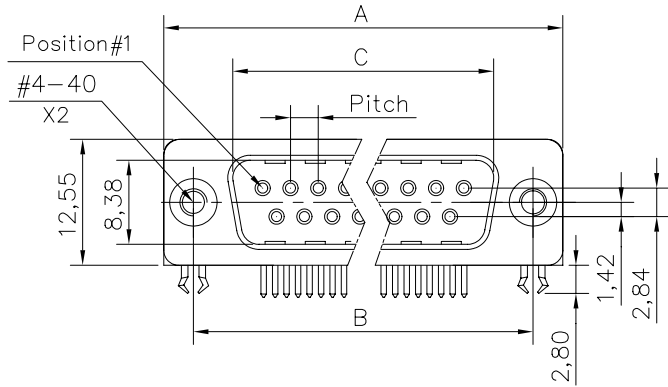

RECOMMENDED P.C.B LAYOUT
(TOLERANCE +/-0.03)

Customer drawing

DIM.S	SHELL	A	B	C	D	Pitch
		09	30.81	24.99	16.92	10.96
15	39.14	33.32	25.25	19.18	2.74	
25	53.04	47.04	38.96	33.24	2.77	
37	69.32	63.50	55.42	49.86	2.77	

REVISIONS				
SYM	ECN	DESCRIPTION	DATE	APPROVED
1			05/30/08	

D-SUB TECHNICAL DATA

SHELL : Steel, 100u" min tin over 50u" min nickel
 BODY : Glass filled thermoplastic.
 Flame retardant to UL94 V-0 Color Black
 CONTACTS : Copper alloy
 0.4um(15u") min gold over 1.25um (50u") min nickel on mating area.
 100u" min tin over 50" min nickel on solder area
 BOARDLOCK : Brass,100u" tin over 50u" min nickel
 REAR INSERT : Brass,100u" tin over 50u" min nickel
 ELECTRICAL : Voltage rating 600 V Rms to 50 Hz
 Current rating 5A
 Withstanding Voltage >1000 V Rms to 50 Hz for one minute
 Insulation resistance >5000 M Ohms
 Contact resistance 20 mOhms max.
 CLIMATIC : Temperature range -55 °C up to 150°C
 MARKING : Amphenol...(Series NO.)
 Commercial reference
 Manufacturing date

PRODUCT CODE

L 17HT N X P 4R 2 C

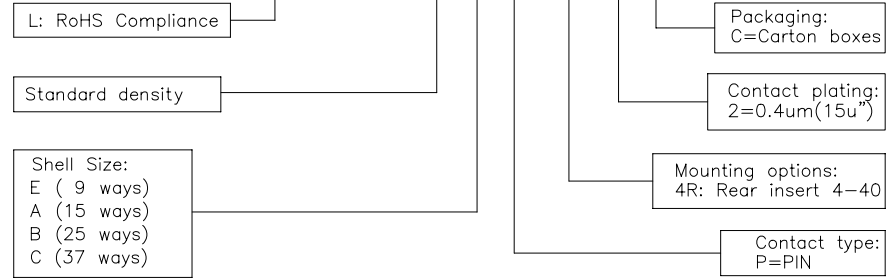

UNLESS OTHERWISE SPECIFIED TOLERANCES		APPROVAL	DATE
	U.S. METRIC	DRAWN	Christine.cui 05/30/08
.X	+/- 0.50	CHECKED	Lik.wang 05/30/08
.XX	+/- 0.30	CHECKED	
.XXX	+/- 0.20		
FRACTIONS	+/-		
ANGLES	+/- 2'		
FOR MATERIALS AND FINISHES SEE NOTES		DRAWING FILE :	
REMOVE SHARP EDGES		ANGLE OF PROJECTION	
DIMENSIONS			
U.S. INCHES			
METRIC MM			

Amphenol		
TITLE D-SUB connectors, HTN series		
SIZE	DRAWING NO.	REV.
A4	C L17HTNXP4R2C	1
SCALE	N/A	SHEET 1 OF 1

X-ON Electronics

Largest Supplier of Electrical and Electronic Components

Click to view similar products for [D-Sub Standard Connectors](#) category:

Click to view products by [Amphenol](#) manufacturer:

Other Similar products are found below :

[DCM37S732N](#) [DAM15P500](#) [DEV09S364GTLF](#) [DEM09P032N](#) [DDM50P732N](#) [DAM15S332N](#) [173109-2218](#) [173109-2466](#) [173109-2436](#)
[173109-2435](#) [56F706-005-LI](#) [56F711-015](#) [015-0341-000](#) [015-0372-008](#) [015-8544-011](#) [017041-0005](#) [020419-0104](#) [012-0515-000](#) [012-9507-](#)
[034](#) [012-9507-114](#) [012-9534-001](#) [020745-0008](#) [609-25P](#) [M24308/2-23Z](#) [M243082310F](#) [M243082410F](#) [M243082411F](#) [M24308/4-21](#)
[CT1A18-11PSA206](#) [CT1N36-5SC](#) [CT2-16S-17PS](#) [CT2-20-15PCAU](#) [CT2-24-12PS](#) [CT2-24-28PSF127A206](#) [CT2-32-9PC](#) [CT6F9767-14-4-](#)
[14S-5PC](#) [CT6FA10SL-4PS](#) [CT7-18-10SC](#) [CT7-18-10SCAU](#) [CT7-18-12SCAU](#) [CT7-18-1PC](#) [CT7-18-1PCAU](#) [CT7-18-21SCAU](#) [M83513/01-](#)
[FC](#) [M83723/76W24619 L/C](#) [M85049/48-3-2F](#) [69001-865](#) [6STD09PCM99B70X](#) [6STD09SCM99B30X](#) [6STD09SCT99S40X](#)