

① 06011WP HY36M-B

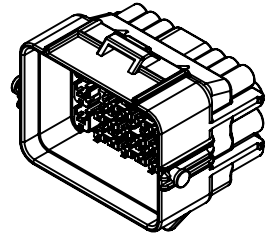

ISO VIEW

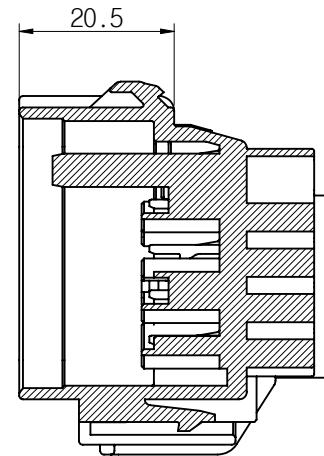
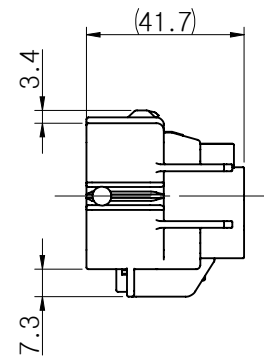
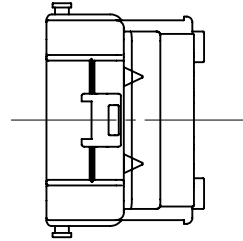
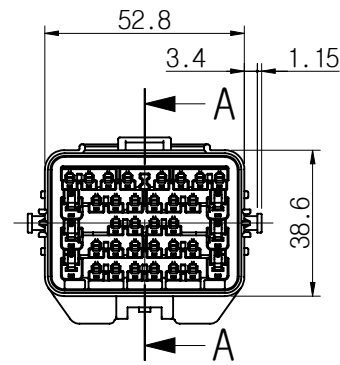

SECTION A-A(1/1)

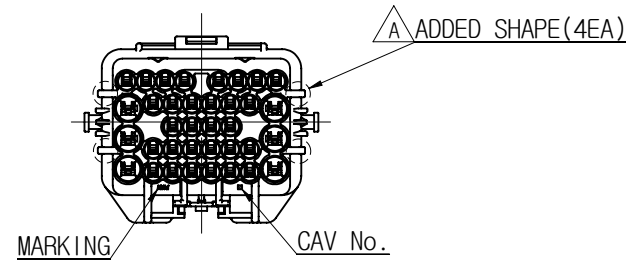

② F/H 06011WP HY36M-OR

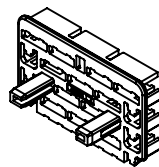

ISO VIEW

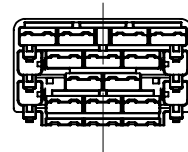
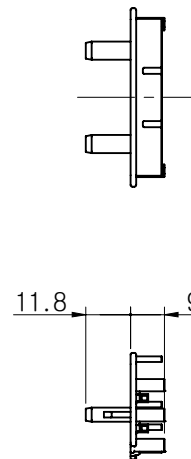
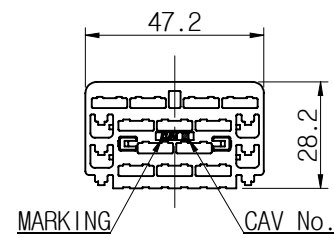

- NOTE -

- BEFORE USING, CHECK THE HARMFUL CRACK, BURR, ETC.
- GENERAL TOLERANCES - SEE BELOW.
- MARKING & CAV No. BY AS GENERAL RULE OF KUM
- ASSY PART

- FRONT HODLER : HP651-36100
- CONNECTOR CLIP : GC110-03020
- TERMINAL

Application Wire(Sq)	PART NAME	PART No
0.3 ~ 0.5 SQ	TML NWP-M-S	TP161-00100
0.75 ~ 1.25 SQ	TML NWP-M-M	TP161-00200
2.0 ~ 3.0 SQ	TML NWP-M-L	TP161-00300
0.3 ~ 0.5 SQ	TML NWP-M-S-Au	TP161-00110
0.75 ~ 1.25 SQ	TML NWP-M-M-Au	TP161-00210
2.0 ~ 3.0 SQ	TML NWP-M-L-Au	TP161-00310
0.22 SQ	TML AWP-M-SS	TP131-00400
0.3 ~ 0.5 SQ	TML AWP-M-S	TP131-00100
0.75 ~ 1.25 SQ	TML AWP-M-M	TP131-00200
0.22 SQ	TML AWP-M-SS-Au	TP131-00410
0.3 ~ 0.5 SQ	TML AWP-M-S-Au	TP131-00110
0.75 ~ 1.25 SQ	TML AWP-M-M-Au	TP131-00210

4) Wire Seal

Insulation Nominal Diameter	PART NAME	PART No
Φ1.4~Φ1.8	W/S NWP-3.6S(R)	EM010-00060
Φ1.9~Φ2.2	W/S NWP-2.8S(MB)	EM010-00140
Φ2.3~Φ2.7	W/S NWP-2.3S(GY)	EM010-00120
Φ2.8~Φ3.3	W/S NWP-1.9S(GN)	EM010-00030
Φ3.6~Φ4.0	W/S NWP-1.4S(OR)	EM010-00100
CLOSED SEAL	W/S NWP-V(BR)	EM010-00050
Φ0.9~Φ1.3	W/S AWP 0.9S(MB)	EB010-01140
Φ1.4~Φ1.8	W/S AWP 1.4S(BR)	EB010-01050
Φ1.9~Φ2.2	W/S AWP 1.9S(GN)	EB010-01030
Φ2.3~Φ2.6	W/S AWP 2.3S(GY)	EB010-01120
Φ2.7~Φ2.9	W/S AWP 2.7S(OR)	EB010-01100
CLOSED SEAL	W/S AWP-V(R)	EB010-01060

5. THIS PART IS WATERPROOF CONNECTOR.

APV	DATE	NOTE No.	SYM	ALTERATION	DWN
CJW	16.07.29	E016-0313	△	ADDED SHAPES(4EA)	LJW
CJW	14.08.27	E012-0211	△	RELEASED	LDW

NO.	PART NAME	PART No.	COLOR	MATERIAL
②	F/H 06011WP HY36M-OR	HP651-36100	ORANGE	PBT
①	06011WP HY36M-B	HP641-36020	BLACK	PBT

DRAWING NAME	06011WP HY36M-B
DRAWING No.	HP641-36020-C01A

GENERAL TOLERANCE							
	10MAX	50MAX	100MAX	150MAX	200MAX	200VR	ANGLE
A	±0.2	±0.3	±0.5	±0.8	±1.0	±1.4	±30'

THIRD ANGLE PROJECTION	A	1/2(1/1)	LDW	LDW	KNJ	CJW
TOLERANCE		SCALE	DESIGN	DRAWN	CHECKED	APPROVED

KUM 케이유엠

X-ON Electronics

Largest Supplier of Electrical and Electronic Components

Click to view similar products for [Headers & Wire Housings](#) category:

Click to view products by [KUM](#) manufacturer:

Other Similar products are found below :

[95000-104TRLF](#) [10135584-644402LF](#) [DF62W-EP2022PCA](#) [95000-106TRLF](#) [DF62W-2022SCA](#) [DF62W-EP2022PC](#) [2203348](#) [DF62W-2022SC](#) [1084018](#) [1029039](#) [1084017](#) [802-10-012-10-002000](#) [1112640](#) [1112639](#) [000-34000](#) [0009482033](#) [0009507031](#) [57102-S06-03LF](#) [57202-S52-04LF](#) [PCN6-15S-2.5E](#) [0039019024](#) [58102-G61-06LF](#) [582553-1](#) [0009508121](#) [0022285053](#) [0050291907](#) [018731A](#) [LY20-4P-DT1-P1E-BR](#) [02.125.8002.8](#) [60101931](#) [60598-1 \(Cut Strip\)](#) [M1625-3R/100](#) [61062-3](#) [61082-181009](#) [636-1427](#) [638009-1](#) [641938-9](#) [641991-4](#) [644168-1](#) [647662-1](#) [65039-019ELF](#) [65817-002LF](#) [65817-015LF](#) [65863-015LF](#) [66207-023LF](#) [67016-026LF](#) [67046-001LF](#) [67095-007LF](#) [67230-005LF](#) [68002-116](#)