

C303 SERIES



SPECIFICATIONS

Circuit	OFF-(ON)/Momentary SPST
Current Rating	:100mA
Voltage Rating	:12VDC
Dielectric voltage	:250VAC for 1 minute
Contact Resistance	:200mΩ Max . (intial)
Insulation Resistance	:100MΩ Min .
Operating Force	:250±100gf
Total Travel	4.5±0.2mm
Operating Force	:1,000,000 Cycles Min
Solder Specifications	:260°C for 5 Seconds
Operating Temperature	:-20°C~ +70°C



C3032 SERIES

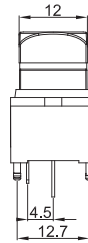
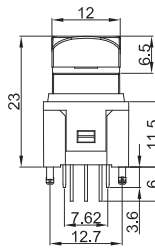
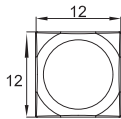

C3035 SERIES

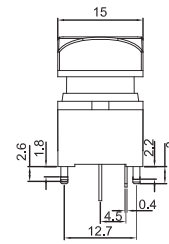
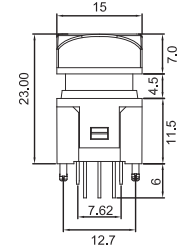
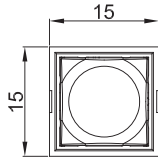

C3037 SERIES

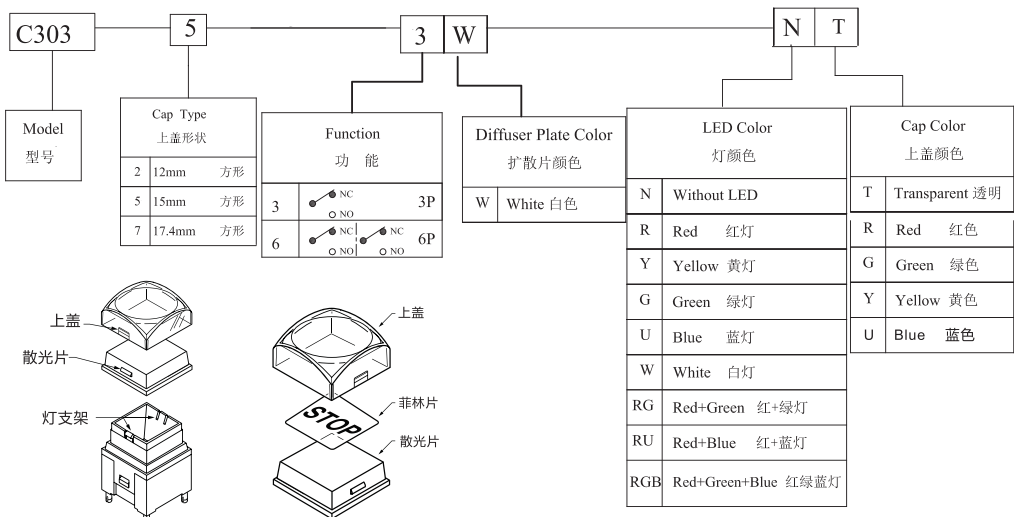
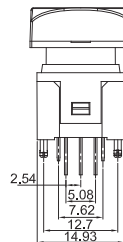
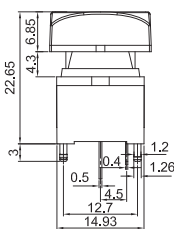
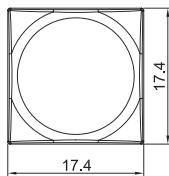

DIP
TACT
LED TACT
PUSH BUTTON
TOGGLE
SLIDE
ROCKER
MICRO / POWER

X-ON Electronics

Largest Supplier of Electrical and Electronic Components

Click to view similar products for [Optical Switches, Reflective, Photo IC Output](#) *category:*

Click to view products by [Challenge manufacturer:](#)

Other Similar products are found below :

[GP2A230LRSF](#) [GP2A240LCS0F](#) [EE-SPY801](#) [EE-SPY802](#) [AEDR-8100-1P2](#) [AEDR-8710-102](#) [AEDR-8711-102](#) [AEDR-8712-102](#) [AEDR-83001K2](#) [AEDR-8300-1Q2](#) [ECS-22RP1R-1000](#) [ECS-22RP2R-1010](#) [ECS-22RP3R-1000](#) [ECS-22RP1Y-1000](#) [ECS-22RP2Y-1010](#) [ECS-22RP3Y-1000](#) [ECS-22RP1G-1000](#) [ECS-22RP2G-1010](#) [ECS-22RP3G-1000](#) [ECS-22RP1G-1020-L24G](#) [ECS-22RP2R-1030-L24R](#) [ECS-22RL1G-0020-L24G](#) [ECS-22RL1R-0020-L24R](#) [ML6-H4KA2VA](#) [K6-8859D-04](#) [C3012A-TW-R-V](#) [C3012-TW-B-V](#) [ML6-H4K12PGVA](#) [ECS-22RP2G-1030-L24G](#) [ECC128973EU](#) [ECC128974EU](#) [ECC128975EU](#) [K6-1212A-04](#) [K6-6133D-L1-02](#) [K6-6136D-L1-04](#) [K6-6140D-03](#) [K6-6270S-02](#) [K6-6271D-02](#) [K6-6272S-02](#) [ML6-H4K12GVA](#) [EE-SPY415](#) [EE-SY310](#) [EE-SY410](#) [EE-SY413](#) [GP2A200LCSCF](#) [GP2A25J0000F](#) [TLLAG-72APG-R1KH1-V-A](#) [TLLAG-72BB-R1KH2-V-A](#) [TLLAG-72BG-R1KH1-V-A](#) [TLLAG-72BPG-R1SH1-V-A](#)