



PINGWEI ENTERPRISE

MBR2020FCT THRU MBR20200FCT

20.0AMPS. SCHOTTKY BARRIER RECTIFIERS

FEATURE

- . High current capability
- . Low forward voltage drop
- . Low power loss, high efficiency
- . High surge capability
- . High temperature soldering guaranteed
260°C /10seconds, 0.25"(6.35mm)from case.

MECHANICAL DATA

- . Terminal: Plated axial leads solderable per MIL-STD 202E, method 208C
- . Case: Molded with UL-94 Class V-0 recognized Flame Retardant Epoxy
- . Polarity: color band denotes cathode
- . Mounting position: any

ITO-220AB

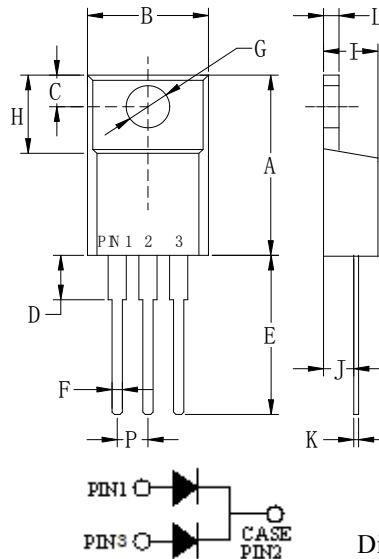

| Dim | Min | Max |
|-----|-------------|-------------|
| A | .571 (14.5) | .610 (15.5) |
| B | .383 (9.72) | .406 (10.3) |
| C | .110 (2.80) | .126 (3.2) |
| D | .133 (3.38) | .162 (4.1) |
| E | .512 (13.0) | .551 (14.0) |
| F | .028 (0.7) | .035 (0.90) |
| G | .114 (2.9) | .138 (3.5) |
| H | .268 (6.8) | .291 (7.4) |
| I | .162 (4.1) | .185 (4.7) |
| J | .102 (2.6) | .110 (2.8) |
| K | .018 (0.45) | .026 (0.65) |
| L | .097 (2.46) | .113 (2.86) |
| P | .89 (2.25) | .113 (2.85) |

Dimensions in inches and (millimeters)

MAXIMUM RATINGS AND ELECTRICAL CHARACTERISTICS

Ratings at 25°C ambient temperature unless otherwise specified.

Single phase, half wave, 60Hz, resistive or inductive load.

For capacitive load, derate current by 20%

| Type Number | SYM BOL | MBR 2020 FCT | MBR 2040 FCT | MBR 2050 FCT | MBR 2060 FCT | MBR 2080 FCT | MBR 20100 FCT | MBR 20150 FCT | MBR 20200 FCT | units | |
|---|-------------|--------------|--------------|--------------|--------------|--------------|---------------|---------------|---------------|---------------------------|----|
| Maximum Recurrent Peak Reverse Voltage | V_{RRM} | 20 | 40 | 50 | 60 | 80 | 100 | 150 | 200 | V | |
| Maximum RMS Voltage | V_{RMS} | 14 | 28 | 35 | 42 | 56 | 70 | 105 | 140 | V | |
| Maximum DC blocking Voltage | V_{DC} | 20 | 40 | 50 | 60 | 80 | 100 | 150 | 200 | V | |
| Maximum Average Forward Rectified Current at $T_C = 100^\circ\text{C}$ | $I_{F(AV)}$ | 20.0 | | | | | | | | A | |
| Peak Forward Surge Current 8.3ms single half sine-wave superimposed on rated load (JEDEC method) | I_{FSM} | 175.0 | | | | | | | | A | |
| Maximum Forward Voltage at 10.0A DC | V_F | 0.45 | 0.55 | 0.70 | | | 0.85 | 0.95 | | V | |
| Maximum DC Reverse Current @ $T_A = 25^\circ\text{C}$ at rated DC blocking voltage @ $T_A = 100^\circ\text{C}$ | I_R | 0.5 | | | 40.0 | | | 0.1 | | 10.0 | mA |
| Typical Junction Capacitance (Note 1) | C_J | 700 | | | | | 300 | | | pF | |
| Typical Thermal Resistance (Note 2) | $R_{(JC)}$ | 3.0 | | | | | | | | $^\circ\text{C}/\text{W}$ | |
| Storage Temperature | T_{STG} | -55 to +150 | | | | | | | | $^\circ\text{C}$ | |
| Operation Junction Temperature | T_J | -55 to +125 | | | -55 to +150 | | | | | $^\circ\text{C}$ | |

Note:

1. Measured at 1.0 MHz and applied reverse voltage of 4.0Vdc
2. Thermal Resistance from Junction to Case Mounted on Heatsink

RATING AND CHARACTERISTIC CURVES (MBR2020FCT THRU MBR20200FCT)

FIG.1-TYPICAL FORWARD CURRENT DERATING CURVE

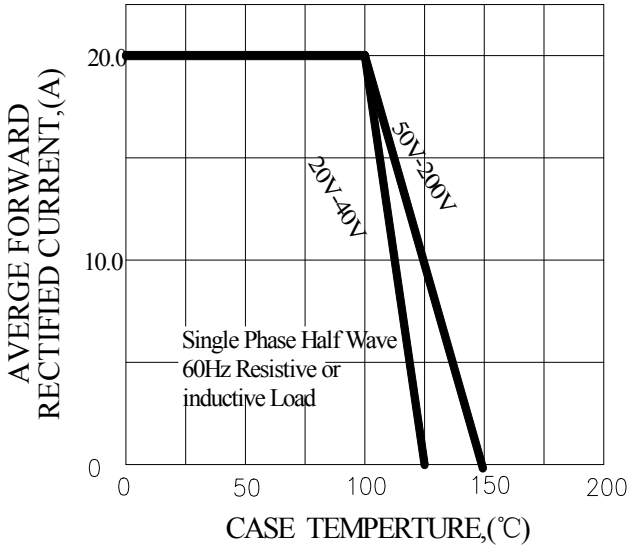

FIG.2-TYPICAL INSTANTANEOUS FORWARD CHARACTERISTICS

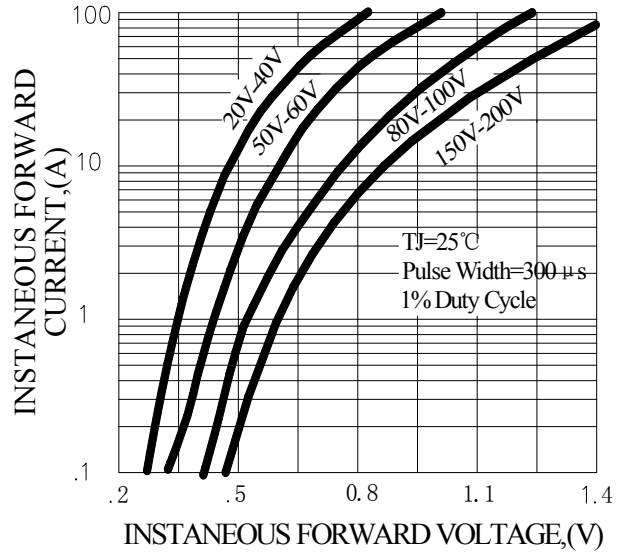

FIG.3-MAXIMUM NON-REPETITIVE FORWARD SURGE CURRENT

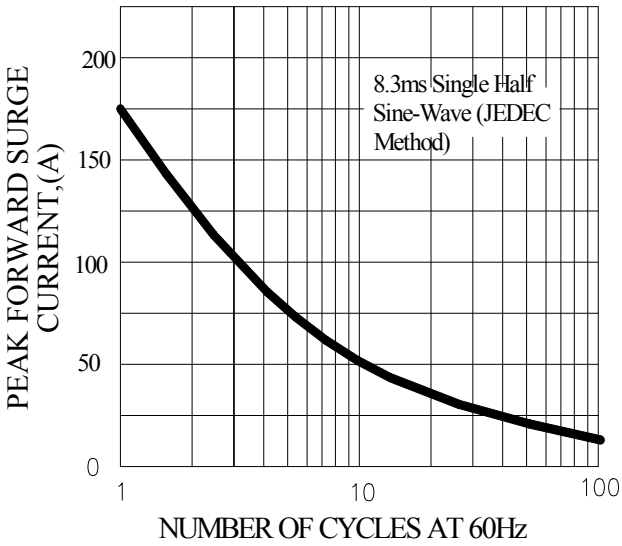
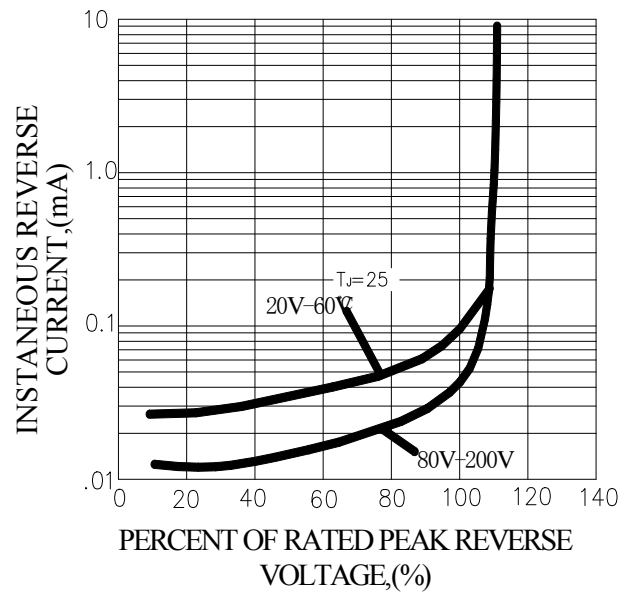

FIG.4-TYPICAL REVERSE CHARACTERISTICS



X-ON Electronics

Largest Supplier of Electrical and Electronic Components

Click to view similar products for [Schottky Diodes & Rectifiers](#) category:

Click to view products by [Pingwei](#) manufacturer:

Other Similar products are found below :

[CUS06\(TE85L,Q,M\)](#) [MA4E2039](#) [D1FH3-5063](#) [MBR0530L-TP](#) [MBR10100CT-BP](#) [MBR30H100MFST1G](#) [MMBD301M3T5G](#) [PMAD1103-LF](#) [PMAD1108-LF](#) [RB160M-50TR](#) [RB520S-30](#) [RB551V-30](#) [DD350N18K](#) [DZ435N40K](#) [DZ600N16K](#) [BAS16E6433HTMA1](#) [BAS 3010S-02LRH E6327](#) [BAT 54-02LRH E6327](#) [IDL02G65C5XUMA1](#) [NSR05F40QNXT5G](#) [JANS1N6640](#) [SB07-03C-TB-H](#) [SB1003M3-TL-W](#) [SBAT54CWT1G](#) [SK32A-LTP](#) [SK33A-TP](#) [SK34A-TP](#) [SK34B-TP](#) [SMD1200PL-TP](#) [ACDBN160-HF](#) [SS3003CH-TL-E](#) [STPS30S45CW](#) [PDS3100Q-7](#) [GA01SHT18](#) [CRS10I30A\(TE85L,QM](#) [MA4E2501L-1290](#) [MBR1240MFST1G](#) [MBRB30H30CT-1G](#) [BAS28E6433HTMA1](#) [BAS 70-02L E6327](#) [HSB123JTR-E](#) [JANTX1N5712-1](#) [VS-STPS40L45CW-N3](#) [DD350N12K](#) [SB007-03C-TB-E](#) [SK110-LTP](#) [SK154-TP](#) [SK32A-TP](#) [SK33B-TP](#) [SK35A-TP](#)