

# Specification for Approval

Date: 2019/1/10

Certificate  
Green Partner

Customer : 天誠

TAI-TECH P/N: FCM1005KF-102T03

CUSTOMER P/N:

DESCRIPTION:

QUANTITY: pcs

REMARK:

Customer Approval Feedback

西北臺慶科技股份有限公司  
**TAI-TECH Advanced Electronics Co., Ltd**

代理商：

■ 深圳市天誠科技有限公司  
Shenzhen TsaSun Technology Co., Ltd.  
ROOM601, BLOCK F, CULTURE CREATIVE PARK, NO.4001 FUQIANG ROAD  
FUTIAN DISTRICT, SHENZHEN CHINA  
TEL: +86-755-83358885 FAX: +86-0755-83351010  
E-mail: sales@tsasun.com

□ 西北臺慶科技股份有限公司  
TAI-TECH Advanced Electronics Co., Ltd Headquarter:  
NO.1 YOU 4TH ROAD, YOUTH INDUSTRIAL DISTRICT, YANG-MEI,  
TAO-YUAN HSIEN, TAIWAN, R.O.C.  
TEL: +886-3-4641148 FAX: +886-3-4643565  
http://www.tai-tech.com.tw  
E-mail: sales@tai-tech.com.tw

□ 臺慶精密電子(昆山)有限公司  
TAI-TECH ADVANCED ELECTRONICS(KUNSHAN) CO., LTD  
SHINWHA ROAD, KUNJIA HI-TECH INDUSTRIAL PARK, KUN-SHAN,  
JIANG-SU, CHINA  
TEL: +86-512-57619396 FAX: +86-512-57619688  
E-mail: sales@tai-tech.cn

□ 慶邦電子元件(泗洪)有限公司  
TAIPAQ ELECTRONICS (SIHONG) CO., LTD  
JIN SHA JIANG ROAD, CONOMIC DEVELOPMENT ZONE SIHONG, JIANGSU,  
CHINA.  
TEL: +86-527-88601191 FAX: +86-527-88601190  
E-mail: sales@taipaq.cn

Sales Dep.

APPROVED	CHECKED
崩青榮	王歡

R&amp;D Center

APPROVED	CHECKED	DRAWN
鄧福興	浦冬生	王俞琴

# Ferrite Chip Bead(Lead Free)

FCM1005KF-102T03

## 1.Features

- 1.Monolithic inorganic material construction.
- 2.Closed magnetic circuit avoids crosstalk.
- 3.S.M.T. type.
- 4.Suitable for flow and reflow soldering.
- 5.Shapes and dimensions follow E.I.A. spec.
- 6.Available in various sizes.
- 7.Excellent solderability and heat resistance.
- 8.High reliability.
- 9.This component is compliant with RoHS legislation and also support lead-free soldering.



## 2.Dimensions

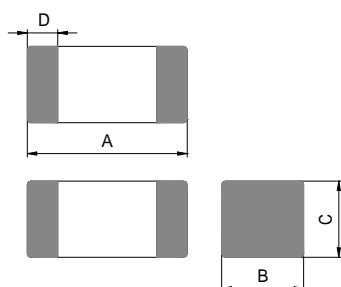

Chip Size	
A	1.00±0.10
B	0.50±0.10
C	0.50±0.10
D	0.25±0.10

Units: mm

## 3.Part Numbering



A: Series  
 B: Dimension  
 C: Material  
 D: Impedance  
 E: Packaging  
 F: Rated Current

L x W  
 Lead Free Material  
 102=1000  
 T=Taping and Reel, B=Bulk(Bags)  
 03=300mA

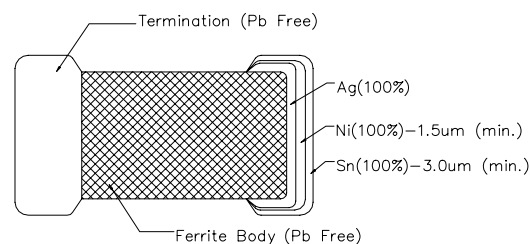

## 4.Specification

Tai-Tech Part Number	Impedance ( )	Test Frequency (Hz)	DC Resistance ( ) max.	Rated Current (mA) max.
FCM1005KF-102T03	1000±25%	60mV/100M	1.20	300

### ■ Impedance-Frequency Characteristics

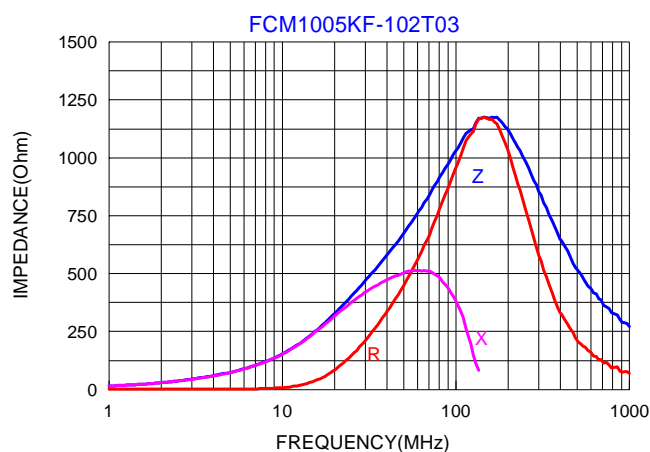

## 5. Reliability and Test Condition

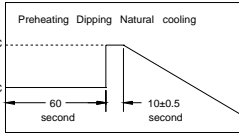
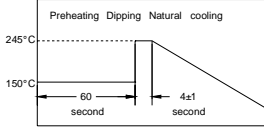
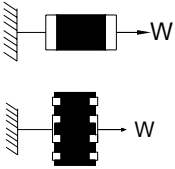
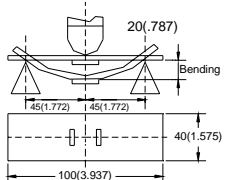
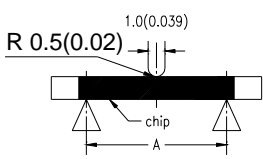
Item	Performance										Test Condition																											
Series No.	FCB	FCM	HCB	HPB	HFB	FCA	FCI	FHI	FCH	HCI	--																											
Operating Temperature	-55~+125 (Including self-temperature rise)						-40~+85 (Including self-temperaturerise)				--																											
Storage Temperature	-55~+125						-40~+85				--																											
Impedance (Z)	Refer to standard electrical characteristics list										HP4291A, HP4287A+16092A																											
Inductance (Ls)																																						
Q Factor																																						
DC Resistance											HP4338B																											
Rated Current											**																											
Temperature Rise Test	30    max. (   T )										1. Applied the allowed DC current. 2. Temperature measured by digital surface thermometer.																											
Solder heat Resistance	Appearance: No significant abnormality. Impedance change: Within ± 30%.				No mechanical damage. Remaining terminal electrode:70% min.				Preheat: 150   ,60sec. Solder: Sn-Ag3.0-Cu0.5 Solder temperature: 260±5 Flux for lead free: rosin Dip time: 10±0.5sec. 																													
Solderability	More than 90% of the terminal electrode should be covered with solder.								Preheat: 150   ,60sec. Solder: Sn-Ag3.0-Cu0.5 Solder temperature: 245±5 Flux for lead free: rosin Dip time: 4±1sec.																													
Terminal strength	The terminal electrode and the dielectric must not be damaged by the forces applied on the right conditions. 				For FCB FCM HCB HPB HFB FCI FHI FCH HCI: <table><tr><td>Size</td><td>Force (Kgf)</td><td>Time(sec)</td></tr><tr><td>1005</td><td>0.2</td><td rowspan="8">&gt;25</td></tr><tr><td>1608</td><td>0.5</td></tr><tr><td>2012</td><td>0.6</td></tr><tr><td>3216</td><td>1.0</td></tr><tr><td>3225</td><td>1.0</td></tr><tr><td>4516</td><td>1.0</td></tr><tr><td>4532</td><td>1.5</td></tr><tr><td>5750</td><td>2.0</td></tr></table> For FCA: <table><tr><td>Size</td><td>Force (Kgf)</td><td>Time(sec)</td></tr><tr><td>3216</td><td>0.5</td><td>&gt;25</td></tr></table>							Size	Force (Kgf)	Time(sec)	1005	0.2	>25	1608	0.5	2012	0.6	3216	1.0	3225	1.0	4516	1.0	4532	1.5	5750	2.0	Size	Force (Kgf)	Time(sec)	3216	0.5	>25	
Size	Force (Kgf)	Time(sec)																																				
1005	0.2	>25																																				
1608	0.5																																					
2012	0.6																																					
3216	1.0																																					
3225	1.0																																					
4516	1.0																																					
4532	1.5																																					
5750	2.0																																					
Size	Force (Kgf)	Time(sec)																																				
3216	0.5	>25																																				
Flexture strength	The terminal electrode and the dielectric must not be damaged by the forces applied on the right conditions. 				Solder a chip on a test substrate, bend the substrate by 2mm (0.079in) and return.																																	
Bending Strength	The ferrite should not be damaged by Forces applied on the right condition. 				<table><tr><th>Size</th><th>mm(inches)</th><th>P-Kgf</th></tr><tr><td>1608</td><td>0.80(0.033)</td><td>0.3</td></tr><tr><td>2012</td><td>1.40(0.055)</td><td>1.0</td></tr><tr><td>FCA3216</td><td>2.00(0.079)</td><td>1.5</td></tr><tr><td>3216</td><td>2.00(0.079)</td><td>2.5</td></tr><tr><td>3225</td><td></td><td></td></tr><tr><td>4516</td><td>2.70(0.106)</td><td>2.5</td></tr><tr><td>4532</td><td></td><td></td></tr><tr><td>5750</td><td></td><td></td></tr></table>							Size	mm(inches)	P-Kgf	1608	0.80(0.033)	0.3	2012	1.40(0.055)	1.0	FCA3216	2.00(0.079)	1.5	3216	2.00(0.079)	2.5	3225			4516	2.70(0.106)	2.5	4532			5750		
Size	mm(inches)	P-Kgf																																				
1608	0.80(0.033)	0.3																																				
2012	1.40(0.055)	1.0																																				
FCA3216	2.00(0.079)	1.5																																				
3216	2.00(0.079)	2.5																																				
3225																																						
4516	2.70(0.106)	2.5																																				
4532																																						
5750																																						
Random Vibration Test	Appearance: Cracking, shipping and any other defects harmful to the characteristics should not be allowed. Impedance: within±30%										Frequency: 10-55-10Hz for 1 min. Amplitude: 1.52mm Directions and times: X, Y, Z directions for 2 hours. A period of 2 hours in each of 3 mutually perpendicular directions (Total 6 hours).																											

Item	Performance	Test Condition
Loading at High Temperature	Appearance: no damage.	Temperature: 125±5 (bead), 85±5 (inductor) Applied current: rated current. Duration: 1008±12hrs. Measured at room temperature after placing for 2 to 3hrs.
Humidity	Impedance: within±30% of initial value. Inductance: within±10% of initial value. Q: within±30% of initial value. (FCI FHI FCH) Q: within±20% of initial value. (HCI)	Humidity: 90~95%RH. Temperature: 40±2 Temperature: 60±2 (HCI) Duration: 1008±12hrs. Measured at room temperature after placing for 2 to 3hrs.
Thermal shock	Appearance: no damage. Impedance: within±30% of initial value. Inductance: within±10% of initial value. Q: within±30% of initial value. (FCI FHI FCH) Q: within±20% of initial value. (HCI)	For FCB FCM HCB HPB HFB FCA : Condition for 1 cycle Step1: -55±2 30±3 min. Step2: +125±5 30±3 min. Number of cycles: 5 For FCI FHI FCH HCI : Condition for 1 cycle Step1: -40±2 30±3 min. Step2: +85±5 30±3 min. Number of cycles: 100 Measured at room temperature after placing for 2 to 3 hrs.
Low temperature storage test		Temperature: -55±2 Duration: 1008±12hrs. Measured at room temperature after placing for 2 to 3hrs.
Drop	a: No mechanical damage b: Impedance change: ±30%	Drop 10 times on a concrete floor from a height of 75cm

### \*\*Derating Curve

For the ferrite chip bead which withstanding current over 1.5A, as the operating temperature over 85 , the derating current information is necessary to consider with. For the detail derating of current, please refer to the Derated Current vs. Operating Temperature curve.

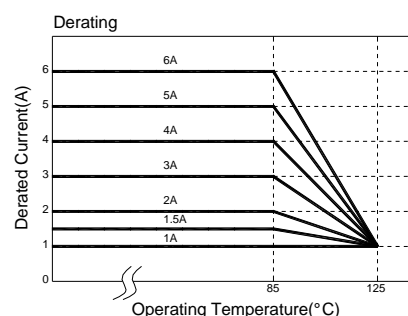

## 6.Soldering and Mounting

### 6-1. Recommended PC Board Pattern

Chip Size						Land Patterns For Reflow Soldering		
Series	Type	A(mm)	B(mm)	C(mm)	D(mm)	L(mm)	G(mm)	H(mm)
FCB	1005	1.0±0.10	0.50±0.10	0.50±0.10	0.25±0.10	2.10	0.50	0.55
FCM	1608	1.6±0.15	0.80±0.15	0.80±0.15	0.30±0.20	2.60	0.60	0.80
HCB	2012	2.0±0.20	1.25±0.20	0.85±0.20	0.50±0.30	3.00	1.00	1.00
HPB		2.0±0.20	1.25±0.20	1.25±0.20	0.50±0.30			
HFB	2520	2.5±0.20	2.00±0.20	1.60±0.20	0.50±0.30	3.90	1.50	1.50
FCI	3216	3.2±0.20	1.60±0.20	1.10±0.20	0.50±0.30	4.40	2.20	1.40
FHI	3225	3.2±0.20	2.50±0.20	1.30±0.20	0.50±0.30	4.40	2.20	3.40
FCH	4516	4.5±0.20	1.60±0.20	1.60±0.20	0.50±0.30	5.70	2.70	1.40
HCI	4532	4.5±0.20	3.20±0.20	1.50±0.20	0.50±0.30	5.90	2.57	4.22
UHI	5750	5.7±0.20	5.00±0.30	1.80±0.20	0.50±0.30	8.00	4.00	5.80

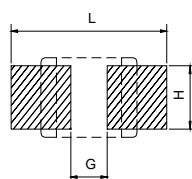
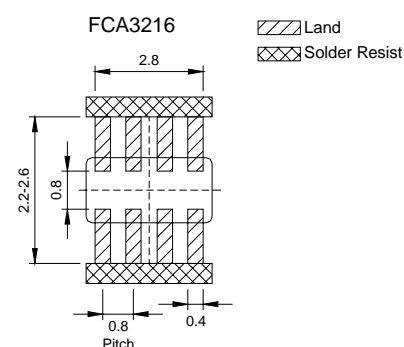

PC board should be designed so that products are not sufficient under mechanical stress as warping the board.  
Products shall be positioned in the sideways direction against the mechanical stress to prevent failure.

### 6-2. Soldering

Mildly activated rosin fluxes are preferred. The minimum amount of solder can lead to damage from the stresses caused by the difference in coefficients of expansion between solder, chip and substrate. The terminations are suitable for all wave and re-flow soldering systems. If hand soldering cannot be avoided, the preferred technique is the utilization of hot air soldering tools.

### 6-2.1 Lead Free Solder re-flow:

Recommended temperature profiles for lead free re-flow soldering in Figure 1.

### 6-2.2 Solder Wave:

Wave soldering is perhaps the most rigorous of surface mount soldering processes due to the steep rise in temperature seen by the circuit when immersed in the molten solder wave. Due to the risk of thermal damage to products, wave soldering of large size products is discouraged. Recommended temperature profile for wave soldering is shown in Figure 2.

### 6-2.3 Soldering Iron(Figure 3):

Products attachment with a soldering iron is discouraged due to the inherent process control limitations. In the event that a soldering iron must be employed the following precautions are recommended.

Note : Preheat circuit and products to 150  
350 tip temperature for Ferrite chip bead (max)

Never contact the ceramic with the iron tip  
1.0mm tip diameter (max)

Use a 20 watt soldering iron with tip diameter of 1.0mm  
Limit soldering time to 3 sec.

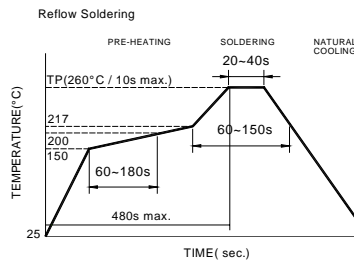

Figure 1. Re-flow Soldering(Lead Free)

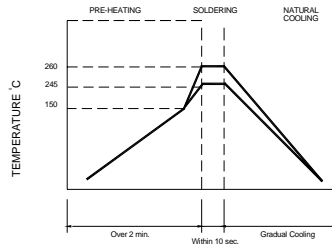

Figure 2. Wave Soldering

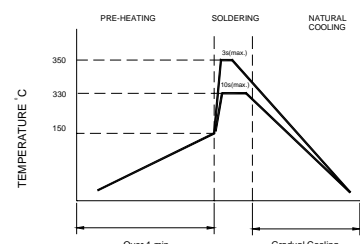
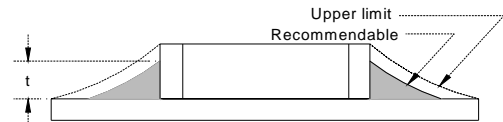

Figure 3. Hand Soldering

### 6-2.4 Solder Volume:

Accordingly increasing the solder volume, the mechanical stress to product is also increased. Exceeding solder volume may cause the failure of mechanical or electrical performance. Solder shall be used not to be exceed as shown in right side:



## 7. Packaging Information

### 7-1. Reel Dimension

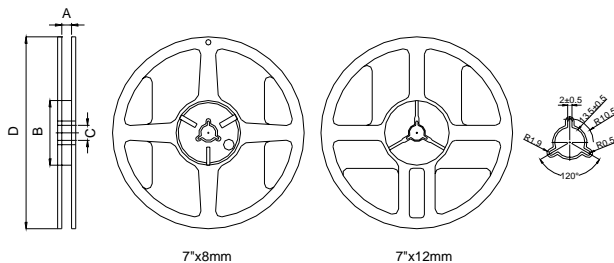

Type	A(mm)	B(mm)	C(mm)	D(mm)
7"x8mm	9.0±0.5	60±2	13.5±0.5	178±2
7"x12mm	13.5±0.5	60±2	13.5±0.5	178±2

### 7-2.1 Tape Dimension / 8mm

Material of taping is paper

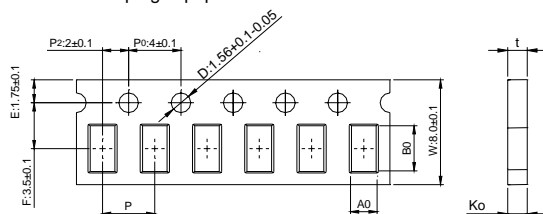

Material of taping is plastic

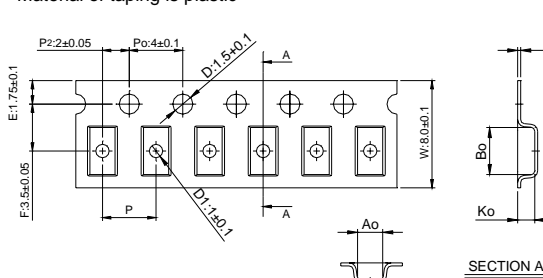

Series	Size	Bo(mm)	Ao(mm)	Ko(mm)	P(mm)	t(mm)	D1(mm)
FCB,FCM,HCB	100505	1.12±0.03	0.62±0.03	0.60±0.03	2.0±0.10	0.60±0.03	none
HPB,HFB,FCI	160808	1.85±0.05	1.05±0.05	0.95±0.05	4.0±0.10	0.95±0.05	none
FHI,FCH,HCI	201209	2.30±0.05	1.50±0.05	0.95±0.05	4.0±0.10	0.95±0.05	none

Series	Size	Bo(mm)	Ao(mm)	Ko(mm)	P(mm)	t(mm)	D1(mm)
FCB,FCM	160808	1.95±0.10	1.05±0.10	1.05±0.10	4.0±0.10	0.23±0.05	none
HCB,HPB	201209	2.25±0.10	1.42±0.10	1.04±0.10	4.0±0.10	0.22±0.05	1.0±0.10
HFB,FCI	201212	2.35±0.10	1.50±0.10	1.45±0.10	4.0±0.10	0.22±0.05	1.0±0.10
FHI,FCH	321611	3.50±0.10	1.88±0.10	1.27±0.10	4.0±0.10	0.22±0.05	1.0±0.10
HCI	322513	3.42±0.10	2.77±0.10	1.55±0.10	4.0±0.10	0.22±0.05	1.0±0.10
FCA	321609	3.40±0.10	1.77±0.10	1.04±0.10	4.0±0.10	0.22±0.05	1.0±0.10

## 7-2.2 Tape Dimension / 12mm

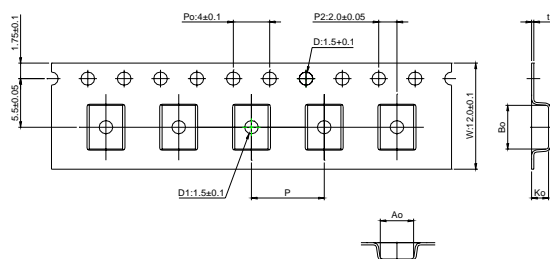

Series	Size	Bo(mm)	Ao(mm)	Ko(mm)	P(mm)	t(mm)	D1(mm)
FCB,	451616	$4.95 \pm 0.1$	$1.93 \pm 0.1$	$1.93 \pm 0.1$	$4.0 \pm 0.1$	$0.24 \pm 0.05$	$1.5 \pm 0.1$
HCB.FCM	453215	$4.95 \pm 0.1$	$3.66 \pm 0.1$	$1.85 \pm 0.1$	$8.0 \pm 0.1$	$0.24 \pm 0.05$	$1.5 \pm 0.1$
FCI	575018	$6.10 \pm 0.1$	$5.40 \pm 0.1$	$2.00 \pm 0.1$	$8.0 \pm 0.1$	$0.30 \pm 0.05$	$1.5 \pm 0.1$

## 7-3. Packaging Quantity

Chip Size	575018	453215	451616	322513	321611	201212	201209	160808	100505
Chip / Reel	1000	1000	2000	2500	3000	2000	4000	4000	10000
Inner box	4000	4000	8000	12500	15000	10000	20000	20000	50000
Middle box	20000	20000	40000	62500	75000	50000	100000	100000	250000
Carton	40000	40000	80000	125000	150000	100000	200000	200000	500000
Bulk (Bags)	7000	12000	20000	30000	50000	100000	150000	200000	300000

## 7-4. Tearing Off Force

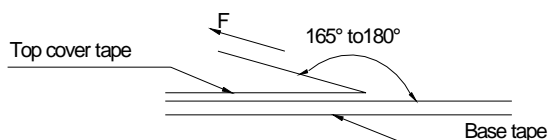

The force for tearing off cover tape is 15 to 60 grams in the arrow direction under the following conditions.

Room Temp. ( )	Room Humidity (%)	Room atm (hPa)	Tearing Speed mm/min
5~35	45~85	860~1060	300

**Application Notice**

## Storage Conditions

To maintain the solderability of terminal electrodes:

1. Temperature and humidity conditions:  $-10 \sim 40^\circ\text{C}$  and  $30 \sim 70\%$  RH.
2. Recommended products should be used within 6 months from the time of delivery.
3. The packaging material should be kept where no chlorine or sulfur exists in the air.

## Transportation

1. Products should be handled with care to avoid damage or contamination from perspiration and skin oils.
2. The use of tweezers or vacuum pick up is strongly recommended for individual components.
3. Bulk handling should ensure that abrasion and mechanical shock are minimized.

## X-ON Electronics

Largest Supplier of Electrical and Electronic Components

*Click to view similar products for [Ferrite Beads](#) category:*

*Click to view products by [TAITEC](#) manufacturer:*

Other Similar products are found below :

[2943778301](#) [BMB1J0120BN3JIT](#) [82350120560](#) [0261014605](#) [2643066902](#) [3061000011](#) [2673045901](#) [2643083601](#) [2643074901](#) [4361142521](#)  
[4078078621](#) [4078044821](#) [4078033621](#) [CZB2BFTTE121P](#) [BMB2A0120AN2](#) [BMB1J0200BN3JIT](#) [EMI0805R-220](#) [74279250](#) [7427924](#)  
[CZB1JGTTD202P](#) [MAF0603GWY551AT000](#) [MAF1005GWZ102AT000](#) [BLM18HE152SH1D](#) [2944778302](#) [BLM02PX600SN1D](#) [SMB2.5-1](#)  
[EMI1206R-600](#) [BLM02KX180SN1D](#) [BLM02BC100SN1D](#) [BLM02KX100SN1D](#) [BLM02BB101SN1D](#) [BLM02BC220SN1D](#)  
[BLE32PN260SH1L](#) [BLE32PN260SN1L](#) [BLE32PN260SZ1L](#) [74275013](#) [7427503](#) [BLM18HE601SH1D](#) [BLM15BD152SN1D](#)  
[BLM15BD152SZ1D](#) [BLE18PS080SZ1D](#) [BLM21PG221BH1D](#) [WLBD1005HCU330TL](#) [BLM21AG471BH1D](#) [BLE18PS080BH1D](#)  
[BLM21AG331BH1D](#) [BLM21PG300BH1D](#) [BLM21PG600BH1D](#) [BLM03HB401SZ1D](#) [BLM03HB401SN1D](#)