

DRAWING MADE BY
CAD
HAND MADE MODIFICATIONS ARE FORBIDDEN

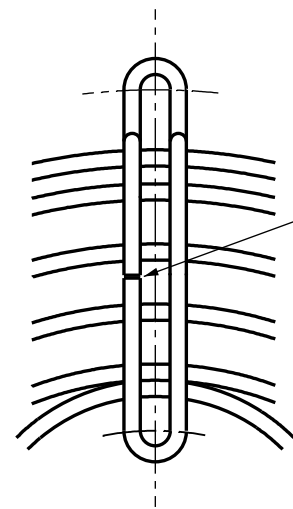

ALTERNATIVE SOLUTION
SOLUZIONE ALTERNATIVA:
STAFFE NON SALDATE DI TESTA.

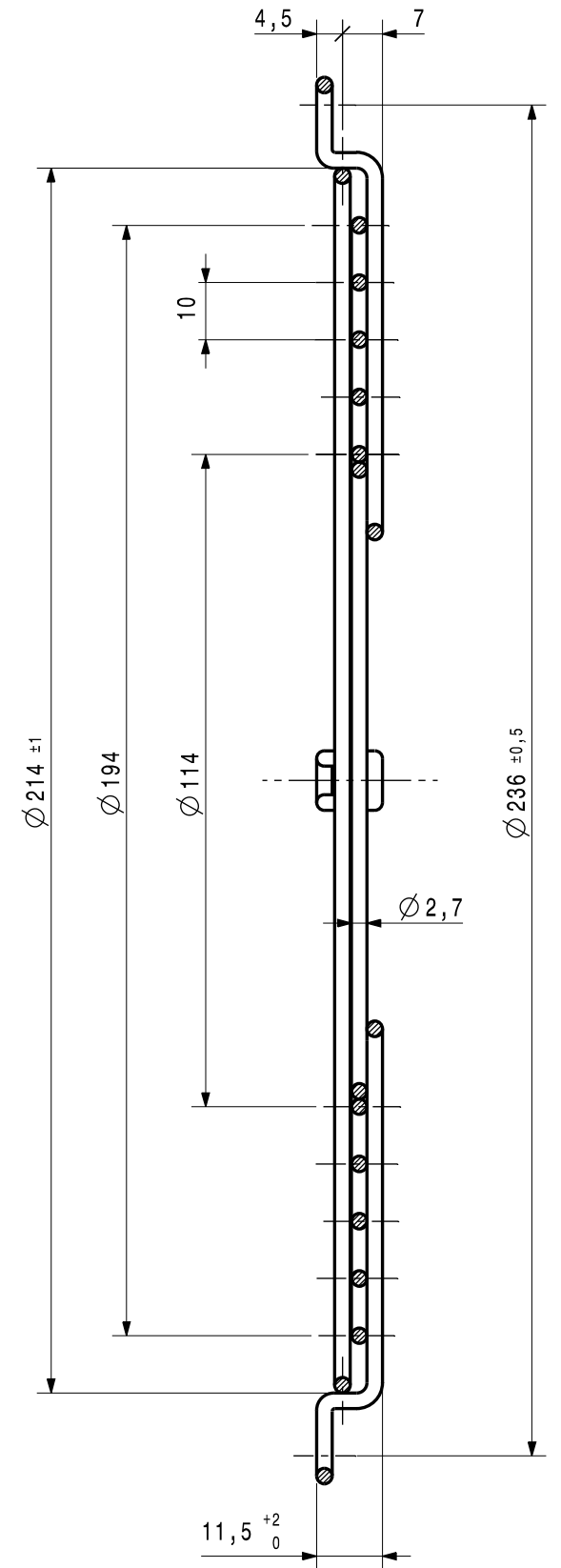
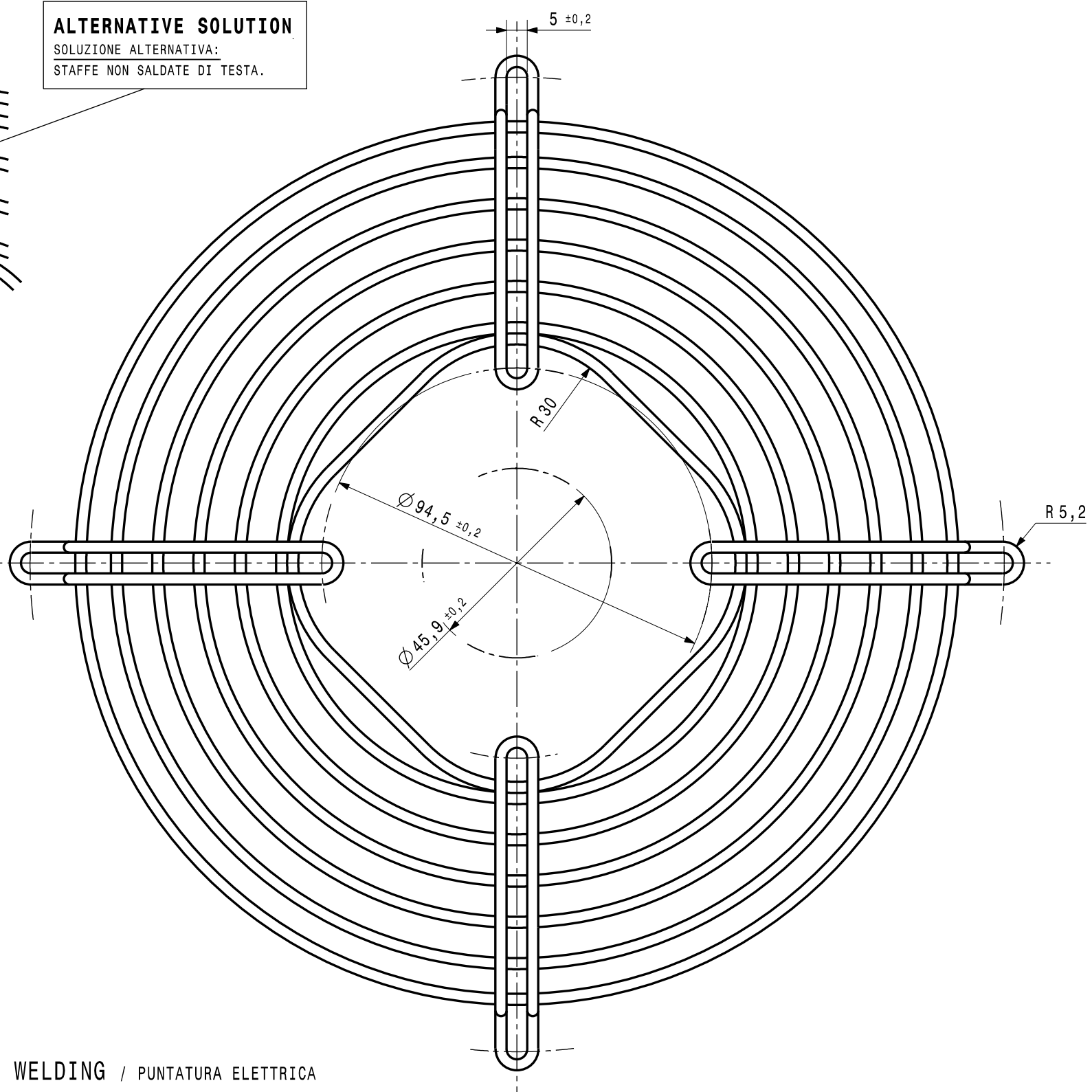

- ELECTRICAL SPOT WELDING / PUNTATURA ELETTRICA
- ASSEMBLING RULES IN ACCORDANCE WITH EL.UN.0017
/ NORME DI COSTRUZIONE SECONDO EL.UN.0017
- EUROPEAN STANDARD EN 294 / NORMATIVA EUROPEA EN 294

| Rel | Date | Description | Executor signature | Checked |
|----------------------------------|------|-------------|--------------------|---------|
| | | | | |
| M O D I F I C A T I O N S | | | | |
| | | | | |

| | | | |
|---|--|-----------|--|
| For dim. without tolerance see standard UNI EN 22768-mK | Treatment <u>WHITE GALVANIZING 6/8µm / ZINCATURA BIANCA Sp.6/8µm</u> | A3 | |
| | Material <u>ROUND BAR STEEL Fe37B UNI 10233 / Tondo Acciaio Dolce Ø2,7</u> | | |
| Drawn <u>G.Porro</u> | PROTECTION GRID | | Weight . |
| Date <u>28/11/08</u> | FOR Ø200 FAN BLADE | | Release - |
| Check <u>T.Sirtori</u> | for N MOTORS | | Ref.No <u>R.S.117/0042 (R.S.0214/08)</u> |
| Scale <u>---</u> | 1-055-614 | | |

X-ON Electronics

Largest Supplier of Electrical and Electronic Components

Click to view similar products for [Fan Accessories](#) category:

Click to view products by [Elco](#) manufacturer:

Other Similar products are found below :

[LZ31](#) [LZ32P-1](#) [63070-2-4013](#) [71882-2-4053](#) [73770-2-3634](#) [73806-2-3634](#) [73816-2-3634](#) [854589-1](#) [99485901](#) [99485904](#) [1-21002-3](#) [1247-4-6254](#) [RF119](#) [1434-4-6711-80](#) [1434-4-6711-1](#) [169-002](#) [KM36](#) [27453.32193](#) [27453.32262](#) [99485906](#) [99485912](#) [F92-B](#) [FG92-W2](#) [FK120-30](#) [FK40-30](#) [FK80-45](#) [27453.32241](#) [27453.32298](#) [R88ACPU001M1](#) [R88ACPU001M2](#) [LZ215](#) [LZ22-2](#) [LZ24B](#) [LZ37-2](#) [525-00-0009](#) [KM38](#) [420-05-0276](#) [50824-4-1040](#) [04.846.1353.0](#) [04.846.1453.0](#) [055032](#) [07100-40](#) [07190-50](#) [08195](#) [08245](#) [09325-M/60](#) [09494-2-4039](#) [09576-2-4013](#) [109-1102](#) [109-019H](#)