

REV	DATE	BY	CHKD	REASON FOR CHANGE
1				INITIALS
2				INITIALS
3				INITIALS
4				INITIALS
5				INITIALS
6				INITIALS
7				INITIALS
8				INITIALS
9				INITIALS
10				INITIALS
11				INITIALS
12				INITIALS
13				INITIALS
14				INITIALS
15				INITIALS
16				INITIALS
17				INITIALS
18				INITIALS
19				INITIALS
20				INITIALS

REV	DATE	BY	CHKD	REASON FOR CHANGE
1				INITIALS
2				INITIALS
3				INITIALS
4				INITIALS
5				INITIALS
6				INITIALS
7				INITIALS
8				INITIALS
9				INITIALS
10				INITIALS
11				INITIALS
12				INITIALS
13				INITIALS
14				INITIALS
15				INITIALS
16				INITIALS
17				INITIALS
18				INITIALS
19				INITIALS
20				INITIALS

REV	DATE	BY	CHKD	REASON FOR CHANGE
1				INITIALS
2				INITIALS
3				INITIALS
4				INITIALS
5				INITIALS
6				INITIALS
7				INITIALS
8				INITIALS
9				INITIALS
10				INITIALS
11				INITIALS
12				INITIALS
13				INITIALS
14				INITIALS
15				INITIALS
16				INITIALS
17				INITIALS
18				INITIALS
19				INITIALS
20				INITIALS

REV	DATE	BY	CHKD	REASON FOR CHANGE
1				INITIALS
2				INITIALS
3				INITIALS
4				INITIALS
5				INITIALS
6				INITIALS
7				INITIALS
8				INITIALS
9				INITIALS
10				INITIALS
11				INITIALS
12				INITIALS
13				INITIALS
14				INITIALS
15				INITIALS
16				INITIALS
17				INITIALS
18				INITIALS
19				INITIALS
20				INITIALS

REV	DATE	BY	CHKD	REASON FOR CHANGE
1				INITIALS
2				INITIALS
3				INITIALS
4				INITIALS
5				INITIALS
6				INITIALS
7				INITIALS
8				INITIALS
9				INITIALS
10				INITIALS
11				INITIALS
12				INITIALS
13				INITIALS
14				INITIALS
15				INITIALS
16				INITIALS
17				INITIALS
18				INITIALS
19				INITIALS
20				INITIALS

REV	DATE	BY	CHKD	REASON FOR CHANGE
1				INITIALS
2				INITIALS
3				INITIALS
4				INITIALS
5				INITIALS
6				INITIALS
7				INITIALS
8				INITIALS
9				INITIALS
10				INITIALS
11				INITIALS
12				INITIALS
13				INITIALS
14				INITIALS
15				INITIALS
16				INITIALS
17				INITIALS
18				INITIALS
19				INITIALS
20				INITIALS

REV	DATE	BY	CHKD	REASON FOR CHANGE
1				INITIALS
2				INITIALS
3				INITIALS
4				INITIALS
5				INITIALS
6				INITIALS
7				INITIALS
8				INITIALS
9				INITIALS
10				INITIALS
11				INITIALS
12				INITIALS
13				INITIALS
14				INITIALS
15				INITIALS
16				INITIALS
17				INITIALS
18				INITIALS
19				INITIALS
20				INITIALS

REV	DATE	BY	CHKD	REASON FOR CHANGE
1				INITIALS
2				INITIALS
3				INITIALS
4				INITIALS
5				INITIALS
6				INITIALS
7				INITIALS
8				INITIALS
9				INITIALS
10				INITIALS
11				INITIALS
12				INITIALS
13				INITIALS
14				INITIALS
15				INITIALS
16				INITIALS
17				INITIALS
18				INITIALS
19				INITIALS
20				INITIALS

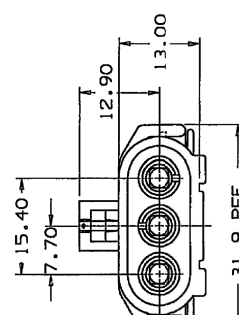
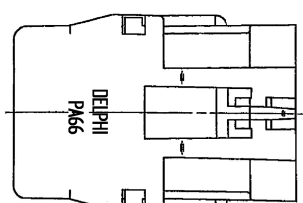

INDEX CODE  
013  
(ALSO SEE HANDBOOK)

ASM DIMENSIONING POINT  
FLEX AREA MAY EXHIBIT MATERIAL SEPARATION AFTER FINAL ASSEMBLY.

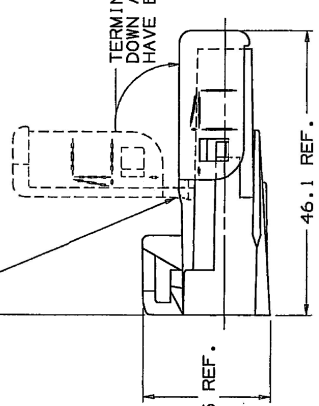

TERMINAL LOCK TO BE FOLDED DOWN AS SHOWN AFTER TERMINALS HAVE BEEN INSERTED

PULL OUT RIBS PERMITTED ALONG THIS AND OPPOSITE SURFACE

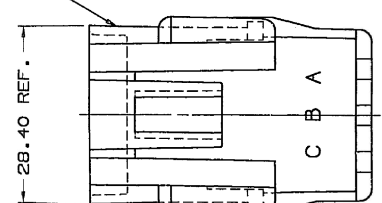

- NOTES —
1. USE TERMINAL 1208940 OR EQUIVALENT.
  2. USE CABLE SEAL OR EQUIVALENT.
  3. USE 1202093 LOCK OR EQUIVALENT.
  4. SEALING CODE 3.
  5. USE 1201523 CABLE SEAL OR EQUIVALENT.
  6. CAUTION: DO NOT ATTEMPT TO COPY THIS DRAWING WHEN THE DRAWING IS NOT THE LATEST COPY OF DRAWING NUMBER 1208487 FROM THE PACKARD ELECTRIC DIVISION.
  7. DRAWING SURFACE, PREFERABLY VISIBLE AT FINAL ASSEMBLY, OPTIONAL CONSTRUCTION TO BE "PEEP" OR NO LOGO.
  8. MATERIAL RECYCLING CODE P466- PER SAE J1334 (3.3) (6.1) RAISED ABOVE THE SURFACE OF THE DRAWING. OPTIONAL CONSTRUCTION TO BE NO MATERIAL RECYCLING CODE.

**DELPHI**  
DELPHI TECHNOLOGICAL SYSTEMS

DATE: 1992  
DRAWN BY: GAVILION  
CHECKED BY: E. TRACY  
PART NO: 1208487

REVISIONS:  
1. 1208487  
2. 1208487  
3. 1208487

DATE: 1992  
DRAWN BY: GAVILION  
CHECKED BY: E. TRACY  
PART NO: 1208487

REVISIONS:  
1. 1208487  
2. 1208487  
3. 1208487

DATE: 1992  
DRAWN BY: GAVILION  
CHECKED BY: E. TRACY  
PART NO: 1208487

REVISIONS:  
1. 1208487  
2. 1208487  
3. 1208487

DELPHI TECHNOLOGICAL SYSTEMS

DATE: 1992  
DRAWN BY: GAVILION  
CHECKED BY: E. TRACY  
PART NO: 1208487

REVISIONS:  
1. 1208487  
2. 1208487  
3. 1208487

DATE: 1992  
DRAWN BY: GAVILION  
CHECKED BY: E. TRACY  
PART NO: 1208487

REVISIONS:  
1. 1208487  
2. 1208487  
3. 1208487

DATE: 1992  
DRAWN BY: GAVILION  
CHECKED BY: E. TRACY  
PART NO: 1208487

REVISIONS:  
1. 1208487  
2. 1208487  
3. 1208487

DELPHI TECHNOLOGICAL SYSTEMS

DATE: 1992  
DRAWN BY: GAVILION  
CHECKED BY: E. TRACY  
PART NO: 1208487

REVISIONS:  
1. 1208487  
2. 1208487  
3. 1208487

DATE: 1992  
DRAWN BY: GAVILION  
CHECKED BY: E. TRACY  
PART NO: 1208487

REVISIONS:  
1. 1208487  
2. 1208487  
3. 1208487

DATE: 1992  
DRAWN BY: GAVILION  
CHECKED BY: E. TRACY  
PART NO: 1208487

REVISIONS:  
1. 1208487  
2. 1208487  
3. 1208487

## X-ON Electronics

Largest Supplier of Electrical and Electronic Components

*Click to view similar products for [Automotive Connectors](#) category:*

*Click to view products by [APTIV](#) manufacturer:*

Other Similar products are found below :

[003-018-000](#) [600858](#) [60403001](#) [60993906-B](#) [60993913-B](#) [629515004020001](#) [M902-2131](#) [M902-2161](#) [M902-2344](#) [72.330.1035.1](#)  
[73.353.4028.0](#) [F118010](#) [F119300-B](#) [F132210](#) [F132210-B](#) [F166900](#) [F180100](#) [F258300](#) [F258300-B](#) [F294300-B](#) [F339100](#) [F339700](#) [F358300-](#)  
[B](#) [F374110](#) [F407400](#) [F412210](#) [F427600](#) [F444110](#) [F487000](#) [F495100-B](#) [F500900-B](#) [F509500B-B](#) [770444-1](#) [776880-1](#) [827153-1](#) [881735-1](#)  
[8N1515-32-24P](#) [9-1326729-8](#) [925467-1](#) [925474-1](#) [928905-1](#) [936398-2](#) [964562-1](#) [964562-4](#) [964731-2](#) [965051-1](#) [968782-1](#) [GT17SA-8DS-](#)  
[HU](#) [GT17VS-10DP-5.2CF](#) [98315-0001](#)