

# COM-KNOBS

Order data on pages 192-193

**OKW**  
GEHÄUSE  
SYSTEME



## MODERN APPEARANCE

### Sizes (mm)

ø 16, ø 20, ø 23, ø 31, ø 40, ø 50

### Fastening

with collet fixture system for rotary potentiometer with shaft ends according to DIN 41591

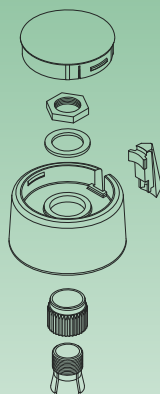

### THE PRODUCT

Outstanding appearance is characteristic of the COM-KNOBS.

Aesthetic design and a modern selection of colours in pastel tones give the appliances a high-quality appearance.

Different sizes and combinations also provide a wide selection of attractive tuning knobs with the tried and tested collet fixture system.

### YOUR ADVANTAGE

Knob design for a modern, innovative image for your equipment.

Reliable operation with the tried and tested collet fixture system: convenient assembly of knobs from the front and tight fitting on the axis.

Without/with marking element.

For size 40 and larger, the cover is also available with a finger recess for rational handling during adjustment.



detailed drawings see our website  
[www.okw.com](http://www.okw.com)



## COM-KNOBS WITH RECESS / WITHOUT RECESS

## COVER

PA 6 reinforced



PA 6 reinforced

without/  
with  
finger  
recess

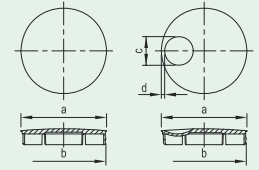

Knob Ø	Dim. in mm		Borehole D	[Color-coded images]				COVER		
	without recess	with recess		[Color-coded images]	[Color-coded images]	[Color-coded images]	[Color-coded images]	[Color-coded images]	[Color-coded images]	
16			4 mm, without chamfer	A 30 16 049	A 31 16 049	A 30 16 048	A 31 16 048	a = 11.5 b = 11.0	<ul style="list-style-type: none"> <li><span style="color: red;">●</span> A 32 16 003</li> <li><span style="color: yellow;">●</span> A 32 16 004</li> <li><span style="color: cyan;">●</span> A 32 16 005</li> <li><span style="color: blue;">●</span> A 32 16 006</li> <li><span style="color: grey;">●</span> A 32 16 007</li> <li><span style="color: black;">●</span> A 32 16 009</li> </ul>	
			6 mm, with chamfer	A 30 16 069	A 31 16 069	A 30 16 068	A 31 16 068			
			1/4", with chamfer	A 30 16 639	A 31 16 639	A 30 16 638	A 31 16 638			
20			4 mm, without chamfer	A 30 20 049	A 31 20 049	A 30 20 048	A 31 20 048	a = 14.0 b = 13.5	<ul style="list-style-type: none"> <li><span style="color: red;">●</span> A 32 20 003</li> <li><span style="color: yellow;">●</span> A 32 20 004</li> <li><span style="color: cyan;">●</span> A 32 20 005</li> <li><span style="color: blue;">●</span> A 32 20 006</li> <li><span style="color: grey;">●</span> A 32 20 007</li> <li><span style="color: black;">●</span> A 32 20 009</li> </ul>	
			6 mm, with chamfer	A 30 20 069	A 31 20 069	A 30 20 068	A 31 20 068			
			1/4", with chamfer	A 30 20 639	A 31 20 639	A 30 20 638	A 31 20 638			
23			4 mm, without chamfer	A 30 23 049	A 31 23 049	A 30 23 048	A 31 23 048	a = 17.0 b = 16.5	<ul style="list-style-type: none"> <li><span style="color: red;">●</span> A 32 23 003</li> <li><span style="color: yellow;">●</span> A 32 23 004</li> <li><span style="color: cyan;">●</span> A 32 23 005</li> <li><span style="color: blue;">●</span> A 32 23 006</li> <li><span style="color: grey;">●</span> A 32 23 007</li> <li><span style="color: black;">●</span> A 32 23 009</li> </ul>	
			6 mm, without chamfer	A 30 23 069	A 31 23 069	A 30 23 068	A 31 23 068			
			1/4", without chamfer	A 30 23 639	A 31 23 639	A 30 23 638	A 31 23 638			
31			6 mm, without chamfer	A 30 31 069	A 31 31 069	A 30 31 068	A 31 31 068	a = 25.0 b = 24.5	<ul style="list-style-type: none"> <li><span style="color: red;">●</span> A 32 31 003</li> <li><span style="color: yellow;">●</span> A 32 31 004</li> <li><span style="color: cyan;">●</span> A 32 31 005</li> <li><span style="color: blue;">●</span> A 32 31 006</li> <li><span style="color: grey;">●</span> A 32 31 007</li> <li><span style="color: black;">●</span> A 32 31 009</li> </ul>	
			1/4", without chamfer	A 30 31 639	A 31 31 639	A 30 31 638	A 31 31 638			
40			6 mm, without chamfer	A 30 40 069	A 31 40 069	A 30 40 068	A 31 40 068	a = 34.0 b = 33.5 c = 11.4 d = 1.3	<ul style="list-style-type: none"> <li><span style="color: red;">●</span> A 32 40 003</li> <li><span style="color: yellow;">●</span> A 32 40 004</li> <li><span style="color: cyan;">●</span> A 32 40 005</li> <li><span style="color: blue;">●</span> A 32 40 006</li> <li><span style="color: grey;">●</span> A 32 40 007</li> <li><span style="color: black;">●</span> A 32 40 009</li> </ul>	A 32 40 103
			8 mm, without chamfer	A 30 40 089	A 31 40 089	A 30 40 088	A 31 40 088			
50			6 mm, without chamfer	A 30 50 069	A 31 50 069	A 30 50 068	A 31 50 068	a = 44.0 b = 43.5 c = 12.9 d = 2.8	<ul style="list-style-type: none"> <li><span style="color: red;">●</span> A 32 50 003</li> <li><span style="color: yellow;">●</span> A 32 50 004</li> <li><span style="color: cyan;">●</span> A 32 50 005</li> <li><span style="color: blue;">●</span> A 32 50 006</li> <li><span style="color: grey;">●</span> A 32 50 007</li> <li><span style="color: black;">●</span> A 32 50 009</li> </ul>	A 32 50 103
			8 mm, without chamfer	A 30 50 089	A 31 50 089	A 30 50 088	A 31 50 088			



PEAK	DISK	DIAL	STATOR	NUT COVER
<p>PA 6 reinforced only for COM-KNOBS with recess</p>	<p>ABS ...010 = marking white</p>	<p>Polycarbonate ...0 = symbols black ...9 = symbols silver</p>	<p>Aluminium marking black</p>	<p>ABS ...010 = marking white ...018 = marking black</p>
<p>a = 3.9</p> <ul style="list-style-type: none"> <li> A 33 16 003</li> <li> A 33 16 004</li> <li> A 33 16 005</li> <li> A 33 16 006</li> <li> A 33 16 007</li> <li> A 33 16 009</li> </ul>	<p>a = 23.0 b = 10.0 c = 1.3</p>	<p>a = 31.0 b = 14.5 c = 10.0 d = 2.5 e = 1.7</p> <p>(ø 16 with moulded-on nut cover)</p>	<p>a = 16.0 b = 10.1 c = 15.5</p>	<p>a = 19.3 b = 17.6 c = 10.0 d = 3.3 e = 4.3</p> <p>a = 16.4 b = 14.6 c = 10.0 d = 3.3 e = 4.3 f = 10.2</p>
<p>a = 4.0</p> <ul style="list-style-type: none"> <li> A 33 20 003</li> <li> A 33 20 004</li> <li> A 33 20 005</li> <li> A 33 20 006</li> <li> A 33 20 007</li> <li> A 33 20 009</li> </ul>		<p>a = 36.0 b = 12.0 c = 1.5</p>	<p>a = 20.0 b = 10.1 c = 18.0</p>	
<p>a = 4.0</p> <ul style="list-style-type: none"> <li> A 33 20 003</li> <li> A 33 20 004</li> <li> A 33 20 005</li> <li> A 33 20 006</li> <li> A 33 20 007</li> <li> A 33 20 009</li> </ul>	<p>a = 31.0 b = 16.5 c = 1.3</p>	<p>a = 40.0 b = 16.3 c = 1.3</p>	<p>a = 23.0 b = 10.2 c = 20.0</p>	
<p>a = 4.0</p> <ul style="list-style-type: none"> <li> A 33 20 003</li> <li> A 33 20 004</li> <li> A 33 20 005</li> <li> A 33 20 006</li> <li> A 33 20 007</li> <li> A 33 20 009</li> </ul>	<p>a = 40.0 b = 16.5 c = 1.6</p>	<p>a = 49.9 b = 16.5 c = 1.5</p>		
<p>a = 4.0</p> <ul style="list-style-type: none"> <li> A 33 20 003</li> <li> A 33 20 004</li> <li> A 33 20 005</li> <li> A 33 20 006</li> <li> A 33 20 007</li> <li> A 33 20 009</li> </ul>	<p>a = 50.1 b = 24.0 c = 1.8</p>			
<p>a = 4.0</p> <ul style="list-style-type: none"> <li> A 33 20 003</li> <li> A 33 20 004</li> <li> A 33 20 005</li> <li> A 33 20 006</li> <li> A 33 20 007</li> <li> A 33 20 009</li> </ul>				

**Standard colours COM-KNOBS**

- COM-KNOBS
- Nero
  - Volcano
- Covers without/with finger recess
- Marking element "Peak"
- Coral
  - Beach
  - Lagoon
  - Sky
  - Mineral
  - Nero
- Disk, Nut cover
- Black, RAL 9005
  - Dust grey, RAL 7037
- Dial
- Transparent, bright surface with/without marking

## X-ON Electronics

Largest Supplier of Electrical and Electronic Components

*Click to view similar products for [Knobs & Dials](#) category:*

*Click to view products by [OKW](#) manufacturer:*

Other Similar products are found below :

[61-9028.20](#) [61-9028.9](#) [8529](#) [8573](#) [9-1437622-4](#) [11K5015-EMNB](#) [11K5019-ECNB](#) [11K5020-KLAB](#) [11K5028-JMNG](#) [11K5048-KMNB](#)  
[11K5014-EMNB](#) [11K5015-EMNG](#) [11K5015-KMNG](#) [11K5019-EMNB](#) [11K5029-KMNG](#) [P400S-08-D6-N](#) [K6510](#) [KNSL500B1/8](#)  
[AL811BA18](#) [420031B18](#) [5006](#) [KB700BA1/4](#) [KS700B14](#) [411](#) [4-1437621-3](#) [420065A14AL](#) [5149A](#) [52-928.20](#) [52-928.60](#) [52-928.9](#) [8517](#)  
[8546](#) [8570](#) [8572](#) [H-516-3A](#) [P861H-0X-S6](#) [8544](#) [11K5014-JMNG](#) [11K5014-KMNG](#) [11K5014-ECNG](#) [5700E](#) [KA500B18](#) [KFS600B14](#)  
[KN900AB14](#) [KFS500B14](#) [KNS501B18](#) [PKD60B1018](#) [PK1100B18](#) [PKES140B14](#) [PKES150B14](#)