

Series 400 & 1400

1" Diameter, 10 Turn

Concentric Scale Dials



Series 400 & 1400 Specifications

Mounting

Requires only 1 sq.in. (25.4 sq. mm) of panel space.
Mounts on true 1 in. centers.

Dial Mounts On

1/4 in. (6.35 mm) diameter shaft +.0000 -.0006
3/8 in. (9.53 mm) 32-NEF-2A Bushing Dimensions

Figure 1

Series 400 & 1400 Dimensions

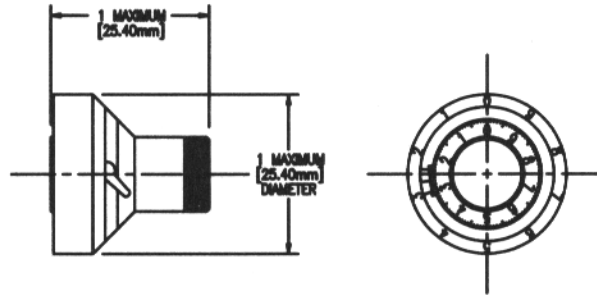

Description

The 400 series is designed specifically for multi-turn potentiometers. The knob attaches directly to the shaft, and the body of the dial is mounted rigidly to the panel. Ideal for use with our 73JA, 73JB, and 62JA potentiometers.

Features

- Accurate readings
- Zero backlash
- Metallic or plastic styles
- Brake lever option

Series 400 & 1400 How To Order

Catalog Number	Description
411	Commercial 10 turn, black anodized, no brake lever
1411	Same as 411, except black plastic
412	Commercial 10 turn, black anodized, with brake lever
1412	Same as 412, except black plastic
461	Commercial 10 turn, clear anodized, no brake lever
1461	Same as 461, except gray plastic
462	Commercial 10 turn, clear anodized, with brake lever
1462	Same as 462, except gray plastic

X-ON Electronics

Largest Supplier of Electrical and Electronic Components

Click to view similar products for [honeywell](#) manufacturer:

Other Similar products are found below :

[MML93J](#) [9810405](#) [3010A](#) [5VP1](#) [5VP2](#) [LZJ3-7M](#) [V7-2B27E9](#) [LTPCTAA50UEBITX01](#) [MPRLS0001PG0000SAB](#) [LZZ7J3-7M](#) [76072-00000150-15](#) [NSCDRRN030PDUNV](#) [5SM3-TN196](#) [14CE2-2](#) [91MCE2-S5](#) [NSCDRRN001PGUNV](#) [SE3450-013](#) [GLLA06A1B](#) [3600080010001](#) [23944-01](#) [53C110K](#) [58C1-25](#) [58C1-3K](#) [591SXP56S252SC](#) [5ML1-E1](#) [5SE1-12](#) [602HE1-6](#) [604HE223-6B](#) [61CX11-D01](#) [624HE17-RB](#) [M3050A13](#) [64AT22-3D](#) [66AT23-7](#) [6AT3-T](#) [6HM7-6](#) [MA215HT-96](#) [6PA104](#) [6PA148-E6](#) [701PB580](#) [70B1N056S202W](#) [727033](#) [EXD-AR20](#) [MD3211Q16](#) [76054-00000700-01](#) [76061-00000015-15](#) [76061-B00000020-01](#) [76078-00000350-01](#) [76078-B00000400-01](#) [76580-00000130-01](#) [76584-M00000100-24](#)