

CAB CAB ABS 303018 T



Sample photo

Order symbol: CAB ABS 303018 T
Product nbr: 8183040
Description: Cabinet, ABS
Remarks: Latches on the long side

EAN: 6418074020178
EI. number:
 Finland: 3424357
 Electric No. 8212020537
 Denmark:
 Electric No. Italy: 7812025
 Electric No. Sweden: 2540037

Including: Cabinet base, door with PUR gasket, latches, screws for mounting plate/DIN-rail and corner plugs.

Dimensions:				Accessories:	
	Length	Width	Height		
mm:	300	300	180	EKIV 27	DIN-35 Mounting rail
inch:	11.8	11.8	7.1	DS35270E1	DIN-35 Mounting rail
Materials:				FP A 33	Swing-out door/Front plate
Material:	ABS			MB 12225 AL	Swing door set
Base colour:	RAL 7035 -light grey			FP 33	Front plate
Cover colour:	Smoked grey			FP 12-33	Front plate
Gasket material:	Polyurethane			FP 12x2-33	Front plate
Temperatures:				DRF 33	DIN rail frame set
Temperature °C (short term):	-40 ... 80 °C			Rating:	
Temperature °C (continuous):	-40 ... 60 °C			Ingress Protection (EN 60529): IP65	
Temperature °F (short term):	-40 ... 175 °F			Impact Resistance (EN 62262): IK08	
Temperature °F (continuous):	-40 ... 140 °F			Electrical insulation: Totally insulated	
Accessories:				Halogen free (DIN/VDE 0472, Part 815): 1	
EKIV 33	Mounting plate			Flammability Rating: UL 94 HB	
				Glow Wire Test (IEC 695-2-1) °C: 650	
				NEMA Class: NEMA 1, 4, 4X, 12, 13	
				Certificates:	
				SGS Fimko	
				Gost R	

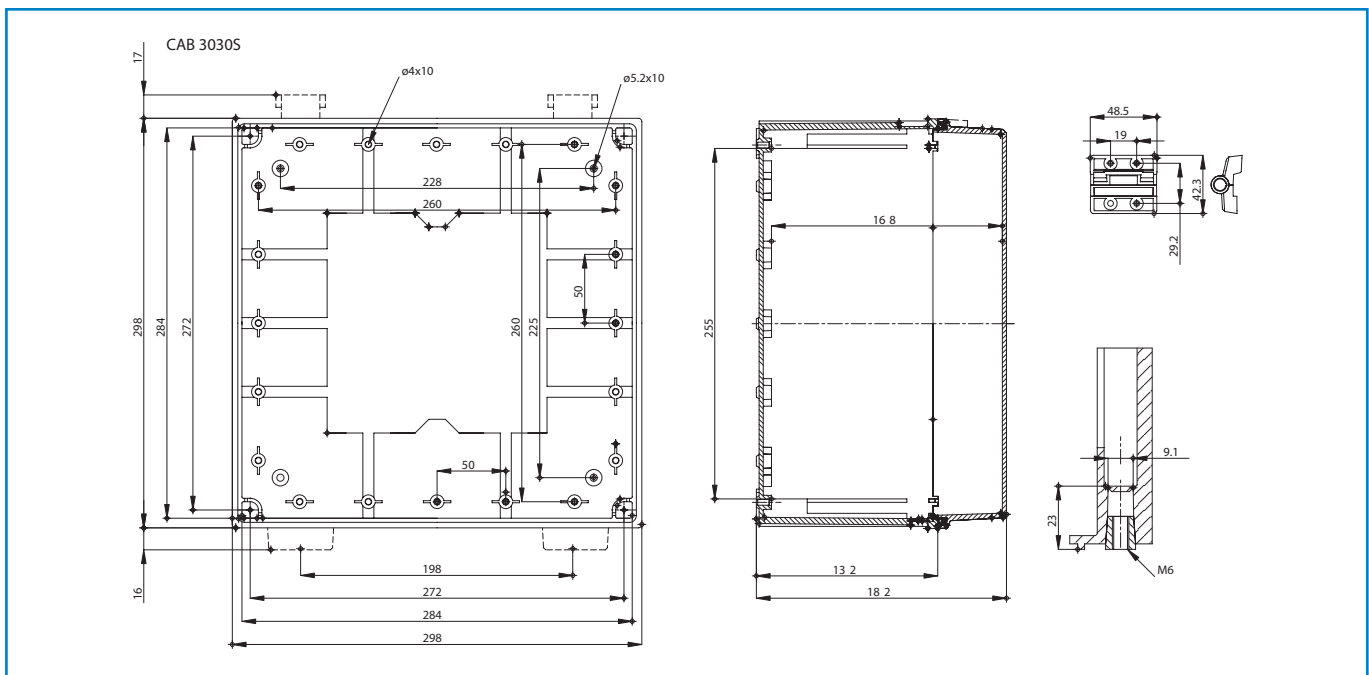

X-ON Electronics

Largest Supplier of Electrical and Electronic Components

Click to view similar products for [fibox manufacturer](#):

Other Similar products are found below :

[MPS ARCA 5040](#) [PCM 175/75 T](#) [ABQ3 364015](#) [EKMVT](#) [CAB ABSQ 302017G](#) [CAB P 302017](#) [CAB PC 303018 G3B](#) [CAB PCQ 404017 T](#)
[ABS 150/125 HG](#) [PCT 081206](#) [CAB ABS 302018 G](#) [CAB PC 303018 T3B](#) [CAB PCQ 303017 T](#) [CAB PCQ 404017 G](#) [PC 5628 13 T](#) [TAM](#)
[090706 MC](#) [ARCA 705030](#) [ARCA 406021](#) [MP 6040](#) [ARCA 405021](#) [ARCA 507030](#) [ARCA 604021](#) [ARCA 806030](#) [EKOE 130 G](#) [2539543](#)
[DRS ARCA 403015](#) [DRS ARCA 304021](#) [DRS ARCA 302015](#) [DRS ARCA 203015](#) [PC 100/125 HG](#) [PC 100/75 HT](#) [PC 300/150 ZG](#) [PCM](#)
[175/150 G](#) [PCM 125/100 G](#) [PC 125/125 HG](#) [PC 200/63 HT](#) [ABS D 65 G](#) [CAB PC 302018 G](#) [CAB ABSQ 403017 G](#) [CAB PC 302018 G3B](#)
[7094450](#) [PC 1919 13 T-2FSH](#) [PC 200/150 HT](#) [9821007](#) [EKPE 130 G ENCLOSURE](#) [ABS C 85 G](#) [FEX 3828 18 T ENCLOSURE](#) [FP 12017](#)
[SET](#) [CAB PC 302018 G CABINET](#) [EKIV 33 MOUNTING PLATE](#)