

**Sealtite NMUA grey:**  
**All-plastic, medium mechanical strength, flexible, UL & CSA approved (type B).**

The NMUA is the universal applicable all plastic Sealtite conduit. The lead-free PVC cover is perfect for applications where no high demands or extreme circumstances will influence the conduit. For this reason type NMUA is used in the machine and apparatus industry, train-warning-systems, and the food industry. Type NMUA is particularly used where an UL/CSA approval is demanded.

**Material & Construction:**

**Construction:** Thick smooth thermoplastic (PVC compound) core reinforced with PVC spiral.

**Cover specifications:** PVC, smoothbore in- and outside, with PVC spiral reinforced, lead-free according to RoHS, sunlight and UV resistant, suitable for outside and burial installation.

**Special approvals:** UL- 1660 **type B** (file # E 211327) and

CSA C22.2 (file # 20817)

**Temperature range:** -20 °C till +80 °C, intermittent up to +100 °C. For CSA -18 °C till +75 °C.

**Colour:** Grey.

**Classification according NEN-EN-IEC 61386:**

**Compression resistance:** Class 2, Light (320 N).

**Impact resistance:** Class 3, Medium (2 J).

**Tensile strength:** Class 4, Heavy (1000 N).

**Protection class:** IP 67 (dust-proof, water-tight).



Spiral reinforced PVC

Sealtite	Diametre		Bending radius		Standard carton		Small carton		Reels		Weight (Kg/m)	
	Size (Inch)	Inside (mm)	Outside (mm)	Static (mm)	Dynamic (mm)	Metre	Article No.	Metre	Article No.	Metre		Article No.
						<b>Grey</b>			<b>Grey</b>		<b>Grey</b>	
3/8"	12,6	17,8	70	100	30	300.012.0	-	-	-	-	0,13	
1/2"	16,0	21,1	100	135	30	300.016.0	-	-	-	-	0,20	
3/4"	21,1	26,4	130	175	30	300.020.0	-	-	-	-	0,30	
1"	26,8	33,1	180	220	30	300.026.0	-	-	-	-	0,38	
1.1/4"	35,4	41,8	225	270	15	300.035.0	-	-	-	-	0,55	
1.1/2"	40,3	47,8	255	320	15	300.040.0	-	-	-	-	0,70	
2"	51,6	59,9	310	400	15	300.050.0	-	-	-	-	1,00	

**ANAMET  
 ALL-PLASTIC  
 CONDUITS**

**CONDUIT  
 TYPE NMUA  
 GREY**

The fittings for Sealtite NMUA are outlined on pages 8-08 till 8-10. Sealtite fittings illustrated in chapter 5 can also be used.



Size Sealtite	Inch	-	-	3/8"	1/2"	3/4"	1"	1 1/4"	1 1/2"	2"	-	-	-
Fittings	ISO	-	-	M16 - M20	M20	M25	M32	M40	M50	M63	-	-	-
	PG	-	-	11 - 13,5	16	21	29	36	42	48	-	-	-
	NPT	-	-	1/2"	1/2"	3/4"	1"	1 1/4"	1 1/2"	2"	-	-	-



**Sealtite NMSF grey:**  
**All-plastic, medium mechanical strength, soft flexible.**

The NMSF is a softer and more flexible execution of type NMUA. The lead-free PVC cover is perfect for applications where no high demands or extreme circumstances will influence the conduit and where no UL/CSA approval is needed. For this reason type NMSF is used in the general machine and apparatus industry.

**Classification according NEN-EN-IEC 61386:**  
**Compression resistance:** Class 1, Very Light (125 N).  
**Impact resistance:** Class 3, Medium (2 J).  
**Tensile strength:** Class 4, Heavy (1000 N).  
**Protection class:** IP 67 (dust-proof, water-tight).

**Material & Construction:**

**Construction:** Thick smooth thermoplastic (PVC compound) core reinforced with PVC spiral.

**Cover specifications:** PVC, smoothbore in- and outside, with PVC spiral reinforced, lead-free according to RoHS, sunlight and UV resistant, suitable for outside and burial installation.

**Temperature range:** -20 °C till +80 °C, intermittent up to +100 °C.

**Colour:** Grey.

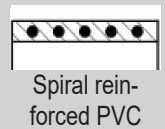

**ANAMET  
 ALL-PLASTIC  
 CONDUITS**

**CONDUIT  
 TYPE NMSF  
 GREY**

Sealtite	Diameter		Bending radius		Standard carton		Small carton		Reels		Weight (Kg/m)
	Size (Inch)	Inside (mm)	Outside (mm)	Static (mm)	Dynamic (mm)	Metre	Article No.	Metre	Article No.	Metre	
						<b>Grey</b>		<b>Grey</b>		<b>Grey</b>	
3/8"	12,6	17,8	70	100	30	325.012.0	-	-	-	-	0,12
1/2"	16,0	21,1	100	135	30	325.016.0	-	-	-	-	0,18
3/4"	21,1	26,4	130	175	30	325.020.0	-	-	-	-	0,28
1"	26,8	33,1	180	220	30	325.026.0	-	-	-	-	0,34
1.1/4"	35,4	41,8	225	270	15	325.035.0	-	-	-	-	0,46
1.1/2"	40,3	47,8	255	320	15	325.040.0	-	-	-	-	0,6
2"	51,6	59,9	310	400	15	325.050.0	-	-	-	-	0,8

The fittings for Sealtite NMSF are outlined on pages 8-08 till 8-10. Sealtite fittings illustrated in chapter 5 can also be used.



Size Sealtite	Inch	-	-	3/8"	1/2"	3/4"	1"	1 1/4"	1 1/2"	2"	-	-	-
Fittings	ISO	-	-	M16 - M20	M20	M25	M32	M40	M50	M63	-	-	-
	PG	-	-	11 - 13,5	16	21	29	36	42	48	-	-	-
	NPT	-	-	1/2"	1/2"	3/4"	1"	1 1/4"	1 1/2"	2"	-	-	-



## Anamet, halogenfree, polyamide fittings for Anaconda Sealrite NMUA / NMSF / NMFG.

These polyamide PA6 Anamet fittings are specially made for the combination with Anaconda Sealrite NMUA / NMSF and NMFG. This fitting offers liquid-tightness in combination with the UL & CSA approvals which makes them also suitable for export projects outside Europe.

### Material & Construction:

**Construction:** Plastic fitting, consisting of 2 parts (counter

nut and body).

**Material:** Polyamide PA-6, V-2, halogenfree.

**Special approvals:** UL- 1660, **type A** (file # E234207) and CSA C22.2 (file #E234207).

**Temperature:** -40 °C till +120 °C continuous.

**Protection class:** IP 67 (dust-proof, water-tight).

**Colour:** Grey.



### ISO straight fitting, male, PA 6

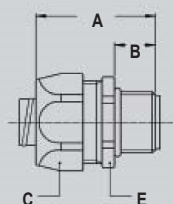

Thread	NMUA	Min. Internal Bore (mm)	Dimensions in mm					Standard Package	Article Number	Weight (Kg/100)
			A	B	C	D	E			
M16 x 1,5	3/8"	10,9	47	14	35	-	33	25	263.016.0	2,0
M20 x 1,5	1/2"	14,4	47	14	35	-	33	25	263.020.0	2,3
M25 x 1,5	3/4"	18,0	49	16	43	-	39	10	263.025.0	3,4
M32 x 1,5	1"	23,9	53	16	49	-	44	5	263.032.0	5,8

### ISO 90° fitting, male, PA 6

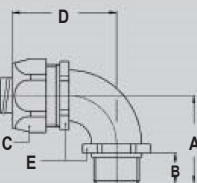

Thread	NMUA	Min. Internal Bore (mm)	Dimensions in mm					Standard Package	Article Number	Weight (Kg/100)
			A	B	C	D	E			
M16 x 1,5	3/8"	10,9	30	13	35	60	31	10	263.116.0	2,4
M20 x 1,5	1/2"	14,4	30	13	35	60	31	10	263.120.0	2,9
M25 x 1,5	3/4"	18,0	40	14	43	68	37	10	263.125.0	4,1
M32 x 1,5	1"	23,9	50	16	49	82	45	5	263.132.0	6,7

**ANAMET  
ALL-PLASTIC  
CONDUITS**

**LIQUID-TIGHT  
FITTINGS FOR  
NMUA / NMSF  
IP 67**

**NPT straight fitting, male, PA 6  
(including NPT lock nut).**

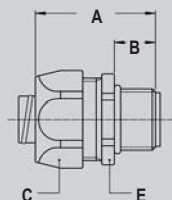

Thread NPT	NMUA Size (inch)	Min. Internal Bore (mm)	Dimensions in mm					Standard Package	Article Number	Weight (Kg/100)
			A	B	C	D	E			
1/2"	3/8"	10,9	47	14	35	-	33	<b>25</b>	<b>263.312.0</b>	2,3
1/2"	1/2"	14,4	47	14	35	-	33	<b>25</b>	<b>263.316.0</b>	2,6
3/4"	3/4"	18,0	49	16	43	-	39	<b>10</b>	<b>263.320.0</b>	3,8
1"	1"	23,9	53	16	49	-	44	<b>5</b>	<b>263.326.0</b>	6,3
1.1/4"	1.1/4"	30,6	60	18	59	-	55	<b>5</b>	<b>263.335.0</b>	9,5
1.1/2"	1.1/2"	35,4	64	19	66	-	61	<b>1</b>	<b>263.340.0</b>	10,3
2"	2"	47,8	72	21	83	-	79	<b>1</b>	<b>263.350.0</b>	19,5

**NPT 90° fitting, male, PA 6  
(including NPT lock nut).**

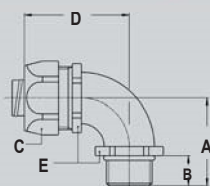

Thread NPT	NMUA Size (inch)	Min. Internal Bore (mm)	Dimensions in mm					Standard Package	Article Number	Weight (Kg/100)
			A	B	C	D	E			
1/2"	3/8"	10,9	30	13	35	60	31	<b>10</b>	<b>263.412.0</b>	2,7
1/2"	1/2"	14,4	30	13	35	60	31	<b>10</b>	<b>263.416.0</b>	3,2
3/4"	3/4"	18,0	40	14	43	68	37	<b>10</b>	<b>263.420.0</b>	4,5
1"	1"	23,9	50	16	49	82	45	<b>5</b>	<b>263.426.0</b>	7,2
1.1/4"	1.1/4"	30,6	68	18	59	84	54	<b>5</b>	<b>263.435.0</b>	14,4
1.1/2"	1.1/2"	35,4	70	19	66	88	59	<b>1</b>	<b>263.440.0</b>	16,8
2"	2"	47,8	73	21	83	90	74	<b>1</b>	<b>263.450.0</b>	27,2

**ANAMET  
ALL-PLASTIC  
CONDUITS**

**LIQUID-TIGHT  
FITTINGS FOR  
NMUA / NMSF  
IP 67**



## Anaconda nickel plated brass fittings for NMUA / NMSF.

The nickel plated brass Anaconda fittings can also be used with Anaconda Sealrite NMUA and NMSF. This Anaconda fitting is the most used universal fitting and offers great corrosion protection in combination with a nice appearance. They are also available in stainless steel.

**Construction:** Nickel plated brass fitting, consisting of 4 parts (counter nut, clamping ring, ferrule and body).

**Material:** Counter nut, body and ferrule are nickel plated

brass with exception of size 3/8" till 1" where the ferrule is from galvanised steel. Clamping ring and inserts are made from PA6 (red for ISO metric, blue for Pg and white for NPT).

**Temperature:** -45 °C till +105 °C continuous (cable-hose-fittings are -40 °C till +100 °C).

**Protection class:** IP 67 (dust-proof, water-tight), with cable-hose fittings an IP 68 rate on the switchbox can be obtained.

**Colour:** Metal.



### ISO straight fitting, male, nickel plated brass.

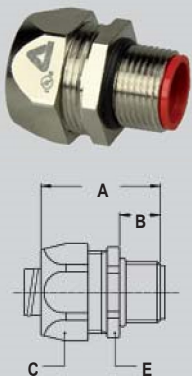

Thread ISO	Sealrite Size (inch)	Min. Internal Bore (mm)	Dimensions in mm					Standard Package	Article Number	Weight (Kg/100)
			A	B	C	D	E			
M16 x 1,5	3/8"	10,2	35	12	26	-	24	10	812.016.1	4,8
M20 x 1,5	3/8"	10,2	36	13	26	-	24	10	812.017.1	5,1
M20 x 1,5	1/2"	13,9	37	13	29	-	27	10	812.020.1	5,9
M25 x 1,5	3/4"	18,5	40	15	35	-	33	5	812.025.0*	7,9
M32 x 1,5	1"	23,8	46	15	45	-	43	5	812.032.1	17,5
M40 x 1,5	1.1/4"	31,8	52	16	54	-	52	2	812.040.1	27,9
M50 x 1,5	1.1/2"	36,8	56	18	63	-	60	2	812.050.1	42,3
M63 x 1,5	2"	47,8	66	20	77	-	74	2	812.063.1	73,5

\* Fitting is including turned ferrule for higher pull-out strength



### Pg straight fitting, male, nickel plated brass.

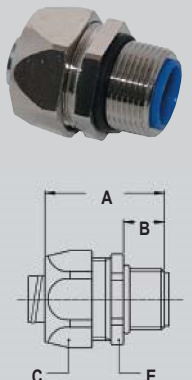

Thread Pg	Sealrite Size (inch)	Min. Internal Bore (mm)	Dimensions in mm					Standard Package	Article Number	Weight (Kg/100)
			A	B	C	D	E			
Pg 9	3/8"	10,2	35	12	26	-	24	10	810.010.1	4,8
Pg 11	3/8"	10,2	35	12	26	-	24	10	810.011.1	5,6
Pg 13,5	3/8"	10,2	35	12	26	-	24	10	810.013.1	5,6
Pg 16	1/2"	13,9	37	13	29	-	27	10	810.016.1	6,3
Pg 21	3/4"	18,5	40	15	35	-	33	5	810.021.0*	8,4
Pg 29	1"	23,8	46	15	45	-	43	5	810.029.1	25,0
Pg 36	1.1/4"	31,8	52	16	54	-	52	2	810.036.1	34,6
Pg 42	1.1/2"	36,8	56	18	63	-	60	2	810.042.1	47,2
Pg 48	2"	47,8	66	20	77	-	74	2	810.048.1	72,0

\* Fitting is including turned ferrule for higher pull-out strength

## X-ON Electronics

Largest Supplier of Electrical and Electronic Components

*Click to view similar products for [Non-Heat Shrink Tubing and Sleeves](#) category:*

*Click to view products by [ANAMET EUROPE](#) manufacturer:*

Other Similar products are found below :

[601203-000](#) [CTA-0053](#) [8429-9](#) [8445-7.5](#) [8450](#) [120-116-1-1-09BE](#) [120-116-1-1-09BF](#) [120-116-1-1-09BP](#) [120-116-1-1-12BE](#) [120-116-1-1-12BP](#) [120-123-06](#) [120-123-10](#) [120-125-12BL](#) [120-125-12R](#) [120-125-20R](#) [120-126-09](#) [120-126-09BL](#) [120-126-12](#) [120-126-12BL](#) [120-126-52](#) [120-126-52BL](#) [120-104-12](#) [120-105-1-1-06BE](#) [120-105-1-1-06CE](#) [120-116-1-1-06BP](#) [120-116-1-1-10BP](#) [120-116-1-1-12BF](#) [120-123-12](#) [120-125-09](#) [120-125-12](#) [120-125-12Y](#) [120-125-52BL](#) [120-S002-12](#) [120-S001-09](#) [120-S002-09](#) [121-101-1-1-56BFC](#) [121-101-1-1-64BFC](#) [RAY-90-3.0\(100\)](#) [20675-2](#) [8S42-100FR-CS8184](#) [SAS-115-1-1048-1X](#) [SAS-160-1-1048-1X](#) [RAY-103-10.0\(100\)](#) [RAY-103-4.0\(100\)](#) [4627-S](#) [3-1991136-0](#) [561-SL1000PP](#) [561-SL250FRPP](#) [561-SL375NYGY](#) [561-SL375PE](#)