

**QUICK CAB PCQ 302017 G**



Sample photo

**Order symbol:** CAB PCQ 302017 G  
**Product nbr:** 8113338  
**Description:** Cabinet, PC  
**Remarks:** Grey cover

**EAN:** 6418074011145  
**EI. number:**  
 Finland: 3421970  
 Electric No. Italy: 7681020  
 Electric No. Sweden: 2539106

Including: Base with screws for mounting plate/DIN-rail, internal corner plugs, cover with PUR gasket and CS 12137 cover screws.

Dimensions:		Length	Width	Height	Accessories:		
mm:		300	200	170	EKIV 17	DIN-35 Mounting rail	
inch:		11.8	7.9	6.7	EKIV 27	DIN-35 Mounting rail	
<b>Materials:</b>						FP A 23	Swing-out door/Front plate
<b>Material:</b>		Polycarbonate			MB 12225 AL	Swing door set	
<b>Base colour:</b>		RAL 7035 -light grey			FP 12-23	Front plate	
<b>Cover screws material:</b>		Polyamide			DRF 23	DIN rail frame set	
<b>Cover colour:</b>		RAL 7035 -light grey			DRF 33	DIN rail frame set	
<b>Cover screws colour:</b>		RAL 5023			PAT 12040	Hinge set	
<b>Gasket material:</b>		Polyurethane					
<b>Temperatures:</b>						<b>Rating:</b>	
<b>Temperature °C (short term):</b>		-40 ... 120 °C			Ingress Protection (EN 60529): IP66/IP67		
<b>Temperature °C (continuous):</b>		-40 ... 80 °C			Impact Resistance (EN 62262): IK08		
<b>Temperature °F (short term):</b>		-40 ... 250 °F			Electrical insulation: Totally insulated		
<b>Temperature °F (continuous):</b>		-40 ... 175 °F			Halogen free (DIN/VDE 0472, Part 815): 1		
<b>Accessories:</b>						UV resistance: UL 508	
EKIV 23		Mounting plate			Flammability Rating: UL 746C 5"		
						Glow Wire Test (IEC 695-2-1) °C: 960	
						NEMA Class: NEMA 1, 4, 4X, 12, 13	
						<b>Certificates:</b>	
						Germanischer Lloyd (GL)	
						SGS Fimko	
						Lloyds Register of Shipping (LR)	
						Gost R	

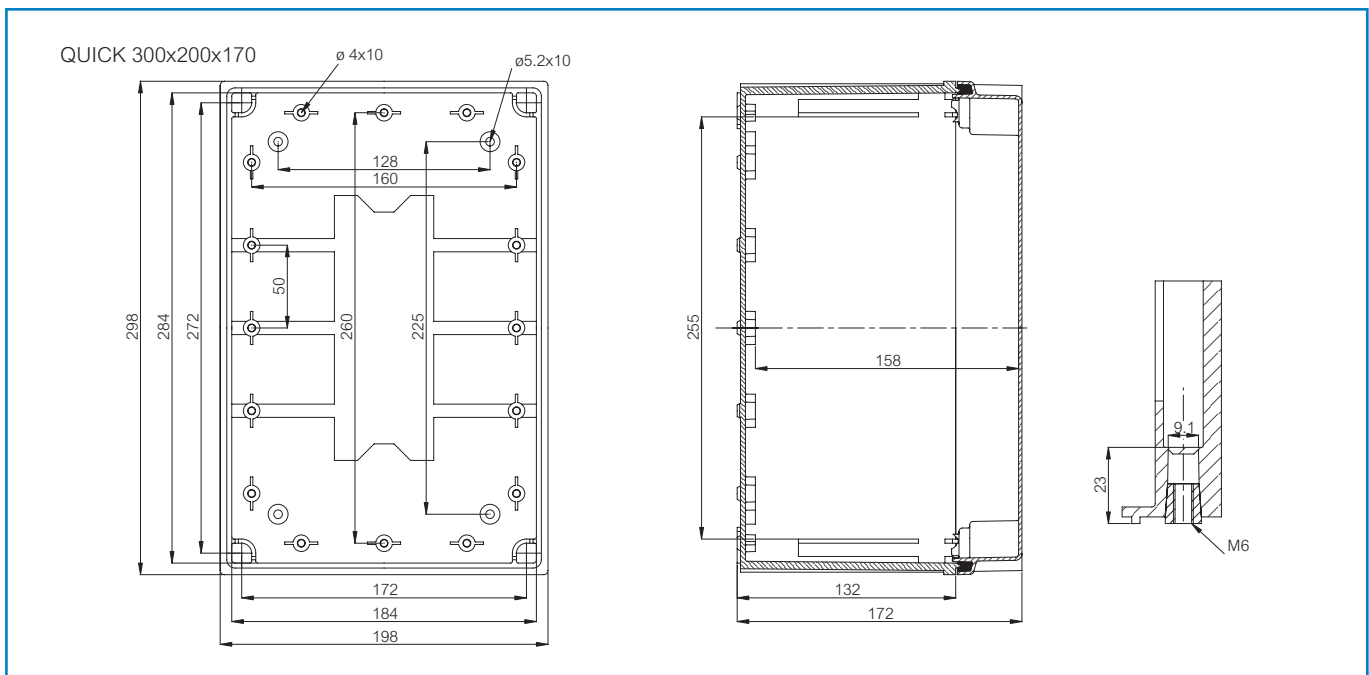

## X-ON Electronics

Largest Supplier of Electrical and Electronic Components

*Click to view similar products for [Enclosures, Boxes, & Cases](#) category:*

*Click to view products by [Fibox](#) manufacturer:*

Other Similar products are found below :

[CR-425 PAINTED](#) [585-R-WH-PK](#) [M-10-PLATED](#) [60221-01](#) [60566-01-000](#) [HPL-9VB BATT DOOR](#) [M-16-LID-PLATED](#) [M18-PLTD](#) [M-21-LID-PLATED](#) [M-21-PLATED](#) [M-23-PLATED](#) [CU-281-MB](#) [6711GSKT](#) [71884-29-028](#) [LH45-100 Black](#) [7200B](#) [72868-510-000](#) [CNS-0000 Black](#) [72883-510-000](#) [CNS-0101 Black](#) [72906-510-000](#) [CNS-0407 Black](#) [73091-510-000](#) [CNM-0000-BLACK Kit](#) [73092-510-000](#) [CNM-0101 Black](#) [73108-510-000](#) [CNL-0303 Black](#) [73395-510-039](#) [CNS-0006 Bone](#) [74257-510-000](#) [CNL-0004](#) [MDC-1183-PLAIN-ALUM](#) [MDC-1183-PTD](#) [MDC-13104-PLAIN-ALUM](#) [MDC-211 - PAINTED IVORY/BEIGE](#) [MDC-321-PTD](#) [MDC-432-PLAIN-ALUM](#) [MDC-973-PTD](#) [76](#) [77153-01-028](#) [FLX6030](#) [83535-01-508](#) [PS-11296-G](#) [PS-11298-B](#) [116-508](#) [120-407](#) [120-412](#) [120-909](#) [120-455](#) [R272-100-000](#) [120-910](#) [R501-001-010](#) [R508-080-000](#) [R508-160-000](#) [R530-120-000](#) [R530-122-000](#) [R530-200-000](#) [R531-160-000](#) [R531-200-000](#) [R582-080-100](#)