

Product Name: LCK Cable Mounts

Features & Benefits:

The LKC mounts give additional support to the cables by means of their curved design. Simple to install with a screw or bolt they give excellent security, particularly in areas of high vibration.

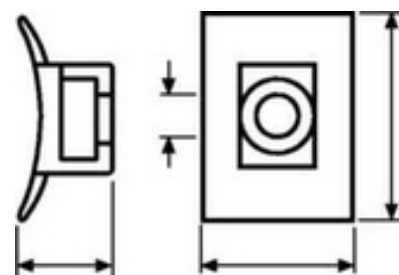

Application:

Designed specifically for holding heavier cable bundles these mounting bases can be used in many industries from agriculture to truck manufacture. They offer a very secure fixing and can be used with a wide variety of heavy duty cable ties up to 13mm wide.

Material Data:

Material: Polyimide 6.6 (PA66)

Colour: Black (BK), Natural (NA)

Operating Temp: -40°C to +85°C Continuous, (+105°C for 500h)

Flammability: UL94 V2

Technical Table:

Article No.	Type	Length (L)	Width (W)	Height (H)	Fixing Hole Ø (FH)	Strap Width max. (G)	Colour
LKCSF1.NN3P	LKCSF1	40.0	19.0	16.0	6.0	13.0	Natural
LKCSF1.NB3P	LKCSF1	40.0	19.0	16.0	6.0	13.0	Black
LKCRF1.NB3P	LKCRF1	23.82	11.91	3.99	6.35	4.8	Black
LKCRF1.NN3P	LKCRF1	23.82	11.91	3.99	6.35	4.8	Natural

X-ON Electronics

Largest Supplier of Electrical and Electronic Components

Click to view similar products for [Hellermann](#) manufacturer:

Other Similar products are found below :

[111-03250](#) [RSB2](#) [ETST668](#) [T18RPOCKETPAC](#) [217-2B7W1](#) [380-03003](#) [406064A](#) [TSR1I-21](#) [TSR1I-29](#) [TSR1I-33](#) [TSR1I-36](#) [1126-4JW8](#)
[RSB6](#) [MS3109-12AU](#) [Q30LR-PA66-BK-C1](#) [HWCLIP16 BLACK](#) [RLT150.NB2P](#) [T50IDH0C2](#) [T30MR BLACK](#) [AS45](#) [LPH275 BLACK](#)
[T120R.RN3P](#) [MK7.9A](#) [181-50840](#) [TWT2](#) [MCTPP50L](#) [MCTPP120R](#) [MBT14H](#) [G51P-A-PE-NA](#) [E4500](#) [TSRI-JB2](#) [SBS2 YELLOW](#) [309-](#)
[65110](#) [309-65129](#) [309-65214](#) [309-65298](#) [309-65300](#) [309-65105](#) [309-65117](#) [309-65118](#) [309-65164](#) [NGM20-RED](#) [NGM20-WH](#) [H75X25](#)
[RED](#) [HA67-69.8-11.7](#) [HA67-88.9-17.1](#) [321-50012](#) [HEGPA6614 GREY](#) [HIS-3-9/3-PEX-CL](#) [HIS-3 12/4 CLR](#)