



Model Number

NBN4-12GM40-Z0-V1

Features

- 4 mm not embeddable
- 2-wire DC

Connection

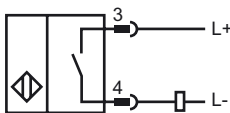

Pinout

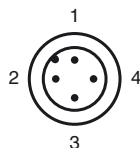

Wire colors in accordance with EN 60947-5-2

- | | |
|---|----|
| 1 | BN |
| 2 | WH |
| 3 | BU |
| 4 | BK |

Accessories

- V1-W**
Field attachable female cordset
- V1-G-2M-PUR**
Cable socket, M12, 4-pin, PUR cable
- V1-W-2M-PUR**
Cable socket, M12, 4-pin, PUR cable
- BF 12**
Mounting flange, 12 mm
- V1-G**
Field attachable female cordset

Dimensions

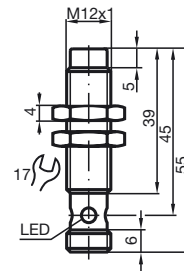

Technical Data

General specifications

Switching element function	DC	NO
Rated operating distance	s_n	4 mm
Installation		not embeddable
Output polarity		DC
Assured operating distance	s_a	0 ... 3.24 mm
Reduction factor r_{Al}		0.37
Reduction factor r_{Cu}		0.36
Reduction factor r_{V2A}		0.74

Nominal ratings

Operating voltage	U_B	5 ... 60 V
Switching frequency	f	0 ... 1000 Hz
Hysteresis	H	1 ... 10 typ. 5 %
Reverse polarity protected		tolerant
Short-circuit protection		pulsing
Voltage drop	U_d	≤ 5 V
Operating current	I_L	2 ... 100 mA
Lowest operating current	I_m	2 mA
Off-state current	I_r	0 ... 0.5 mA typ.
Indication of the switching state		Multihole-LED, yellow

Ambient conditions

Ambient temperature		-25 ... 70 °C (-13 ... 158 °F)
---------------------	--	--------------------------------

Mechanical specifications

Connection type		Device connector M12 x 1 , 4-pin
Housing material		brass, nickel-plated
Sensing face		PBT
Protection degree		IP67

Compliance with standards and directives

Standard conformity		
Standards		EN 60947-5-2:2007 IEC 60947-5-2:2007

Approvals and certificates

UL approval		cULus Listed, General Purpose
CSA approval		cCSAus Listed, General Purpose
CCC approval		Certified by China Compulsory Certification (CCC)

Release date: 2010-10-20 10:53 Date of issue: 2010-10-20 088195_ENG.xml

X-ON Electronics

Largest Supplier of Electrical and Electronic Components

Click to view similar products for [Pepperl & Fuchs](#) manufacturer:

Other Similar products are found below :

[RL31-54/73C/136](#) [3RG7122-0AA00](#) [NBB-12GM40-E1](#) [3RG4013-3KB00](#) [3RG4038-3KB00](#) [3RG7134-3AA00](#) [LD31/LV31/25/73C/76A/136](#)
[NBB4-12GM50-A2-V1](#) [RL31-8-1200-RT/73C/136](#) [CBB8-18GS75-E2](#) [45018](#) [UC2000-30GM-E6R2-V15](#) [6GR6221-3AB00](#) [REF-MH50](#)
[3RG4148-3CD00](#) [INX360D-F99-I2E2-V15](#) [MPS11HD](#) [UB2000-F42-U-V15](#) [50FY416](#) [NBN4-12GM50-E0](#) [UC2000-30GM-IUR2-V15](#)
[41FR2](#) [3RG6233-3JS00](#) [NBN8-12GM50-E2-V1](#) [UC-30GM-R2](#) [M100/MV100-RT/35/76A/95/103](#) [3RG4013-0KB00](#) [UB400-F77-E2-V31](#)
[3RG4023-3AG33](#) [MD17/73](#) [NBB5-18GM50-E2](#) [NBN4-12GM50-E2](#) [UB800-18GM40-U-V1](#) [UB800-18GM40-I-V1](#) [ML100-55/95/103](#)
[KCD2-R](#) [NBB15-30GM50-E2-V1](#) [UB2000-F42-E5-V15](#) [REF-C110-2](#) [ML100-8-1000-RT/95/103](#) [3RG4200-1AB00](#) [NBB2-V3-E2](#)
[3RG7120-3AA00](#) [OB-150-F6-E5](#) [REF-H50](#) [UB800-18GM40-E5-V1](#) [MV17/73/136](#) [NBB4-12GM50-E2-V1](#) [3RG6343-3AB00](#) [NJ2-PD-US-](#)
[2.062-V93](#)