

# DTS-31 CURRENT COMPENSATED CHOKES

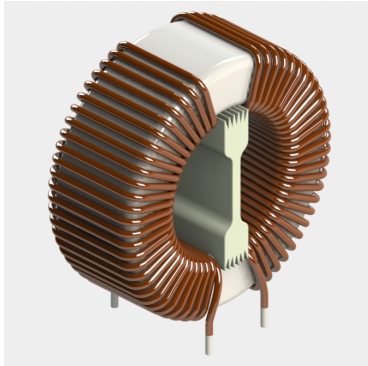

## APPLICATIONS:

- Common-mode noise suppression on an AC power supply line and signal/data line

## ORDERING CODE:

DTS -31 /22 /3,3 -V

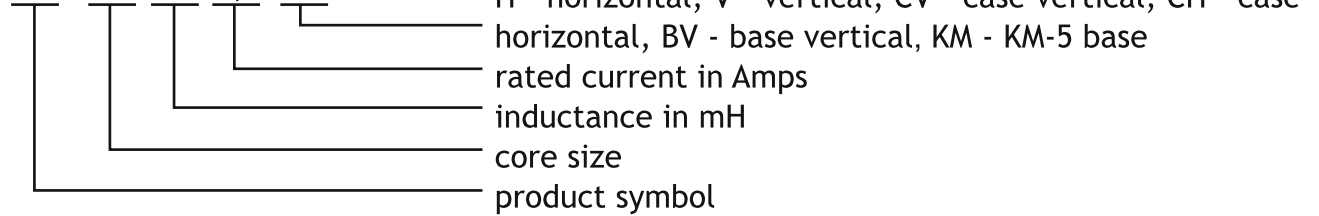

## DIMENSIONS:

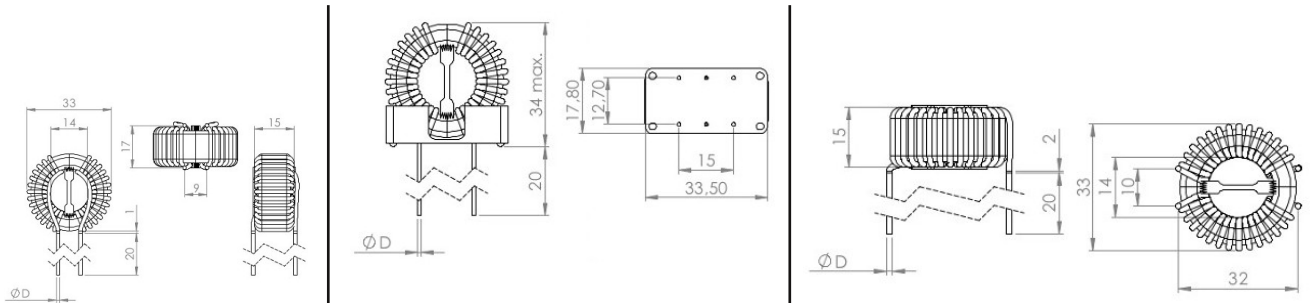

vertical version

KM version  
POD-FATR-KM5-BASE

horizontal version

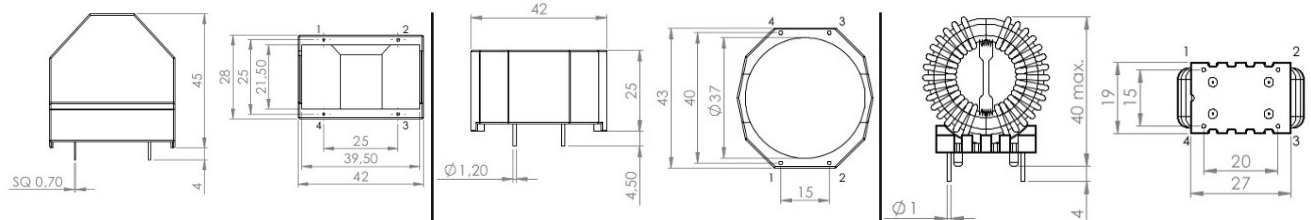

CV version  
OBUD-TOR-VGH 42X21,5x45  
mat: PA66 FR50 [E41938](#)

CH version  
OBUD-TOR-H-39X24-F

BV version  
POD-27X19-10P  
mat: T-375J [E304813](#)  
[UL EIS FER-155 class F - 155°C](#)

**FOOTPRINTS:**

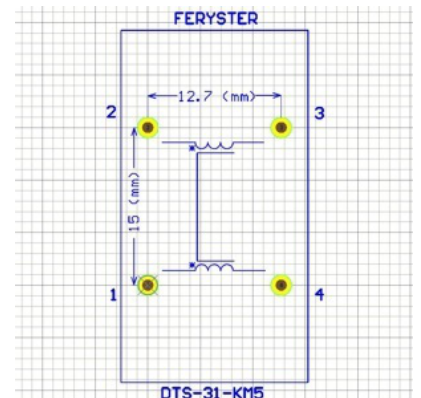
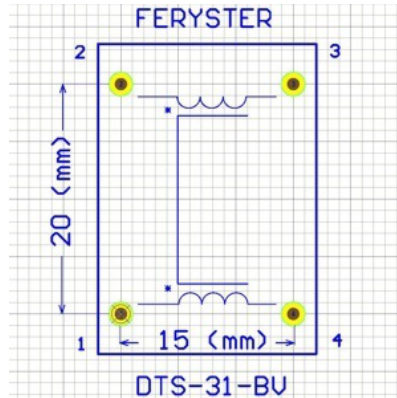
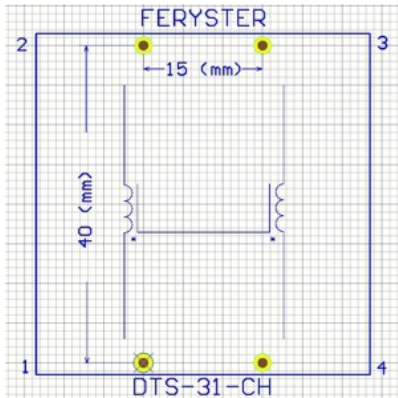
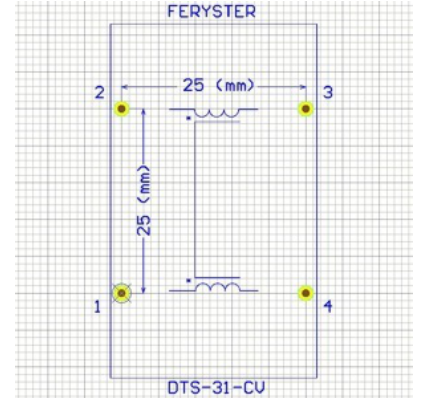
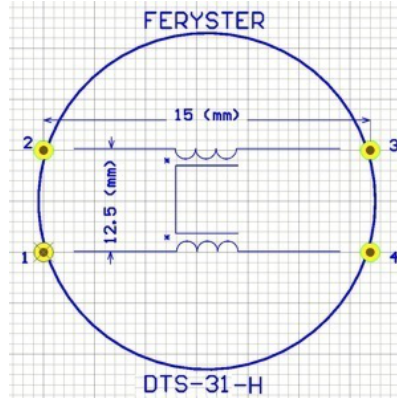
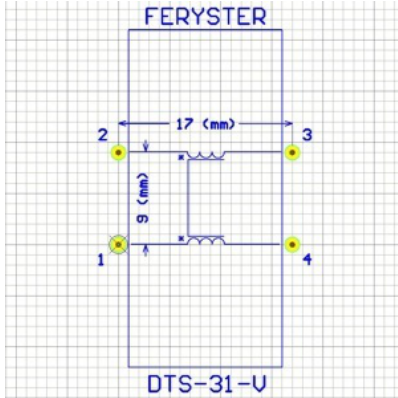

**PROPERTIES:**

Part number	$L_{nom}$ [mH]	$I_{nom}$ [A]	RDC [ $\Omega$ ]	Mounting version						$\varnothing D$ [mm]
				V	H	CV	CH	BV	KM	
DTS-31/0,22/30	2x0,22	30	2x0,001	✓	✓	-	-	-	✓	2,2
DTS-31/0,33/25	2x0,33	25	2x0,002	✓	✓	-	-	-	✓	2,0
DTS-31/0,47/25	2x0,47	25	2x0,002	✓	✓	-	-	-	✓	2,0
DTS-31/0,68/20	2x0,68	20	2x0,003	✓	✓	-	-	-	✓	1,8
DTS-31/1,0/18	2x1,0	18	2x0,004	✓	✓	-	-	-	✓	1,7
DTS-31/1,5/15	2x1,5	15	2x0,010	✓	✓	-	-	-	✓	1,6
DTS-31/2,2/10	2x2,2	10	2x0,010	✓	✓	-	-	-	✓	1,4
DTS-31/3,3/7,8	2x3,3	7,8	2x0,020	✓	✓	-	-	-	✓	1,2
DTS-31/4,7/6,3	2x4,7	6,4	2x0,023	✓	✓	-	-	-	✓	1,1
DTS-31/6,8/5,0	2x6,8	5,0	2x0,030	✓	✓	✓	✓	✓	✓	0,9
DTS-31/10/5,0	2x10	5,0	2x0,040	✓	✓	✓	✓	✓	✓	0,9
DTS-31/15/4,0	2x15	4,0	2x0,070	✓	✓	✓	✓	✓	✓	0,8
DTS-31/22/3,3	2x22	3,3	2x0,100	✓	✓	✓	✓	✓	✓	0,8

- Inductance tolerance: -20% +50%
- LCR meter  $f=10\text{kHz}$
- Dielectric withstanding voltage 2000V
- RDC Cu wire resistance  $\pm 20\%$

**CHARACTERISTICS:**

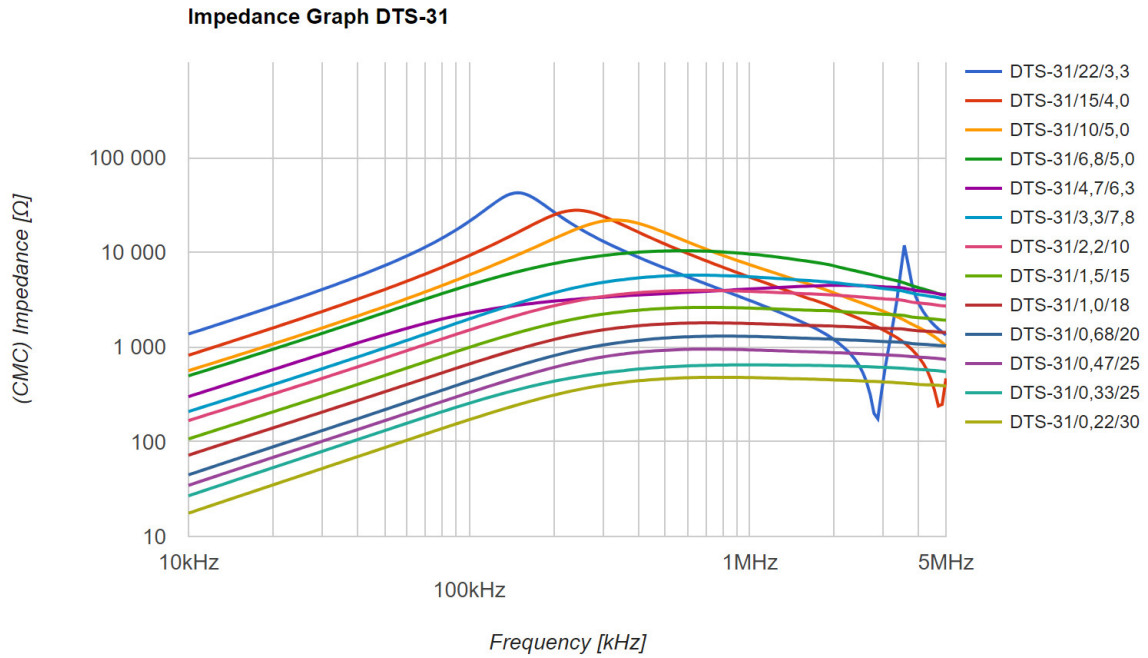

**MEASUREMENT METHOD:**

- Measured with RIGOL DSA815.

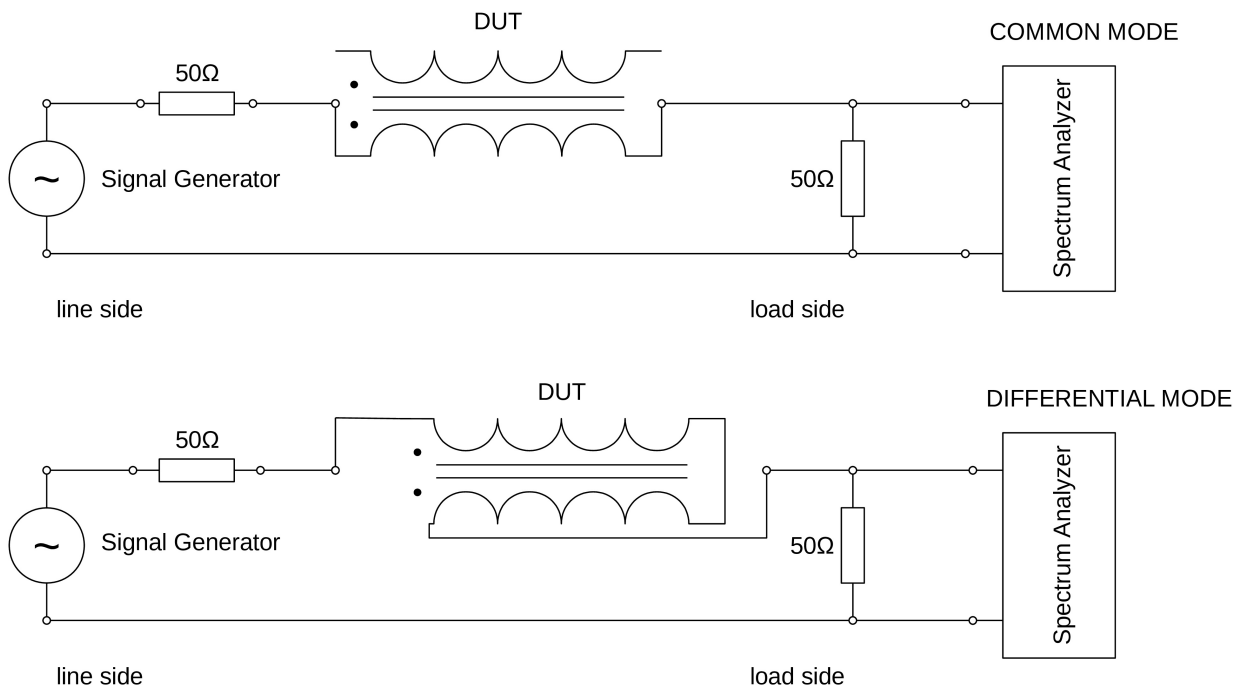

**ATTENUATION:**

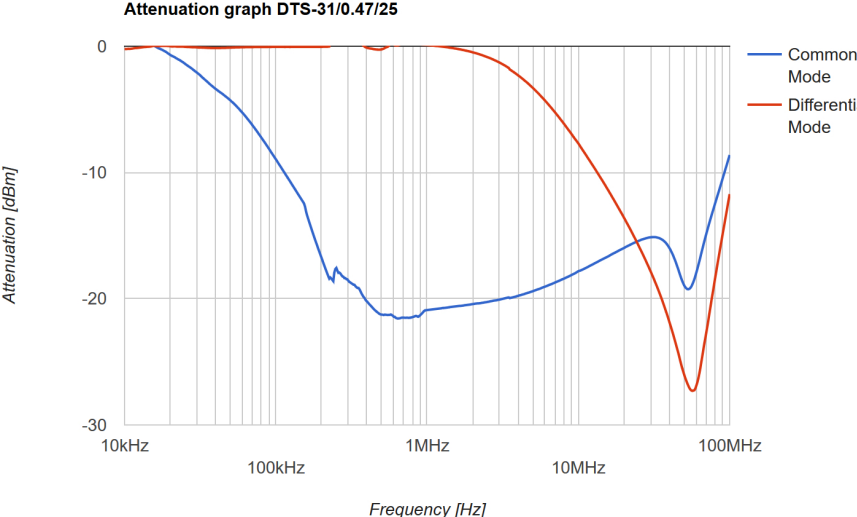
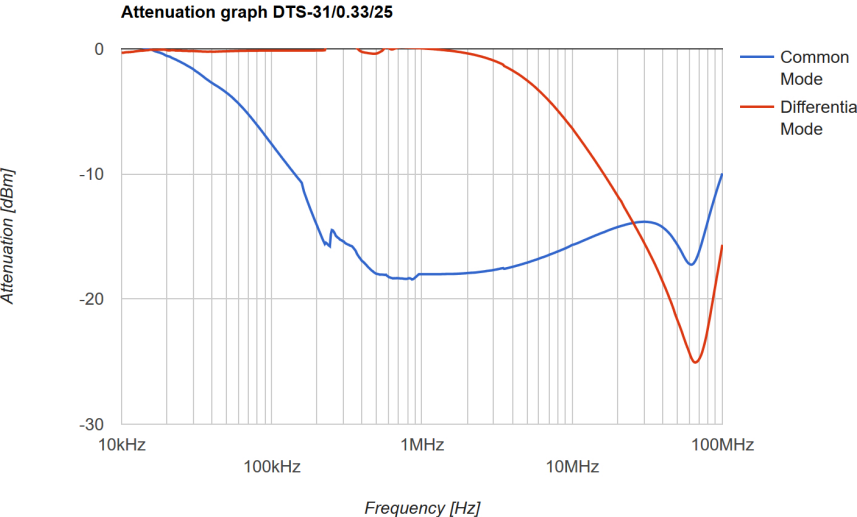
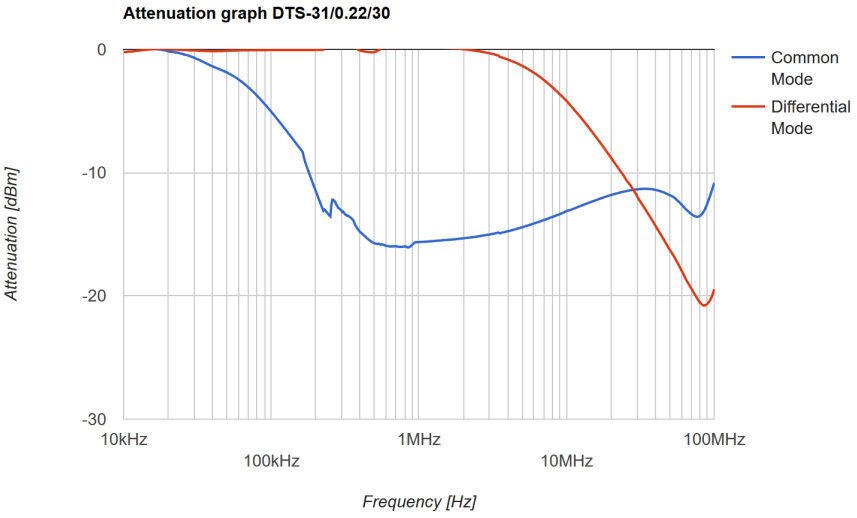

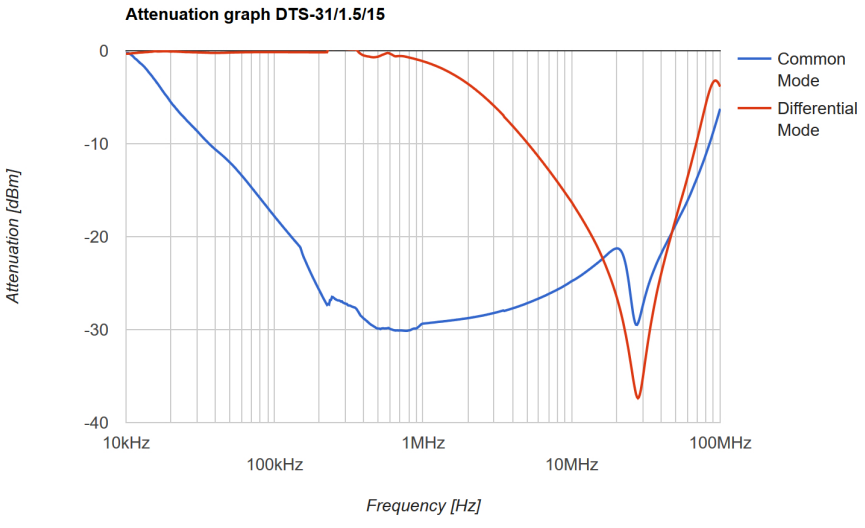
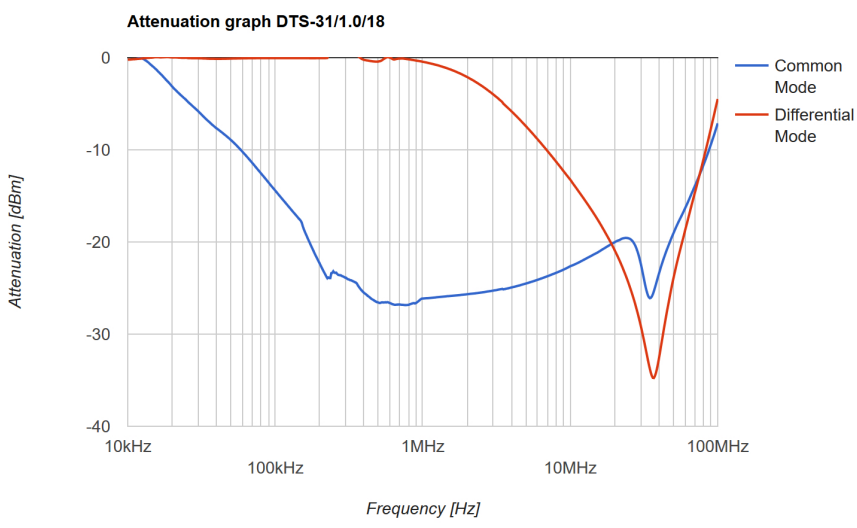
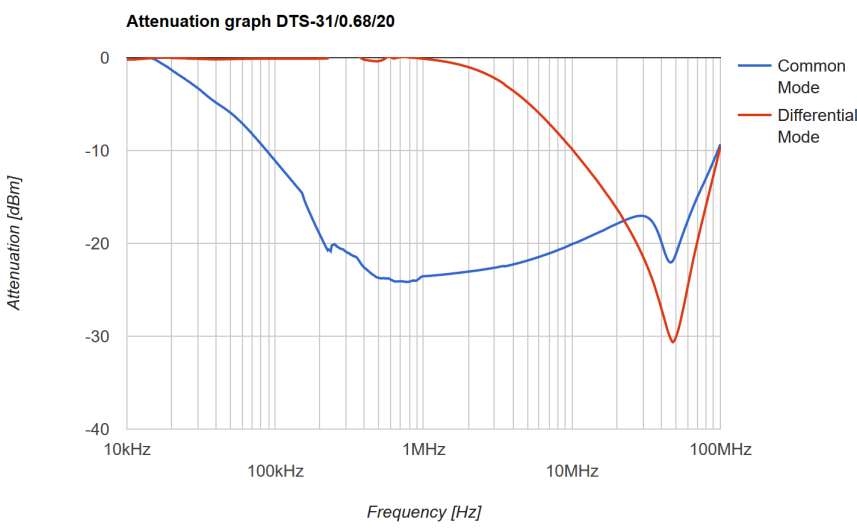

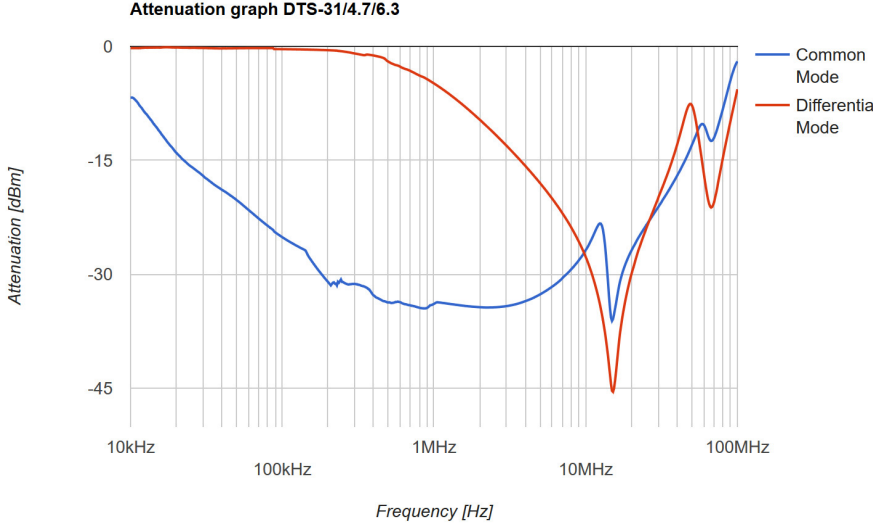
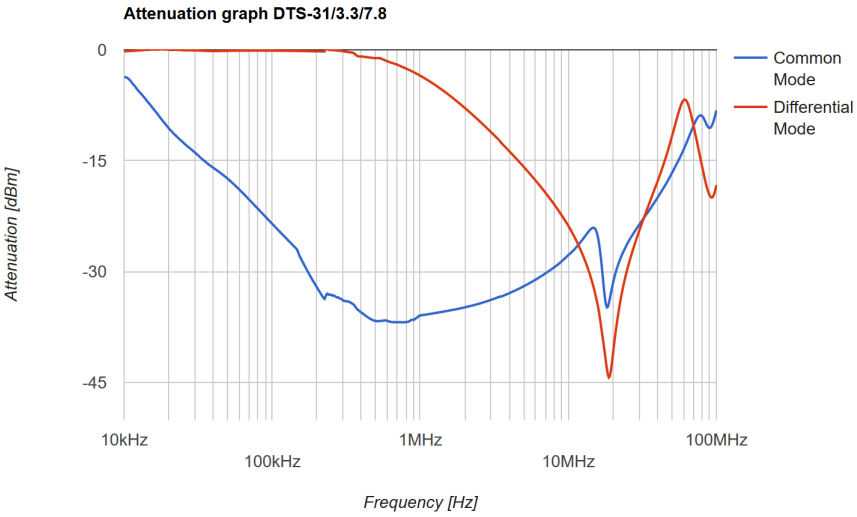
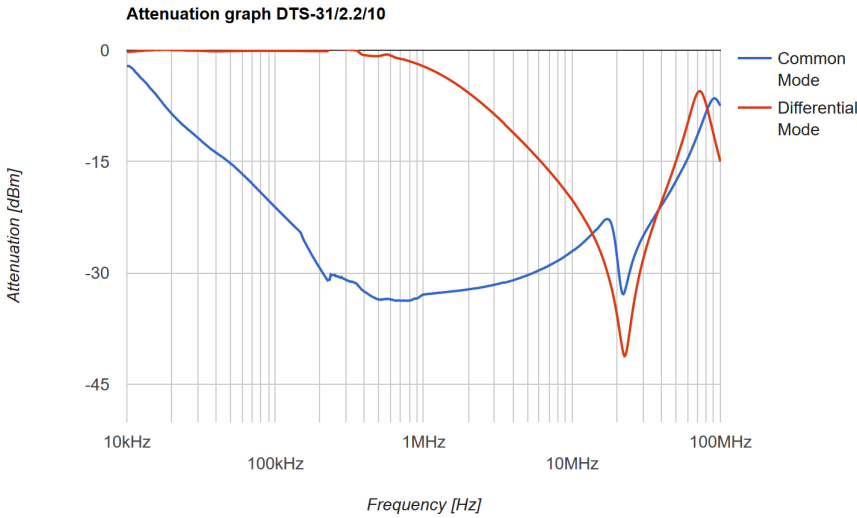

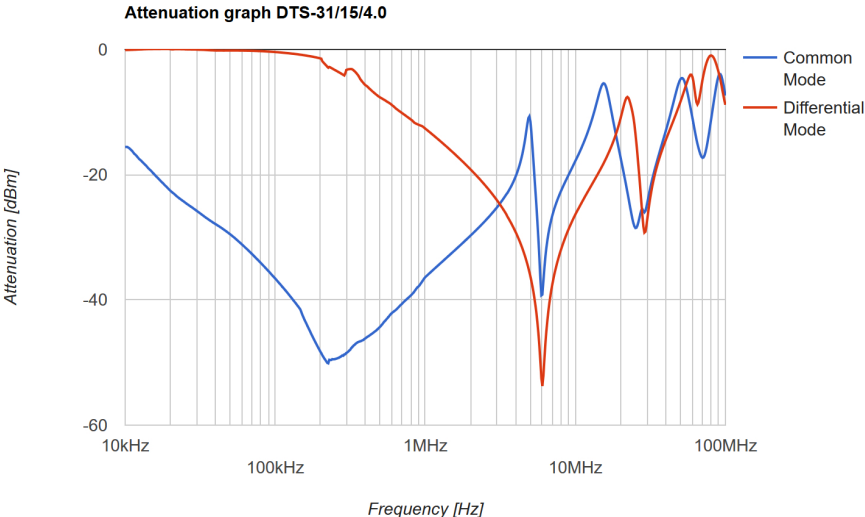
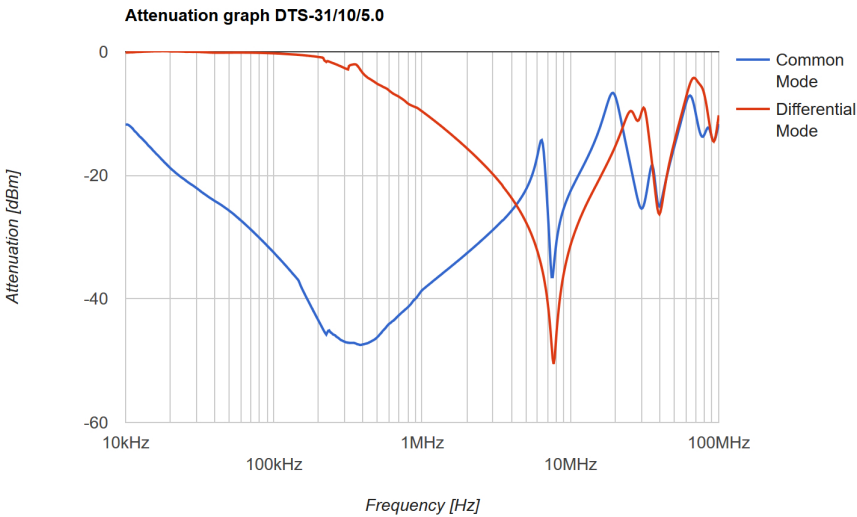
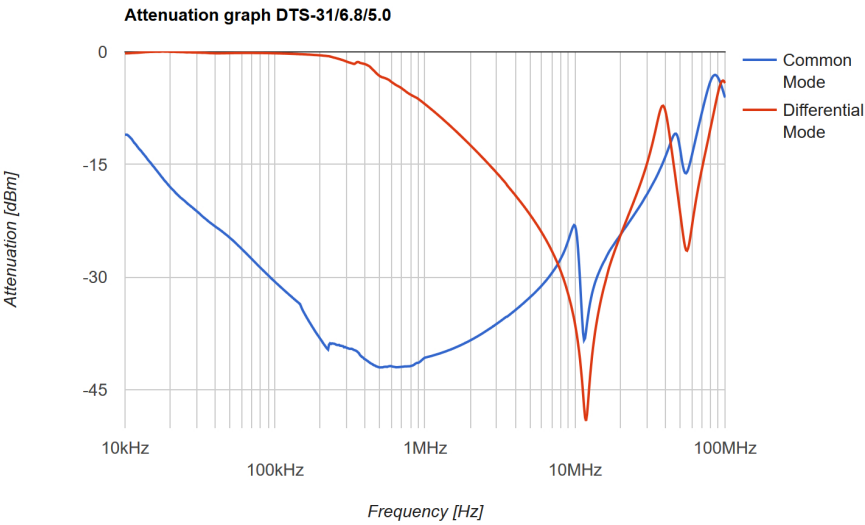

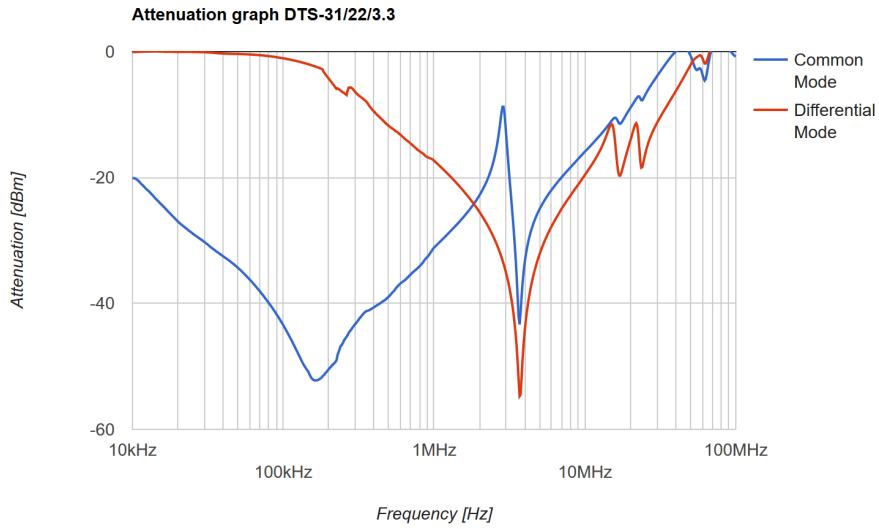

**COMMON MODE ATTENUATION:**

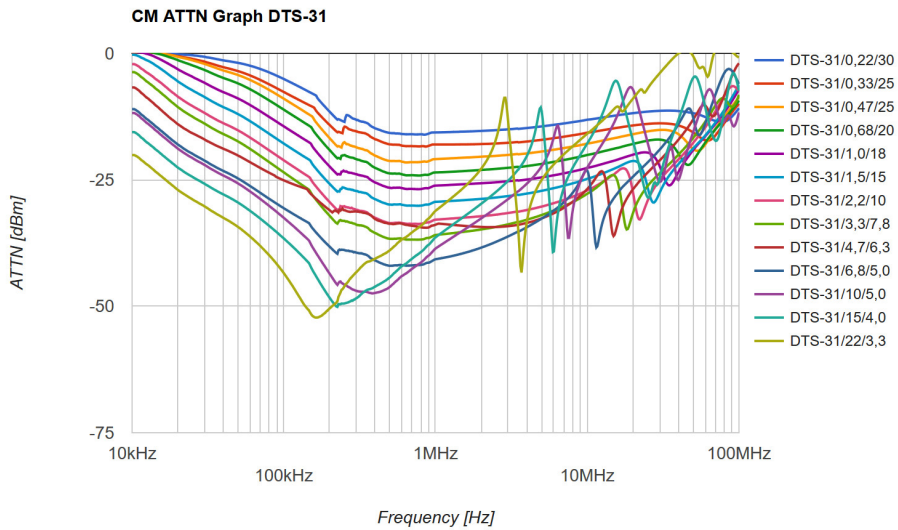

**DIFFERENTIAL MODE ATTENUATION:**

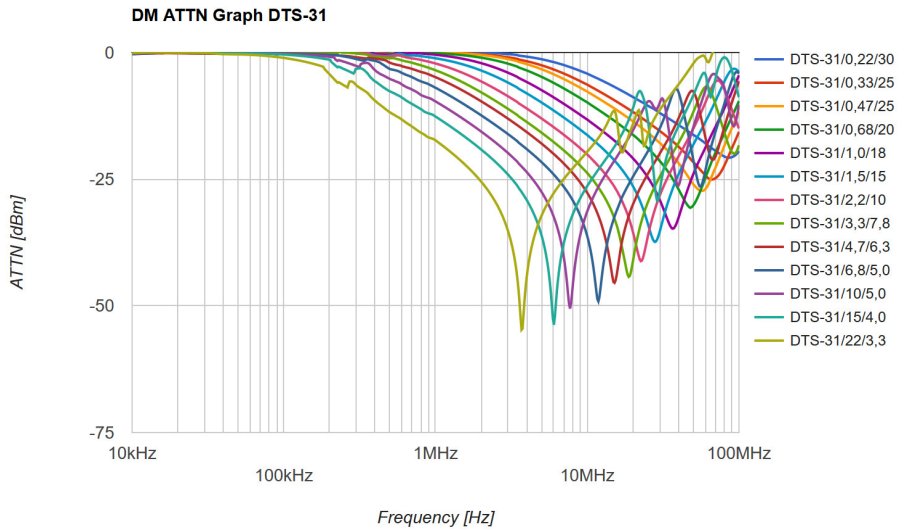



## X-ON Electronics

Largest Supplier of Electrical and Electronic Components

*Click to view similar products for [Fixed Inductors](#) category:*

*Click to view products by [Feryster](#) manufacturer:*

Other Similar products are found below :

[MLZ1608M6R8WTD25](#) [MLZ1608N6R8LT000](#) [MLZ1608N3R3LTD25](#) [MLZ1608N3R3LT000](#) [MLZ1608N150LT000](#)

[MLZ1608M150WTD25](#) [MLZ1608M3R3WTD25](#) [MLZ1608M3R3WT000](#) [MLZ1608M150WT000](#) [MLZ1608A1R5WT000](#)

[MLZ1608N1R5LT000](#) [B82432C1333K000](#) [PCMB053T-1R0MS](#) [PCMB053T-1R5MS](#) [PCMB104T-1R5MS](#) [CR32NP-100KC](#) [CR32NP-](#)

[151KC](#) [CR32NP-180KC](#) [CR32NP-181KC](#) [CR32NP-1R5MC](#) [CR32NP-390KC](#) [CR32NP-3R9MC](#) [CR32NP-680KC](#) [CR32NP-820KC](#)

[CR32NP-8R2MC](#) [CR43NP-390KC](#) [CR43NP-560KC](#) [CR43NP-680KC](#) [CR54NP-181KC](#) [CR54NP-470LC](#) [CR54NP-820KC](#) [CR54NP-8R5MC](#)

[MGDQ4-00004-P](#) [MGDU1-00016-P](#) [MHL1ECTTP18NJ](#) [MHL1JCTTD12NJ](#) [PE-51506NL](#) [PE-53601NL](#) [PE-53630NL](#) [PE-53824SNLT](#) [PE-](#)

[62892NL](#) [PE-92100NL](#) [PG0434.801NLT](#) [PG0936.113NLT](#) [PM06-2N7](#) [PM06-39NJ](#) [HC2LP-R47-R](#) [HC2-R47-R](#) [HC3-2R2-R](#) [HC8-1R2-R](#)