



**Multitite FCE black:
Flexible and extra robust.**

Type FCE is mainly used in the apparatus- and machine building industry where tight bending diameters are involved and medium to high mechanical protection is needed. In combination with the IP 65 and IP 68 fittings a complete liquid-tightness can be achieved. Type FCE is delivered on convenient reels (card board reels with stamped metal core).

Classification according NEN-EN-IEC 61386:

Compression resistance: Class 4, Heavy (1250 N).

Impact resistance: Class 4, Heavy (6 J).

Tensile strength: Class 4, Heavy (1000 N).

Protection class: IP 67 (dust-proof, water-tight).

Material & Construction:

Construction: Galvanised steel core, square-locked with thin wall convoluted thermoplastic (PVC compound) cover. Type FCE is made out of thicker and higher performance strip gauge compared with FCD.

Cover specifications: PVC, lead-free according to RoHS.

Temperature: -20 °C to +80 °C, intermittent up to +90 °C.

Colour : Black (on request grey is also available).



Square locked

FCE	Diametre		Bending radius (CL)		Small reel		Standard reel		Large reel		Weight
	Size	Inside	Outside	Static	Dynamic	Metre	Article No.	Metre	Article No.	Metre	
DN	(mm)	(mm)	(mm)	(mm)		Black		Black		Black	
10	7,0	10,0	30	40	-	-	25	371.010.2	50	371.010.5	0,10
12	10,0	14,0	37	50	-	-	25	371.012.2	50	371.012.5	0,18
16	13,0	17,0	45	60	10	371.016.1	25	371.016.2	50	371.016.5	0,23
18	-	-	-	-	-	-	-	-	-	-	-
20	17,0	21,5	55	80	10	371.020.1	25	371.020.2	50	371.020.5	0,30
25	21,2	26,0	70	100	10	371.025.1	25	371.025.2	50	371.025.5	0,39
32	28,1	34,0	95	125	10	371.032.1	25	371.032.2	-	-	0,52
40	37,7	45,0	115	160	10	371.040.1	25	371.040.2	-	-	0,75
50	48,4	56,0	135	190	10	371.050.1	25	371.050.2	-	-	1,10

* Special reel quantities on request.

The fittings for Multitite FCE are outlined on pages 2-07 till 2-15.



Size Multitite	DN	10	12	16	18	20	25	32	40	50	-	-	-
Fittings	ISO	M10 / M12	M12 / M16	M16 / M20	M20	M20	M25	M32	M40	M50 / M63	-	-	-
	PG	7	9	11 / 13,5	13,5	16	21	29	36	48	-	-	-
	NPT	-	-	1/2"	-	1/2"	3/4"	1"	-	-	-	-	-



Anaconda IP 54 nickel plated brass fittings for Multitite FCD and FCE.

These nickel plated brass Anaconda fittings are standard fittings which can be used with Anaconda Multitite type FCD and FCE. The 2-piece Anaconda fittings are universal fittings and offer great corrosion protection in combination with a slim appearance.

Material & Construction:

Construction: Nickel plated brass fitting, consisting of 2 parts (body and cap).

Material: Body and cap are nickel plated brass.

Temperature: -55 °C till +260 °C continuous.

Protection class: IP 54.

Colour: Metal.

**ANACONDA
MULTITITE**

**FITTINGS FOR
MULTITITE
IP 54**

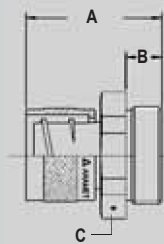

ISO straight fitting, fixed, male, nickel plated brass.



Thread	FCD / FCE ISO	Min. Internal Size (DN) Bore (mm)	Dimensions in mm					Standard Package	Article Number	Weight (Kg/100)
			A	B	C	D	E			
M10 x 1,0	10	5,5	24	8	14	-	-	10	260.110.0	1,3
M12 x 1,5	10	5,5	24	8	14	-	-	10	260.111.0	1,4
M12 x 1,5	12	8,5	26	10	18	-	-	10	260.112.0	1,8
M16 x 1,5	12	8,5	26	10	18	-	-	10	260.115.0	2,0
M16 x 1,5	16	11,2	27	10	20	-	-	10	260.116.0	2,3
M20 x 1,5	16	11,2	27	10	22	-	-	10	260.117.0	2,6
M20 x 1,5	18	13,2	27	10	24	-	-	10	260.118.0	2,7
M20 x 1,5	20	15,2	27	10	24	-	-	10	260.120.0	3,0
M25 x 1,5	25	19,2	32	12	30	-	-	5	260.125.0	5,4
M32 x 1,5	32	25,9	35	13	38	-	-	5	260.132.0	8,1
M40 x 1,5	40	34,8	41	14	48	-	-	2	260.140.0	15,0
M50 x 1,5	50	44,8	45	15	60	-	-	2	260.150.0	22,4
M63 x 1,5	50	44,8	46	16	70	-	-	2	260.160.0	28,6

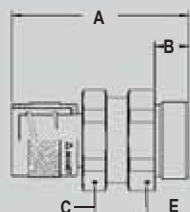

ISO straight fitting, swivel, male, nickel plated brass.



Thread	FCD / FCE ISO	Min. Internal Size (DN) Bore (mm)	Dimensions in mm					Standard Package	Article Number	Weight (Kg/100)
			A	B	C	D	E			
M10 x 1,0	10	5,5	30	8	14	-	14	10	261.110.0	1,7
M12 x 1,5	10	5,5	30	8	14	-	14	10	261.111.0	1,9
M12 x 1,5	12	8,5	34	10	18	-	18	10	261.112.0	2,4
M16 x 1,5	12	8,5	34	10	18	-	18	10	261.115.0	3,1
M16 x 1,5	16	11,2	36	10	20	-	20	10	261.116.0	3,9
M20 x 1,5	16	11,2	36	10	20	-	22	10	261.117.0	4,2
M20 x 1,5	18	13,2	37	10	24	-	24	10	261.118.0	4,4
M20 x 1,5	20	15,2	37	10	24	-	24	10	261.120.0	4,9
M25 x 1,5	25	19,2	43	12	30	-	30	5	261.125.0	8,8
M32 x 1,5	32	25,9	47	13	38	-	38	5	261.132.0	13,3
M40 x 1,5	40	34,8	56	14	48	-	48	2	261.140.0	25,1
M50 x 1,5	50	44,8	60	15	60	-	60	2	261.150.0	36,7
M63 x 1,5	50	44,8	61	16	60	-	70	2	261.160.0	47,1

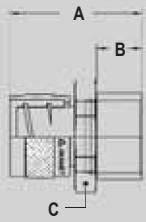

ISO straight fitting, fixed, female, nickel plated brass.



Thread	FCD / FCE Size (DN)	Min. Internal Bore (mm)	Dimensions in mm					Standard Package	Article Number	Weight (Kg/100)
			A	B	C	D	E			
M16 x 1,5	16	11,2	29	13	20	-	-	10	260.316.0	2,4
M20 x 1,5	16	11,2	30	13	24	-	-	10	260.317.0	3,0
M20 x 1,5	20	15,2	30	13	24	-	-	10	260.320.0	3,2
M25 x 1,5	25	19,2	34	15	30	-	-	5	260.325.0	5,9
M32 x 1,5	32	25,9	39	16	38	-	-	5	260.332.0	8,5
M40 x 1,5	40	34,8	43	16	48	-	-	2	260.340.0	16,6
M50 x 1,5	50	44,8	47	17	60	-	-	2	260.350.0	24,5

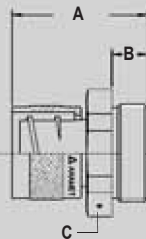

Pg straight fitting, fixed, male, nickel plated brass.



Thread Pg	FCD / FCE Size (DN)	Min. Internal Bore (mm)	Dimensions in mm					Standard Package	Article Number	Weight (Kg/100)
			A	B	C	D	E			
Pg 7	10	5,5	24	8	14	-	-	10	260.207.0	1,3
Pg 9	12	8,5	26	10	18	-	-	10	260.209.0	1,9
Pg 11	16	11,2	27	10	20	-	-	10	260.211.0	2,4
Pg 13,5	18	13,2	27	10	24	-	-	10	260.213.0	3,0
Pg 16	20	15,2	27	10	24	-	-	10	260.216.0	3,2
Pg 21	25	19,2	32	12	30	-	-	5	260.221.0	5,5
Pg 29	32	25,9	35	13	38	-	-	5	260.229.0	8,9
Pg 36	40	34,8	41	14	50	-	-	2	260.236.0	19,0
Pg 48	50	44,8	45	16	65	-	-	2	260.248.0	25,3

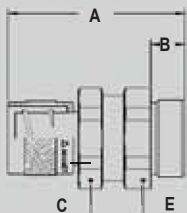

Pg straight fitting, swivel, male, nickel plated brass.



Thread Pg	FCD / FCE Size (DN)	Min. Internal Bore (mm)	Dimensions in mm					Standard Package	Article Number	Weight (Kg/100)
			A	B	C	D	E			
Pg 7	10	5,5	30	8	14	-	14	10	261.207.0	1,8
Pg 9	12	8,5	34	10	18	-	18	10	261.209.0	3,0
Pg 11	16	11,2	36	10	20	-	20	10	261.211.0	4,0
Pg 13,5	18	13,2	36	10	24	-	24	10	261.213.0	4,6
Pg 16	20	15,2	37	10	24	-	24	10	261.216.0	5,2
Pg 21	25	19,2	43	12	30	-	30	5	261.221.0	9,2
Pg 29	32	25,9	47	13	38	-	40	5	261.229.0	14,6
Pg 36	40	34,8	56	14	48	-	50	2	261.236.0	27,3
Pg 48	50	44,8	61	16	60	-	65	2	261.248.0	43,8

**ANACONDA
MULTITITE**

**FITTINGS FOR
MULTITITE
IP 54**

Box connector, fixed, nickel plated brass.

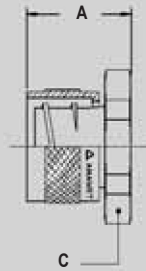

Thread	FCD / FCE	Min. Internal Bore (mm)	Dimensions in mm					Standard Package	Article Number	Weight (Kg/100)
	Size (DN)		A	B	C	D	E			
-	10	5,5	16	-	14	-	-	10	262.210.0	1,0
-	12	8,5	16	-	18	-	-	10	262.212.0	1,4
-	16	11,2	17	-	20	-	-	10	262.216.0	1,7
-	18	13,2	17	-	24	-	-	10	262.218.0	2,1
-	20	15,2	17	-	24	-	-	10	262.220.0	2,5
-	25	19,2	20	-	30	-	-	5	262.225.0	4,0
-	32	25,9	22	-	38	-	-	5	262.232.0	6,1
-	40	34,8	27	-	48	-	-	2	262.240.0	11,6
-	50	44,8	30	-	60	-	-	2	260.250.0	18,0

End cap, nickel plated brass.

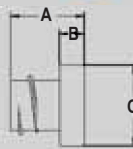

Thread	FCD / FCE	Min. Internal Bore (mm)	Dimensions in mm					Standard Package	Article Number	Weight (Kg/100)
	Size (mm)		A	B	C	D	E			
-	10	5,5	18	6	13	-	-	10	264.110.0	0,4
-	12	8,5	18	6	17	-	-	10	264.112.0	0,4
-	16	11,2	18	6	20	-	-	10	264.116.0	0,8
-	18	12,6	19	6	22	-	-	10	264.118.0	1,0
-	20	15,2	19	6	24	-	-	10	264.120.0	1,2
-	25	19,2	21	7	30	-	-	5	264.125.0	1,8
-	32	25,9	22	8	38	-	-	5	264.132.0	2,9
-	40	34,8	24	8	49	-	-	2	264.140.0	5,2
-	50	44,8	25	8	60	-	-	2	264.150.0	7,6

90° elbow, ISO, inside / outside thread, nickel plated brass.

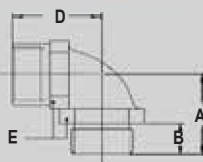

Outside Thread	Inside Thread	Min. Internal Bore (mm)	Dimensions in mm					Standard Package	Article Number	Weight (Kg/100)
			A	B	C	D	E			
M16 x 1,5	M16 x 1,5	-	26	10	-	24	22	10	783.016.0	6,0
M20 x 1,5	M20 x 1,5	-	26	10	-	25	24	10	783.020.0	10,0
M25 x 1,5	M25 x 1,5	-	32	10	-	34	33	5	783.025.0	16,0
M32 x 1,5	M32 x 1,5	-	40	12	-	40	42	5	783.032.0	26,0



Anaconda IP 65 nickel plated brass fittings for FCD & FCE.



The nickel plated brass Anaconda IP 65 fittings can be used with Anaconda FCD and FCE conduits. This Anaconda fitting offers besides a good corrosion protection also a higher degree of protection, IP 65, and a nice appearance. Because the design is universal up to 1", all types of Anaconda fittings are possible in this range.

Material & Construction:

Construction: Nickel plated brass fitting, consisting of 4 parts (counter nut, clamping ring, ferrule and body).

Material: Counter nut and body are nickel plated brass. Ferrule is from passivated brass and clamping ring is from PA6.

Temperature: -45 °C till +105 °C continuous, (cable-hose-fittings are -40 °C till +100 °C).

Protection class: IP 65.

Colour: Metal.

ISO straight fitting, compact, male, nickel plated brass (including connection set)

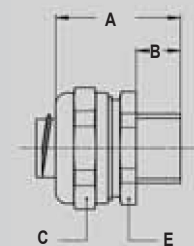

Thread	FCD / FCE Size (DN)	Min. Internal Bore (mm)	Dimensions in mm					Standard Package	Article Number	Weight (Kg/100)
			A	B	C	D	E			
M16 x 1,5	12	8,3	30	10	26	-	24	10	712.015.4	4,2
M20 x 1,5	12	8,3	30	10	26	-	24	10	712.014.4	4,4
M16 x 1,5	16	11,2	30	10	26	-	24	10	712.016.4	4,2
M20 x 1,5	16	11,2	30	10	26	-	24	10	712.017.4	4,4
M20 x 1,5	20	15,2	32	10	29	-	27	10	712.020.4	5,0
M25 x 1,5	25	19,2	33	10	35	-	33	5	712.025.4	7,4
M32 x 1,5	32	25,9	36	12	45	-	44	5	712.032.4	13,9

ISO 90° fitting, compact, male, nickel plated brass (including connection set)

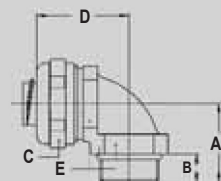

Thread	FCD / FCE Size (DN)	Min. Internal Bore (mm)	Dimensions in mm					Standard Package	Article Number	Weight (Kg/100)
			A	B	C	D	E			
M16 x 1,5	12	8,3	26	10	26	31	22	10	712.915.4	7,0
M20 x 1,5	12	8,3	26	10	26	32	24	10	712.914.4	7,2
M16 x 1,5	16	11,2	26	10	26	31	22	10	712.916.4	7,0
M20 x 1,5	16	11,2	26	10	26	32	24	10	712.917.4	7,2
M20 x 1,5	20	15,2	28	10	29	34	27	10	712.920.4	8,4
M25 x 1,5	25	19,2	32	10	35	40	33	5	712.925.4	17,5
M32 x 1,5	32	25,9	40	12	45	49	42	5	712.932.4	29,4

ANACONDA
MULTITITE

LIQUID-TIGHT
FITTINGS FOR
MULTITITE
IP 65

ISO straight swivel fitting, male, nickel plated brass (including connection set)

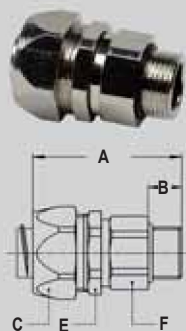

Thread	FCD / FCE ISO Size (DN)	Min. Internal Bore (mm)	Dimensions in mm					Standard Package	Article Number	Weight (Kg/100)
			A	B	C	E	F			
M16 x 1,5	12	8,3	48	10	26	24	21	10	813.015.4	8,1
M16 x 1,5	16	10,7	48	10	26	24	21	10	813.016.4	8,1
M20 x 1,5	20	13,9	49	10	29	27	25	10	813.020.4	10,2
M25 x 1,5	25	17,4	49	10	35	33	31	5	813.025.4	13,8
M32 x 1,5	32	23,4	55	12	45	42	38	5	813.032.4	32,5

ISO 90° swivel fitting, male, nickel plated brass (including connection set)

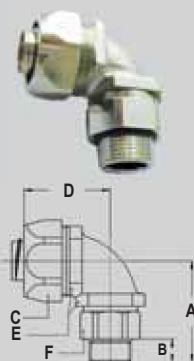

Thread	FCD / FCE ISO Size (mm)	Min. Internal Bore (mm)	Dimensions in mm						Standard Package	Article Number	Weight (Kg/100)
			A	B	C	D	E	F			
M16 x 1,5	12	8,3	39	10	26	35	22	21	10	813.915.4	10,8
M16 x 1,5	16	10,7	39	10	26	35	22	21	10	813.916.4	10,8
M20 x 1,5	20	13,9	39	10	29	37	27	25	10	813.920.4	13,2
M25 x 1,5	25	17,4	46	10	35	44	33	31	5	813.925.4	22,8
M32 x 1,5	32	23,4	55	12	45	55	42	38	5	813.932.4	41,4

ISO cable-hose fitting, male, nickel plated brass (including connection set).

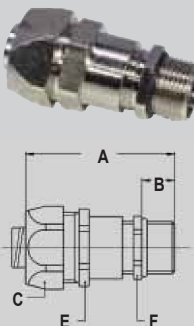

Thread	FCD / FCE ISO Size (DN)	Clamping Range (mm)	Dimensions in mm					Standard Package	Article Number	Weight (Kg/100)
			A	B	C	E	F			
M16 x 1,5	16	3 - 10	64	12	26	24	20	10	812.716.4	8,2
M20 x 1,5	16	6 - 11	57	12	26	24	22	10	812.717.4	9,5
M20 x 1,5	20	7 - 14	64	12	29	27	24	10	812.720.4	10,2
M25 x 1,5	20	10 - 14	62	12	29	27	27	10	812.722.4	11,7
M25 x 1,5	25	9 - 18	77	15	35	33	30	5	812.725.4	17,0
M32 x 1,5	25	13 - 18	70	15	35	33	34	5	812.728.4	19,6
M32 x 1,5	32	13 - 25	88	15	45	43	40	5	812.732.4	31,0

Pg straight fitting, compact, male, nickel plated brass (including connection set)

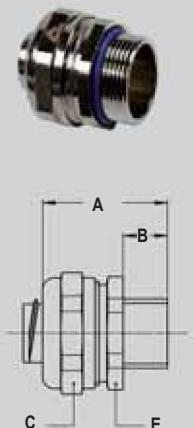

Thread	FCD / FCE Pg Size (DN)	Min. Internal Bore (mm)	Dimensions in mm					Standard Package	Article Number	Weight (Kg/100)
			A	B	C	D	E			
Pg 11	16	11,2	30	10	26	-	24	10	710.011.4	4,2
Pg 13,5	16	11,2	30	10	26	-	24	10	710.013.4	4,4
Pg 16	20	15,2	32	10	29	-	27	10	710.016.4	5,0
Pg 21	25	19,2	33	10	35	-	33	5	710.021.4	7,4
Pg 29	32	25,9	36	12	45	-	44	5	710.029.4	13,9

ANACONDA
MULTITITE

LIQUID-TIGHT
FITTINGS FOR
MULTITITE
IP 65

**Pg 90° fitting, compact, male, nickel plated brass
(including connection set)**

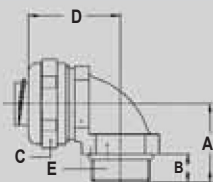

Thread Pg	FCD / FCE Size (DN)	Min. Internal Bore (mm)	Dimensions in mm					Standard Package	Article Number	Weight (Kg/100)
			A	B	C	D	E			
Pg 11	16	11,2	26	10	26	32	24	10	710.911.4	7,0
Pg 13,5	16	11,2	26	10	26	32	24	10	710.913.4	7,2
Pg 16	20	15,2	28	10	29	34	27	10	710.916.4	8,4
Pg 21	25	19,2	32	10	35	40	33	5	710.921.4	17,5
Pg 29	32	25,9	40	12	45	49	42	5	710.929.4	29,4

**NPT straight fitting, compact, male, nickel plated brass
(including connection set)**

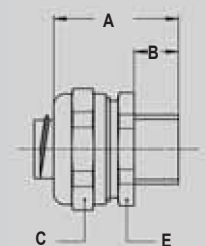

Thread NPT	FCD / FCE Size (mm)	Min. Internal Bore (mm)	Dimensions in mm					Standard Package	Article Number	Weight (Kg/100)
			A	B	C	D	E			
NPT 1/2"	16	11,2	32	12	26	-	24	10	714.012.4	4,6
NPT 1/2"	20	15,2	34	12	29	-	27	10	714.016.4	5,4
NPT 3/4"	25	19,2	35	12	35	-	33	5	714.020.4	7,8
NPT 1"	32	25,9	37	13	45	-	44	5	714.026.4	14,2

**NPT 90° swivel fitting, male, nickel plated
brass (including connection set)**

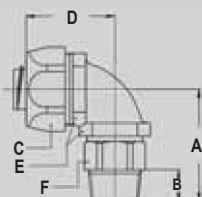

Thread NPT	FCD / FCE Size (mm)	Min. Internal Bore (mm)	Dimensions in mm						Standard Package	Article Number	Weight (Kg/100)
			A	B	C	D	E	F			
NPT 1/2"	16	10,7	41	12	26	35	22	22	10	819.912.4	12,0
NPT 1/2"	20	13,9	41	12	29	37	27	25	10	819.916.4	14,0
NPT 3/4"	25	17,4	48	12	35	44	33	31	5	819.920.4	23,5
NPT 1"	32	23,4	56	13	45	55	42	38	5	819.926.4	42,0

**Conduit connector, nickel plated brass
(including connection set)**

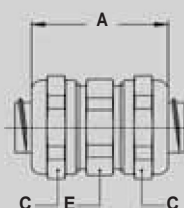

Thread	FCD / FCE Size (mm)	Min. Internal Bore (mm)	Dimensions in mm					Standard Package	Article Number	Weight (Kg/100)
			A	B	C	D	E			
-	12	8,3	41	-	26	-	24	10	784.010.4	7,4
-	16	11,2	41	-	26	-	24	10	784.012.4	7,4
-	20	15,2	45	-	29	-	27	10	784.016.4	8,8
-	25	19,2	48	-	35	-	33	5	784.020.4	13,0
-	32	25,9	53	-	45	-	44	5	784.026.4	25,2

**ANACONDA
MULTITITE**

**LIQUID-TIGHT
FITTINGS FOR
MULTITITE
IP 65**



**ANACONDA
MULTITITE**

**LIQUID-TIGHT
FITTINGS FOR
MULTITITE
IP 68**



Anaconda IP 68 nickel plated brass fittings for FCD & FCE.

The nickel plated brass Anaconda IP 68 fittings can be used with Anaconda FCD and FCE conduits. This Anaconda fitting offers besides a good corrosion protection also a high degree of protection, IP 68, and a nice appearance. Because the design is universal up to 1" all types of Anaconda fittings are possible in this range.



Material & Construction:

Construction: Nickel plated brass fitting, consisting of 5 parts (counter nut, filler ring, sealing sleeve, ferrule and body).

Material: Counter nut, filler ring, ferrule and body are nickel plated brass. Sealing sleeve is NBR-rubber.

Temperature: -45 °C till +105 °C continuous, (cable-hose-fittings are -40 °C till +100 °C).

Protection class: IP 68 (dust-proof, water-tight).

Swivel fittings are limited to IP 67.

Colour: Metal.

ISO straight fitting, compact, male, nickel plated brass (including connection set)

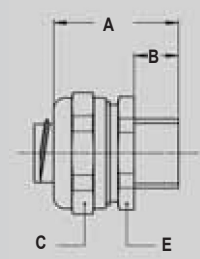

Thread	FCD / FCE	Min. Internal	Dimensions in mm					Standard	Article	Weight
			ISO	Size (DN)	Bore (mm)	A	B			
M12 x 1,5	12	8,5	31	10	22	-	20	10	812.012.5	3,8
M16 x 1,5	16	11,2	30	10	26	-	24	10	712.016.5	4,2
M20 x 1,5	16	11,2	30	10	26	-	24	10	712.017.5	4,4
M20 x 1,5	20	15,2	32	10	29	-	27	10	712.020.5	5,0
M25 x 1,5	25	19,2	33	10	35	-	33	5	712.025.5	7,4
M32 x 1,5	32	25,9	36	12	45	-	44	5	712.032.5	13,9
M40 x 1,5	40	34,5	45	14	59	-	55	2	812.040.5	18,8

ISO straight swivel fitting, male, nickel plated brass, IP 67 (including connection set)

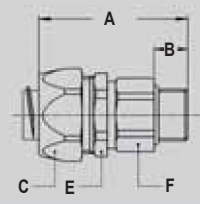

Thread	FCD / FCE	Min. Internal	Dimensions in mm					Standard	Article	Weight
			ISO	Size (DN)	Bore (mm)	A	B			
M16 x 1,5	16	10,7	48	10	26	24	21	10	813.016.5	8,1
M20 x 1,5	20	13,9	49	10	29	27	25	10	813.020.5	10,2
M25 x 1,5	25	17,4	49	10	35	33	31	5	813.025.5	13,8
M32 x 1,5	32	23,4	55	12	45	42	38	5	813.032.5	32,5

**ISO 90° fitting, compact, male, nickel plated brass
(including connection set)**

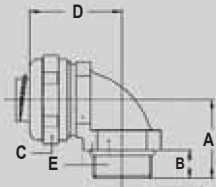

Thread	FCD / FCE	Min. Internal Bore (mm)	Dimensions in mm					Standard Package	Article Number	Weight (Kg/100)
			A	B	C	D	E			
M16 x 1,5	16	11,2	26	10	26	31	22	10	712.916.5	7,0
M20 x 1,5	16	11,2	26	10	26	32	24	10	712.917.5	7,2
M20 x 1,5	20	15,2	28	10	29	34	27	10	712.920.5	8,4
M25 x 1,5	25	19,2	32	10	35	40	33	5	712.925.5	17,5
M32 x 1,5	32	25,9	40	12	45	49	42	5	712.932.5	29,4

ISO 90° swivel fitting, male, nickel plated brass IP 67 (including connection set)

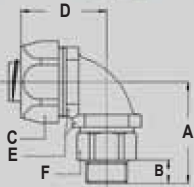

Thread	FCD / FCE	Min. Internal Bore (mm)	Dimensions in mm						Standard Package	Article Number	Weight (Kg/100)
			A	B	C	D	E	F			
M16 x 1,5	16	10,7	39	10	26	35	22	21	10	813.916.5	10,8
M20 x 1,5	20	13,9	39	10	29	37	27	25	10	813.920.5	13,2
M25 x 1,5	25	17,4	46	10	35	44	33	31	5	813.925.5	22,8
M32 x 1,5	32	23,4	55	12	45	55	42	38	5	813.932.5	41,4

ISO cable-hose fitting, male, nickel plated brass (including connection set).

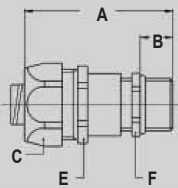

Thread	FCD / FCE	Clamping Range (mm)	Dimensions in mm					Standard Package	Article Number	Weight (Kg/100)
			A	B	C	E	F			
M16 x 1,5	16	3 - 10	64	12	26	24	20	10	812.716.5	8,2
M20 x 1,5	16	6 - 11	57	12	26	24	22	10	812.717.5	9,5
M20 x 1,5	20	7 - 14	64	12	29	27	24	10	812.720.5	10,2
M25 x 1,5	20	10 - 14	62	12	29	27	27	10	812.722.5	11,7
M25 x 1,5	25	9 - 18	77	15	35	33	30	5	812.725.5	17,0
M32 x 1,5	25	13 - 18	70	15	35	33	34	5	812.728.5	19,6
M32 x 1,5	32	13 - 25	88	15	45	43	40	5	812.732.5	31,0

ISO straight fitting, female, nickel plated brass (including connection set).

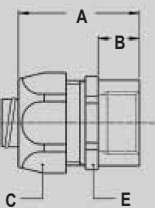

Thread	FCD / FCE	Min. Internal Bore (mm)	Dimensions in mm					Standard Package	Article Number	Weight (Kg/100)
			A	B	C	D	E			
M16 x 1,5	16	11,2	35	12	26	-	24	10	812.316.5	5,0
M20 x 1,5	20	15,2	37	13	29	-	27	10	812.320.5	7,6
M25 x 1,5	25	19,2	40	15	35	-	33	5	812.325.5	9,0
M32 x 1,5	32	25,9	46	15	45	-	43	5	812.332.5	18,3

**ANACONDA
MULTITITE**

**LIQUID-TIGHT
FITTINGS FOR
MULTITITE
IP 68**

**Pg straight fitting, compact, male, nickel plated brass
(including connection set)**

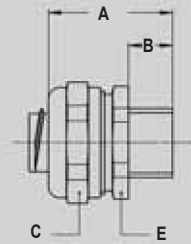

Thread Pg	FCD / FCE Size (DN)	Min. Internal Bore (mm)	Dimensions in mm					Standard Package	Article Number	Weight (Kg/100)
			A	B	C	D	E			
Pg 11	16	11,2	30	10	26	-	24	10	710.011.5	4,2
Pg 13,5	16	11,2	30	10	26	-	24	10	710.013.5	4,4
Pg 16	20	15,2	32	10	29	-	27	10	710.016.5	5,0
Pg 21	25	19,2	33	10	35	-	33	5	710.021.5	7,4
Pg 29	32	25,9	36	12	45	-	44	5	710.029.5	13,9

**Pg 90° fitting, compact, male, nickel plated brass
(including connection set)**

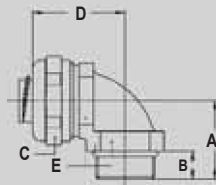

Thread Pg	FCD / FCE Size (mm)	Min. Internal Bore (mm)	Dimensions in mm					Standard Package	Article Number	Weight (Kg/100)
			A	B	C	D	E			
Pg 11	16	11,2	26	10	26	32	24	10	710.911.5	7,0
Pg 13,5	16	11,2	26	10	26	32	24	10	710.913.5	7,2
Pg 16	20	15,2	28	10	29	34	27	10	710.916.5	8,4
Pg 21	25	19,2	32	10	35	40	33	5	710.921.5	17,5
Pg 29	32	25,9	40	12	45	49	42	5	710.929.5	29,4

**Pg straight fitting, female, nickel plated brass
(including connection set).**

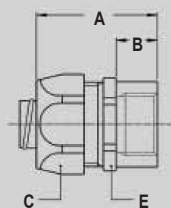

Thread Pg	FCD / FCE Size (mm)	Min. Internal Bore (mm)	Dimensions in mm					Standard Package	Article Number	Weight (Kg/100)
			A	B	C	D	E			
Pg 11	16	11,2	35	12	26	-	24	10	810.311.5	5,3
Pg 13,5	16	11,2	35	12	26	-	24	10	810.313.5	5,3
Pg 16	20	15,2	37	13	29	-	27	10	810.316.5	6,3
Pg 21	25	19,2	40	15	35	-	33	5	810.321.5	9,3
Pg 29	32	25,9	46	15	45	-	43	5	810.329.5	20,7

**Conduit connector, nickel plated brass
(including connection set)**

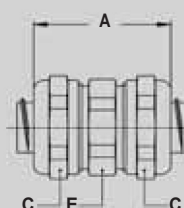

Thread	FCD / FCE Size (mm)	Min. Internal Bore (mm)	Dimensions in mm					Standard Package	Article Number	Weight (Kg/100)
			A	B	C	D	E			
-	16	11,2	41	-	26	-	24	10	784.012.5	7,4
-	20	15,2	45	-	29	-	27	10	784.016.5	8,8
-	25	19,2	48	-	35	-	33	5	784.020.5	13,0
-	32	25,9	53	-	45	-	44	5	784.026.5	25,2

**ANACONDA
MULTITITE**

**LIQUID-TIGHT
FITTINGS FOR
MULTITITE
IP 68**

X-ON Electronics

Largest Supplier of Electrical and Electronic Components

Click to view similar products for [Non-Heat Shrink Tubing and Sleeves](#) category:

Click to view products by [ANAMET EUROPE](#) manufacturer:

Other Similar products are found below :

[CTA-0053](#) [8429-9](#) [8445-7.5](#) [8450](#) [120-116-1-1-09BE](#) [120-116-1-1-09BF](#) [120-116-1-1-09BP](#) [120-116-1-1-12BE](#) [120-116-1-1-12BP](#) [120-123-06](#) [120-123-10](#) [120-125-12BL](#) [120-125-12R](#) [120-125-20R](#) [120-126-09](#) [120-126-09BL](#) [120-126-12](#) [120-126-12BL](#) [120-126-52](#) [120-126-52BL](#) [120-104-12](#) [120-105-1-1-06BE](#) [120-105-1-1-06CE](#) [120-116-1-1-06BP](#) [120-116-1-1-10BP](#) [120-116-1-1-12BF](#) [120-123-12](#) [120-125-09](#) [120-125-12](#) [120-125-12Y](#) [120-125-52BL](#) [120-S002-12](#) [HC1B-7008-0375-0](#) [120-S001-09](#) [120-S002-09](#) [121-101-1-1-56BFC](#) [121-101-1-1-64BFC](#) [RAY-90-3.0\(100\)](#) [20675-2](#) [8S42-100FR-CS8184](#) [SAS-115-1-1048-1X](#) [SAS-160-1-1048-1X](#) [25T-GB](#) [RAY-103-10.0\(100\)](#) [RAY-103-4.0\(100\)](#) [4627-S](#) [3-1991136-0](#) [561-SL1000NYGY](#) [561-SL1000PP](#) [561-SL250FRPP](#)