



# Inductive proximity sensors

## IH 34 series, sensing range 30 mm

### AC / DC 2-wire, plastic housing

Dimensions in mm

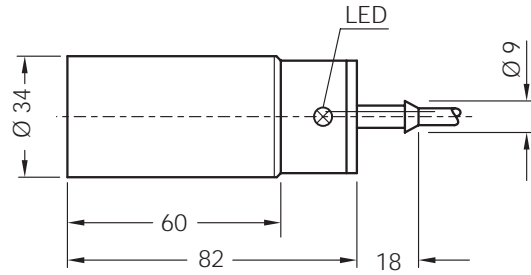

#### Features



- ▶ Can be installed non-flush in metal
- ▶ Enhanced sensing range
- ▶ Broad operating voltage range in AC and DC
- ▶ Normally open/ normally closed function
- ▶ Plastic housing
- ▶ Enclosure rating IP 67
- ▶ LED status indicator

#### Accessories

- ▶ Mounting clamps incl.

#### Connection diagram

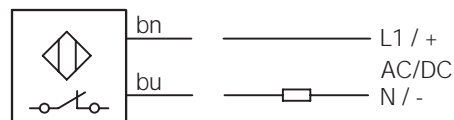
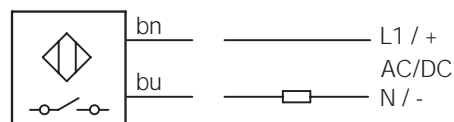

Wire colour	Assignment
bn brown	L1 / +
bu blue	N / -

## Electrical and mechanical data

<b>Operating voltage</b> $U_b$	20 ... 250 V AC / DC	<b>Wire-break protection</b>	-
<b>Voltage drop</b> $U_d$ (at $I_a$ max.)	$\leq 6.5$ V AC / $\leq 6$ V DC	<b>Short-circuit protection (pulsed)</b>	-
<b>Continuous current</b> $I_a$	$\leq 350$ mA AC (... + 50 °C) $\leq 250$ mA AC (... + 80 °C) $\leq 100$ mA DC	<b>Reverse polarity protection</b>	-
<b>Peak current</b> $I_k$	2.2 A (20ms / 0.5 Hz)	<b>Power-up pulse suppression</b>	yes
<b>Min. load current</b>	5 mA	<b>Enclosure rating</b> to EN 60529	IP 67
<b>Residual current</b>	$\leq 2.5$ mA (250 V AC) $\leq 1.3$ mA (110 V AC) $\leq 0.8$ mA (24 V DC)	<b>Protection class</b>	□
<b>Time delay before availability</b> $t_v$ (with $s_n$ 20 / 30 mm)	approx. 8 / 50 ms	<b>Shock and vibration stress</b>	30 g, 11 ms 10 to 55 Hz, 1 mm
<b>Hysteresis</b> H	1% - 15% of $s_r$	<b>Ambient temperature</b> $T_a$	- 25 ... + 80 °C
<b>Repeatability</b> R ( $U_b$ and $T_a$ constant)	$\leq 10\%$ of $s_r$	<b>Housing material</b>	Plastic
<b>Temperature drift</b>	$\pm 10\%$ of $s_r$	<b>Connection cable</b>	PUR-PVC, 2 x 0.5 mm <sup>2</sup>
<b>EMC</b>	to EN 60 947-5-2		

## Selection table

Sensing range $s_n$ mm	Installation in metal	Output function	Switching frequency $f$ in Hz	Connection	Type	Order number
30			7	Cable 2 m	IH34-30NUS-KU0	7902134
30			7	Cable 2 m	IH34-30NUO-KU0	7902135

## X-ON Electronics

Largest Supplier of Electrical and Electronic Components

*Click to view similar products for [Proximity Sensors](#) category:*

*Click to view products by [Sick](#) manufacturer:*

Other Similar products are found below :

[01.001.5653.1](#) [70.340.1028.0](#) [70.360.2428.0](#) [70.364.4828.0](#) [70.810.1053.0](#) [72.360.1628.0](#) [73.363.6428.0](#) [980659-1](#) [QT-12](#)  
[E2ECQC2D1M1GJT03M](#) [E2EX10D1NN](#) [E2E-X14MD1-G](#) [E2E-X2D1-G](#) [E2EX2ME2N](#) [E2E-X3D1-N](#) [10M](#) [E2E-X4MD1-G](#)  
[E2FMX1R5D12M](#) [E2K-F10MC1](#) [5M](#) [EC3016PPASL-1](#) [EI1204TBOSL-6](#) [EI5515NPAP](#) [BSA-08-25-08](#) [IC08ANC15PO-K](#) [25.161.3253.0](#)  
[25.332.0653.1](#) [25.352.0653.0](#) [25.352.0753.0](#) [25.523.3253.0](#) [922FS1.5C-A4P-Z774](#) [SC606ABV0S30](#) [SM552A100](#) [SM952A126100LE](#)  
[SM956A132600](#) [A1220EUA-T](#) [F3S-A162-U](#) [CL18](#) [QT-08L](#) [34.110.0010.0](#) [TL-C2MF1-M3-E4](#) [IA08BLF15NOM5](#) [IA08BSF15NOM5](#)  
[IA12ASF04DOM1](#) [IS2](#) [IS31SE5000-UTLS2-TR](#) [34.110.0021.0](#) [34.110.0022.0](#) [CA150-120VACDC](#) [VM18VA3000Q](#) [XS508BSCBL2](#)  
[XS512BLNAM12](#)