

Inductive proximity switches are contact-free sensors. They detect all conductive metals, regardless of whether they move or not. The achievable sensing range of the devices depends on the object material and its dimensions. The vibration-resistant sensors can be approached laterally or frontally. Inductive proximity switches are used for presence detection (e.g. goods carriers), positioning (e.g. dampers), counting (e.g. nuts /bolts), speed detection (e.g. for cog wheels), on conveyor systems (e.g. hose feedings) or distance measurements (e.g. press-in checking) of metallic objects.

TECHNICAL DATA

Devices for hose mounting	NO
Feeding technology	NO
Hygienic and wet area	NO
Metallic sensor surface	NO
Oil and lubricating coolants	NO
Ring-shaped sensors	NO
Rough ambient conditions	NO
Welding proof sensors	NO
Ambient temperature (min/max)	0°C / 230°C
Ambient temperatures > -25°C	NO
Compression-resistant	NO
Construction type housing	Cuboid
Degree of protection (IP)	IP50
Height of sensor	40mm
High-pressure resistant sensors	NO
Increased ambient temperatures > 80°C	YES
Length of sensor	66mm
Material active area of sensor	Vectra®
Material housing	Stainless steel 1.4305
Material housing	Metal
Material independent sensors (factor 1)	NO
Mechanical mounting condition for sensor	Not flat
Sensors unaffected by atmospheric changes (temperature cycle)	NO
Teflon housing	NO
Width sensor	40mm
Cascadable	NO
Connection to an amplifier	YES
Correction factor (aluminium)	0.3
Correction factor (brass)	0.4
Correction factor (copper)	0.2
Correction factor (stainless steel)	0.7

TECHNICAL DATA

Correction factor (steel)	1
Distance measuring sensors	NO
Double sensing range	NO
Hysteresis	15%
Increased sensing range	NO
Quadruple sensing range	NO
Reverse polarity protection	NO
Short-circuit-proof	NO
Suited for safety functions	NO
Switching distance	20mm
Switching frequency	100Hz
Triple sensing range	NO
Type of actuation	Metallic Target
Type of electric connection	Lemoso-connector
Type of switch function	Amplifier
Type of switching output	Amplifier
Voltage type	DC
With LED indication	NO
With monitoring function downstream switching devices	NO
Areas inquiry	NO
End position inquiry hydraulic cylinder	NO
Welding areas	NO

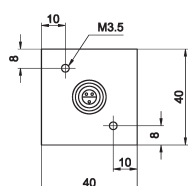
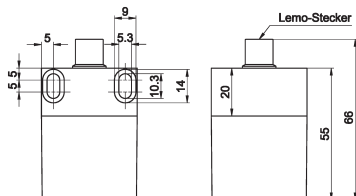
CONNECTION
DIMENSIONAL DRAWING

ADDITIONAL INFORMATION

X-ON Electronics

Largest Supplier of Electrical and Electronic Components

Click to view similar products for [Proximity Sensors](#) category:

Click to view products by [IPF ELECTRONIC](#) manufacturer:

Other Similar products are found below :

[01.001.5653.1](#) [70.340.1028.0](#) [70.360.2428.0](#) [70.364.4828.0](#) [70.810.1053.0](#) [72.360.1628.0](#) [73.363.6428.0](#) [980659-1](#) [QT-12](#)
[E2ECQC2D1M1GJT03M](#) [E2EX10D1NN](#) [E2E-X14MD1-G](#) [E2E-X2D1-G](#) [E2EX2ME2N](#) [E2E-X3D1-N](#) [10M](#) [E2E-X4MD1-G](#)
[E2FMX1R5D12M](#) [E2K-F10MC1](#) [5M](#) [EC3016PPASL-1](#) [EI1204TBOSL-6](#) [EI5515NPAP](#) [BSA-08-25-08](#) [IC08ANC15PO-K](#) [25.161.3253.0](#)
[25.332.0653.1](#) [25.352.0653.0](#) [25.352.0753.0](#) [25.523.3253.0](#) [922FS1.5C-A4P-Z774](#) [SC606ABV0S30](#) [SM552A100](#) [SM952A126100LE](#)
[SM956A132600](#) [A1220EUA-T](#) [F3S-A162-U](#) [CL18](#) [QT-08L](#) [34.110.0010.0](#) [TL-C2MF1-M3-E4](#) [IA08BLF15NOM5](#) [IA08BSF15NOM5](#)
[IA12ASF04DOM1](#) [IS2](#) [IS31SE5000-UTLS2-TR](#) [34.110.0021.0](#) [34.110.0022.0](#) [CA150-120VACDC](#) [VM18VA3000Q](#) [XS508BSCBL2](#)
[XS512BLNAM12](#)