

JBC

www.jbctools.com



MV

PNEUMATIC SUCTION MODULE

MV / PNEUMATIC SUCTION MODULE

MV-A
PNEUMATIC SUCTION
MODULE



0010207
MODULE CABLE
CONNECTOR



MANUAL

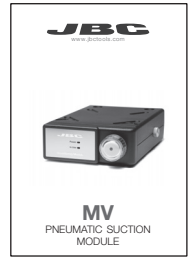

0821830
FILTER SUCTION SET



0005966
50 FILTERS BOX



0781046
COTTON FILTERS



0008446
ESCAPE FILTER



INSTALLATION

MV-A
PNEUMATIC SUCTION
MODULE

DD-2B
CONTROL UNIT

Connectable control units:
DI, DD, DDR, DM.

Connectable Compact line:
CV

Air pressure
range supply
4 to 6 bar
6 bar MAX

USB
connector
to PC

Power Cord Socket

Equipotential connection

DR560-A
DESOLDERING IRON



DR-SD
DESOLDERING
STAND

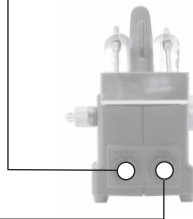

PNEUMATIC SUCTION MODULE ELEMENTS



CHANGING PUMP FILTERS

IMPORTANT!!!

Do not open the external filter with sharps in order to avoid damage

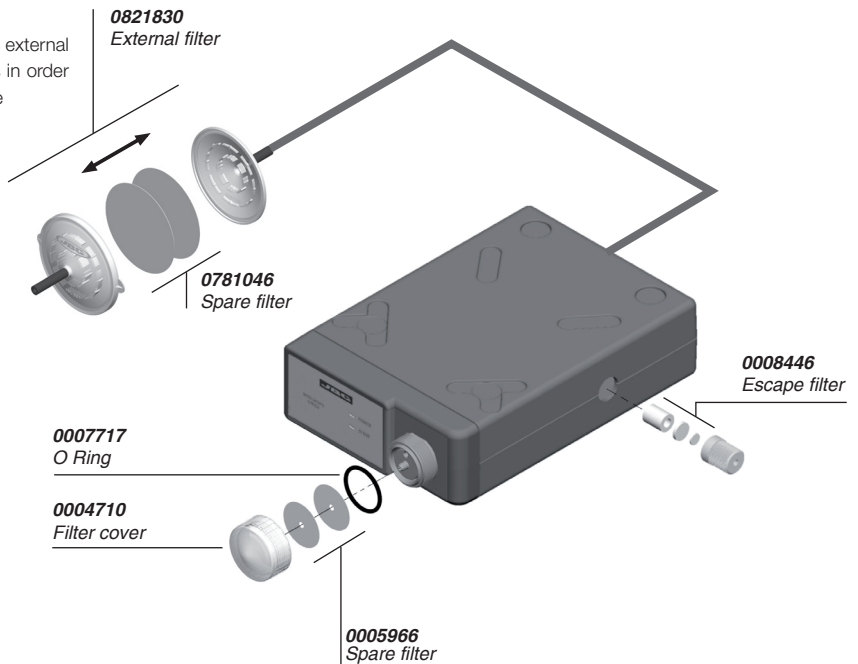

TECHNICAL SPECIFICATIONS

- Air pressure range supply: 4-6 bar
- Maximum Air pressure: 6 bar
- Weight of complete unit: 0,7 kg (1,6 lb)
- Complies with CE standards on electrical safety, electromagnetic compatibility and ESD protected housing "skin effect"
- RoHS compliant
- Equipotential connector and the tool tip are connected to station mains ground supply for ESD protection



This product should not be thrown in the garbage.

JBC

WARRANTY

JBC's 2 years warranty guarantees this equipment against all manufacturing defects, covering the replacement of defective parts and all necessary labour.

Warranty does not cover product wear due to use or mis-use.

In order for the warranty to be valid, equipment must be returned, postage paid, to the dealer where it was purchased enclosing this fully filled in, sheet.

SERIAL N°

STAMP OF DEALER

DATE OF PURCHASE

www.jbctools.com

X-ON Electronics

Largest Supplier of Electrical and Electronic Components

Click to view similar products for [Soldering Workstation Equipment](#) category:

Click to view products by [JBC Tools](#) manufacturer:

Other Similar products are found below :

[FP-BVX](#) [GS1116](#) [2072](#) [BH-010](#) [AC-TX001-4](#) [CA0202](#) [CA0201](#) [AC-TX002-2](#) [WXD2N](#) [Q-7100-9000](#) [35456](#) [T0051514699N](#)
[T0051517699N](#) [35457](#) [35450](#) [WS2-NS](#) [T0051512299N](#) [ALFA](#) [T0058757898](#) [T0058768762](#) [T0058744845N](#) [T0051515699N](#)
[T0051512199N](#) [FT91000037N](#) [BL12](#) [145-2000-ESDN](#) [T0058758721N](#) [T0058768727N](#) [WXD2020N](#) [T0058768725N](#) [BP0027](#) [CLMU-A8](#)
[RMSE-2QE](#) [RMVE-2QE](#) [QUICK 860DA](#) [0016344](#) [0.SA.0](#) [0T56](#) [CL-SFE/1 FILTERS](#) [PX0410/03P/5055](#) [RA150](#) [36A.SA](#) [3C.SA](#) [3.TA](#)
[AT850D/P](#) [TMT-HA300](#) [TMT-PH200](#) [TMT-PH300](#) [5-048](#) [5-050](#)