

LED Power Supply Constant Voltage

Model	LNA0612CV
Voltage	12V
Current	0.5A
Power	6W



Input	Rated input voltage	230 VAC	
	Range of input voltage	220-240VAC	
	Frequency	50Hz	
	Power Factor	NC	
	Current	0.1 A MAX. @Full Load	
	Start-Up time	<0.5S for ERP @Full Load	
	Inrush Current	40A MAX. @Full Load, 240 VAC	
	Unload Power Consumption	≤0.5W	
Output	Unload voltage	12.6VDC MAX	
	Load Voltage rang	NA	
	Constant Voltage	12V	
	Voltage Accuracy	±5% @220-240VAC	
	Voltage Regulation	≤3%@Full Load	
	Hold-up Time	NA	
	Efficiency in full load	≥80%@Full Load ,240VAC	
	Ripple	NA	
	Power Max	6W	
Dimming	Dimmable or not	NA	
	Dimming mode	NA	
	Dimming current range	NA	
Protection	Over load Protection	105-150% Protection type: Auto Restore	
	Over Voltage Protection	>16VDC Protection type: Auto Restore	
	Short circuit Protection	Protection type: Auto Restore	
	Over Temperature protection	Protection type: Auto Restore	
	HI-pot	Input-Output(V.AC)	3000V/5mA/1min
Isolation	Input-FG(V.AC)	NA	
	Output-FG(V.AC)	NA	
	Leakage Current	<0.5mA(240VAC)	
Environment/Life	Input-Output(V.AC)	≥10MΩ@500VDC	
	Input-FG(V.AC)	NA	
	Output-FG(V.AC)	NA	
	Operating Temperature	-10°C...+40°C	
	tc	85°C	
Feature	Storage Temperature	-20°C...+60°C	
	Humidity	20%-90%RH	
	Life time	> 30,000h @40°C	
	HSF requirement	RoHS	
Safety @ EMC	Dmension	67.5*31*21(LXWXH)mm	
	Approval	CE	
	Safety standards	EN 61347-1; EN61347-2-13 EN60598-1; EN60598-2-6	
	EMI	EN55015; EN61000-3-2 Class C EN61000-3-3	
	EMS		EN61547; EN 61000-4-2 - 8KV; 4KV
			Performance Criteria B EN 61000-4-5 — 1000V; Performance Criteria C

LED Power Supply Constant Voltage	
Model	LNA0612CV
Voltage	12V
Current	0.5A
Power	6W

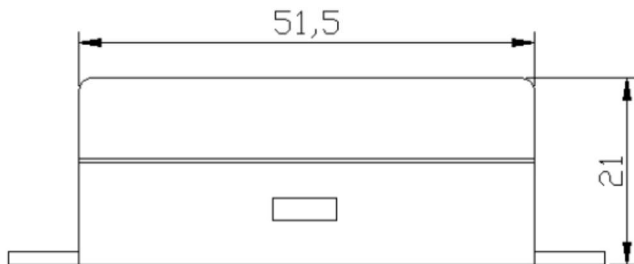
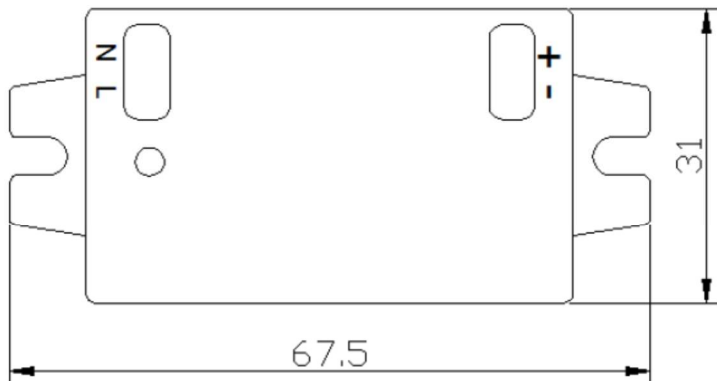

LABEL:





ESPE  **LED POWER SUPPLY**
LNA0612CV

INPUT: 230VAC 50Hz 0.1A
OUTPUT: 12V \equiv 500mA 6W
tc: 85 $^{\circ}$ C ta: 40 $^{\circ}$ C

CE

tc

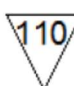
SELV

MADE IN CHINA

X-ON Electronics

Largest Supplier of Electrical and Electronic Components

Click to view similar products for [LED Power Supplies](#) category:

Click to view products by [Espe](#) manufacturer:

Other Similar products are found below :

[ESS015W-1000-12](#) [EUC-075S105DT](#) [PDA-WIFI](#) [PIFC-K250F](#) [PITB-K222A](#) [ALD-514012PJ134](#) [LB240S24KH](#) [LMH020-SPLC-0000-0000001](#)
[LMD600-0100-C1A7-7030000](#) [79534](#) [79535](#) [EUG-200S210DT](#) [ESS030W-1050-21](#) [ESS030W-0900-32](#) [BPOXL 4-12-035](#) [SLM160W-3.9-40-ZA](#)
[LE42S24VN](#) [ESS010W-0180-42](#) [ESS010W-0350-24](#) [ESS010W-0200-42](#) [ESM060W-1400-42](#) [PDA080B-1A0G](#) [ESS010W-0500-12](#) [PDA150B-](#)
[S1A5G](#) [ZPS-20](#) [SLM140W-1.05-130-ZA](#) [UCP20U-480-36](#) [EVM120W-3000-40](#) [ESS040W-1400-27](#) [ESS015W-0700-18](#) [ESS010E-0250-42](#)
[EVM120W-2700-42-ECN2](#) [79278](#) [MU060C105AQ_0-10V](#) [EUD-150S350DVA](#) [LSWC-040S105PS](#) [LWA320-C420-ARK-B](#) [50304](#) [HVG-320-](#)
[36AB](#) [HVG-320-54AB](#) [ELEMENT 30/220-240/700 S](#) [OT FIT 38/220-240/900 CS S MINI](#) [ELEMENT 180/220-240/24 G2](#) [NPF-120D-24BE](#) [NPF-](#)
[120D-48BE](#) [NPF-120D-54BE](#) [PWM-40-36](#) [PWM-60-36](#) [LUD-060S150BSF](#) [RCD-48-1.00](#)