

LED Power Supply Constant Voltage	
Model	LSA1512CV
Voltage	12V
Current	1.25A
Power	15W

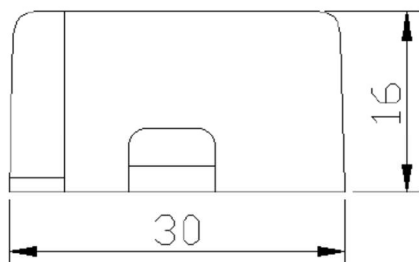

Input	Rated input voltage	230 VAC
	Range of input voltage	220-240VAC
	Frequency	50Hz
	Power Factor	NC
	Current	0.3 A MAX. @Full Load
	Start-Up time	<0.5S for ERP @Full Load
	Inrush Current	40A MAX. @Full Load. 240 VAC
	Unload Power Consumption	≤0.5W
Output	Unload voltage	12.6VDC MAX
	Load Voltage rang	NC
	Constant Voltage	12V
	Voltage Accuracy	±5% @ 220-240VAC
	Voltage Regulation	≤3%@Full Load
	Hold-up Time	<1s max,Io=0mA
	Efficiency in full load	≥80%@Full Load ,240VAC
	Ripple	NA
Dimming	Power Max	15W
	Dimmable or not	NA
	Dimming mode	NA
Protection	Dimming current range	NA
	Over load Protection	105-150%
		Protection type: Auto Restore
	Over Voltage Protection	>16VDC
		Protection type: Auto Restore
Short circuit Protection	Protection type: Auto Restore	
Over Temperature protection	Protection type: Auto Restore	
HI-pot	Input-Output(V.AC)	3000V/5mA/1min
	Input-FG(V.AC)	NA
	Output-FG(V.AC)	NA
Isolation	Leakage Current	<0.5mA(240VAC)
	Input-Output(V.AC)	≥10MΩ@500VDC
	Input-FG(V.AC)	NA
Environment/Life	Output-FG(V.AC)	NA
	Operating Temperature	-10°C...+40°C
	tc	85°C
	Storage Temperature	-20°C...+60°C
	Humidity	20%-90%RH
	Life time	>30,000h @50°C
HSF requirement	RoHS	
Feature	Dmension	160.5*30*16(LXWXH)mm
Safety @ EMC	Approval	CE
	Safety standards	EN 61347-1; EN61347-2-13 EN60598-1; EN60598-2-6
	EMI	EN55015; EN61000-3-2 Class C EN61000-3-3
	EMS	EN61547; EN 61000-4-2 - 8KV; 4KV
		Performance Criteria B
	EN 61000-4-5 —1000V; Performance Criteria C	

LED Power Supply Constant Voltage	
Model	LSA1512CV
Voltage	12V
Current	1.25A
Power	15W



LABEL:

ESPE

LED POWER SUPPLY
LSA1512CV

L

INPUT.....230V~
50Hz 0.3A

OUTPUT.....12V= 1.25A

tc:85 C° ta:40C°

M/M/F/110

IP20

• tc



CE

Constant Voltage

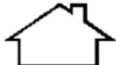

SELV
MADE IN CHINA

N

-

X-ON Electronics

Largest Supplier of Electrical and Electronic Components

Click to view similar products for [LED Power Supplies](#) category:

Click to view products by [Espe](#) manufacturer:

Other Similar products are found below :

[ESS015W-1000-12](#) [EUC-075S105DT](#) [PDA-WIFI](#) [PIFC-K250F](#) [PITB-K222A](#) [ALD-514012PJ134](#) [LB240S24KH](#) [LMH020-SPLC-0000-0000001](#)
[LMD600-0100-C1A7-7030000](#) [79534](#) [79535](#) [EUG-200S210DT](#) [ESS030W-1050-21](#) [ESS030W-0900-32](#) [BPOXL 4-12-035](#) [SLM160W-3.9-40-ZA](#)
[LE42S24VN](#) [ESS010W-0180-42](#) [ESS010W-0350-24](#) [ESS010W-0200-42](#) [ESM060W-1400-42](#) [PDA080B-1A0G](#) [ESS010W-0500-12](#) [PDA150B-](#)
[S1A5G](#) [ZPS-20](#) [SLM140W-1.05-130-ZA](#) [ESS040W-1400-27](#) [ESS015W-0700-18](#) [ESS010E-0250-42](#) [EVM120W-2700-42-ECN2](#) [79278](#)
[MU060C105AQ_0-10V](#) [EUD-150S350DVA](#) [LSWC-040S105PS](#) [LWA320-C420-ARK-B](#) [50304](#) [HVG-320-36AB](#) [HVG-320-54AB](#) [ELEMENT](#)
[30/220-240/700 S](#) [OT FIT 38/220-240/900 CS S MINI](#) [ELEMENT 180/220-240/24 G2](#) [PWM-40-36](#) [PWM-60-36](#) [LUD-060S150BSF](#) [RCD-48-1.00](#)
[ESS010W-0750-12](#) [EUC-036S035DV](#) [EUC-036S045DV](#) [EUC-036S070SV](#) [EUC-042S105DS](#)