

Anna-40-3 series

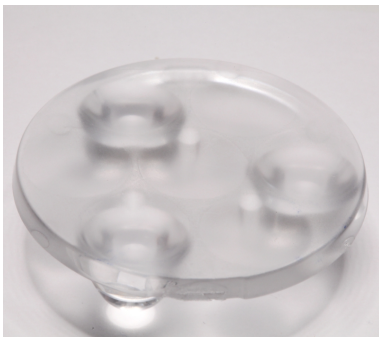

Ordering number	C11711		
Description	C11711_Anna-40-3-M-XP-G		
Family	Anna-40-3	FWHM	28 degrees
Type	Lens	Efficiency	-
LED	XP-G	cd/lm	-
Color	Transparent	Gerber File	Available
Diameter	40 mm		
Height	10.7 mm		
Style	Round		
Optic Material	PMMA		
Holder Material	-		
Fastening	Glue, pin		
Status	Ready		



Ordering number	C11712		
Description	C11712_Anna-40-3-W-XP-G		
Family	Anna-40-3	FWHM	42 degrees
Type	Lens	Efficiency	-
LED	XP-G	cd/lm	-
Color	Transparent	Gerber File	Available
Diameter	40 mm		
Height	10.7 mm		
Style	Round		
Optic Material	PMMA		
Holder Material	-		
Fastening	Pin, glue		
Status	Ready		

D

C

B

A

4

4

3

3

2

2

1

1

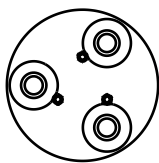

Anna-3

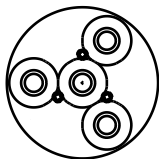

Anna-4

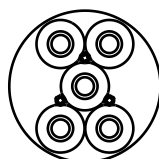

Anna-5

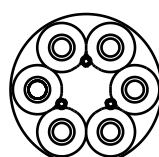

Anna-6

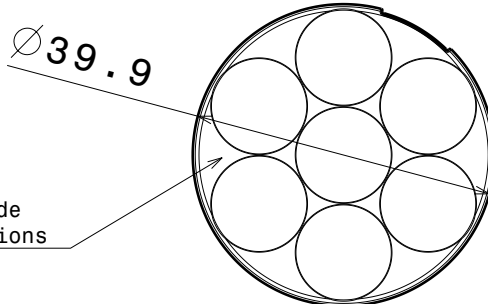
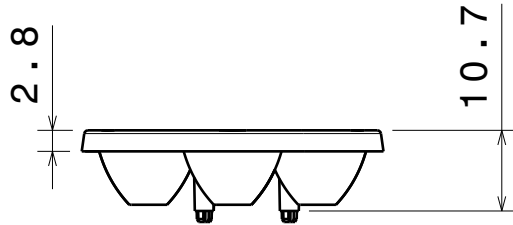

Anna-7

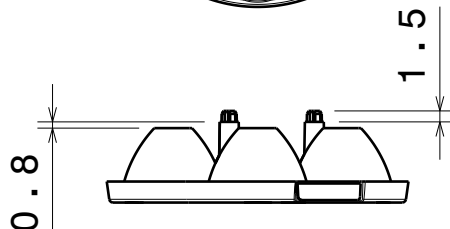

Same top side in all versions

Same location pin-circle in all versions

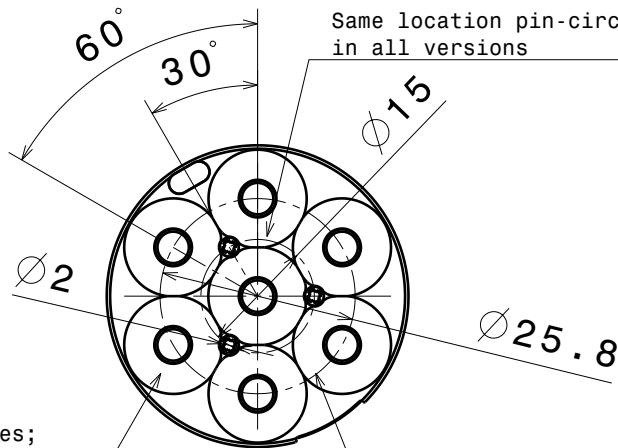

Number of cones varies; 3, 4, 5, 6 and 7pcs on bottom side depending the version.

Same led-circle in all versions

Material: PMMA

Versions:

- Anna-3-S
- Anna-3-M
- Anna-3-W
- Anna-4-S
- Anna-4-M
- Anna-4-W
- Anna-5-S
- Anna-5-M
- Anna-5-W
- Anna-6-S
- Anna-6-M
- Anna-6-W
- Anna-7-S
- Anna-7-M
- Anna-7-W

This drawing is our property. It can't be reproduced or communicated without our written agreement.



L
T
F
F

e
e
i
i
N
n

d

DRAWING TITLE

Datasheet Anna40-series Lens

DRAWN BY

DATE

p

12.10.2010

CHECKED BY

DATE

s n

12.10.2010

DESIGNED BY

DATE

hh

30.07.2010

SIZE

DRAWING NUMBER

REV

A4

-

1

SCALE

1:1

WEIGHT (g)

SHEET

1/1

D

A

X-ON Electronics

Largest Supplier of Electrical and Electronic Components

Click to view similar products for [Ledil](#) manufacturer:

Other Similar products are found below :

[F10390_PENTA-5-M](#) [C10472_RER-5-M](#) [FCN10804_LR1-RS](#) [FCN11454_LE1-M2](#) [C10365_PLATINUMROCKET-3-W](#)
[C12084_BROOKE-SCR-W](#) [FA10643_TINA-M](#) [C12449_STRADA-T-6X1-DWC](#) [C10686_EVA-W](#) [C11552_BARBARA-S](#)
[CA11264_HEIDI-D](#) [CN12644_LENINA-S](#) [CS14840_HB-2X2MX-M](#) [F14533_ANGELETTE-M](#) [F15244_FLORENCE-ZT25-S](#)
[CN17052_DAISSY-7X1-WW-MATT](#) [C17171_DAISSY-8X1-SHD-MATT](#) [FA11207_TINA-W](#) [FCP13895_SEANNA-A](#) [CN14236_WINNIE-S](#)
[C11795_ANNA-40-4-W](#) [C12358_TYRA3-W](#) [C13508_STRADA-SQ-T2](#) [CP10961_RGBX-SS](#) [CN12646_LENINA-W](#) [CP15304_LARISA-](#)
[RS-PIN](#) [FN13888_BILLIE-A](#) [CP16939_CARMEN-W-C-WHT](#) [C17341_DAISSY-4X1-WW-US-D](#) [C14275_SHELLY-T-6X1-N](#)
[C14346_ANGELETTE-WAS](#) [CA11998_EMILY-SS-WAS](#) [CA12000_EMILY-O-WAS](#) [C13032_BARBARA-WW](#) [C15800_MOLLY-S](#)
[FCN12592_LE1-D-COP](#) [CA12242_HEIDI-SS](#) [CP13682_RGBX2-S](#) [CA11476"TYRA2-M](#) [FS15626_FLORENCE-3R-IP-Z90](#)
[F12916_CRYSTAL-RS](#) [C17172_DAISSY-8X1-SHD-MATT-WHT](#) [C17174_DAISSY-4X1-W-US](#) [CA11267_HEIDI-O-90](#) [CA12878_MIRA-M](#)
[CP12413_LOS-D](#) [CP10944_RGBX-M](#) [FA10661"LXP-RS](#) [FCP15347_FLORENTINA-4X1-O](#) [CN12721_LENA-S-DL](#)